



产品配色与工艺说明图
Product Colour, Material & Finishing Specifications

Product Model 产品型号	TB20	Brand 品牌	中性	Job No. 图档编码	3-608TB200690A0001
Product Type 产品类	无线充电器说明书	Description 描述	/	Revision 版本号	
Dimension 尺寸	85*65mm	Original Designer 原设计师		Date 日期	2019.9.9
Scale 比例	1:1	Technology 工艺	128g哑粉纸 双面四色印刷	Verifying 审核	/

无线充电
蓝牙音响
用户手册

用户手册

感谢使用本产品，本产品是一款无线充电蓝牙音响，支持蓝牙立体声音频无线传输及控制。同时也是一款智能手机无线充电器，它可以摆脱复杂的线路连接和连线距离的限制，使用户享受高品质的音乐和数码产品无线充电的无限乐趣。
在使用无线充电蓝牙音响前，请认真阅读本手册并妥善保管，以备查阅。

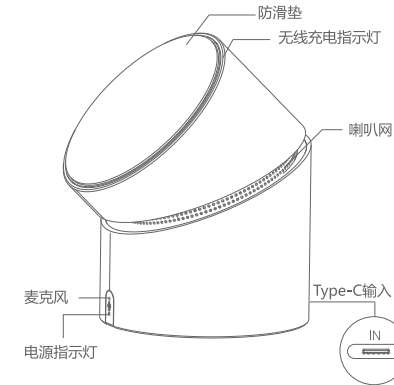

产品按键与功能

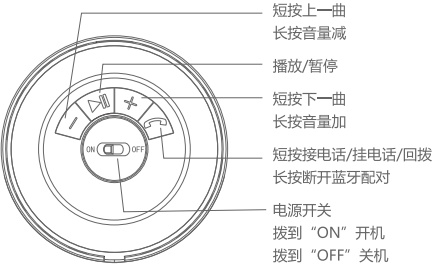

技术参数

蓝牙规格	Bluetooth V4.0
电源供应	DC 5V 2A DC 9V 1.67A
输出功率	5W/2.5W/10W
内置充电电流	500mA
额定功率	2.5W
失真度	<0.5%
无线充电	Qi标准 110~2050KHz 无线充电 - 无线充电
无线充电功率	<10W
工作环境温度	>3℃~49℃

蓝牙连接方式

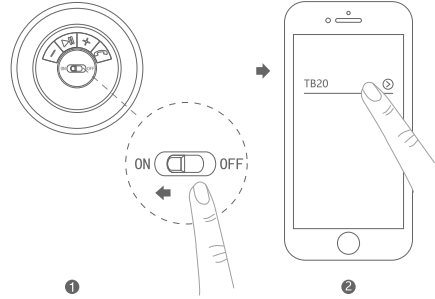

1. 拨动ON/OFF开关键到ON方向，开机成功，无线充电蓝牙音箱发出一次提示音，指示灯绿灯闪烁，等待配对。
 2. 将音乐播放设备的蓝牙功能开启，然后在设备的蓝牙菜单里选择“TB20”，配对成功后，无线充电蓝牙音箱发出“滴”声提示配对成功，绿灯停止闪烁。
 3. 单击“D”键一次或者在播放音乐的蓝牙设备上开启音乐，播放音乐。
- * 蓝牙连接状态下，长按“S”无线充电蓝牙音箱发出“滴”声，提示蓝牙已断开，绿灯闪烁，等待下一次配对。
- * 单击“+”键为上一曲，长按为减音量。
- * 单击“-”键为下一曲，长按为加音量。

对手机进行无线充电

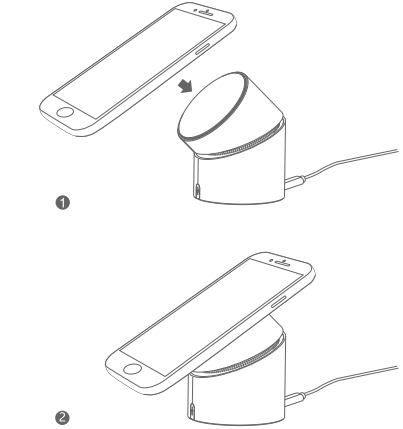

1. 确认无线充电蓝牙音箱电源指示灯为绿色，处于连接电源状态。
2. 将带有无线充电功能的手机置于无线充电蓝牙音箱的滑板上，充电指示灯变为蓝色，找到正确充电位置开始充电，当充电指示灯蓝绿交替闪烁时，表示手机位置摆放不正确，请重新摆放手机，直到待机指示灯只显示蓝色，此时无线充电指示灯亮也会亮一盏蓝光。

蓝牙通话

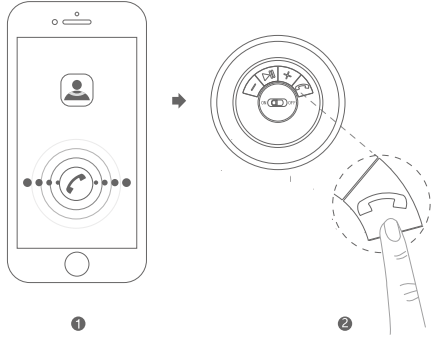

1. 手机与音响蓝牙连接状态下，当有来电进入时，无线充电蓝牙音响发出连续提示音，此时单击音响底部“S”键或直接手机接听，免提通话用户需面向音响，与麦克风保持30cm内为佳，通话完毕单击“S”键或直接手机挂机。
 2. 手机与音响蓝牙连接状态下，双击“S”键一次即可拨最新未接出的电话。
- * 无线充电蓝牙音箱来电提示音为音响本身固有提示铃声，并非手机来电铃声。

359度旋转

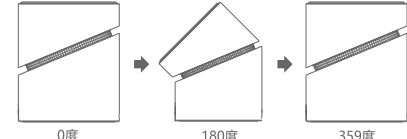

可359度旋转，顶部面板设计防滑垫，手机充电成功后可以旋转至任意角度，即使再劲爆的音乐也不会掉下来。当硅胶垫上沾有灰尘时，影响防滑效果，可用无尘布小心擦拭，或沾取少量硅胶垫表面处理剂擦拭。

注意事项

- 请勿让儿童使用玩耍本产品。
- 请勿敲击或拍打本产品。
- 请勿将本产品投于火中。
- 注意防水，防高温，严寒地区使用也会导致产品性能下降。
- 请勿堵塞机体上的喇叭网。
- 如长时间不用，请在2-3个月时间给内置电池充一次电，防止电池自放电或漏电极不能正常使用本机。
- 不使用时，请即电源开关OFF关。
- 如出现故障请送修，请勿自行拆装。
- 请将本产品置于通风位置充电。

Wireless Charging
Bluetooth Speaker
User Manual
BT20

User Manual

Thanks for using this product, this is a Wireless Charging Bluetooth Speaker, supporting Bluetooth stereo audio wireless transmission and control. It is also a smart phone wireless charger that can get rid of complex line connections and connection distance restrictions, allowing users to enjoy the high-quality music and digital products wireless charging unlimited fun.
Please read this manual carefully and keep it properly for reference before using the wireless Bluetooth speaker.

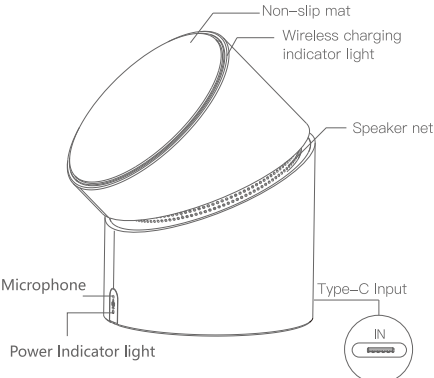

Product buttons and functions

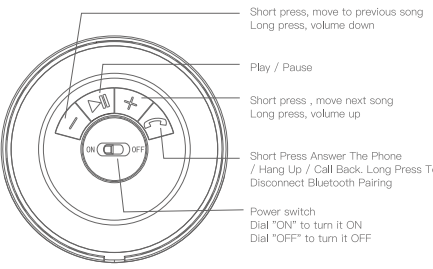

Specification

Bluetooth Specification	Bluetooth V4.0
Power Supply	DC 5V 2A DC 9V 1.67A
Output Power	5W/2.5W/10W
Built-in Battery Charging Current	500mA
Built-in Battery Capacity	500mAh
Signal To Noise Ratio	>85dB
Distortion	<0.5%
Wireless Charging	Qi standard 110~2050KHz Wireless Charging
Wireless Transmission Range	<10M
Working Temperature	<35℃~45℃

Bluetooth connection way

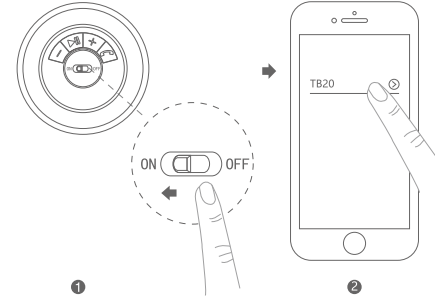

1. Did the ON/OFF key to the ON direction, boot up successfully, the wireless bluetooth speaker will give a prompt sound, and the indicator light will flash green, waiting for pairing.
 2. Turn on the bluetooth function of music playback device and select "BT20" from the bluetooth menu of the device.
 3. Click "BT" button once Or turn on music on a bluetooth device that plays music.
- * Under bluetooth connection, long press "S", the bluetooth speaker makes a "ding" sound, represent the bluetooth is disconnected and the green light flashes, waiting for the next pairing.
- * Click "-" button for the previous song, long press is reduce the volume.
- * Click "+" button for the next song, long press is increase volume.

Charge the phone wirelessly

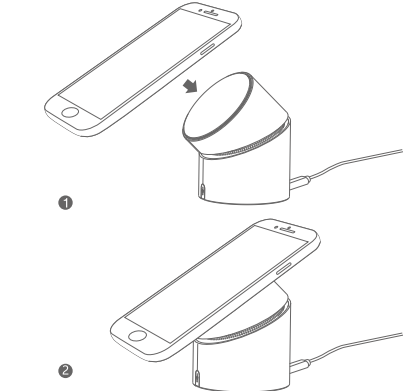

1. Verify that the power indicator of the wireless charging bluetooth speaker is green and in the connected power state.
2. Place the phone with wireless charging function on the wireless charging bluetooth speaker anti-slip mat, the charging prompt light turns blue, find the correct charging position and start charging. When the charging light flashes alternately blue and green, it means that the mobile phone is not in the correct position. Please rearrange the mobile phone until the standby indicator lights only show blue, at this time, the wireless charging indicator will also turn on a circle of blue light.

Bluetooth call

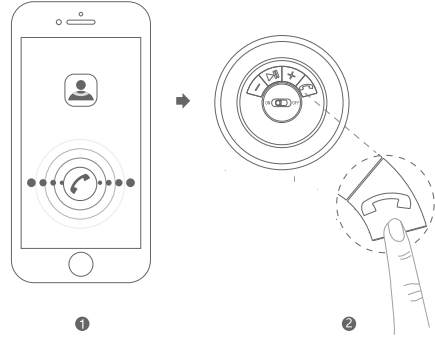

1. When the mobile phone is connected to the audio by bluetooth, while there is an incoming call, the wireless bluetooth speaker will issue a continuous prompt sound, you can click the "S" key at the bottom of the stereo or directly answer the phone, the user needs to face the audio when making a hands-free call, it is better to keep within 30cm of the microphone. After the call click "S" button or hang up the phone directly.
 2. When the mobile phone is connected to the audio by bluetooth, double-click "S" button once, then can call back the latest phone call.
- * The call prompt tone of the wireless bluetooth speaker is the inherent prompt ring tone of the audio system, not the ring tone of the mobile phone.

Rotate 359°

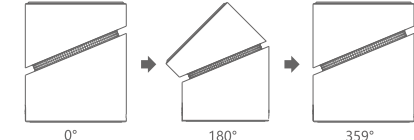

It can rotate at 359 degrees, and the anti-skid pad is designed on the top panel, which can rotate to any Angle after successful charging, even the strongest music will not fall. When there is dust on the silicone mat, it will affect the anti-skid effect, you can use dust-free cloth carefully wipe, or use a small amount of silicone pad surface treatment agent wipe.

Notes

- Do not allow children to use this product.
 - Do not hit or slap this product.
 - Pay attention to waterproof, prevent high temperature, cold area use will also lead to product performance decline.
 - Do not block the speaker net on the body.
 - If it is not used for a long time, please charge the built-in battery once within 2-3 months to prevent the battery from self-closing or leakage, which may cause the normal use of the unit.
 - Please turn OFF the power when not in use.
 - If there is a fault, please send it for repair. Please do not disassemble it by yourself.
 - Please charge the product in a ventilated position.
- Bluetooth Specification Power Supply Output Power Built-in Battery Charging Current Built-in Battery Capacity

FCC Warning:

This device complies with part 15 of the FCC Rules. Operation is subject to the following two conditions: (1) This device may not cause harmful interference, and (2) this device must accept any interference received, including interference that may cause undesired operation. Any Changes or modifications not expressly approved by the party responsible for compliance could void the user's authority to operate the equipment. This equipment has been tested and found to comply with the limits for a Class B digital device, pursuant to part 15 of the FCC Rules. These limits are designed to provide reasonable protection against harmful interference in a residential installation. This equipment generates uses and can radiate radio frequency energy and, if not installed and used in accordance with the instructions, may cause harmful interference to radio communications. However, there is no guarantee that interference will not occur in a particular installation. If this equipment does cause harmful interference to radio or television reception, which can be determined by turning the equipment off and on, the user is encouraged to try to correct the interference by one or more of the following measures:
-Reorient or relocate the receiving antenna.
-Increase the separation between the equipment and receiver.
-Connect the equipment into an outlet on a circuit different from that to which the receiver is connected.
-Consult the dealer or an experienced radio/TV technician for help. The device has been evaluated to meet general RF exposure requirement. The device can be used in portable exposure condition without restriction.
FCC RF exposure statement:
The equipment complies with FCC Radiation exposure limit set forth for uncontrolled environment. This equipment should be installed and operated with minimum distance 20cm between the radiator and your body.