

8.5 FT GIANT-SIZED COLOR CHANGING LED TREE

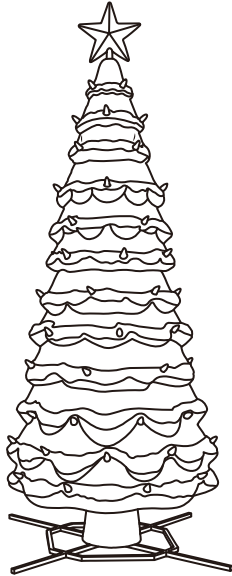

Questions, problems, missing parts? Before returning to the store, please have a copy of your receipt ready and email the SVI customer experience team (customerservice@svius.com) within 90 days of the date of purchase or call Home Accents Holiday Customer Service 8 a.m. - 7 p.m., EST, Monday - Friday, 9 a.m. - 6 p.m., EST, Saturday
1-855-HD-HOLIDAY (1-855-434-6543)
HOMEDEPOT.COM

IMPORTANT TIPS:

- Ensure that item's adapter is plugged in at the Function Control Box and plugged in the wall.
- Ensure that the switch on the function control box is on the desired setting.
- If not functioning properly (ex: LEDs don't light up), ensure that cables are connected to their corresponding cable as shown in the instruction sheet.
- Ensure that the floor or surface that the item sits on is flat and level.

PARTS LIST

- A. Base x 1
- B. Trunk x 1
- C. Tree Support Frame x 1
- D. Lower Support Pole x 1
- E. Middle Support Pole x 1
- F. Upper Support Pole x 1
- G. Disks x 3
- H. Tree Bottom x 1
- I. Tree Middle x 1
- J. Tree Upper x 1
- K. Tree Top x 1
- L. Star x 1
- M. Bulbs x 68 (+3 Spares)
- N. Base Extensions x 4
- O. Stakes x 4
- P. Remote x 1
- Q. Hex Wrench x 1
- R. Adapter * x 1

Power Adapter * Spec
Input: 120V~60Hz
Output: 5.9V 1.5A
Wattage: 8.85W

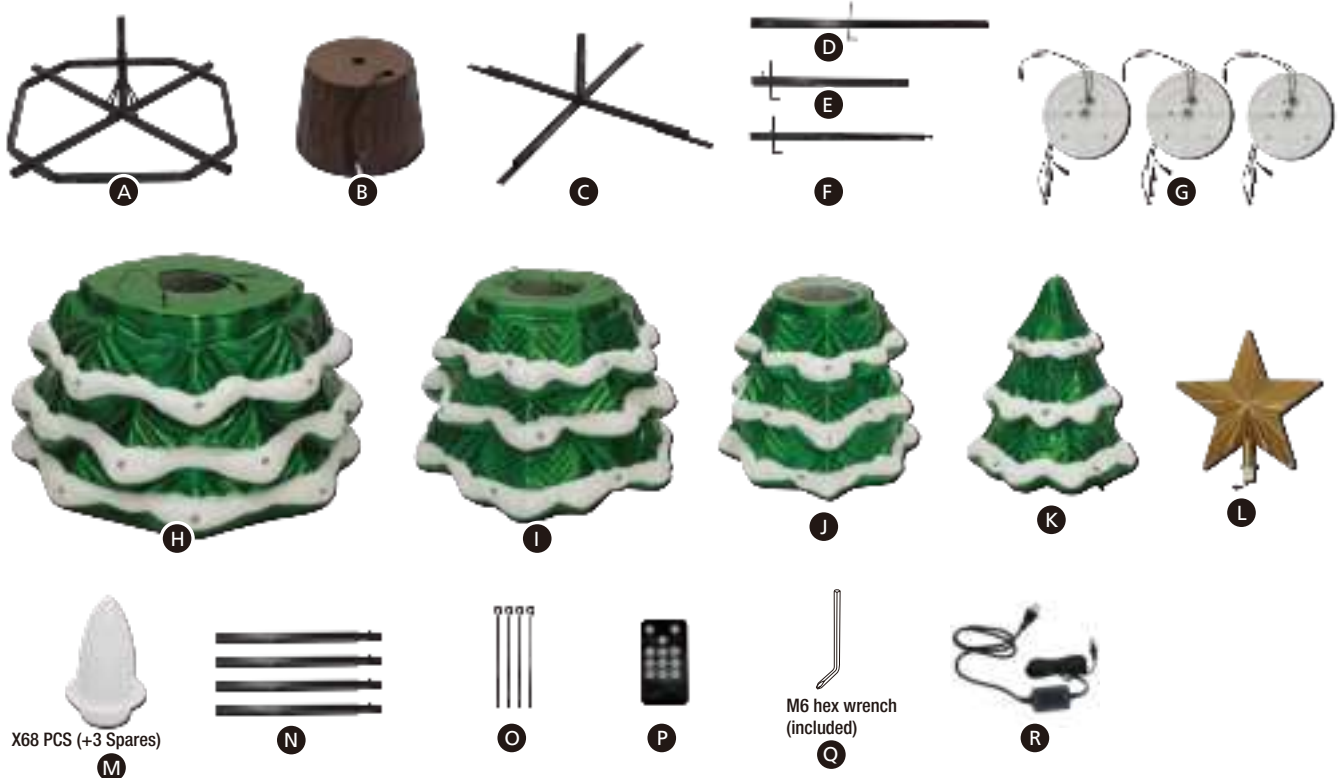

NOTE: Throughout the instructions, Right and Left are relative to the character.

NOTE: First attach the (C) Tree Support Frame to the (A) Base using the quick connect push button and pre-drilled hole. Then secure in place by rotating the screw on the (C) Tree Support clockwise.

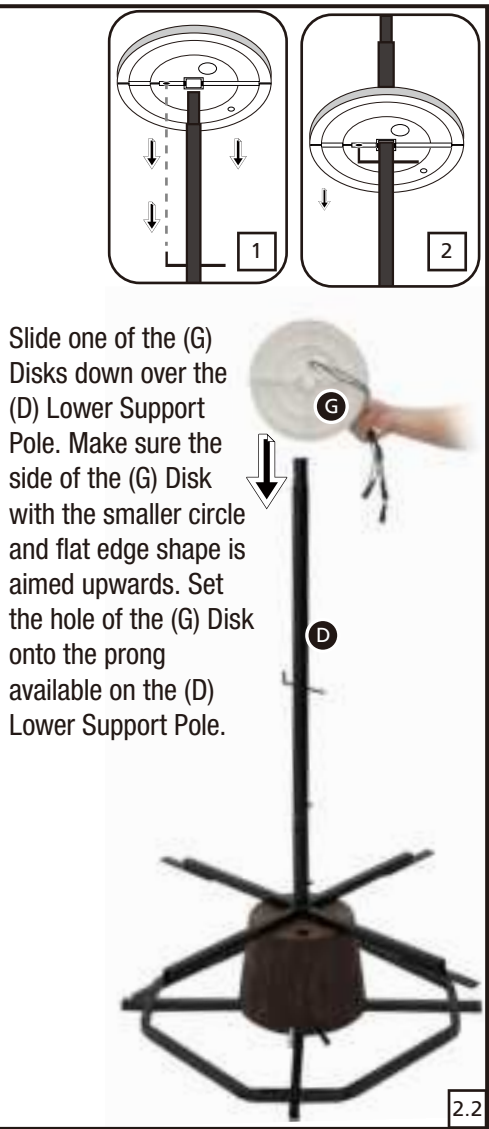
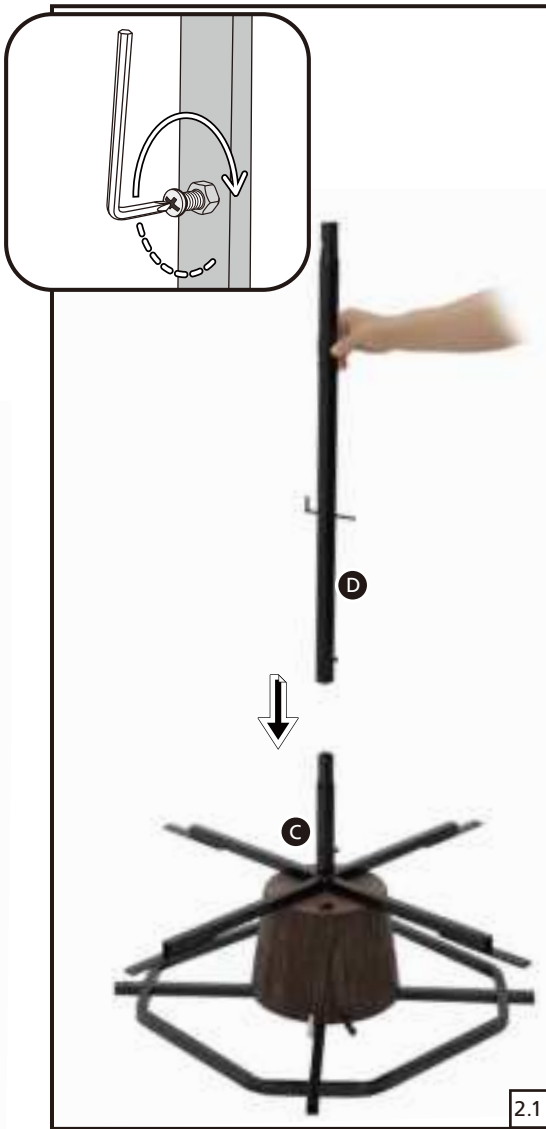
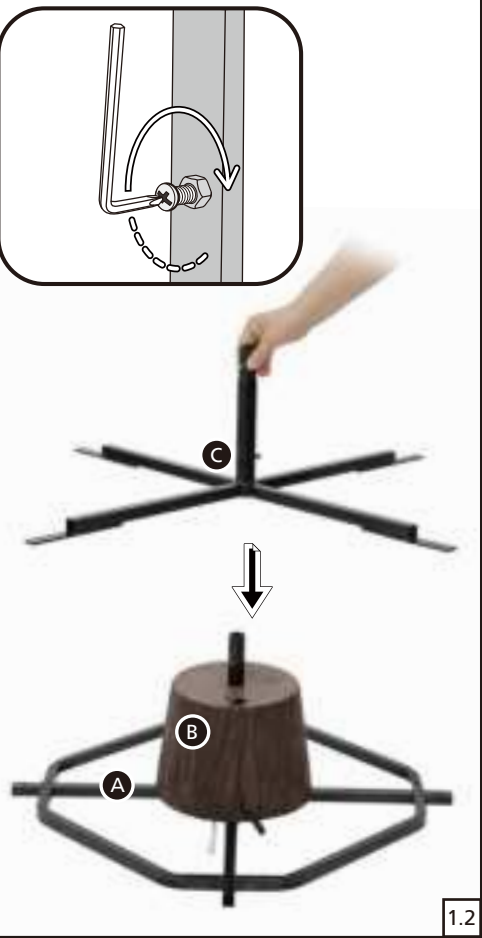
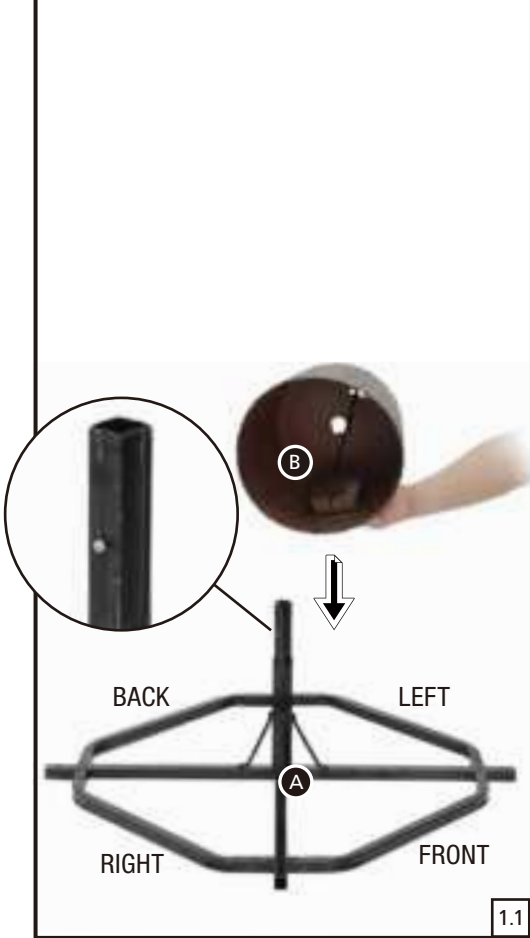

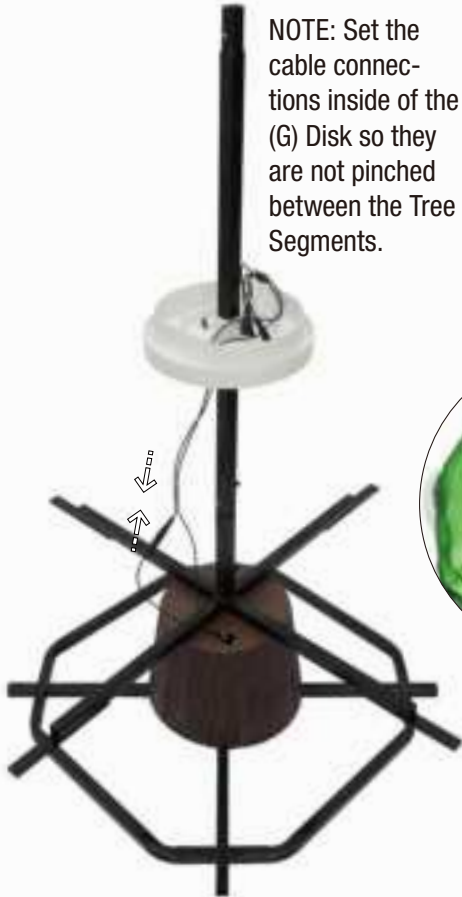
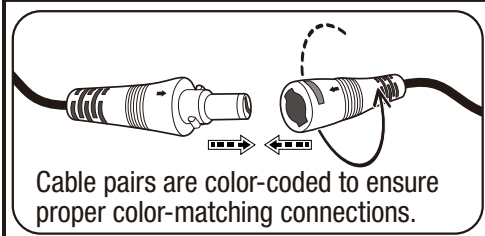

Connect cables as each (G) Disk and (H, I, J, K) Tree Segment is added.

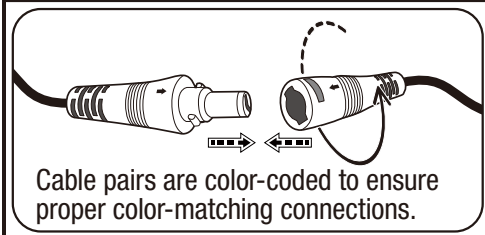
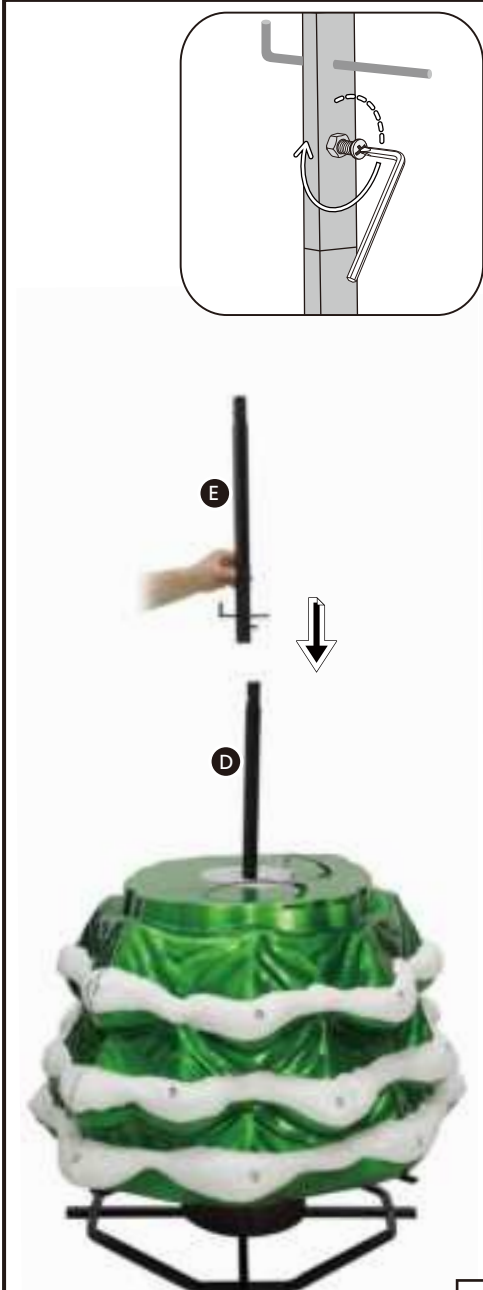
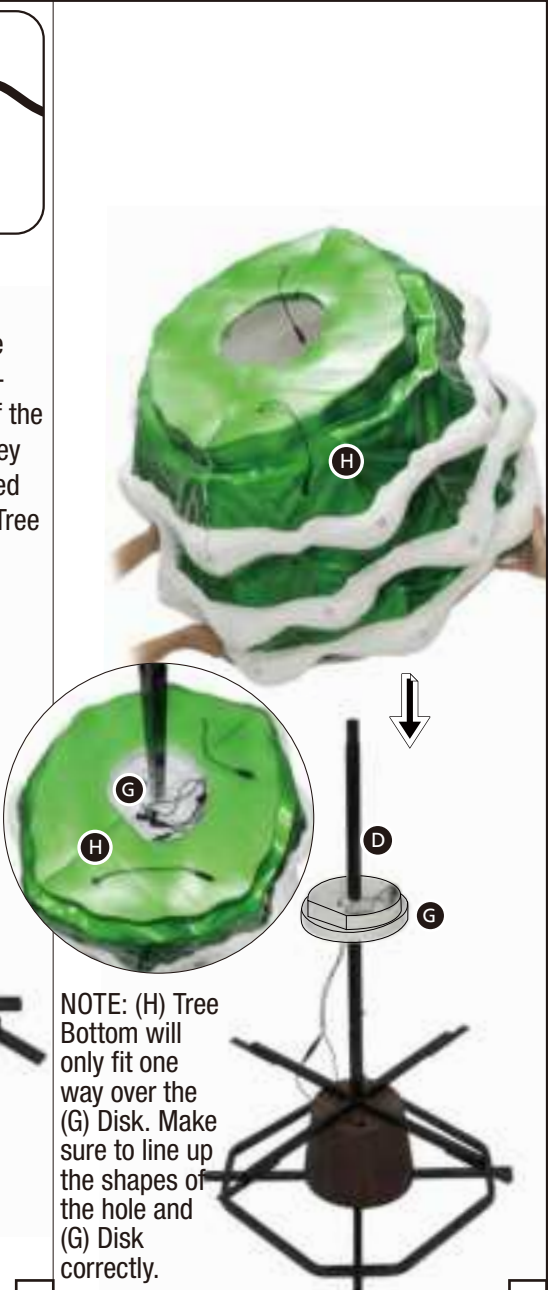

NOTE: Make sure to line up the shape of the hole in (I) Tree Middle with the (G) Disk.

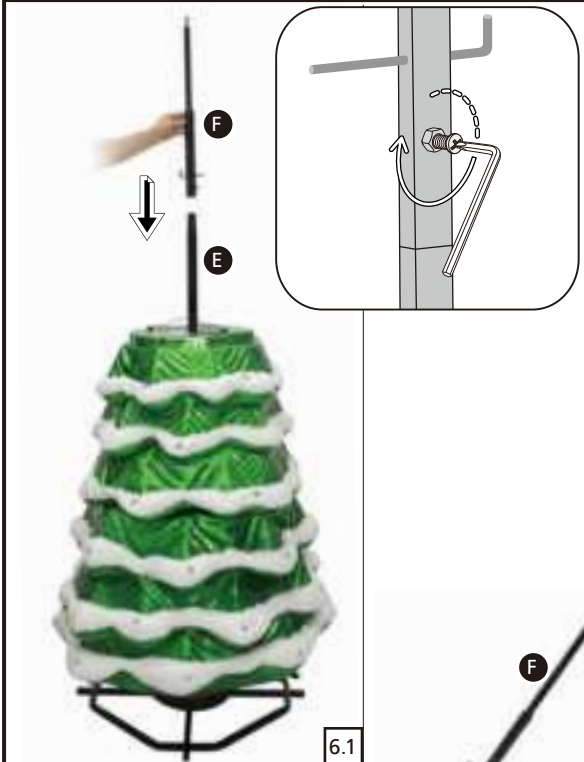
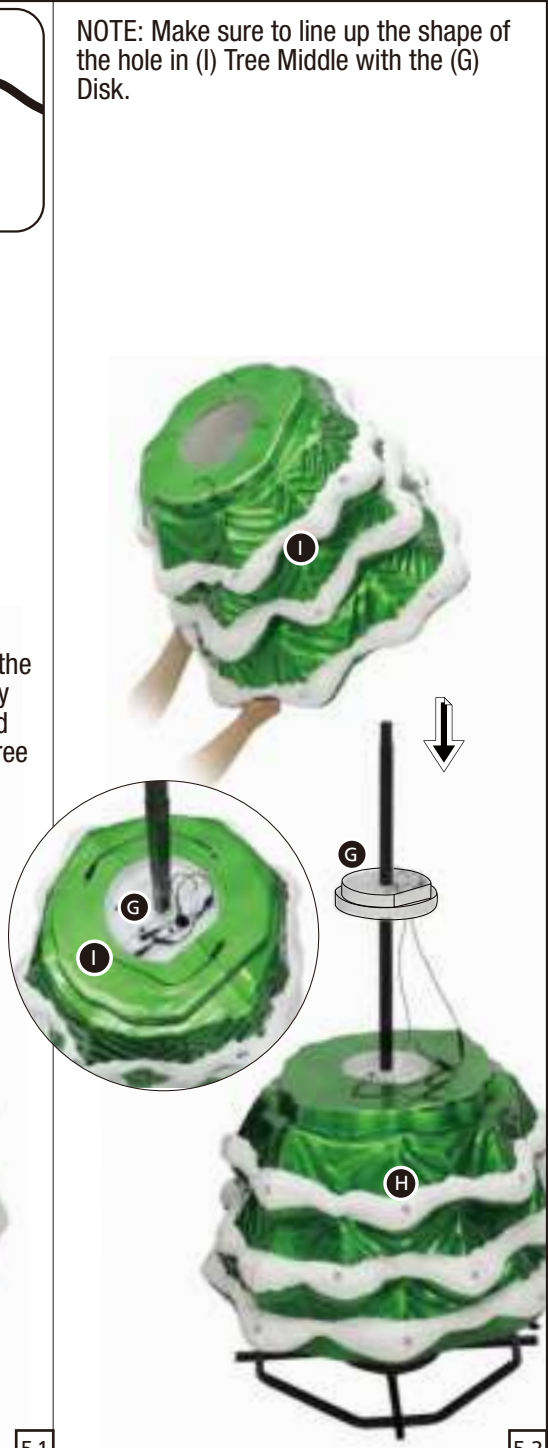

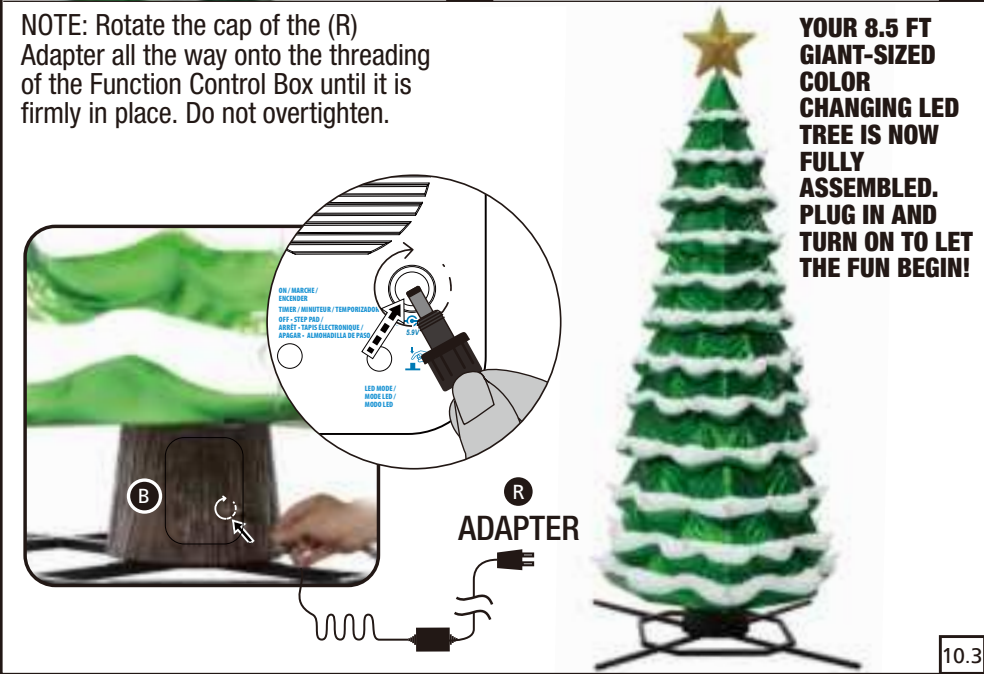
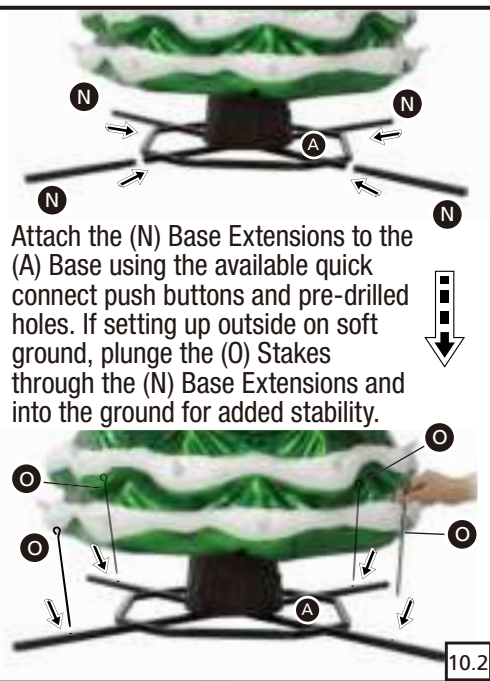
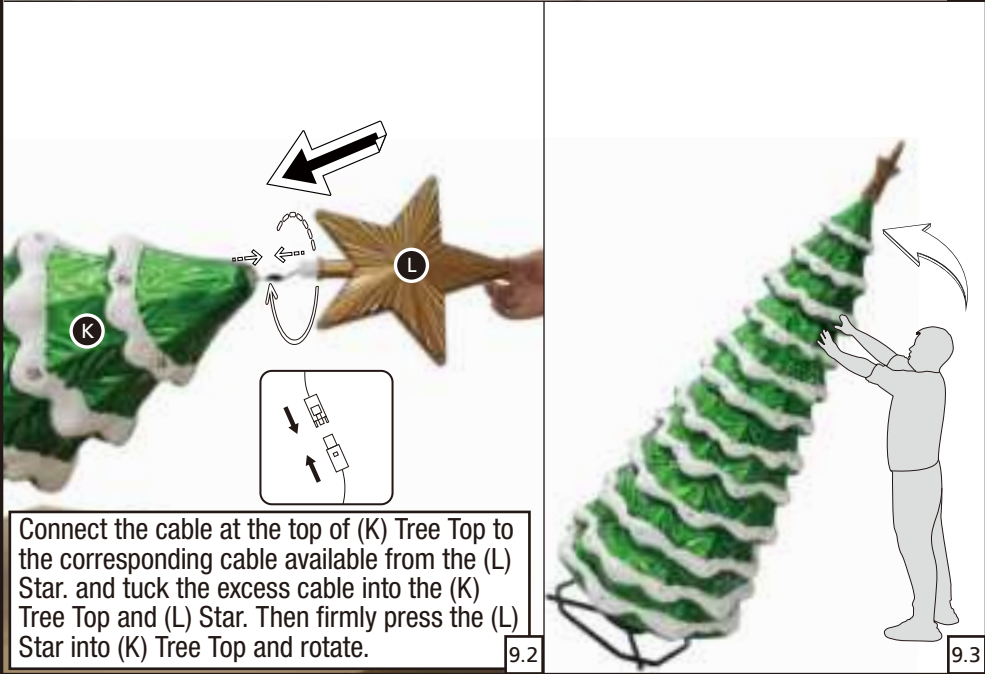
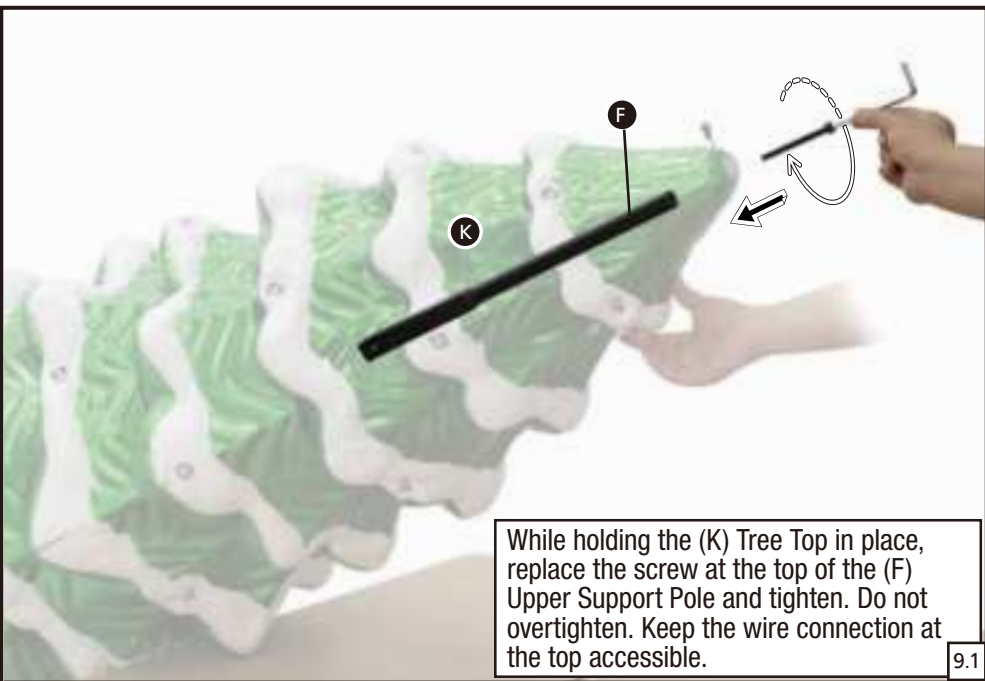
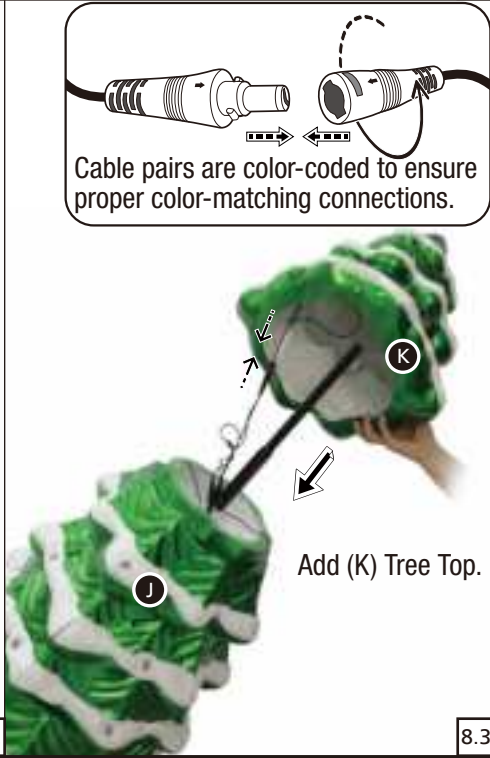
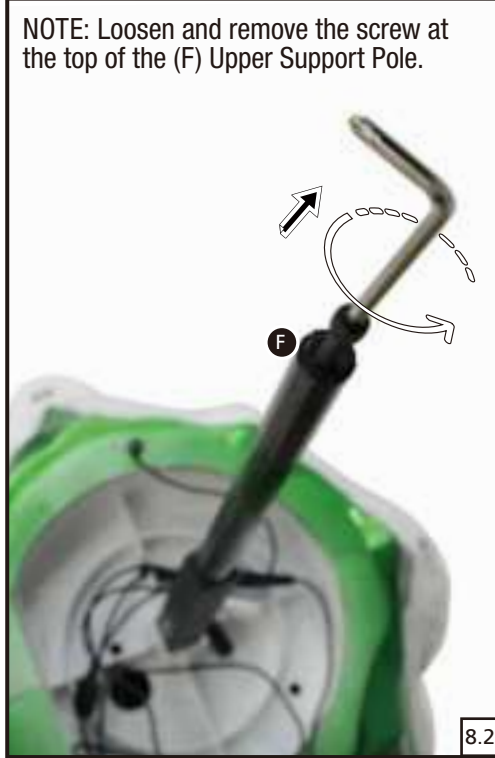
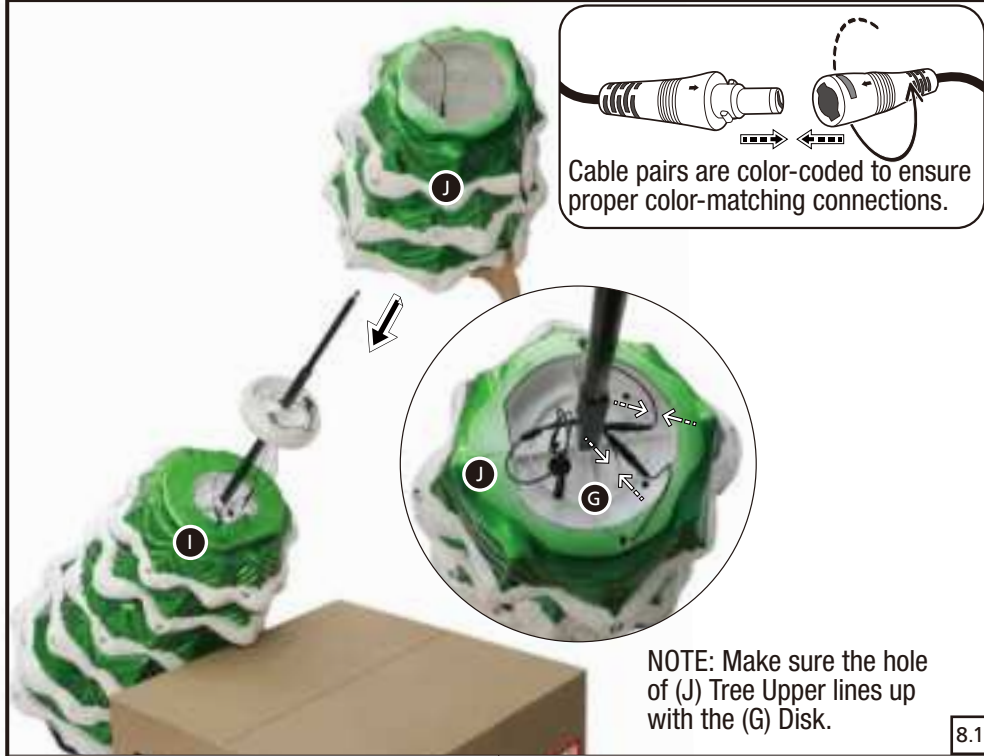
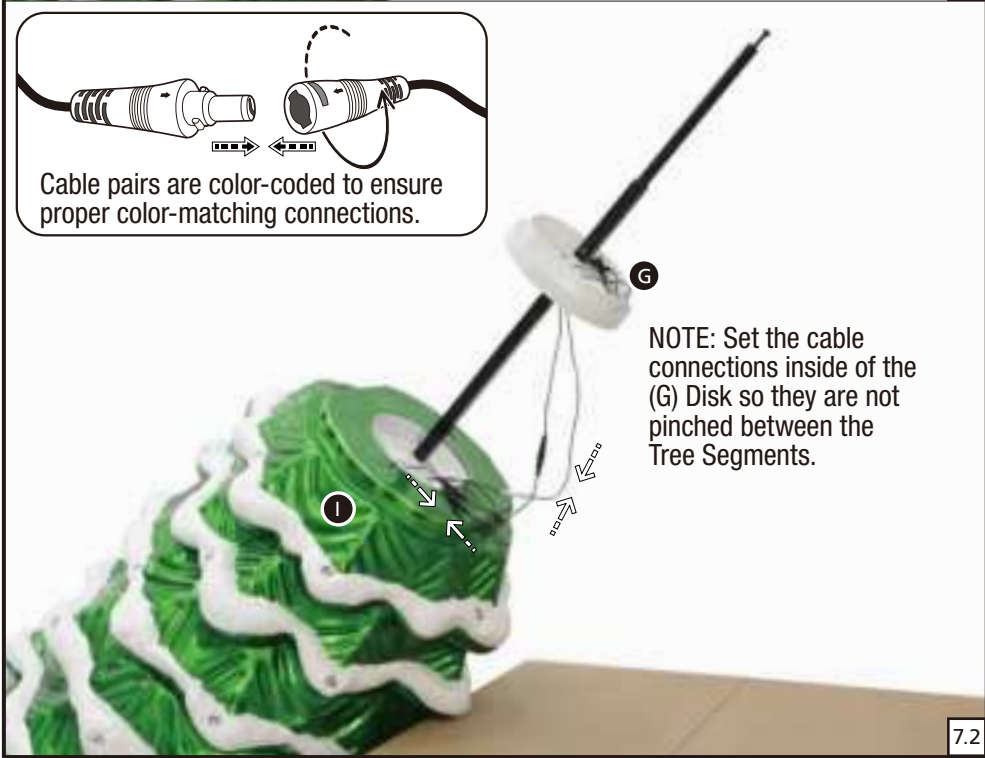
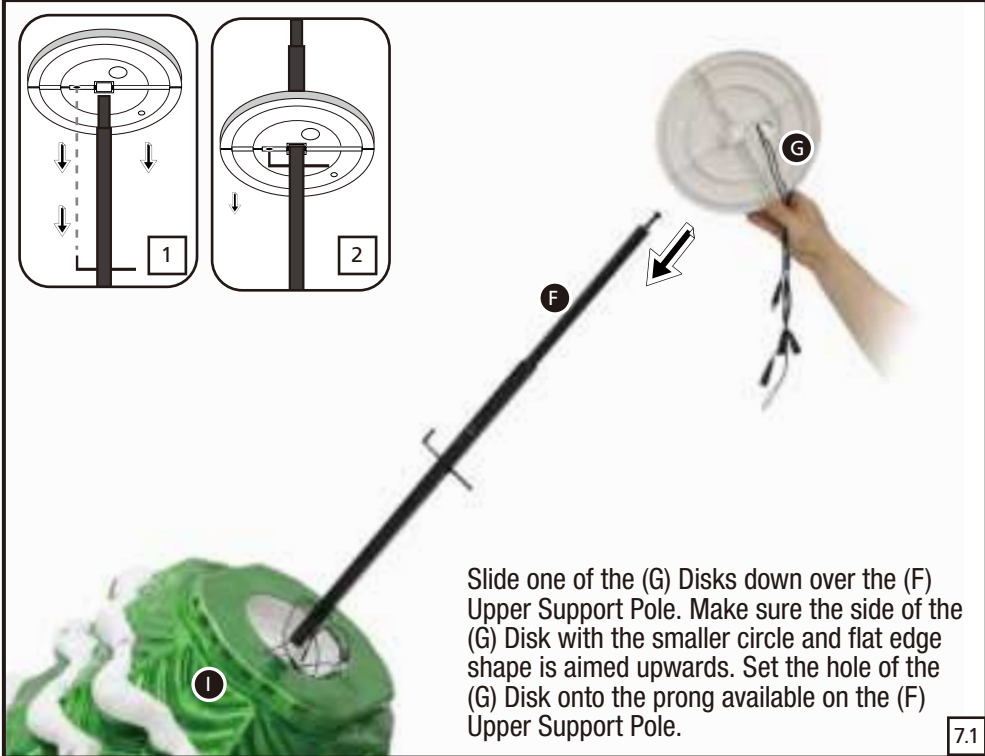

OPERATION INSTRUCTIONS:

1. Plug the power adapter into a standard power outlet and adjust the settings on the Function Control Box, located on the (H) Body, as desired.
2. Settings:

ON / MARCHE / ENCENDER	This switch mode will continuously operate the lights of the item.
TIMER / MINUTEUR / TEMPORIZADOR	In this mode, the lights of the item are activated for a 6 hour period and then deactivated for an 18 hour period. This cycle continues indefinitely until the setting is changed.
OFF / ARRÊT / APAGAR	This switch mode allows the item to be activated only if triggered by using a Step Pad or Try Me Button (Not Included). The item will operate for one activity cycle with each Step Pad or Try Me activation. Otherwise, the item will stay off.
LED MODE/ MODE LED/ MODO LED	Light Functions: Warm White Steady, Warm White Flashing, Warm White Slow Fade, Multi Steady, Multi Flashing, Multi Slow Fade, Warm White/Multi Alternating and Warm White/Multi Slow Fade

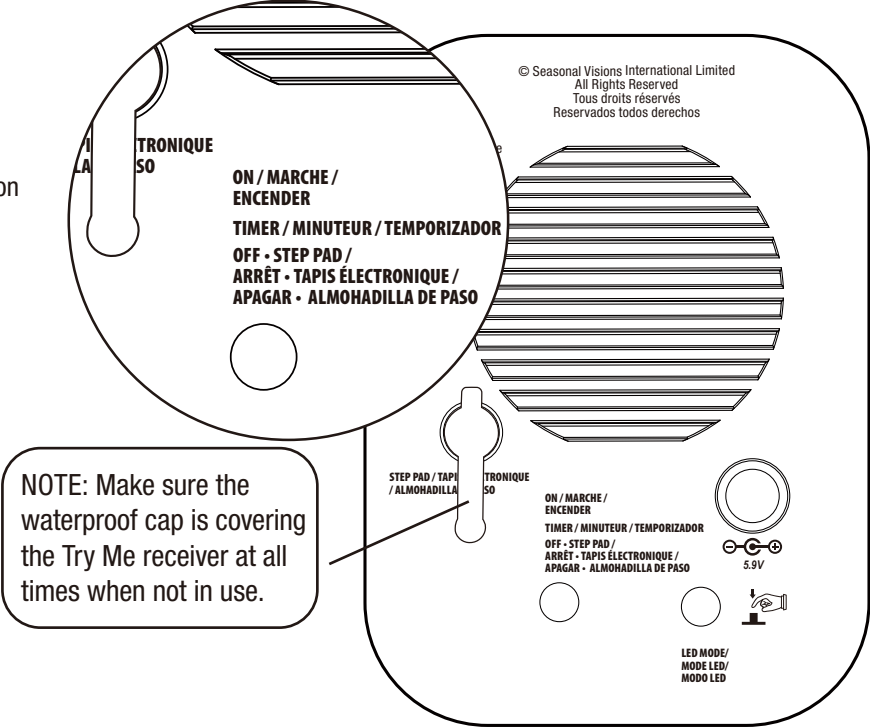

Button	Function Description	
ON	Switches Tree Lights On.	
OFF	Switches Tree Lights OFF. Also allows the item to be activated by using a Step Pad or Try Me Button (Not Included). The item will operate for one activity cycle with each Step Pad or Try Me activation. Otherwise, the item will stay off.	
FN	Toggles the function to the next light mode, listed below.	
Demo	Switches through all different light modes, showing each for 10 seconds.	
	WW Steady (Warm White Steady) WW Slow Fade (Warm White Slow Fade) MLT Flashing (Multi Flashing) WW MLT SEQ (Warm White/Multi Alternating)	WW Flashing (Warm White Flashing) MLT Steady (Multi Steady) MLT Slow Fade (Multi Slow Fade) WW MLT CC (Warm White/Multi Slow Fade)

This Remote Control allows one to change the settings of the 8.5 ft Giant-Sized Color Changing LED Tree from up to 20 ft away. The Remote Control has an indicator light that lets you know if its working.

NOTE: TIMER setting can only be chosen from the 8.5 ft Giant-Sized Color Changing LED Tree Control Panel, not with Remote Control.

NOTE: Requires 2 x 1.5V AAA batteries (Included)
* You will need a small Phillips head screwdriver (Not included).
Locate the battery compartment on the product. Remove the battery compartment cover by using a small Phillips head screwdriver to unscrew the screw. After removing or installing the batteries, place the battery compartment cover into position, and secure the battery cover. If 8.5 ft Giant-Sized Color Changing LED Tree is being stored while not in use, please remove battery in Remote Control.

CARE AND STORAGE INSTRUCTIONS

When not in use, store this product in its original packing. Keep away from heat and moisture.

This device contains licence-exempt transmitter(s)/receiver(s) that comply with Innovation, Science and Economic Development Canada's licence-exempt RSS(s).Operation is subject to the following two conditions:

1. This device may not cause interference.
2. This device must accept any interference, including interference that may cause undesired operation of the device.

This device complies with Part 15 of the FCC Rules. Operation is subject to the following two conditions: (1) This device may not cause harmful interference, and (2) this device must accept any interference received, including interference that may cause undesired operation.

CAUTION: Changes or modifications not expressly approved by the party responsible for compliance could void the user's authority to operate the equipment.

NOTE: This equipment has been tested and found to comply with the limits for a Class B digital device, pursuant to Part 15 of the FCC Rules. These limits are designed to provide reasonable protection against harmful interference in a residential installation. This equipment generates, uses and can radiate radio frequency energy and, if not installed and used in accordance with the instructions, may cause harmful interference to radio or television reception, which can be determined by turning the equipment off and on, the user is encouraged to try to correct the interference by one or more of the following measures: Reorient or relocate the receiving antenna, Increase the separation between the equipment and receiver. Connect the equipment into an outlet on a circuit different from that to which the receiver is connected. Consult the dealer or an experienced radio/TV technician for help.

CAN ICES-003(B)/NMB-003(B)



Questions, problems, missing parts? Before returning to the store, please have a copy of your receipt ready and email the SVI customer experience team (customerservice@svius.com) within 90 days of the date of purchase or call Home Accents Holiday Customer Service 8 a.m. - 7 p.m., EST, Monday - Friday, 9 a.m. - 6 p.m., EST, Saturday

1-855-HD-HOLIDAY(1-855-434-6543)
HOMEDEPOT.COM