

# INSTRUCTIONS

MULTIFUNCTIONAL SOFA MUSIC SYSTEM(BLUETOOTH/USB/AUX)WITH TOUCH BUTTONS

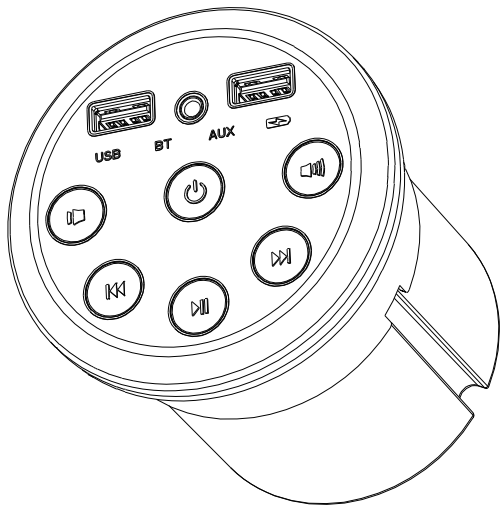

## SF-003

Please read carefully this user manual before  
operating the sofa music system

## Features

Thank you, our distinguished customer, for choosing the latest generation of multi-functional sofa music system, which enables automatic switching from one mode to another (BLUETOOTH/USB /AUX), with the perfect touch buttons plus a strong 2.1bass amp, with good sound quality and beautiful appearance. We sincerely hope that it could give you an extraordinary experience of enjoying the music at this digital age.

### The main functions:

USB: USB interface supports playing music on Flash disk, Android phones with OTG function, IPHONE and IPAD via USB cable.

AUX: supports playing music on mobile phone, computer, television and other audio input via AUX cable.

 : Supports mobile phone charging, Apple Android

### Precautions:

Before use, please read the instructions to ensure proper use of this product. For better service, the customer's product performance

specifications are subject to change, and the content of this manual may also be updated without further notice. To maintain good performance of the product, do not use it in too cold, too hot, dusty or humid environments.

## Control Panel

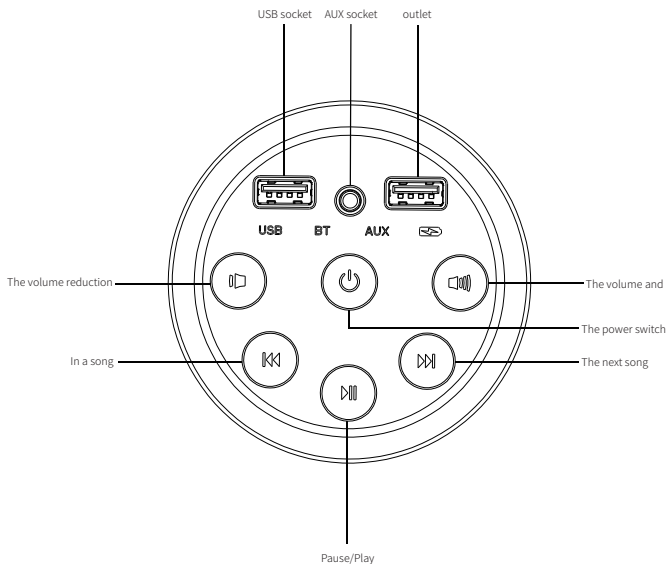

## INSTALLATION GUIDE

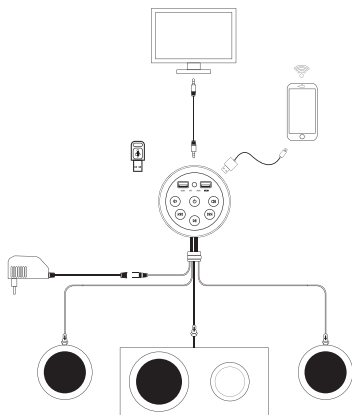

## HOW TO USE

### Bluetooth mode:

Bluetooth mode is set as default mode for playing music when the sofa music system is turned on (touch the “Power” button till the indicator light turns from red to blue) and Bluetooth indicator light “BT” is shining. First search the Bluetooth

device list in mobile phone, and click to connect "SF003", the name of the sofa music system, and the indicator light "BT". Then it is ready to play music from the mobile phone.

### **USB mode:**

When insert a USB device (Flash disk, or IPHONE, IPAD, Android phone with OTG function via USB cable) "USB" indicator light is on, and the play mode will automatically switch to USB mode, scanning USB devices and automatically play music files.

### **AUX mode:**

When insert the 3.5mm audio cable to the AUX connector, it will automatically switch to the AUX mode, and "AUX" indicator light is on. And it's ready to play music from phone, TV, and computer. In this mode, only the Volume+ and Volume- and Play/Pause buttons could be operated from the control panel of the device.



It can be plugged into a USB head cable to charge mobile devices, Apple and Android.

## **Specifications**

Power input:15.0V/2.4A

Frequency response:50HZ-20KHZ

SNR:≥60db

Maximum output power for 2+1 speakers:15W\*2+30W

Speaker Impedance:4 ohms

Adjustment forms:Touch button for Power switch/automatic mode switch/Volume adjustment/Previous and Next song switch

Bluetooth Distance:>10 m in open areas

Bluetooth transmitting frequency:2.4G

USB function:Support playing music on Android with OTG function/ IPHONE/IPAD/Flash disk and charging mobile phone via USB cable.

## Maintenance and Troubleshooting Guides

Before you think to repair the sofa music system for problems, please check first the following FAQ and troubleshooting guides to find the possible causes of the problem you are experiencing. Some simple checks

nimum adjustment you make is likely to solve the problem and restore normal operation of the device. If you have some points in doubt, or cannot resolve the problem, please turn to professional maintenance personnel for solution.

| FAQ   | Troubleshooting Guides  |
|---|---|
| In the mode of USB, not able to play music on iPhone/iPod                 | The version of iPhone/iPod is old, not the latest, thus it cannot play music automatically for the first time connection. You could try to play music manually, and from the second time, it could play music automatically once connected via USB cable.   |
| In the mode of USB, not able to play music on Android system mobile phone | Please make sure your Android phone supports OTG function, or it could be the Android version being old, not the latest. Please confirm it's Android 4.3 or above.  |
| No sound  | Please check whether it's the speaker's volume being too low or they are not correctly connected. If the problem still exists after checking the music system is all connected in correct form, the speakers need to be replaced.   |
| Not able to turn on the device  | The power supply is not plugged in correctly. If you confirm there is something wrong with the power supply, it needs to be replaced.<br>Or if the power supply is in good condition, then it's likely that there is a problem with the device, it would have to be replaced.   |
| No response the device  | Please unplug and plug the power supply and try again. iPhone/iPod/Android phone/USB/AUX is not plugged in correctly.   |
| Touch button does not work  | Please do not press too hard on the touch button and check whether there is any obstacle or water on top of the button, and try to unplug and plug the power supply and try again.  |
| In mode of Bluetooth not able to connect the device to the music system   | Please turn off the Bluetooth connection of the device like iPhone/iPad/Android phone etc (within the connecting distance) that has been already connected to the music system, and then turn on the Bluetooth of the other device that you want to connect to the music system, and search "MS003", the name of the music system and click to connect it. Please make sure the connecting distance is within 10 meters, and avoid the wall and the corner. |

## FCC Statement

This equipment has been tested and found to comply with the limits for a Class B digital device, pursuant to Part 15 of the FCC Rules. These limits are designed to provide reasonable protection against harmful interference in a residential installation. This equipment generates uses and can radiate radio frequency energy and, if not installed and used in accordance with the instructions, may cause harmful interference to radio communications. However, there is no guarantee that interference will not occur in a particular installation. If this equipment does cause harmful interference to radio or television reception, which can be determined by turning the equipment off and on, the user is encouraged to try to correct the interference by one or more of the following measures:

- Reorient or relocate the receiving antenna.
- Increase the separation between the equipment and receiver.
- Connect the equipment into an outlet on a circuit different from that to which the receiver is connected.
- Consult the dealer or an experienced radio/TV technician for help.



This device complies with part 15 of the FCC Rules. Operation is subject to the following two conditions:

(1) This device may not cause harmful interference, and (2) this device must accept any interference received, including interference that may cause undesired operation.

Changes or modifications not expressly approved by the party responsible for compliance could void the user's authority to operate the equipment.