

User Manual  
WIRELESS ACTIVITY ATTACKER  
Model name:BLE20  
FCC ID: ZG8BLE20

## 1.0 Product Introduction:

WIRELESS ACTIVITY ATTACKER is the bracelet built-in smart system, through the mobile phone APP for BT system connected to the network, via wearable electronic equipment function of various types of sensors, can realize the step counting function, anti-lose function, call / SMS reminder, alarm clock and sleep quality control function

## 2.0 Appearance:

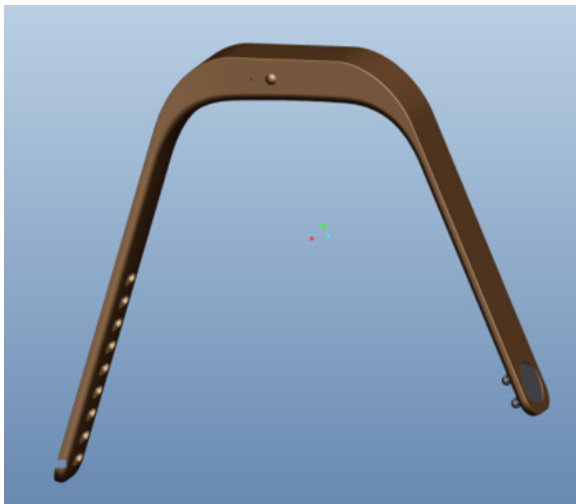

---

### 3.Product Basic Information

Name:	WIRELESS ACTIVITY ATTACKER
Model No:	BLE20
Size of product:	L:107.8 * W:15.5* H:125.2
Size of inside cabinet:	L:37 * W:12.5* H:8.5
Weight:	TBD
Material:	ABS+silicone (wristband)
Button:	one confirm button
Battery:	25mAH/ Lithium polymer battery
vibrating motor	φ 8*3
Charge port:	standard USB port
LED	red&green flashes LED
Vibration sensor	Freescale MMA955xL
Bluetooth version:	CSR1012
Distance:	10 meters
Standby time:	12days
Talk time:	10H
Charge time:	1~1.5H

### 4.Using the interface definition

#### APP:

Download app: Open mobile phone camera to scan two-dimensional code which was on the product packaging , save the file in the link and install it after scanning successful

Start: Install the APP in the mobile phone, click the APP on the mobile phone after startup the smart bracelet, and then run the app.

Search: click the button on the top of left side, select "Settings" in the column, and then select the Bluetooth connection, Bluetooth will be access device searching status.

Online: searched to the corresponding equipment and then click the device name that can be connected into the online status

Exit: click two times the return key, quit to the interface

---

**The specific operation as follows:**

Step counting	Press the confirm button two times, then began to take the initiative to step function, press two times confirm button for the termination step. In the step counting process, can display that how long you spent, how much calories was burned, speed and sport distance, also can check the historical data.
Reminding function	when paired successfully with the mobile phone, The smart bracelet will be vibrated for 1 second of three times to remind when incoming call. The motor will be vibrated 0.5 seconds to remind when there is a message.
Sleep quality monitoring function	Press the confirm button and hold it for 2-3 seconds into sleep mode, Can be check the sleep quality by APP after wake up .
Anti-lose function	The smart bracelet will be vibrated to alarm you when the bracelet was out off the distance of the mobile phone .It will be vibrated for 10 seconds until press confirm button. or return to the effective distance; The mobile phone is ringing to remind you at the same time when out off the distance.
Alarm reminding	When to be the setted time, The smart bracelet will be vibrated lasts 5 sec interval seconds to reminding, until press confirm button to end it
LED	Display “charging /full charged”. The LED is red when in charging, The LED turns green when full charged.
Charging	USB plug into the charger to charge the battery

## 5. FCC Statement

This device complies with part 15 of the FCC rules. Operation is subject to the following two conditions:

- (1) this device may not cause harmful interference, and
- (2) this device must accept any interference received, including interference that may cause undesired operation.

Changes or modifications to this unit not expressly approved by the party responsible for compliance could void the user's authority to operate the equipment.