



深圳市意向互动科技有限公司
SHENZHEN ESHINE INTERACTION TECHNOLOGY CO.,LTD

ES-T6(低配版) 英文说明书

编号：WZ-RD-TZ-133

版本：V1.1

日期：2020-11-27

Solar TWS Earbuds

ES-T6



Use Manual

Product Explosion Diagram

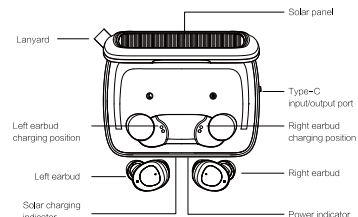

Basic Specifications

Earbud specifications

Bluetooth version: V5.0 ABRCHA	Bluetooth operating frequency: 2.402GHz~2.480GHz
Receiving distance: ≤15 m	Audio S/N: ≥95dB
Battery: Lithium battery 3.7V/55mAh	Microphone: digital silicon microphone 38dB
Charging time: earbuds 1.5H, charging case about 2H	
Talking/playing time: about 6-8 hours (the actual use time depends on the type of song and volume requirements)	
Supporting protocol: A2DP, AVRCP, SPP, HFP, HSP	

Charging case specifications:

Battery capacity: 2500mAh	Solar charging: 5.5V/0.55W
Charging port: Type-C	Charging voltage and current: 5V/2A
Discharge voltage and current: 5V/2A	Charging for Earbuds: about 20 times

Wearing

Earplug model

Three pairs of earplugs of different sizes (small, medium and large) are provided (the medium size has been installed on the earbuds, and the other pair of medium earplugs are provided as a spare), and you can replace them according to the size of your earholes, to obtain a good sound insulation effect and comfortable to wear.



Wearing direction

When the ear wing is above the main body of the earbud, the direction is the correct direction; when the ear wing is in the other direction of the earbud main body, it is the wrong way of wearing. (Take the left earbud as an example)

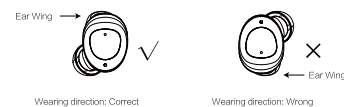

Wearing steps

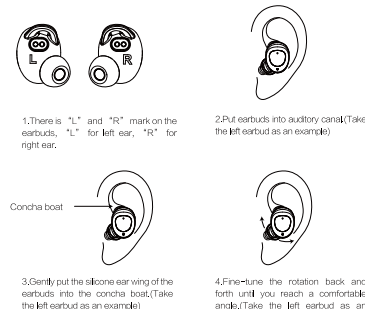

Pairing

1.Left and right earbuds automatic pairing
Take out the left and right earbuds from the charging case simultaneously, and both earbuds will automatically turn on and interconnect. After successful connection, the left earbud is in red and blue flashing lights alternately, and the blue light on the right earbud

flashes slowly. (Binaural interconnection time is 10 seconds, after more than 10 seconds, you need to restart. It is recommended to keep the dual earbuds close during interconnection to improve efficiency)

2.Earbuds pair with phone

- 1.Have the earbuds pair successfully refer to Pairing 1/2.
- 2.Turn on the Bluetooth function of phone.
- 3.Click and connect.



Tip: If the left and right earbuds indicators in blue lights flashing slowly, it successfully connected.

3.Right earbud pair with phone

- 1.Double click the power on/off button of right earbud.
- 2.Turn on the Bluetooth function of the phone, search ES-T6, click and connect.

4.Left earbud pair with phone

- 1.Double click the power on/off button of left earbud.
- 2.Turn on the Bluetooth function of the phone, search ES-T6, click and connect.

Button Function

- 1.Power ON/OFF**
Power ON: Press the left/right earbuds buttons simultaneously for about 4 seconds, (or take the earbuds out from the charging case to automatically power on)
Power OFF: Press the left/right earbuds buttons for about 6 seconds after power on. (The red and blue lights flash alternately when power on, and the red light is on for 1 second and then goes out when turned off)
- 2.Answer/Hang up the call**
Incoming call situation: single click the power on/off button of left or right earbud to answer the call.
On calling situation: single click the power on/off button of left or right earbud to hang up the call

- 3.Reject an incoming call**
Incoming call situation: press the power on/off button of left or right earbud for 3 seconds to reject the incoming call.
- 4.Play/Pause**
Under music playing situation: click the power on/off button of left or right earbud to pause/play the music.
- 5.Clear the pairing (restore the default value), manually pair the left earbud with the right earbud** (You can choose any of the following methods)
Method 1: If the automatic pairing of the left/right earbuds fail, turn off the left/right earbuds, then press and hold the left/right earbuds power-on buttons for 8 seconds. When the left/right earbuds are turned on and the red and blue lights are on, release them, the earbuds restore the default value and automatically power off, and then power on the left/right earbuds again, and then they can be paired automatically.
Method 2: If the automatic pairing of the left/right earbuds fail, press the buttons of the left/right earbuds 3 times in succession, the left/right earbuds will appear red and blue lights, the earbuds will restore the default value and automatically shut down, and then turn the left/right earbuds on again, paired successfully.
- 6.Volume button**
Press the left earbud power on/off button for 2 seconds to increase volume; press the right earbud power on/off button for 2 seconds to decrease the volume.
- 7.Previous/Next song**
Double click the left earbud power on/off button to go to previous song, double click the right earbud power on/off button to go to next song.
- 8.Wake-up function**
Tap the left earbud or right earbud button for 3 consecutive times to enter the wake-up function; such as: iPhone Siri function control; Android phones need to operate the phone wake-up function according to the voice control system of the phone (models that do not support voice control cannot operate this wake-up function).

Charging

1.Charge for base charging case

Use the charging cable included in the product box to connect the power adapter for charging.

2.Solar panel charging

When the solar panel of the product receives sunlight, the best way to receive sunlight illumination is in 45 degrees. The built-in charging circuit automatically charges the built-in battery. The solar indicator light is always green, which indicates that the solar panel is charging the battery.

3.Charge for earbuds

When ensuring that the charging case has sufficient power, put the earbuds into the corresponding place to charge. The LED indicator of the charging case lights up and displays the current battery level of the charging case.
○Charging: the red lights of the earbuds are on ○Full battery: the red lights of the earbuds are off

4. Charging case battery display

Under normal load is connected and inserted TYPE-C, which is automatically powered USB output terminal, the LED power indicator shows the power as shown in the following table; when the digital tube power display is not connected to the lead for 30 seconds, and then the display is turned off, the product will shut down and enter the standby state. To check the battery level, open the lid of the charging case to activate the battery indicator on the display.

Power	LED1	LED2	LED3	LED4
75%-100%	on	on	on	on
50%-75%	on	on	on	off
25%-50%	on	on	off	off
10%-25%	on	off	off	off
0%-10%	flash	on	off	off

5.Charging Digital Equipment

1. Connect the USB adapter to the Type-C port of the charging case, and the product starts to supply power to the USB output. At this time, connect the product and the digital device with the digital device charging cable to charge the digital product. Note: For chargers with fast charging certification, some chargers may not be able to charge the charging box. You can use the Type-C to USB adapter in the accessories to solve this problem.

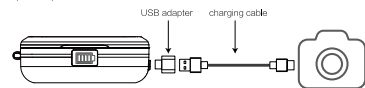

2. Connect the Type-C port cable to the Type-C port of the charging box to charge digital products and devices.

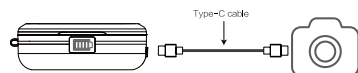

3. When the output USB port is not connected to the charging device for 30 seconds or the charging device is fully charged, the product will turn off the output and power display, and enter a low-power standby state.

Accessories Lists



User manual / 1 piece



Adapter (Type-C to USB) 1 piece

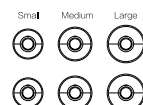

Earplug sleeve / 3 pairs



Type-C cable/1 piece

Warnings:

This product must be charged with a high-quality charging cable, and the Type-C cable is connected to a 5V (2A-3A) power supply adapter, 5V (2A-3A) car charging head, it is recommended to use a power adapter above 2A to charge the charging box of this product.
○Please pay attention to using high-quality chargers or computer ports when charging the product, and do not use cheap and inferior chargers.
○If the product fails, we will solve the problem for you in strict accordance with national regulations and the service within our capacity.
○Bluetooth products have problems with the use environment and connection distance. Please do not use them in strong electromagnetic interference and radiation environments.
○Please do not put the Bluetooth earbuds in water or drop it, these will cause damage to the product.
○If your Bluetooth earbuds is not used for a long time, please charge it once every 30 days to prevent it from being unable to start due to lack of power.
○Do not put this product under the overheating environment (such as inside the airtight car which is under great sunlight heating, Radiators, Stoves and any other equipment or devices which produce high temperature). The overheating would probably damage the product or even cause any potential threat to the safety of human life.
○The product is consisted of sophisticated electronic components, non-professionals cannot disassemble the product, to avoid accidentally hurting yourself or damaging the product.
○There are lithium-ion batteries inside the product. Please pay attention to the use under the local laws and regulations, cannot be discarded, pay attention to recycling. DO NOT put the disposal battery under the overheating environment like strong sunlight, fire or any other similar conditions.

Frequently Asked Questions

Why Bluetooth earbuds cannot be turned on ?

- 1.You can check if the earbuds are with power, if not, please charge it fully before turning it on.
- 2.Please long press power on/off button, (the exact time operation, please check the manual)

Why Bluetooth earbuds signal is not stable ?

- 1.Restart the Bluetooth earbuds.

- 2.Please kindly check the compatibility of the mobile phone and calling communication quality.
 - 3.Then confirm if the distance between earbuds and phone is too far or there is interference surrounded. If too far or there is interference, the signal will be not stable.
 - 4.Please do not stay in the signal ineffective environment.
 - 5.If try these still with problem, please change a phone to try again.
- Why the Bluetooth earbuds' s noise is so big ?**
- 1.Please kindly check the mobile phone' s noise suppression function.
 - 2.Please kindly check the Bluetooth earbuds and mobile phone' s distance is too far or not? If too far, please shorten it to try again.
 - 3.Please kindly confirm if there is an electromagnetic radiation surrounding environment.
- Why the Bluetooth earbuds can' t be heard voice?**
- 1.Please kindly check if the Bluetooth earbuds are on mute or not.
 - 2.Please kindly check if the Bluetooth earbuds and phone is connected well or not.
 - 3.Then confirm if the distance between earbuds and phone is too far or there is interference surrounded.
 - 4.Please make sure the Bluetooth earbuds is not connected with other phone or devices.
- How to charge ?**
- 1.Use the original data cable to charge, and select the appropriate voltage and current adapter according to the requirements.
 - 2.After inserting the Type-C interface, it can be fully charged in about 1.5 hours.
- If the Bluetooth earbuds can be upgraded ?**
- 1.Normally, Bluetooth cannot be upgraded, as the Bluetooth chipset is ROM chipset.
 - 2.The high-end version can carry out product software upgrade services according to the actual situation.
 - 3.Due to improper operation, the upgrade may cause product failure.
- How to connect the Bluetooth earbuds with mobile phone?**
- 1.Power on: enter the red and blue light alternately flashing pairing state.
 - 2.Turn on the phone's Bluetooth, search for Bluetooth devices, and click pair.
 - 3.If need to input the password, please input 1234 or 0000.

FCC Statement

This equipment has been tested and found to comply with the limits for a Class B digital device, pursuant to part 15 of the FCC Rules. These limits are designed to provide reasonable protection against harmful interference in a residential installation. This equipment generates, uses and can radiate radio frequency energy and, if not installed and used in accordance with the instructions, may cause harmful interference to radio communications. However, there is no guarantee that interference will not occur in a particular installation. If this equipment does cause harmful interference to radio or television reception, which can be determined by turning the equipment off and on, the user is encouraged to try to correct the interference by one or more of the following measures:

- Reorient or relocate the receiving antenna.
- Increase the separation between the equipment and receiver.
- Connect the equipment into an outlet on a circuit different from that to which the receiver is connected.
- Consult the dealer or an experienced radio/TV technician for help.

Caution: Any changes or modifications to this device not explicitly approved by manufacturer could void your authority to operate this equipment.

This device complies with part 15 of the FCC Rules. Operation is subject to the following two conditions: (1) This device may not cause harmful interference, and (2) this device must accept any interference received, including interference that may cause undesired operation.

RF Exposure Information

The device has been evaluated to meet general RF exposure requirement. The device can be used in portable exposure condition without restriction.