

Air Omni User Manual

Contents

Welcome&Intro	1
Package Includes	2
Features	3
Compatibility	4
Spec	5
LED Light Indicator.....	6
Quick Guide.....	7
Warranty	17
Exclusions & Limitations	18
Important	18
Customer Service	20
Legal	20
FCC WARNING	22

Welcome & Intro

Thank you for purchasing the PITAKA Air Omni. The Air Omni is an ultimate charging machine that is powered through DC connector. It can charge six devices simultaneously.

Package Includes

1. Air Omni *1
2. Magnetic Holder *1
3. Adapter *1
4. Document Kit *1



①



②

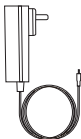

③



④

Features

- The Air Omni can charge 6 devices at the same time. Including Apple Watch wireless charger, 10W wireless charger, 18W convertible Lightning & Type-C connector, earbuds wireless charger, 18W type-C charging port, 18W Type-A charging port.
- Air Omni has a storage compartment that can rest any small accessories and jewelry.
- The adoption of both aramid fiber and zinc alloy assures the premium quality;
- Designed with over-temperature protection, over-current protection, FOD protection and short-circuit protection, the Air Omni is safe to use.

Compatibility

Wired Output	Wireless Output	Apple Watch Series
<p>Made for: iPhone 11 Pro Max, iPhone 11 Pro, iPhone 11, iPhone XS Max, iPhone XS, iPhone XR, iPhone X, iPhone 8 Plus, iPhone 8, iPhone 7 Plus, iPhone 7, iPhone SE, iPhone 6s Plus, iPhone 6s, iPhone 6 Plus, iPhone 6, iPhone 5s, iPad Pro 10.5-inch, iPad Pro 12.9-inch(2nd Generation), iPad Pro 9.7-inch, iPad Pro 12.9-inch(1st Generation), iPad mini 4, iPad Air 2, iPad mini 3, iPad Air, iPad mini 2, iPad (6th generation), iPad (5th generation), iPod touch (6th generation), AirPods 1, AirPods 2, AirPods Pro.</p> <p>Devices that meet the standards of USB-IF TYPE C and USB PD</p>	<p>Wireless devices that meet the standard of Qi1.2.4</p>	<p>Apple Watch 5, Apple Watch Series 4, Apple Watch Series 3, Apple Watch Series 2, Apple Watch Series 1, Apple Watch (1st generation).</p>

Spec

Items	Specifications
Input	15V / 4.3A
Apple Watch Wireless Output	5W
EarPods Wireless Output	5W
Wireless Output for Phone	5W / 7.5W / 10W
Wireless Charging Distance	≤8mm
Wireless Charging Efficiency	≤75%
Operating Temperature	-10 C ~30 C
Storage Temperature	-20 C ~60 C
Wireless Charging Frequency	110KHZ-205KHZ
Convertible Lightning Connector	5V/3A, 9V/2A, 12V/1.5A
Convertible Type-C Connector	5V/3A, 9V/2A, 12V/1.5A
USB-A Port Output	5V/3A, 9V/2A, 12V/1.5A
USB-C Port Output	5V/3A, 9V/2A, 12V/1.5A

LED Light Indicators (wireless output for phone)

Working Conditions	LED Indicator
Power on	The red and white indicators alternately flash for about 2 seconds, then the red light is off, and the white light is on.
Charge devices	The white light flashes once a second.
Overheat protection	The red light flashes every 0.5 seconds.
Foreign object debris	The red light is always on.
Overcurrent short circuit protection	The red light flashes every 2 seconds.
Overvoltage /Undervoltage protection	The white light flashes once a second.

Quick Guide

①

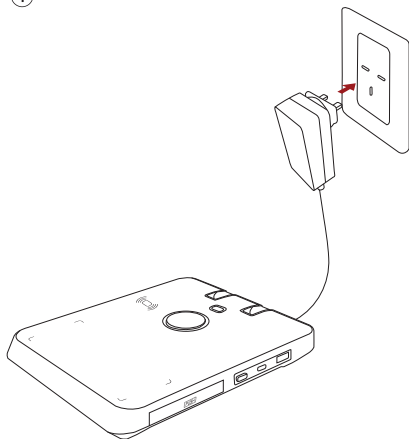

- ② Click the button to switch the Type-C & Lightning connectors.

Notice: Connectors can only be switchable when the supporting stand is folded.

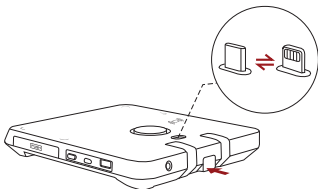

- ③

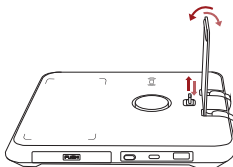

4

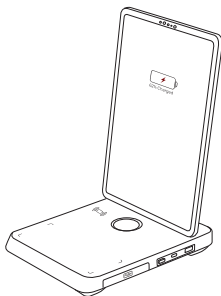

5

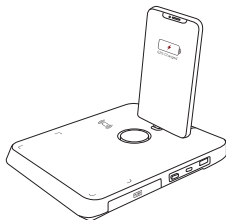

Please insert and remove your device from the connector properly to avoid human damage.

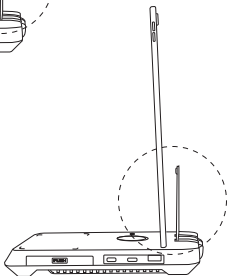
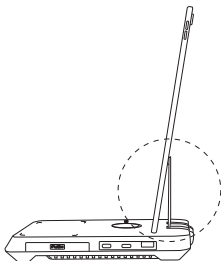

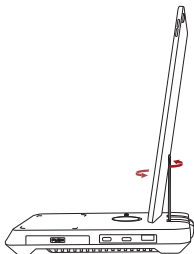
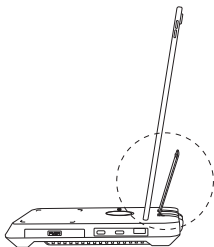

✗

⑥

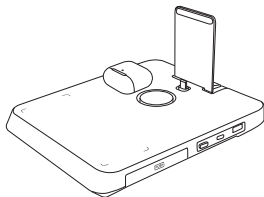

⑦

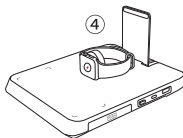
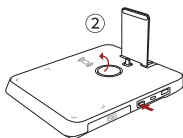
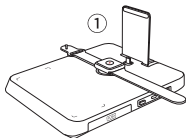

8

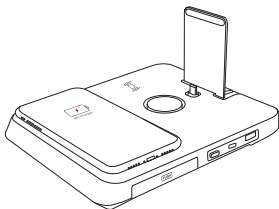

9

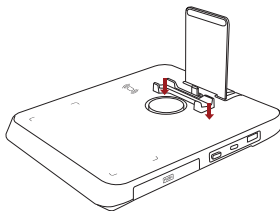

10

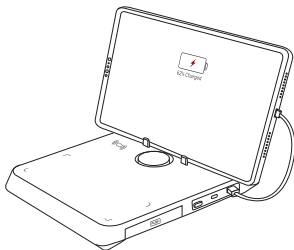

11

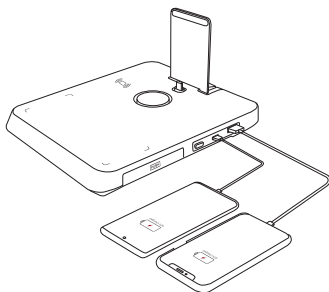

12

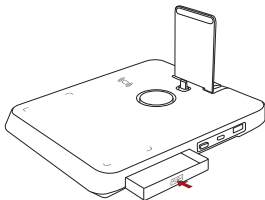

13

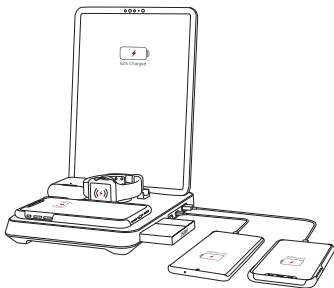



Scan QR code for video instruction.

Warranty

At PITAKA, we are always striving to provide our customers with the best quality products. The PITAKA Air Omni is warrantied for 12 months from the date of purchase.

The Air Omni is warranted to be free defects in materials and function under normal use. A defect is defined as an imperfection or flaw that is produced by a manufacturing error, including malfunction of the wireless charging or surface defects, etc.

The warranty is non-transferable and covers the original end-user purchaser. PITAKA will only authorize the warranty claim if the products were purchased from an official store or an authorized dealer. For full details regarding warranty terms and exclusions, please visit:
ipitaka.com/pages/shipping-warranty.

MODIFICATION: The warranty does not cover the damage caused by human factors, accident and misuse of the product. Any changes or modifications of this device could void the warranty.

Exclusions & Limitations

Except for the limited warranty expressly set forth or to the extent restricted or prohibited by applicable law, PITAKA expressly disclaims any other warranties express or implied, including any warranty of quality, merchant ability, or fitness for a particular purpose, and you specifically agree that PITAKA shall not be liable for any special, incidental, indirect, punitive, or consequential damages of any type on any PITAKA product. In addition to and without limiting the generality of the foregoing disclaimers, the limited warranty does not, under any circumstances, cover the replacement or cost of any electronic device or personal property inside or outside of the PITAKA product.

Important!

1. Please use the AC adapter included in the package to charge. If you are using a third-party adapter, please check and confirm whether the voltage is within the applicable range.
2. Do not keep the Air Omni in a high-temperature environment, including heat caused by intense sunlight or other forms of heat. Do not place it in fire or other excessively hot environments.

3. Do not disassemble the Air Omni or attempt to modify it in any way.
4. Do not attempt to power the Air Omni with any connection other than the Type-C connector.
5. Do not attempt to replace any part of the Air Omni.
6. All parts have gone through a thorough quality assurance inspection. If you find that your Air Omni is excessively hot, is emitting odor, is deformed, abraded or is experiencing or demonstrating an abnormal phenomenon, immediately stop all product use and contact manufacturer.
7. If this Air Omni is intended by the purchaser to be used by a minor, the purchasing adult agrees to provide detailed instructions and warnings to any minor before use. Failure to do so is the sole responsibility of the purchaser, who agrees to indemnify the manufacturer for any unintended use/misuse by a minor.

Customer Service

Tel: +852 9202 6223

Email: support@ipitaka.com

Web: www.ipitaka.com

Legal

iPhone, Apple Watch are trademarks of Apple Inc. in the US and other countries.

The 'Qi' symbol is a trademark of the Wireless Power Consortium. All associated logos and distinctive designs are the property of PITAKA and should be protected under design, trademark and other trade dress regulations.

This product is meant for use only in conjunction with the appropriate device and the steps laid out in this manual. Please consult your device packaging to determine whether this product is compatible with your particular device.

The manufacturer is not responsible for any damages to any device incurred through the use of this product. The manufacturer shall not, in any way, be liable to you or to any third party for any damages you or any third party may suffer as a result of use, intended or unintended, or misuse of this product in conjunction with any device or accessory other than the appropriate device for which this product is designed. The manufacturer will not be responsible for any damages you or any third party may suffer as a result of the misuse of this product as outlined above.

The purchaser agrees to defend, indemnify, and hold the manufacturer harmless for any claims or damages arising from unintended use or misuse, including use with an un-intended device.

The purchaser agrees to defend, indemnify, and hold the manufacturer harmless for any claims or damages arising from unintended use or misuse, including use with an un-intended device.

FCC WARNING

This device complies with part 15 of the FCC Rules. Operation is subject to the following two conditions: (1) this device may not cause harmful interference, and (2) this device must accept any interference received, including interference that may cause undesired operation.

Any changes or modifications not expressly approved by the party responsible for compliance could void the user's authority to operate the equipment.

NOTE: This equipment has been tested and found to comply with the limits for a Class B digital device, according to Part 15 of the FCC Rules. These limits are designed to provide reasonable protection against harmful interference in a residential installation. This equipment generates, uses and can radiate radio frequency energy and, if not installed and used following the instructions, may cause harmful interference to radio communications. However, there is no guarantee that interference will not occur in a particular installation.

If this equipment does cause harmful interference to radio or television reception, which can be determined by turning the equipment off and on, the user is encouraged to try to correct the interference by one or more of the following measures:

- Reorient or relocate the receiving antenna.
- Increase the separation between the equipment and receiver.
- Connect the equipment into an outlet on a circuit different from that to which the receiver is connected.
- Consult the dealer or an experienced radio/TV technician for help.

To maintain compliance with FCC' s RF Exposure guidelines, this equipment should be installed and operated with minimum distance between 20cm the radiator your body: Use only the supplied antenna.

FCC ID: 2ARI5-AO2001

