

MODEL:EMR211X
TITLE:COLOR SP.
VERSION:
REV.: 1.0 DATE: 28APR2018
REMARK: PAGE 1 OF 1
PREPARED BY: VICKY LIN/ VALENTINO CHOW
FILE:
APPROVED BY
PMGT <input type="checkbox"/>
MKTR <input type="checkbox"/>
CU <input type="checkbox"/>
DATE:

A3

IDT IDT Technology Limited

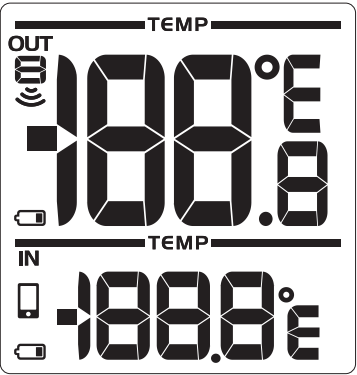

FULL SEGMENT

VA. SIZE: 47X49mm

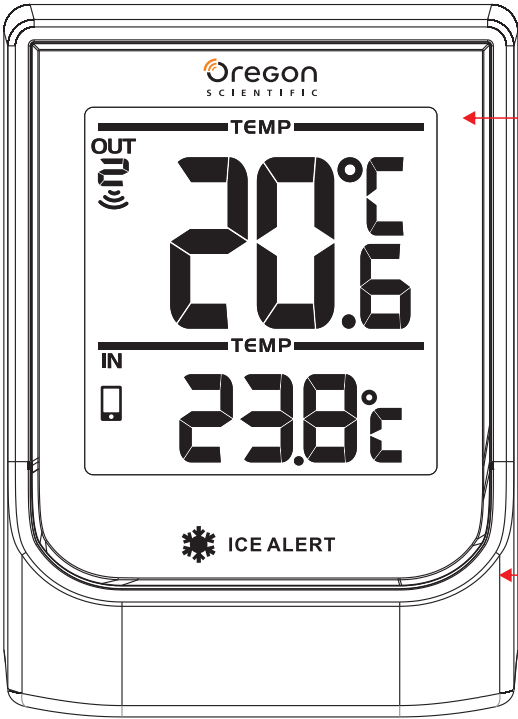
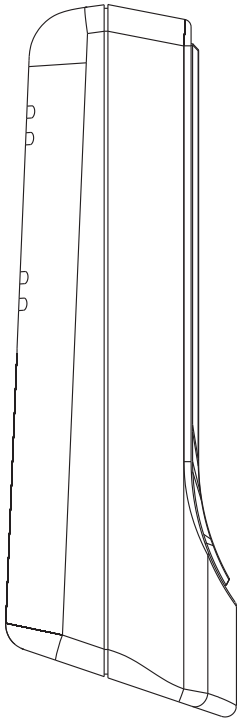

LENS-

INJ. COL: CLEAR
SPRAY COL: NIL
S/S COL ON LENS BACK:
-B/G: MG-04 (METALLIC CRAY)
-LOGO: PMS144C/ PMS427C
-❄️ICON AND TEXT ON LENS FRONT:
TRANSLUCENT WHITE
TEXTURE: HIGH GLOSSY

REAR CAB & BATT. DOOR & STAND-

INJ. COL: PROCESS BLACK C
SPRAY COL: NIL
S/S COL: PMS877C SILVER
TEXTURE: YS20001B

FRONT CAB-

INJ. COL: PROCESS BLACK C
SPRAY COL: NIL
S/S COL: NIL
TEXTURE: HIGH GLOSSY

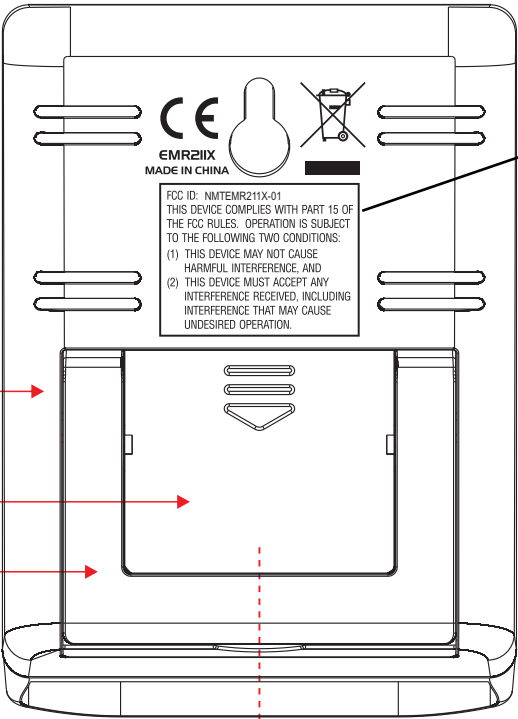

Size: 26mm * 22mm

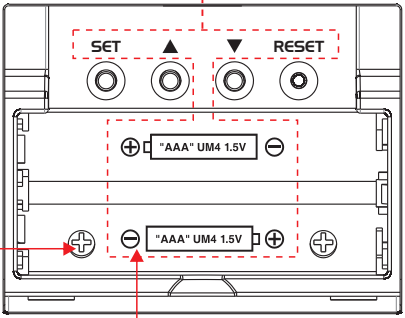

EMBOSS TEXT AND GRAPHIC
SCREW X 2- COL: BLACK