

WELCOME TO THE CHIPOLO COMMUNITY

Chipolo connects your belongings to the Chipolo app on your phone and helps you find them.

LET'S GET STARTED

- 1 Download the free Chipolo app from the App Store or Google Play Store.
- 2 Follow the easy in-app instructions to set up Chipolo.
- 3 Attach Chipolo to anything you don't want to lose.

CHIPOLO FEATURES

Did you know you can share your Chipolo with your loved ones through the Chipolo app, set up the Chipolo phone widget or change your Chipolo's ringtone?

Visit www.chipolo.net/how-it-works and learn about all the Chipolo features.

NEED HELP?

Visit our support pages at www.chipolo.net/support or contact our customer support at support@chipolo.net

Make sure that you are running the latest version of the app for this Chipolo to work.

BATTERY

This product has a replaceable CR2032 battery that will last up to 2 years. When the battery runs out you can replace it in 3 simple steps:

- 1 Use your fingernails or insert a smaller tool into the small gap on the side of the Chipolo and carefully open the device **(image A1)**
- 2 Replace the battery with a new CR2032 type battery, placing the battery positive side up **(image A2)**
- 3 Close your Chipolo by aligning the top holes on both lids **(image A3)**

Please use only the specified CR2032 battery type.

NOTE: Changes or modifications not expressly approved by the party responsible for compliance could void the user's authority to operate the equipment.

A1

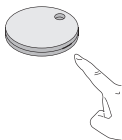

A2

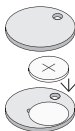

A3

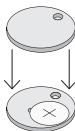

REQUIREMENTS

List of supported devices available at www.chipolo.net/devices

SPECIFICATIONS

Range: up to 60 m (200 ft) - line of sight

Temperature range: -15 °C to +50 °C (5 °F to 122 °F)

Modulation method: GFSK

Antenna power: < 1 mW

Operating frequency band: 2402-2480 MHz

WARNING

Do not ingest battery, Chemical Burn Hazard. This product contains a coin battery. If the coin battery is swallowed, it can cause severe internal burns in just 2 hours and can lead to death. Keep new and used batteries away from Children.

If the battery compartment does not close securely, stop using the product and keep it away from children. If you think batteries might have been swallowed or placed inside any part of the body, seek immediate medical attention.

This product is not a toy or edible. Mobile device casings can interfere with signal strength and decrease Chipolo's visibility. Large metal parts near your mobile devices and your Chipolo can interfere with the Bluetooth signal. Caution! Lithium battery inside. Risk of explosion in case of incorrect use. Please do not expose the product to a direct heat source. Please do not expose the product to any mechanical stress or impact. Do not attempt to disassemble your Chipolo. You run the risk of electric shock and voiding your warranty. Tips for the most efficient usage can be found at www.chipolo.net/faqs

WARRANTY

2 years

DECLARATION OF CONFORMITY

This product is compliant with CE and FCC directives.

This device complies with Part 15 of the FCC Rules and with Industry Canada licence-exempt RSS standard(s). Operation is subject to the following two conditions:

1. This device may not cause harmful interference, and
2. This device must accept any interference received, including interference that may cause undesired operation.

The relevant Declaration of Conformity is available at www.chipolo.net/regulatory. Any changes or modifications not expressly approved by the party responsible for compliance, may void the authorization to operate this equipment. This device complies with the RF exposure SAR test exclusion requirements for portable devices, if a minimum separation distance of 5 mm is kept. However, the device shall be used in such a manner that the potential for human contact during normal operation is minimized.

NOTE: This equipment has been tested and found to comply with the limits for a Class A digital device, pursuant to part 15 of the FCC Rules. These limits are designed to provide reasonable protection against harmful interference when the equipment is operated in a commercial environment. This equipment generates, uses, and can radiate radio frequency energy and, if not installed and used in accordance with the instruction manual, may cause harmful interference to radio communications. Operation of this equipment in a residential area is likely to cause harmful interference in which case the user will be required to correct the interference at his own expense.

WEEE DIRECTIVE & PRODUCT DISPOSAL

At the end of its service life, this product should not be treated as household or general waste. It should be handed over to the applicable collection point for recycling of electrical and electronic equipment or returned to the supplier for disposal.