

Description of E-Label on the ZNFG820UM for Carrier A

❖ FCC ID is applied by E-Label on the device

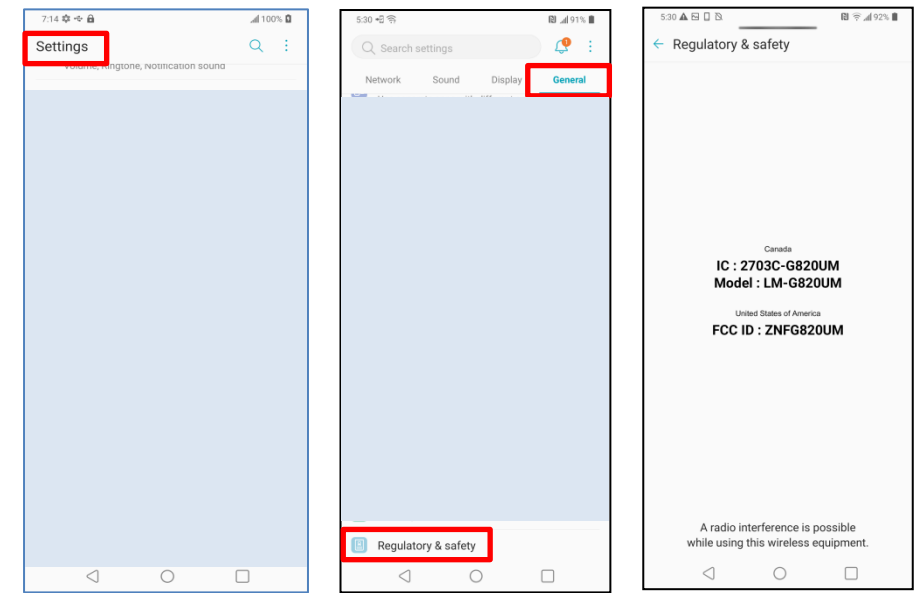

Settings Menu	
Step 1	Select "Setting"
Step 2	Select "General"
Step 3	Select "Regulatory & safety"

❖ FCC ID is applied on packaging Label

FCC ID: ZNFG820UM

❖ Instruction of E-Label on the user manual

Regulatory information (FCC ID number, etc.)

For regulatory details, go to **Settings > General > Regulatory & Safety**.

Description of E-Label on the ZNFG820UM for Carrier B

❖ FCC ID is applied by E-Label on the device

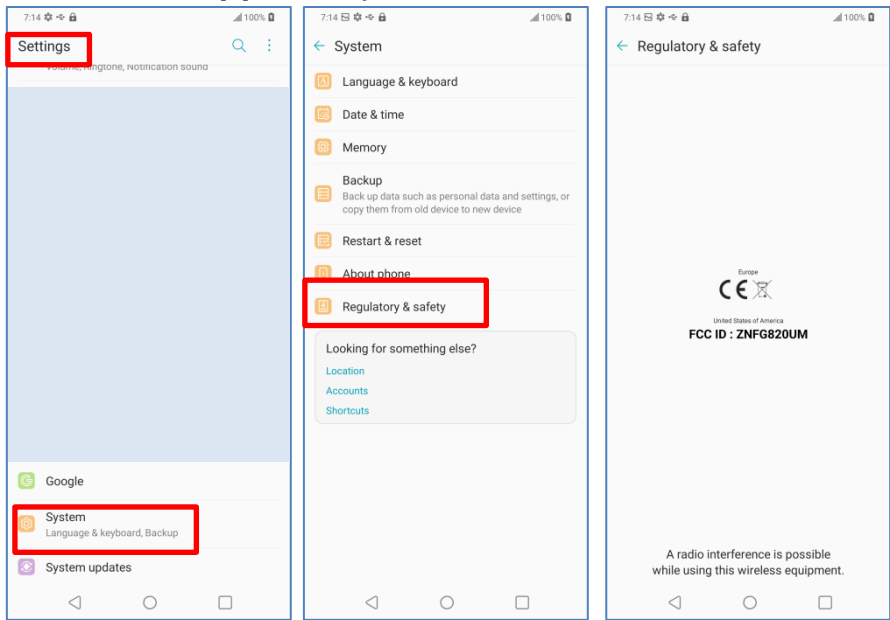

Settings Menu	
Step 1	Select "Setting"
Step 2	Select "System"
Step 3	Select "Regulatory & safety"

❖ FCC ID is applied on packaging Label

FCC ID: ZNFG820UM

❖ Instruction of E-Label on the user manual

Regulatory Information (FCC ID number, etc.)

For regulatory details, go to **Settings** > **System** > **Regulatory & Safety**.