

DOGSPLAY

Quick Start Guide

World first Interactive TV for Pet



Copyright

The contents of this manual are subject to change without prior notice for performance improvement.

© 2023 Sunny Wave Tech Co., Ltd.

The copyright of this manual belongs to Sunny Wave Tech Co., Ltd.

Unauthorized use or reproduction of part or all of the contents of this manual without prior permission is prohibited.

All trademarks are the property of their respective owners.

Model Name	DPT156G101BL
Description	Q-Guide
language	ENG

Index

Check Product Components.....	5
Components.....	5
Operation Method	9
Remote Control	9
Inserting Battery.....	10
Network Configuration	11
Initial Setup.....	11
Connect to a network	12
What if you can't connect to the network?	13
Install Mobile App	14
Adaptation guide for companion animals	15
FAQ	16
Caution	17
Specification	18
Assembly Instructions for Extension Leg	19
Warranty Certificate	20

Please read the instructions carefully before starting.

1. Remote Control Batteries (p.10)

Please note that the remote control battery may not be included due to shipping conditions. Please check the needed battery information and purchase them from the nearby store.

Information
of Battery

Model No. : CR 2032



2. Free Voltage Plug Type (p.11)

Since the terminal plug is connected to the power adapter is a Free Voltage Type, you may use a separate conversion adapter before using.

(Example)



3. Wi-Fi Setting for Mobile App Connection (p.12,14)

Both Dogsplay and mobile app should be connected to the same Wi-Fi when linking both devices for the first time.

4. How to play Dogflix content

When playing content, select the content from the [Dogflix] > [Playlist] menu and play it. Please download new contents on the [home] menu.

Check Product Components

GL

If any items are missing, please contact us at dogsplay.cs@sunnywt.com.

Components

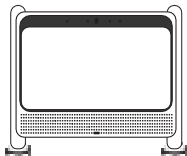

DOGSPLAY TV



Remote Control



Non-Slip Feet



Adapter



User Quick Guide

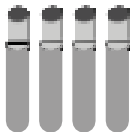

[Accessory]
Please refer to page 5
for the joining method

Note : If the plug does not fit into the socket, you can acquire a separate adapter plug to facilitate its use.

※ Extension legs will be shipped separately only for those who purchased them

Check Product Components

GL

Assemble the product's main body by attaching four feet.

1. Check the alignment holes on the bottom of the product and the top of the foot.
2. Assemble by aligning the two holes to meet and connect
If you hear a click sound, it is properly inserted in the correct direction.
3. Attach all four feet to ensure a level surface.

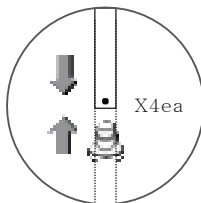
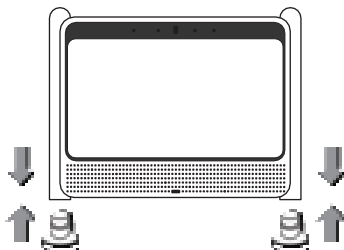

Note : If you have purchased the Extension Leg separately, please refer to page 18 for assembly instructions

Check Product Components

Front

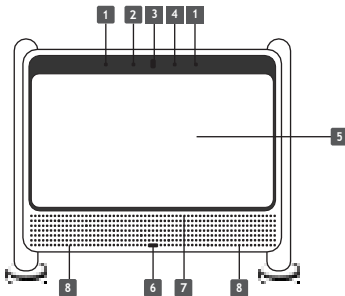

1. Mic: Receives voice input.

2. IR Receiver : Receives signals from the remote control.

3. Camera : Used for essential functions such as video calls and home cam.

4. LED Lamp : Indicates product status.

(The red LED illuminates when plugged in, and the blue LED turns on when the power is active.)

5. LCD Monitor : Features a 15.6-inch LCD screen.

6. Motion Sensor : Detects proximity and object movement.

7. Wide-range Speaker (Dog Speaker) : Produces high-frequency audio output (up to ~40KHz).

8. Standard Speaker : Delivers regular sound output.

Note : The image may differ from the actual product.

Rear & Connections

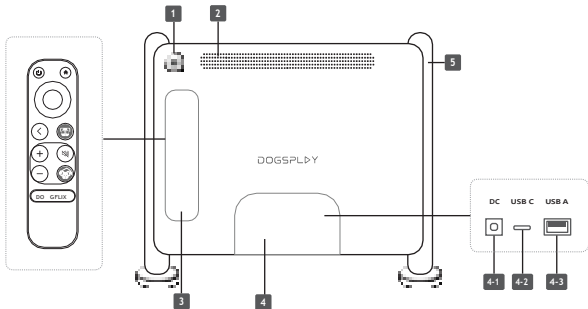

1. **Power** : Used to turn the device on or off.
2. **Ventilation** : Ensures optimal cooling to prevent overheating.
3. **Remote Control Attachment Area** : Easily attach the remote control with a magnet.
4. **Connections : Concealed cable connections, including:**
 - 4-1. **DC port**: Use this port to connect the power cable for Dogsplay operation.
 - 4-2. **USB port (C-type)**: Connect external devices like USB drives and external hard drives.
 - 4-3. **USB port (A-type)**: Connect external devices like USB drives and external hard drives.

Note : The image may differ from the actual product.

Remote Control

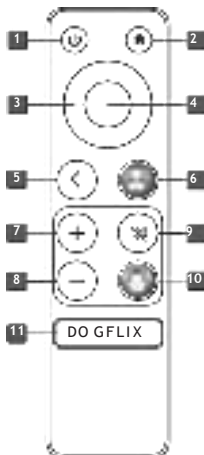

1.		Power on or off
2.		Move to home screen
3.		Move up/down/left/right
4.		Confirm the selection
5.		Return to the previous screen
6.		Dogfilter on or off Can be used to operate both Dogflix and My Media on the display screen. (My Media is available only when USB is inserted)
7/8.		Change the speaker volume (Press and change the dogspeaker volume)
9.		Mute audio (Press and mute dogspeaker volume)
10.		Dogspeaker on or off (Can use with 7,8,9)
11.		Display the Dogflix

Note: The image may differ from the actual product.

Inserting Battery

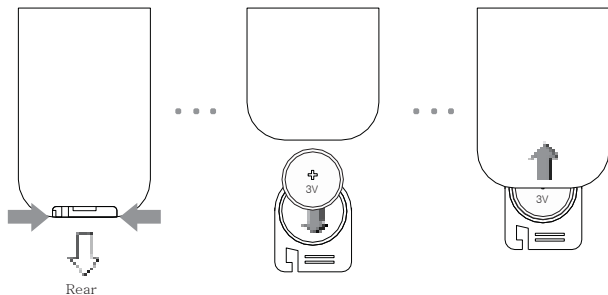

Information of Battery	
	Model No. : CR 2032

※ Please note that the remote control battery may not be included due to shipping conditions. You can purchase it at a nearby convenience store, supermarket, or online marketplace if needed

Initial Setup

1. Connect the adapter to the DC port (4-1) on the rear panel and then connect to the outlet.

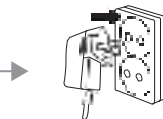
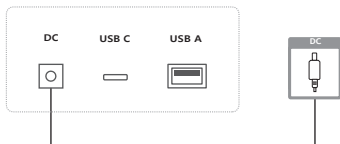

※ Adapters are provided in different types for each country

2. When the adapter is connected, the product automatically turns on.
(May take up to 3 minutes) After connecting the adapter, you can turn the power on/off in the following ways.

After connecting the adaptor.



Power button on the product

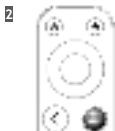

Power button on the remote control

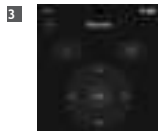

After connecting the app,
Power on or off through
the Remote function

Connect to a network

3. Select language and regional time.

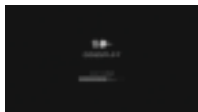

4. Connect to a Wi-Fi

Connecting to a wireless network (Wi-Fi)

First, check whether the network name (SSID) and security key of the wireless router have been set, and then connect. You can check the network name (SSID) and security key on the setting screen of the wireless router. For more details please refer to the user manual of the wireless router.

Select a network on the Wi-Fi setting screen and if you have a security key, enter it to connect.



Router

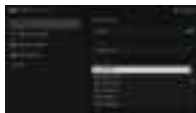

TV Wi-Fi setting screen



If Dogsplay isn't connected to a network, the mobile app won't work and you won't be able to use remote services such as home cam and video calling.

Caution: Network connection might be unstable under certain kind of conditions.

If the issue persists, please contact our support at dogsplay.cs@sunnywt.com.

What if you can't connect to the network?

Click [Skip] on the network setting to enter the home screen.

After the initial setting, go to [] at the top right of the home screen > [] > check available networks and connect them.

Menu	When network connection is successful		When network connection fails
	Mobile App Integration	No Mobile App Integration	
Content Playback (Dogflix, Dogmusic, Dogphoto)	✓	✓	✓
Content Update (Dogflix, Dogmusic, Dogphoto)	✓	✓	✗
Content Download (Dogflix)	✓	✓	✗
Content Remote Playback (Dogflix/Dogmusic)	✓	✗	✗
App Remote Control	✓	✗	✗
Home Cam	✓	✗	✗
Video Call	✓	✗	✗

* If Dogsplay is not connected to the network, only basic contents can be played.

After establishing a network connection, please proceed to pair with the Dogsplay mobile app, download the content and enjoy both the contents as well as all remote functions it offers.

Install Mobile App

Search for 'Dogsplay' in Google Play Store, Apple Store, or use the QR code below to download the Dogsplay app.



Connect Dogsplay to the mobile app



Connect your mobile to the same network as the network that Dogsplay is connected to.

1. Sign up/log in on the Dogsplay mobile app to access.
2. Click the  Nonconnect button on the main screen of the mobile app.
3. Connect to nearby Dogsplay device.
4. Enter the 4-digit code displayed on the Dogsplay screen.

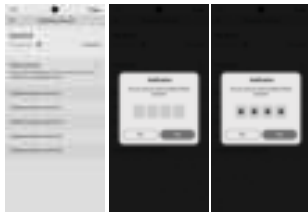

Note: If the connection continues to fail with an unknown error, please contact dogsplay.
cs@sunnywt.com

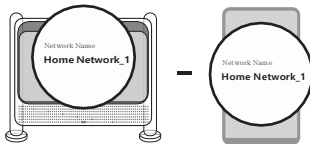

Adaptation guide for companion animals

GL

Some dogs may need up to three months to adjust to their new features.



1. Watch together with your dog whenever possible.

→ Watch together with your canine companion and let them get familiar with the product.

Over time, your pet will become more comfortable and at ease with Dogsplay.

2. Communicate in short words and calm tone.

→ Note that it may differ from in-person interaction.

Speak calmly and slowly to ensure your dog doesn't get startled.



3. Place clothing or socks with your scent near Dogsplay.

→ Most dogs may initially find it odd when they hear a voice coming from a distance, running to the door thinking their owner is somewhere unusual.

Leaving items that has your scent around Dogsplay will help them get used to it.

What is a Dogfliter?

Dogfliter is a patented technology of Dogsplay that is optimized to visual system of dogs with red-green color blindness, malignant myopia, and high moving vision.

Is it different from what is shown on normal TV?

Normal TV, which people watch, can't rectify the color and malignant myopia perfectly for dogs. So, it is still shown unclear and blurry.

What are the advantages of wide range speaker?

Dogs possess six times as many ear muscles as humans, and their hearing is highly developed. This not only piques their interest but also provides safe and varied stimulation. Unlike regular TVs, Dogsplay has the capability to emit ultrasonic waves, as it is built-in.

What is a motion sensor?

This sensor enables the product to activate when the dog approaches, even if the guardian hasn't initiated it. By default, it is set to OFF, and if you wish to utilize it, you can directly configure the distance, reaction time, and sensor usage duration through the device.

Is Dogflix content different from other dog-friendly content?

Yes. Dogflix content utilizes patented 'Dogfliter' technology that is optimized to be easily visible to dogs. This enhances the viewing experience for dogs, making it more engaging and captivating

My dog doesn't watch Dogflix.

To help them become more familiar and interested, please refer to the adaptation guide on the previous page.

1. Power Supply

- Do not use a damaged power adapter, as it can lead to electric shock and even fire.
- Do not use multiple products in a single outlet simultaneously.
Overheating of the outlet may result in a fire hazard.

2. Product Placement

- Avoid placing candles, cigarettes, mosquito repellents, or any heat sources on the product, as this may result in product malfunction or fire.
- Do not install the product in an excessively poorly ventilated area, as it could lead to internal overheating and malfunction.
- Refrain from using the product in a shaky or elevated location, as significant impacts may cause malfunction or fire.
- Do not position the product in direct sunlight or near hot objects, as this could shorten its lifespan and pose a fire hazard.

3. Product Usage

- Avoid turning the volume up excessively, especially with high-frequency broadband speakers, as prolonged use at high volumes may lead to hearing damage.
- Be cautious not to drop the product or subject it to significant shocks, as frequent incidents could result in product malfunction or personal injury.
- Do not attempt to disassemble, repair, or modify the product on your own, as it may pose a risk of fire or electric shock due to voltage flow. In case of malfunction, please contact Sunny Wave Tech Customer Center at dogsplay.cs@sunnywt.com.
- Prevent your dog from chewing or licking the cable.
If this behavior occurs frequently, consider installing a protective cover for the cable.

Item	Spec
Model No.	DPT156G101BL
	39.624cm(15.6") Full HD
Display	344.16mm(H) x 193.59mm(V)
	Pixel Pitch: 0.17925 mm X 0.17925 mm
Adapter	Input: AC100-240V~50/60Hz, 1.5A max / Output: DC 12V, 5A
Interface	USB 3.0 type-C, USB 2.0 type-A (support mouse and keyboard via USB)
Chip	RK3566 (Rockchip)
Camera	5Mp@30fps, Wide angle front camera
Memory	eMMC 32GB, DDR4 2GB
Storage	128GB
Network	Wi-Fi 2.4G/5G
Out-Dimension	with stand: 387.0mm(W) X 248.8mm(D) X 354.5mm(H)
	weight : 2.2 kg
Environmental Condition	Operation: -20 °C ~ 50°C, less than 80%
	Storage: -30 °C ~ 60°C, less than 80%

FCC Warning

This device complies with part 15 of the FCC Rules. Operation is subject to the following two conditions: (1) This device may not cause harmful interference, and (2) this device must accept any interference received, including interference that may cause undesired operation.

This equipment has been tested and found to comply with the limits for a Class B digital device, pursuant to part 15 of the FCC Rules. These limits are designed to provide reasonable protection against harmful interference in a residential installation.

This equipment generates, uses and can radiate radio frequency energy and, if not installed and used in accordance with the instructions, may cause harmful interference to radio communications. However, there is no guarantee that interference will not occur in a particular installation. If this equipment does cause harmful interference to radio or television reception, which can be determined by turning the equipment off and on, the user is encouraged to try to correct the interference by one or more of the following measures:

- Reorient or relocate the receiving antenna.
- Increase the separation between the equipment and receiver.
- Connect the equipment into an outlet on a circuit different from that to which the receiver is connected.
- Consult the dealer or an experienced radio/TV technician for help.

Changes or modifications not expressly approved by the party responsible for compliance could void the user's authority to operate the equipment.

This device should be installed and operated with minimum 20 cm between the radiator and your body.

IC Warning

This device contains license-exempt transmitter(s)/receiver(s) that comply with Innovation, Science and Economic Development Canada's license-exempt RSS(s). Operation is subject to the following two conditions:

- (1) This device may not cause interference.
- (2) This device must accept any interference, including interference that may cause undesired operation of the device.

Cet appareil contient des émetteurs / récepteurs exempts de licence qui sont conformes aux RSS exempts de licence d'Innovation, Sciences et Développement économique Canada. Son fonctionnement est soumis aux deux conditions suivantes: (1) Cet appareil ne doit pas provoquer d'interférences. (2) Cet appareil doit accepter toute interférence, y compris les interférences qui peuvent provoquer un fonctionnement indésirable de l'appareil.

This equipment should be installed and operated with minimum 20 cm between the radiator and your body.

Cet appareil doit être installé et utilisé avec un minimum de 20 cm entre le radiateur et votre corps.

[Accessory] Assembly Instructions for Extension Leg (Large and Medium-sized Dogs)

1. Assemble the bottom of the Dogsplay main body and the Extension Leg's "main body connection part", aligning them with the alignment holes.
2. Assemble the Extension Leg's "foot connection part" and the foot, aligning them with the alignment holes.

Note: Align the indicated holes on each connecting part to ensure that the product remains stable and does not tilt when combined.

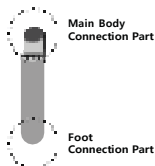

Extension Leg Structure

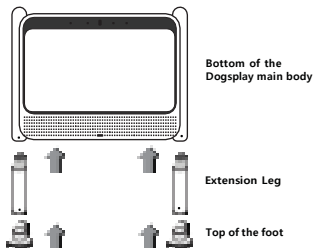

Product Assembly Structure Diagram