



www.dell.com/support/dpem



Dell Wireless Headset

WL3024

QUICK START GUIDE



Recyclable where
facilities exist

www.dell.com/support
www.dell.com/contactdell
www.dell.com/regulatory_compliance
Regulatory model: HS2403 / UD2403

2023-05
Dell P/N: F53MK A00
©2023 Dell Inc.





<https://www.dell.com/support>

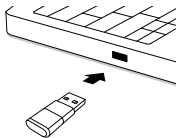
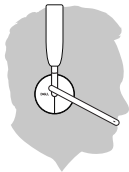

With 0° as the standard, the microphone is in mute state.

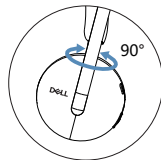
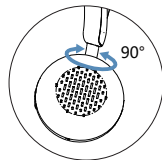
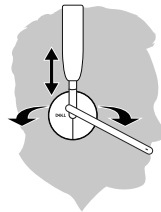
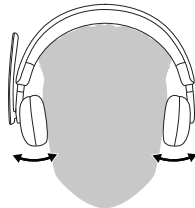
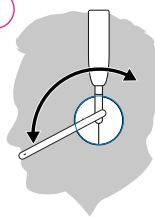

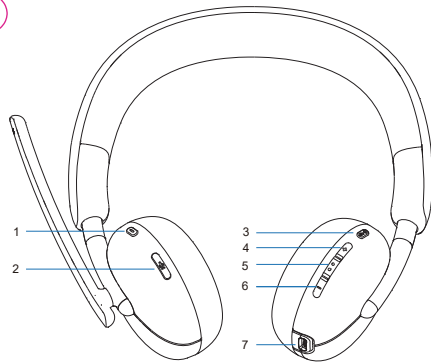
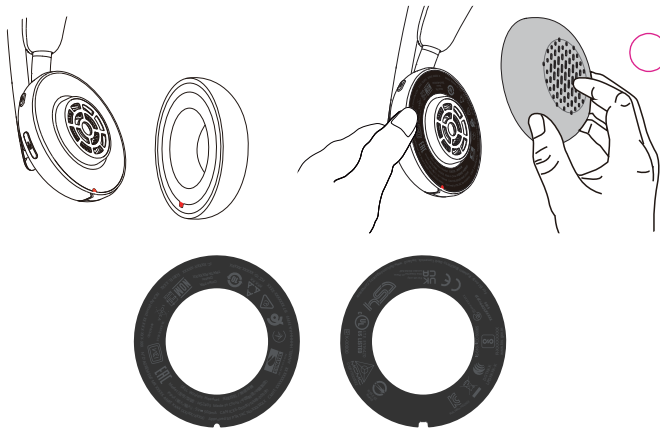

- 1 Teams Button
- 2 Mic Mute button
- 3 On / Off / BT pairing
- 4 Vol+
- 5 Multimedia
- 6 Vol-
- 7 USB C charging port

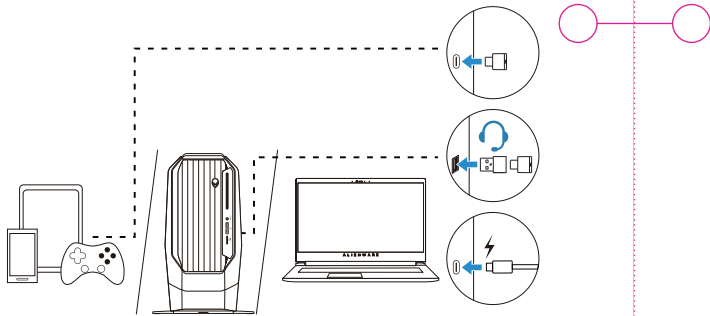

Plug the USB C dongle to USB C port on your computer or Plug the USB wireless dongle into the A to C adaptor, and then connect the adaptor to the USB A port on your computer.

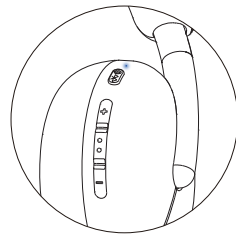
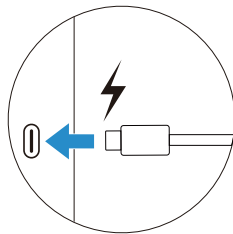

When connected, the power LED will keep on for 3 seconds and then blink slowly.