

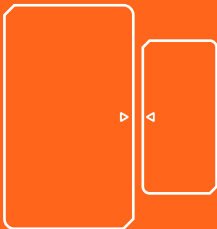

SNZB-04

User manual V 1.0



Wireless Door/Window Sensor

本设备需要连接SONOFF ZigBee网关进行智能操作，可与其他产品互联互通。

① 设备支持其它同类型的网关，具体以实际产品为准。

取出电池绝缘片



安装设备

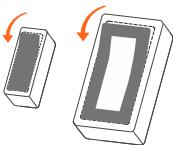

1. 撕下3M胶保护膜

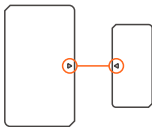

2. 安装时发射器和磁铁上的安装对位标识尽量对齐。
3. 分别粘贴在所需开合区域。

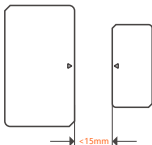

注意：发射器和磁铁安装间隙门窗在闭合状态下小于15mm。

使用说明

1. 下载APP

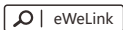

2. 添加子设备

添加子设备前，请先连接网关。



>



打开eWeLink APP，选择要连接的网关，点击“添加”子设备，然后长按设备重置按钮5秒直至LED指示灯闪烁3下，设备进入配对状态，等待设备连接。

注意：如添加失败，请将设备移近网关后再重新添加。

SONOFF网关支持同时连接多个子设备



先打开eWeLink APP网关页面，点击添加，然后设置让所需配对的子设备进入配对状态，等待设备连接。

产品参数

产品型号: SNZB-04

电池型号: CR2032

工作电压: 3V

无线协议: ZigBee (IEEE 802.15.4)

工作温度: -10-40℃

工作湿度: 10-90%RH(无冷凝)

安装距离: < 15mm

外壳材料: PC

产品规格: 发射器(47x27x13.5mm)

磁铁(32x15.6x13mm)

产品介绍

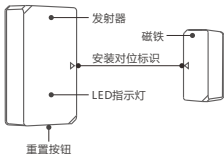

产品特点

SNZB-04是一款低功耗的无线门窗传感器，通过发射器与磁铁的靠近与分开感知门窗开/合状态，通过添加场景联动设置控制其它设备。



低功耗



电量低消息推送



场景联动

使用场景

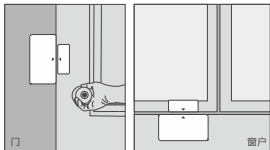

注意事项：

- 请勿安装在户外容易被破坏的位置；
- 请勿安装在基础不牢固或有雨淋的位置；
- 请勿安装在线路旁或磁性物体附近；

删除子设备

长按子设备重置按钮5秒直到LED指示灯闪烁3下，此时子设备已在网关中删除。



提醒：用户还可在APP子设备界面中删除子设备。

The device can be operated intelligently via working with the SONOFF ZigBee Bridge to communicate with other devices.

- ⚠ The device can work with other gateways supporting ZigBee 3.0 wireless protocol. Detailed information is in accordance with the final product.

Pull out the battery insulation sheet

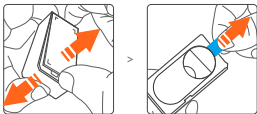

Install the device

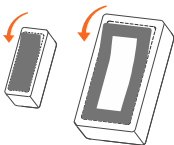

1. Tear off the protective film of the 3M adhesive.

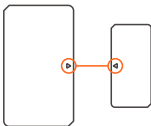

2. Try to align the mark line on the magnet with that on the transmitter during installation.
3. Install them in the opening and closing area separately.

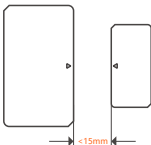

- ① Make sure the installation gap is less than 15mm when the door or the window is closed.

Operation instruction

1. Download APP

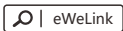

2. Add sub-devices

Connect the Bridge before adding the sub-device



>



Access eWeLink APP, select the Bridge that you want to connect, and tap "Add" to add a sub-device. Then long press reset button on the device for 5s until the LED indicator flashes three times, which means the device has entered the pairing mode, and be patient until pairing completes.

⚠ If the addition failed, move the sub-device closer to the Bridge and try again.

SONOFF ZigBee Bridge supports connecting multiple sub-devices at the same time.

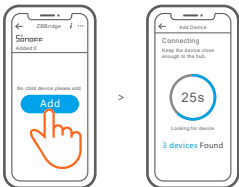

Power the Bridge on, access the Bridge page in the eWeLink APP, and tap "Add". Then set the sub-device to be pair to the pairing mode, and be patient until the pairing completes.

Specifications

Model: SNZB-04

Battery model: CR2032

Working voltage: 3V

Wireless connection: ZigBee (IEEE 802.15.4)

Working temperature : -10-40°C

Working humidity: 10-90%RH (non-condensing)

Installation gap: <15mm

Material: PC

Dimension: Transmitter(47x27x13.5mm)

Magnet(32x15.6x13mm)

Product Introduction

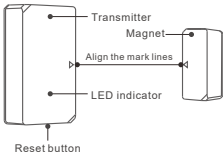

Features

SNZB-04 is a ZigBee low-energy wireless door/window sensor that makes you know the opening/closing status of door and window by separating the magnet from the transmitter. Connect it with the Bridge and you can create a smart scene to trigger other devices.



Low-energy



Low battery notification



Smart scenes

Application

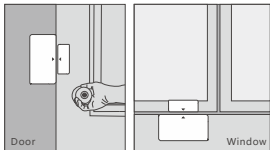

Note:

- Do not install outside the door/window.
- Do not install in the unstable position or in the place exposed to rain or moisture.
- Do not install near wiring or magnetic object.

Delete sub-devices

Long press the reset button on the sub-device for 5s until the LED indicator flashes three times. In this case, the sub-device is deleted from the Bridge successfully.



❗ Users can delete sub-devices directly from the sub-device page on APP.

FCC Statement

This equipment has been tested and found to comply with the limits for a Class B digital device, pursuant to part 15 of the FCC Rules. These limits are designed to provide reasonable protection against harmful interference in a residential installation. This equipment generates, uses and can radiate radio frequency energy and, if not installed and used in accordance with the instructions, may cause harmful interference to radio communications. However, there is no guarantee that interference will not occur in a particular installation. If this equipment does cause harmful interference to radio or television reception, which can be determined by tuning the equipment off and on, the user is encouraged to try to correct the interference by one or more of the following measures:

- Reorient or relocate the receiving antenna.
- Increase the separation between the equipment and receiver.
- Connect the equipment into an outlet on a circuit different from that to which the receiver is connected.
- Consult the dealer or an experienced radio/TV technician for help.

This device complies with part 15 of the FCC Rules. Operation is subject to the following two conditions: (1) This device may not cause harmful interference, and (2) this device must accept any interference received, including interference that may cause undesired operation.

Radiation Exposure Statement

This equipment complies with FCC radiation exposure limits set forth for an uncontrolled environment.

This transmitter must not be collocated or operating in conjunction with any other antenna or transmitter.

This equipment should be installed and operated with minimum distance 20cm between the radiator& your body.

Caution

Any changes or modifications not expressly approved by the party responsible for compliance could void the user's authority to operate the equipment.

SONOFF

Shenzhen Sonoff Technologies Co., Ltd.

1001, BLDG8, Lianhua Industrial Park, shenzhen, GD, China

ZIP code: 518000

Website: sonoff.tech

MADE IN CHINA

