

版本 REV.	设计 DESIGN	日期 DATE	变更内容 CONTENTS	标记 MARK	处数 QTY.
01	林泽斌	20170703			

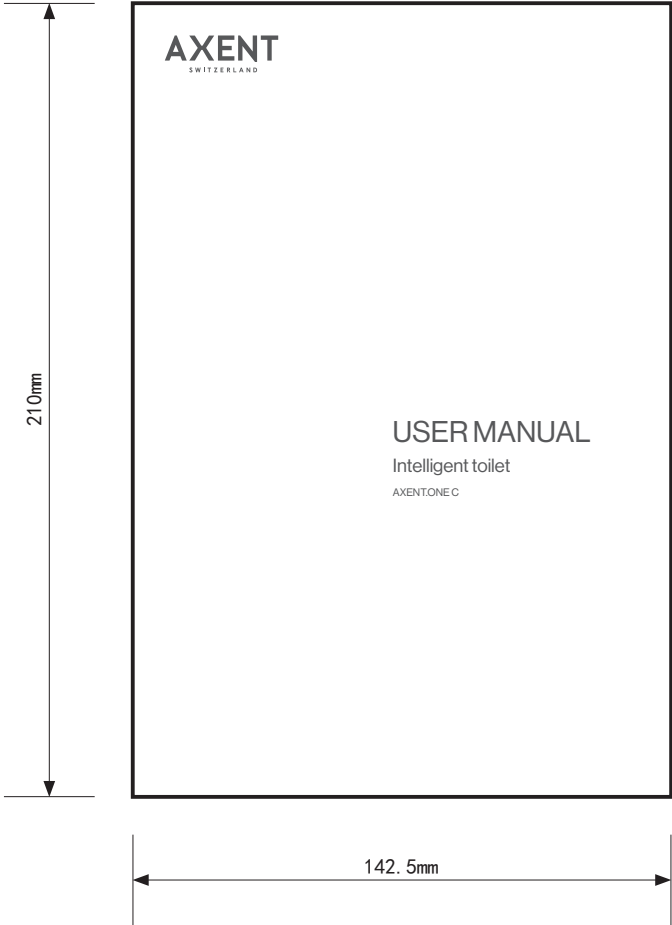

机型编号  
TYPE  
E312-01

技术要求

- 1. 印刷字体需清晰、均匀、平整、无重影；
- 2. 尺寸为 142.5×210mm，公差 ±1mm；
- 3. 装订方式：骑马钉；
- 4. 黑白印刷；
- 5. 所有材料满足欧盟包材指令要求和 REACH 要求。

设计 DESIGN	林泽斌	20170703	材料 MATERIAL	封面 200g 铜版纸（覆哑膜） 内页 128g 铜版纸			名称 TITLE	用户手册
审核 CHECK							编号 PART NO.	224000009300
工艺 PROCESS			图幅 SIZE	A4	比例 SCALE	1:2	<div>AXENT</div> <div>XIAMEN AXENT CORPORATION LIMITED</div> <div>厦门优胜卫厨科技有限公司</div>	
标准化 STANDARDIZE					单位 UNIT	mm		
批准 APPROVE			共 SHEET	1 张	第 OF	1 张		



# USER MANUAL

Intelligent toilet

AXENT.ONE C







**Thank you for your trust.**

We really appreciate your choice of AXENT products. Before using the products, please read this user manual to ensure safe and proper use.

Please follow the instructions written in this manual.

After reading this manual, please preserve it for future use.

The content of the manual might change as a result of the constant upgrade of AXENT products while the update information will NOT be informed.

Illustrations in this manual are only for reference. They are NOT pictures of real items.

We sincerely hope that you could understand how to use the product by reading this user manual.

In order to guarantee the best performance of the product and your safety, we sincerely advise that:

**Please read this manual carefully before using the product for the first time.**







## 1 SAFETY

1.1 NORMAL USE.....	3
1.2 IMPORTANT SAFEGUARDS .....	3
1.3 SAFETY INSTRUCTIONS.....	4
1.4 GROUNDING INSTRUCTIONS .....	6
1.5 FCC INSTRUCTIONS.....	7

## 2 PRODUCTS..... 9

## 3 FUNCTIONS ..... 10

## 4 INTRODUCTION ..... 11

## 5 MULTIFUNCTION KNOB INSTRUCTION4

5.1 QUICK START .....	14
5.2 REGULAR USE.....	15
5.3 ADDITIONAL FEATURES.....	16
5.4 STAND-BY-MODE .....	20
5.5 PAIRING.....	20

## 6 REMOTE CONTROL INSTRUCTION1

### 6.1 REGULAR USE

6.1.1 OPENING AND CLOSING THE SEAT AND LID.....	21
6.1.2 FLUSH .....	21
6.1.3 REAR WASH AND POWER WASH .....	22
6.1.4 FRONT WASH .....	22
6.1.5 OSCILLATING AND PULSATING SHOWER .....	22
6.1.6 WATER VOLUME .....	23
6.1.7 DRY .....	23
6.1.8 SPRAY ARM POSITION .....	23
6.1.9 TEMPERATURE ADJUSTMENT .....	23

### 6.2 ADDITIONAL FEATURES

6.2.1 NIGHT LIGHT SETTING.....	24
6.2.2 MUTE SETTING .....	24
6.2.3 ECO SETTING.....	25
6.2.4 AUTO OPEN SETTING .....	25

---



# CONTENT

---

6.2.5 SENSE AREA SETTING .....	25
6.2.6 AUTO CLOSE SETTING .....	25
6.2.7 AUTO FLUSH SETTING .....	26
6.2.8 DEODORIZE .....	26
6.2.9 SELF CLEANING .....	27
6.2.10 USER PROFILE .....	27
6.2.11 RESET .....	27
6.2.12 PAIRING .....	27
6.2.13 APP .....	27
<b>7 MAINTENANCE</b>	
7.1 SPRAY ARM CLEANING .....	28
7.2 SYSTEM PURGE .....	29
7.3 FILTER CLEANING .....	29
7.4 SURFACE CLEANING .....	30
7.5 REMOVING THE TOILET SEAT AND LID .....	30
7.6 LEAKAGE PROTECTIVE MAINTENANCE .....	31
7.7 WINTER MAINTENANCE .....	32
7.8 LONG-TERM NONUSE MAINTENANCE .....	32
<b>8 MALFUNCTIONS DURING OPERATION</b> .....	33
<b>9 DIMENSION</b> .....	36
<b>10 TECHNICAL DATA</b> .....	37

---



- The following warning signs warn you of dangerous situations and their severity:



**DANGER!**

High risk, lethal hazards, severe injuries



**WARNING!**

Medium risk, severe injuries



**CAUTION!**

Low risk, minor injuries



**NOTE!**

Damage to property

## 1.1 NORMAL USE

The AXENT shower toilet is a shower toilet with spray attachment for rear wash and front wash cleaning functions. It can also be used as a normal WC seat at any time. Its use is limited exclusively to enclosed spaces.

Any other usage will be deemed as not corresponding with normal usage. AXENT undertakes no liability for abnormal usage.

## 1.2 IMPORTANT SAFEGUARDS

When using electrical products, especially when children are present, basic safety precautions should always be followed, including the following:

### READ ALL INSTRUCTIONS BEFORE USING



**DANGER!**

**To reduce the risk of electrocution**

- Always unplug this product immediately after using.
- Do not use while bathing.
- Do not place or store product where it can fall or be pulled into a tub or sink.
- Do not place in or drop into water or other liquid.
- Do not reach for a product that has fallen into water. Unplug immediately.



# SAFETY

---



## **WARNING!**

**To reduce the risk of burns, electrocution, fire, or injury to persons**

- Close supervision is necessary when this product is used by, on, or near children or invalids.
- Use this product only for its intended use as described in this manual. Do not use attachments not recommended by the manufacturer.
- Never operate this product if it has a damaged cord or plug, if it is not working properly, if it has been dropped or damaged, or dropped into water. Return the product to a service center for examination and repair.
- Keep the cord away from heated surfaces.
- Never block the air openings of the product or place it on a soft surface, such as a bed or couch, where the air openings may be blocked. Keep the air openings free of lint, hair, and the like.
- Never use while sleeping or drowsy.
- Never drop or insert any object into any opening or hose.
- Do not use outdoors or operate where aerosol (spray) products are being used or where oxygen is being administered.
- Connect this product to a properly grounded outlet only. See Chapter 1.4.
- Unplug this product before filling. Fill (reservoir) with water only unless otherwise specified by manufacturer. Do not overfill (or specify filling instructions).

## **SAVE THESE INSTRUCTIONS**

### **1.3 SAFETY INSTRUCTIONS**

Carefully read and observe the following safety instructions!

#### **Information for the user**

- Children and persons with insufficient knowledge or experience in handling the device, or who have limited physical, sensory or mental capabilities, may only use the device following proper instruction or when supervised.
- Make sure that children cannot play with AXENT shower toilet.

#### **Avoid malfunctions and damage to the product as a result of improper use.**

- If AXENT shower toilet is moved from a cold location to a warm location, condensation may form. Leave the unit switched off for a few hours.
- Do not install AXENT shower toilet in rooms where there is a danger of frost. The room temperature must not be less than 39 °F (4°C).
- Do not place open fire sources, candles, cigarettes, or similar, on AXENT shower toilet.
- Do not reuse the old hose-set. Please use the new one only.



- Do not expose the AXENT shower toilet directly to water.
- Do not climb on or stand on the product.
- Do not place any heavy objects on the lid.
- Only open the seat and cover via the remote control.
- Do not push the lid down with excessive force.
- Do not deliberately soil, spray or block the spray arm.

### **Repairs must only be carried out by a person with the necessary expertise**

- Do not carry out modifications, tamper with, install additional equipment or attempt to repair the AXENT shower toilet.
- Improperly performed repairs can lead to accidents, damage and malfunctions.

### **Only use the device when it is fully functional**

- Make sure that the power cable or mains plug is not damaged.
- The power cable must not become jammed or pinched.
- Keep the power cable away from hot surfaces and sharp edges.
- Never touch the mains plug with wet hands.
- Do not use the product if it is not working properly.

Disconnect it from the mains immediately. Close the water cut-off valve to interrupt the water supply. Contact your installer.

### **Information on the use of batteries**

- Keep batteries out of the reach of small children. Batteries can be life-threatening if swallowed. If a battery has been swallowed, call for medical assistance immediately.
- Batteries may not be recharged, reactivated by other means, dismantled, exposed to fire or short-circuited.
- Always remove empty batteries from the remote control immediately. They may leak and cause damage.
- Do not insert new and old batteries together in the remote control.
- Clean the battery and contacts before inserting the battery. Note the proper polarity.
- Remove the batteries if you do not use the remote control for an extended period.
- Do not expose the batteries to extreme conditions: avoid contact with hot surfaces or direct sunlight. Otherwise there is a risk of leakage.
- If battery acid has leaked, avoid contact with skin, eyes and mucous membranes. In case of contact with the acid, flush the affected areas with large amounts of clean water and consult a doctor immediately.



# SAFETY

---

## 1.4 GROUNDING INSTRUCTIONS

This product should be grounded. In the event of an electrical short circuit, grounding reduces the risk of electric shock by providing an escape wire for the electric current.

This product is equipped with a cord having a grounding wire with a grounding plug.

The plug must be plugged into an outlet that is properly installed and grounded.



### **DANGER!**

**Improper use of grounding plug can result in a risk of electric shock**

- If repair or replacement of the cord or plug is necessary, do not connect the grounding wire to either flat blade terminal. The wire with insulation having an outer surface that is green with or without yellow stripes is the grounding wire.
- This product is factory equipped with a specific electric cord and plug to permit connection to a proper electric circuit. Make sure that the product is connected to an outlet having the same configuration as the plug. No adapter should be used with this product. Do not modify the plug provided — if it will not fit the outlet, have the proper outlet installed by a qualified electrician. If the product must be reconnected for use on a different type of electric circuit, the reconnection should be made by qualified service personnel.
- If it is necessary to use an extension cord, use only a three wire extension cord that has a three-blade grounding plug, and a three-slot receptacle that will accept the plug on the product. Replace or repair a damaged cord.

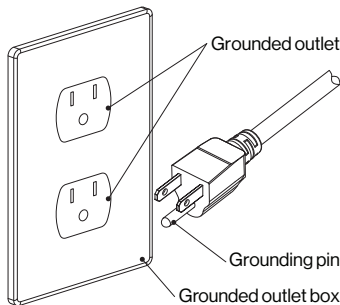

Wiring Diagram (NOT FOR INSPECTOR'S USE)



### **NOTE!**

- Actual field installation maybe be slightly different from diagram. Provided fittings will be connected at the bottom of unit instead on the sides.



### 1.5 FCC INSTRUCTIONS

Please note that changes or modifications not expressly approved by the party responsible for compliance could void the user's authority to operate the equipment.

Note: This equipment has been tested and found to comply with the limits for a Class B digital device, pursuant to part 15 of the FCC Rules. These limits are designed to provide reasonable protection against harmful interference in a residential installation. This equipment generates, uses and can radiate radio frequency energy and, if not installed and used in accordance with the instructions, may cause harmful interference to radio communications. However, there is no guarantee that interference will not occur in a particular installation. If this equipment does cause harmful interference to radio or television reception, which can be determined by turning the equipment off and on, the user is encouraged to try to correct the interference by one or more of the following measures:

- Reorient or relocate the receiving antenna.
- Increase the separation between the equipment and receiver.
- Connect the equipment into an outlet on a circuit different from that to which the receiver is connected.
- Consult the dealer or an experienced radio/TV technician for help.







- This manual is applicable for the following products:

► [E322-02]

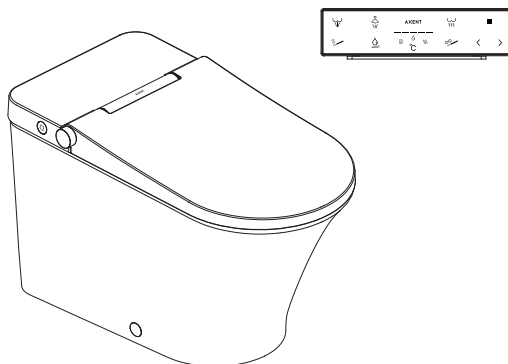



# FUNCTIONS

---

	FUNCTION	E322-02
1	Rear Wash	●
2	Power Wash	●
3	Front Wash	●
4	Instantly Water Heating	●
5	Water Temperature Adjustment	●
6	Water Volume Adjustment	●
7	Spray Arm Position Adjustment	●
8	Oscillate	●
9	Pulsate	●
10	Pulsate / Oscillate	●
11	Dry	●
12	Air Temperature Adjustment	●
13	Auto Flush	●
14	Auto Open	●
15	Remote Control Open	●
16	Seat Heating	●
17	Seat Temperature Adjustment	●
18	Protection from low temperature burn	●
19	Anti-microbial Seat	●
20	Anti-microbial Ceramic	●
21	Self Cleaning	●
22	Descale	●
23	Side button	●
24	Remote Control	●
25	User Profile	●
26	Auto Light	●
27	Eco	●
28	Inlet Filtering	●
29	Deodorize	●
30	Soft Close	●



## ■ MAIN

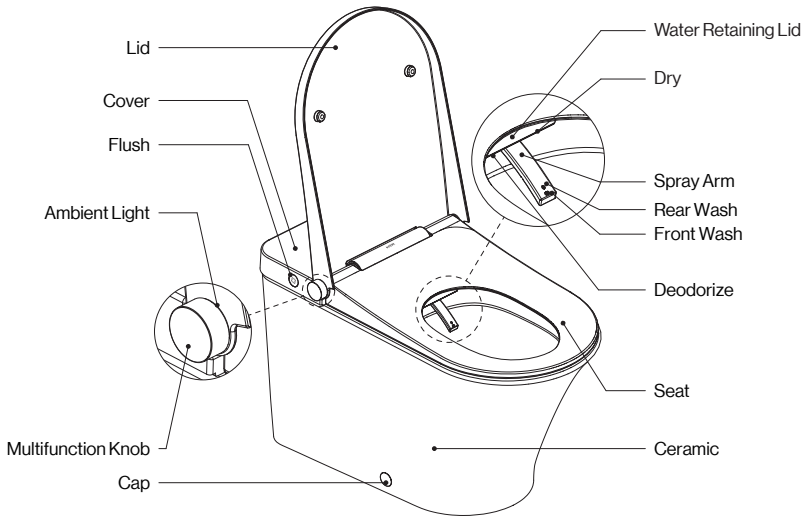

## ■ SIDE BUTTONS

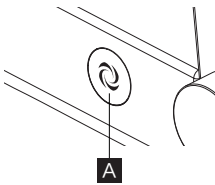

**A** Flush

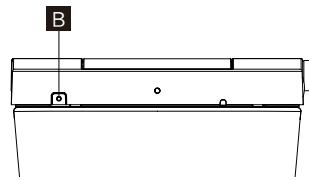

**B** Drain



# INTRODUCTION

## ■ REMOTE CONTROL

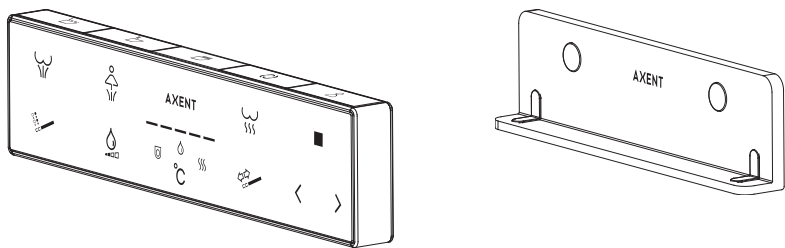

REMOTE CONTROL

HOLDER

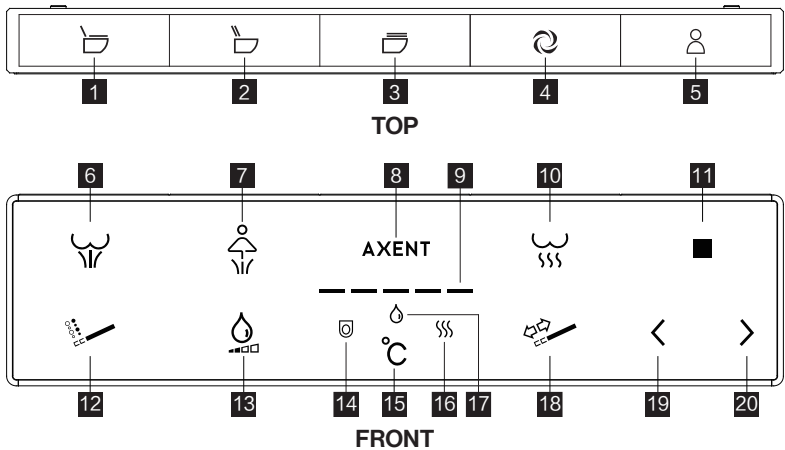

TOP

FRONT

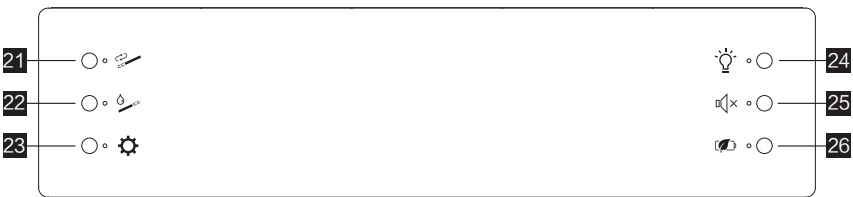

BACK

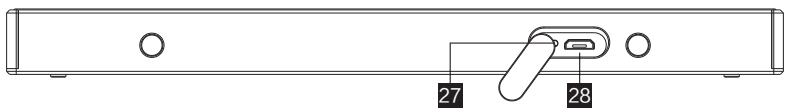

BOTTOM



## ► INTERFACE

- |                          |                        |
|--------------------------|------------------------|
| <b>1</b> Lid             | <b>15</b> Temp         |
| <b>2</b> Seat            | <b>16</b> Air Temp     |
| <b>3</b> Close           | <b>17</b> Water Temp   |
| <b>4</b> Flush           | <b>18</b> Position     |
| <b>5</b> User            | <b>19</b> Minus        |
| <b>6</b> Rear Wash       | <b>20</b> Plus         |
| <b>7</b> Front Wash      | <b>21</b> System Purge |
| <b>8</b> Logo Indicator  | <b>22</b> Descale      |
| <b>9</b> Level Indicator | <b>23</b> Setting      |
| <b>10</b> Dry            | <b>24</b> Light        |
| <b>11</b> Stop           | <b>25</b> Mute         |
| <b>12</b> Massage        | <b>26</b> Eco          |
| <b>13</b> Water Volume   | <b>27</b> Power Off    |
| <b>14</b> Seat Temp      | <b>28</b> Charging     |

## ► COMBINATION

- |  |  |
|--|--|
| <b>23</b> + <b>1</b> → Auto Open Setting                   | <b>23</b> + <b>5</b> for 2 sec. → Turn Off               |
| <b>23</b> + <b>2</b> for 2 sec. → Sensing Distance Setting | <b>23</b> + <b>25</b> → Deodorize Setting                |
| <b>23</b> + <b>3</b> → Auto Close Setting                  | <b>23</b> + <b>26</b> → Self Cleaning Setting            |
| <b>23</b> + <b>4</b> → Auto Flush Setting                  | <b>23</b> + <b>26</b> for 2 sec. → Self Cleaning Setting |

## ► ON/OFF/CHARGING

### ON

The remote control is powered off. Press **23** Setting for 2 sec. to turn on the remote control.

### OFF

Press **23** Setting and at the same time **5** User for 2 sec. to turn off the remote control.

### CHARGING

When power is below 15%, the **8** Logo Indicator will blink on and off, indicating the battery needs to be charged.

Please connect the standard charge cable to **28** Charging on the remote control.

The **9** Level Indicator indicates the battery powe. All 5 lights on means the remote control is fully charged.



# MULTIFUNCTION KNOB INSTRUCTION

---

## 5.1 QUICK START

AXENT.ONE C offers a Quick Start function. Sit down on the toilet seat and push the button. The shower starts and will stop after another push on the button.



The spray arm is automatically cleaned with water before and after each shower procedure.





# MULTIFUNCTION KNOB INSTRUCTION

## 5.2 REGULAR USE

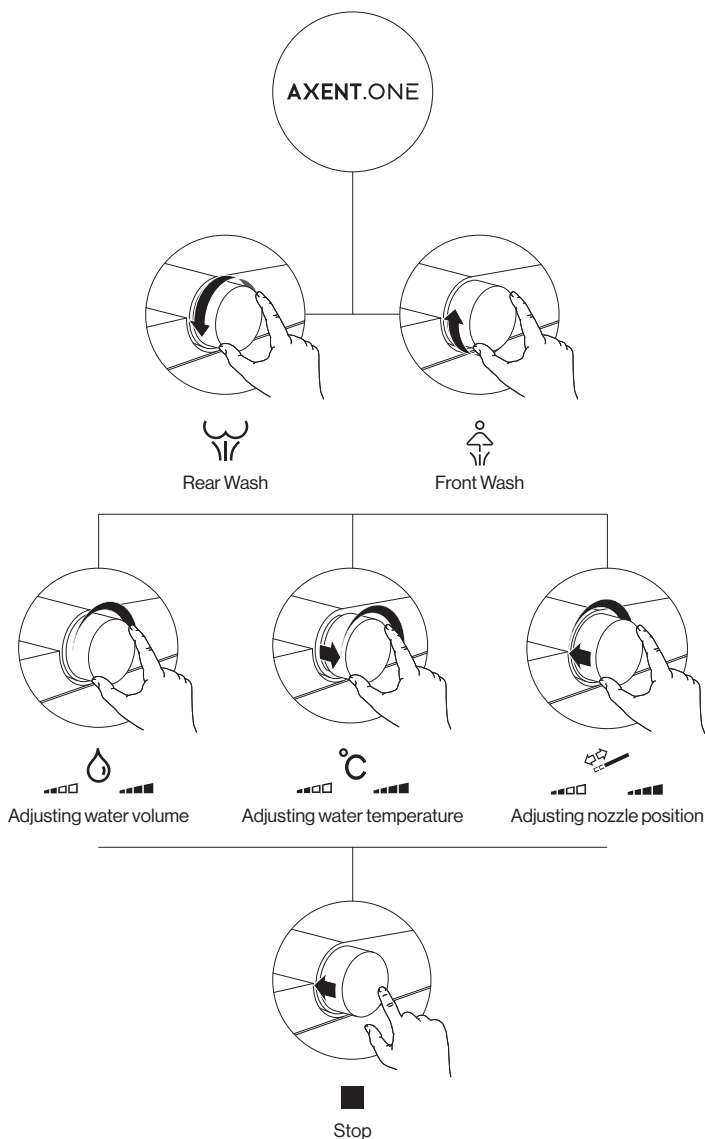



# MULTIFUNCTION KNOB INSTRUCTION

---

## 5.3 ADDITIONAL FEATURES

With the multifunction knob, beside the primary functions, additional settings can be changed or service functions made on two main levels.

### LEVEL 1

- Signal ton ON / OFF
- Seat heating ON / OFF
- Self-cleaning function ON / OFF
- System purge
- Emptying the water tank

### LEVEL 2

- Night light ON / AUTO / OFF
- Deodorizer ON / OFF
- Decalcification for water-bearing parts
- Spray arm cleaning
- System reset

### ACTIVATE FUNCTIONS AT LEVEL 1

By pressing the multifunction knob for 5 seconds until the «Ambient light» flashes slowly, the mode level 1 is activated.

The «Ambient light» keeps on flashing slowly.

### DEACTIVATE FUNCTIONS AT LEVEL 1

You are in the mode level 1: Push the multifunction knob.

The «Ambient light» stops flashing and you hear one time «beep».

The mode level 1 is deactivated.



### NOTE!

- If no operations are done within 3 minutes, the mode level 1 will be deactivated automatically.

### LEVEL 1

### SIGNAL TON

### ON / OFF

You are in the mode level 1: «Ambient light» flashes slowly,

- Turn the multifunction knob counter clockwise.

One time «beep»:

Signal ton is ON

Two times «beep»:

Signal ton is OFF

Factory setting:

Signal ton is ON



# MULTIFUNCTION KNOB INSTRUCTION

---

## LEVEL 1

### SEAT HEATING

ON / AUTO / OFF

You are in the mode level 1: «Ambient light» flashes slowly

- Press and hold the multifunction knob.
- Turn it clockwise.

One time «beep»:	Seat heating is ON
Two times «beep»:	Seat heating is AUTO
Three times «beep»:	Seat heating is OFF
Factory setting:	Seat heating is ON

## LEVEL 1

### SELF-CLEANING FUNCTION

ON / OFF

As soon as you sit down on the toilet seat, the spray arm will be cleaned with fresh water.  
This function can be turned ON or OFF.

You are in the mode level 1: «Ambient light» flashes slowly

- Press and hold the multifunction knob.
- Turn it counter clockwise.

One time «beep»:	Self-cleaning function is ON
Two times «beep»:	Self-cleaning function is OFF
Factory setting:	Self-cleaning function is ON

## LEVEL 1

### SYSTEM PURGE

After a long time of not using the shower toilet, all water bearing parts can be exchanged with fresh water.

You are in the mode level 1: «Ambient light» flashes slowly.

- Turn multifunction knob clockwise.
- You will hear one «beep». The system purge has started.

The system purge process stops after 90s automatically.



#### NOTE!

- Turn multifunction knob clockwise again to stop the system purge procedure immediately.



# MULTIFUNCTION KNOB INSTRUCTION

---

## LEVEL 1                      EMPTYING THE WATER TANK

In case of a service intervention, you might be obliged to empty the water tank.

You are in the mode level 1: «Ambient light» flashes slowly.

- Pull the multifunction knob.
- Turn it counter clockwise.

The pump empties the water tank. You will hear a «beep» if the process is finished.

## ACTIVATE FUNCTIONS AT LEVEL 2

By pressing the multifunction knob for 5 seconds until the «Ambient light » flashes slowly, the mode level 1 is activated.

By pressing the multifunction knob again for 5 seconds until the «Ambient light » flashes quickly, the mode level 2 is activated. The «Ambient light » keeps on flashing quickly.

## DEACTIVATE FUNCTIONS AT LEVEL 2

You are in the mode level 2.

Push the multifunction knob.

The «Ambient light» stops flashing and you hear one time «beep».

The mode level 2 is deactivated.



### NOTE!

- If no operations are done within 3 minutes, the mode level 2 will be deactivated automatically.

LEVEL 2	NIGHT LIGHT	ON / AUTO / OFF
---------	-------------	-----------------

You are in the mode level 2: «Ambient light» flashes quickly.

- Turn multifunction knob counter clockwise.

One time «beep»:

Night light function is ON

Two times «beep»:

Night light function is AUTO

Three times «beep»:

Night light function is OFF

Factory setting:

AUTO mode – the brightness will be adapted according to the ambience.



# MULTIFUNCTION KNOB INSTRUCTION

---

## LEVEL 2

## DEODORIZER

## ON / OFF

The deodorizer function is activated when a user is seated.

You are in the mode level 2: «Ambient light» flashes quickly

- Press and hold the multifunction knob.
- Turn it clockwise.

One time «beep»:

Deodorizer is ON

Two times «beep»:

Deodorizer is OFF

Factory setting:

Deodorizer is ON

## LEVEL 2

## AUTO DRY

## ON / OFF

The dry function is started when a user press the multifunction knob during Rear or Front Wash.

You are in the mode level 2: «Ambient light» flashes quickly

- Press and hold the multifunction knob.
- Turn it counter clockwise.

One time «beep»:

Auto Dry is ON

Two times «beep»:

Auto Dry is OFF

Factory setting:

Auto Dry is OFF

## LEVEL 2

## DECALCIFICATION FOR THE WATER-BEARING PARTS

The entire water system can easily be decalcified like a coffee machine. Fill a cup with 200ml decalcification liquid (Durgol preferred).

You are in the mode level 2: «Ambient light» flashes quickly

- Pull the multifunction knob.
- Turn it clockwise.

The water system will be drained completely and the spray arm is moving out without any water spray function.

- Hold the cup close the spray arm.
- Dip the spray arm into the cup with the decalcification liquid.

The liquid will be absorbed. The spray arm moves back into its position.

The decalcification liquid will circulate in the water-bearing parts in order to dissolve the limestone.

The decalcification liquid will be ejected automatically.

The whole water-bearing system will be rinsed 3 times with fresh water. This process will take approximately 3 minutes



# MULTIFUNCTION KNOB INSTRUCTION

---

## LEVEL 2 SPRAY ARM CLEANING

You are in the mode level 2: «Ambient light» flashes quickly

- Turn the multifunction knob clockwise.

The spray arm will move out.

- Clean the spray arm with a fabric.
- Turn the multifunction knob clockwise again.

The spray arm will move back to its position.



### NOTE!

- If no operations are done within 3 minutes, the spray arm will move back automatically.

## LEVEL 2 SYSTEM RESET

You are in the mode level 2: «Ambient light» flashes quickly

- Pull the multifunction knob.
- Turn it counter clockwise.

One time «beep»:

All values are reset to factory settings

If you turn the multifunction knob again, a 3 seconds «beep» will inform you that the system will be re-started.

## 5.4 STAND-BY-MODE

### ACTIVATE

Press and hold the multifunction knob until «Ambient light» off.

### DEACTIVATE

Slightly knock the toilet lid.

## 5.5 PAIRING

Cut off the power of the shower toilet and then apply power to it. After three times «beep», start pairing by pressing multifunction knob 5 times within 20 seconds.

Three times «beep» from the shower toilet confirms successful pairing.

Pairing has originally been done in the factory. It is necessary only after you changed your multifunction knob.



# REMOTE CONTROL INSTRUCTION

---

## 6.1 REGULAR USE

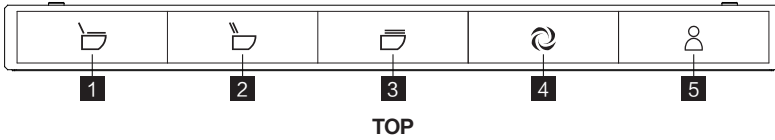

### 6.1.1 OPENING AND CLOSING THE SEAT AND LID

#### OPEN

Press **1** Lid after leaving the seat; open the lid or close the seat.

Press **2** Seat after leaving the seat; open the lid and seat.

Auto Open: According to the Auto Open Setting, lid or lid and seat will be opened automatically when you are around.

#### CLOSE

Press **3** Close after leaving the seat; close the seat and lid.

Auto Close: Lid and seat will be closed automatically 2 minutes after leaving.



#### Note!

- Auto Open only works when the lid is closed and 10 sec. after last Auto Open.
- Please do not put things on the lid or seat.

### 6.1.2 FLUSH

Press **4** Flush; starts the function.

Auto Flush: Leave the seat after you are seated over 5 sec. and the function will be started after a period of time defined by the Auto Flush Setting. Factory setting of Auto Flush Setting is 15 seconds.



# REMOTE CONTROL INSTRUCTION

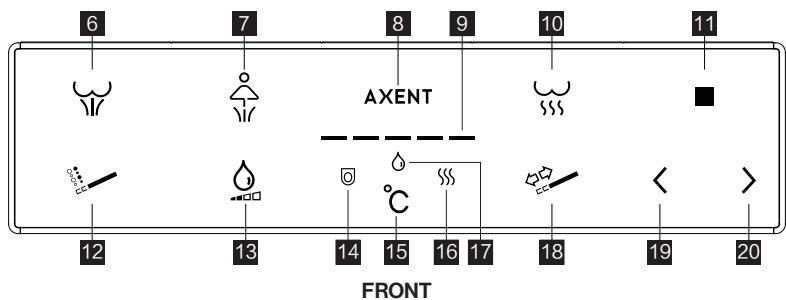

## 6.1.3 REAR WASH AND POWER WASH

### START

Press **6** Rear Wash after you are seated; the **6** Rear Wash icon starts to light and starts the function.

### STOP

Press **11** Stop to stop the Rear Wash.  
The Rear Wash will stop automatically after continuous usage of 3 minutes.

## 6.1.4 FRONT WASH

### START

Press **7** Front Wash after you are seated; the **7** Front Wash icon starts to light and starts the function.

### STOP

Press **11** Stop to stop the Front Wash.  
The Front Wash will stop automatically after continuous usage of 3 minutes.

## 6.1.5 OSCILLATING AND PULSATING SHOWER

Press **12** Massage to activate oscillating, pulsating, or oscillating and pulsating wash during the Rear and Front Wash.

- Oscillating: Press **12** Massage
- Pulsating: Press **12** Massage twice
- Pulsating and Oscillating: Press **12** Massage three times

After pressing three times the **12** Massage function, the regular Rear or Front wash is in place again.



## REMOTE CONTROL INSTRUCTION

---

### 6.1.6 WATER VOLUME

Press **13** Water Volume during Rear or Front Wash, the **13** Water Volume icon starts to light and the water volume can be regulated.

- Press **19** Minus to reduce the water volume.
- Press **20** Plus to increase the water volume.

The **9** Level Indicator indicates the selected water volume.

### 6.1.7 DRY

#### START

Press **10** Dry after you are seated; the **10** Dry icon starts to light and starts the function.

- Oscillating Air: Press **12** Massage during dry; the **12** Massage icon starts to blink and starts oscillating air. Press **12** Dry again will stop oscillating air.

#### STOP

Press **11** Stop to stop the Dry.

The Dry will stop automatically after continuous usage of 3 minutes.

### 6.1.8 SPRAY ARM POSITION

Press **18** Position during Rear Wash, Front Wash, or Dry; the **18** Position icon starts to light and the position can be regulated.

- Press **19** Minus to move the Spray Arm backward.
- Press **20** Plus to move the Spray Arm forward.

The **9** Level Indicator indicates the selected Spray Arm position.

### 6.1.9 TEMPERATURE ADJUSTMENT

Press **15** Temp repeatedly during Rear or Front Wash to switch among **14** Seat Temp, **17** Water Temp or **16** Air Temp.

When indicator lights **14**, **17** or **16** on, corresponding temperature can be adjusted.

- Press **19** Minus to lower the temperature.
- Press **20** Plus to increase the temperature.

The **9** Level Indicator indicates the selected level. If all lights are off, the corresponding heating function is turned off.



# REMOTE CONTROL INSTRUCTION

## 6.2 ADDITIONAL FEATURES

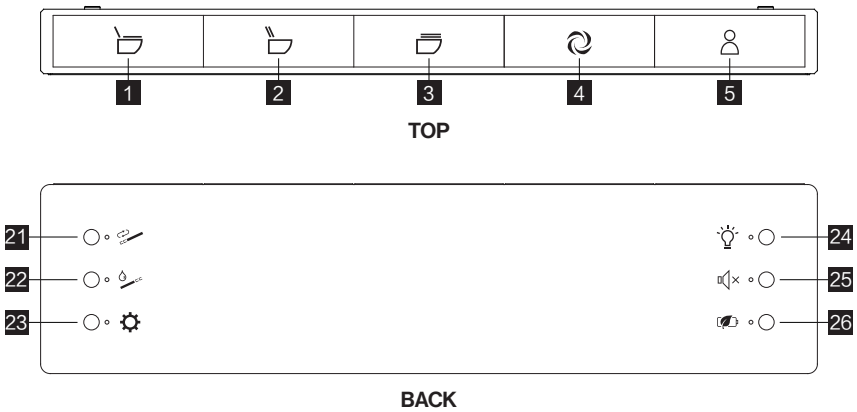

### 6.2.1 NIGHT LIGHT SETTING

Press **24** Light to enter into the setting. Press **24** Light to switch among ON, OFF and AUTO.

- Night Light is ON: The indicator on.
- Night Light is AUTO: The indicator blinks 3 times and turns on.
- Night Light is OFF: The indicator blinks for one second and turns off.

Factory setting: Night Light function is AUTO mode - the brightness will be adapted according to the ambience.

### 6.2.2 MUTE SETTING

Press **25** Mute to set the mute mode ON or OFF.

- Mute is ON: The indicator on.
- Mute is OFF: The indicator blinks for one second and turns off.

Factory setting: Mute function is OFF.



## 6.2.3 ECO SETTING

Press **26** Eco to turn on or off the function.

- Eco is ON: The indicator on.
- Eco is OFF: The indicator blinks for one second and turns off.

Factory setting: Eco function is OFF.

## 6.2.4 AUTO OPEN SETTING

Press **23** Set and at the same time **1** Lid to enter the setting. Press **1** Lid repeatedly to switch among OFF, Seat and Lid.

- Auto Open is OFF: One indicator in **9** Level Indicator on.
- Auto Open is Seat: Three indicators in **9** Level Indicator on.
- Auto Open is Lid: Five indicators in **9** Level Indicator on.

Factory setting: Auto Open function is Seat.

## 6.2.5 SENSE AREA SETTING

Press **23** Set and at the same time **2** Seat for 2 sec. to light the **14** Seat Temp, **17** Water Temp and **16** Air Temp and enter the setting. The **9** Level Indicator indicates is reduction or increase and the selected level of Sense Area. Every one indicator of the **9** Level Indicator count 4 levels.

- Press **19** Minus to reduce the levels of Sense Area.
- Press **20** Plus to increase the levels of Sense Area.

Entering Stand-by Mode will exit the Sense Area Setting.

## 6.2.6 AUTO CLOSE SETTING

Press **23** Set and at the same time **3** Close to enter the setting. Press **3** Close to turn on or off the function.

- Auto Close is OFF: One indicator in **9** Level Indicator on.
- Auto Close is ON: Five indicators in **9** Level Indicator on.

Factory setting: Auto Close function is ON.



# REMOTE CONTROL INSTRUCTION

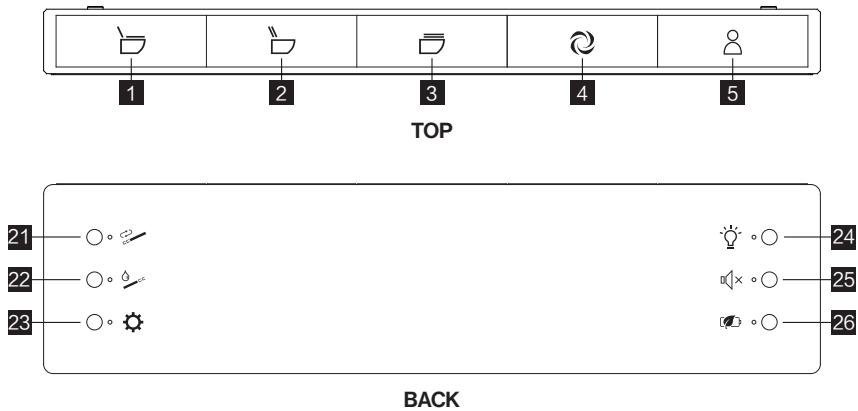

## 6.2.7 AUTO FLUSH SETTING

Press **23** Set and at the same time **4** Flush to enter the setting. Press **4** Flush repeatedly to switch among OFF, 5 seconds, 10 seconds, 15second, 20 seconds and 25 seconds.

- Auto Flush is OFF: No indicator in **9** Level Indicator on.
- Auto Flush is 5 seconds: One indicator in **9** Level Indicator on.
- Auto Flush is 10 seconds: Two indicators in **9** Level Indicator on.
- Auto Flush is 15 seconds: Three indicators in **9** Level Indicator on.
- Auto Flush is 20 seconds: Four indicators in **9** Level Indicator on.
- Auto Flush is 25 seconds: Five indicators in **9** Level Indicator on.

Factory setting: Auto Flush function is 15 seconds.

## 6.2.8 DEODORIZE

Press **23** Set and at the same time **25** Mute to turn on or off the function.

- Deodorize is ON: The indicator on.
- Deodorize is OFF: The indicator blinks for one second and turns off.

Factory setting: Deodorize function is ON.



### 6.2.9 SELF CLEANING

Press **23** Set and at the same time **26** Eco to turn on or off the function.

- Self Cleaning is ON: The indicator on.
- Self Cleaning is OFF: The indicator blinks for one second and turns off.

Factory setting: Deodorize function is ON.

### 6.2.10 USER PROFILE

Press **5** User to switch among different user profiles. There are 5 user profiles in total which correspond with five indicators in **9** Level Indicator respectively.

Functions will conform with the settings defined by the user profile selected.

The change of user's setting will be saved automatically when profile setting mode is on.

You will exit user profile mode after activating the stand-by mode of the remote control for a moment.

### 6.2.11 RESET

The remote control and shower toilet can be reset to the factory settings.

Turn off the remote control. Press **26** Eco and at the same time turn on the remote control by pressing **23** Set for 2 seconds to restore factory settings.

### 6.2.12 PAIRING

Pairing has originally been done in the factory. So it is necessary only after you changed your remote control.

Please make sure there is sufficient power supply for the remote control before pairing.

Cut off the power of the shower toilet and then apply power to it.

After a «beep», start pairing by pressing **11** Stop 5 times within 20 seconds.

Three times «beep» from the shower toilet confirms successful pairing.

### 6.2.13 APP

Users of Android and IOS could scan the following QR code to download and install the app named "AXENT Intelligent Control" so that your device (such as smart phones and tablets etc.) are capable of controlling this product remotely.



- Requires bluetooth 3.0 or later.
- Requires IOS8.0 or later.



# MAINTENANCE

---

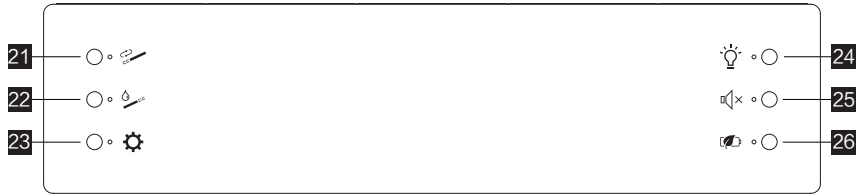

BACK

## 7.1 SPRAY ARM CLEANING

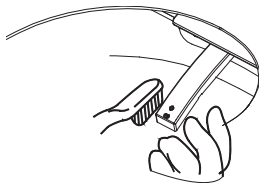

### ► MULTIFUNCTION KNOB

You are in the mode level 2: «Ambient light» flashes quickly

- Turn the multifunction knob clockwise.
- Clean the spray arm with a fabric.
- Turn the multifunction knob clockwise again.

The spray arm will move back to its position.

If no operations are done within 3 minutes or you are seated, the spray arm will move back automatically.

### ► REMOTE CONTROL

Leave the seat and press **22** Descale.

- The washing spray arm extends.
- Clean the spray arm with a fabric.

Press **22** Descale again.

The spray arm will move back to its position.

If no operations are done within 3 minutes or you are seated, the spray arm will move back automatically.



## 7.2 SYSTEM PURGE

After a long time not using the shower toilet, all water bearing parts can be exchanged with fresh water.

### ► MULTIFUNCTION KNOB

You are in the mode level 1: «Ambient light» flashes slowly.

- Turn multifunction knob clockwise.
- You will hear one «beep». The system purge has started.

The system purge process stops after 90s automatically.

Turn multifunction knob clockwise again to stop the system purge procedure immediately.

### ► REMOTE CONTROL

Press **21** System Purge to turn on function.

The system purge process stops after 90s automatically.

Press **21** System Purge again or press **11** Stop to stop the system purge procedure immediately.

## 7.3 FILTER CLEANING

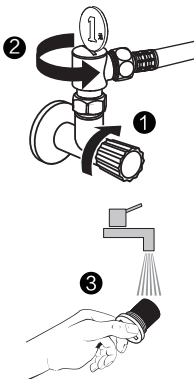

The filter net could be detached as shown in the picture on the left.

Wash the filter with clean water.



### NOTE!

- When the water flow is lower than normal, please clean the filter.
- During the whole cleaning process, please detach the inlet hose from the product.
- Please make sure that the angle valve is shut off.
- Please put the filter back in reversed sequence after cleaning it.



## MAINTENANCE

---

### 7.4 SURFACE CLEANING



#### **CAUTION!**

- Cut off the power of the shower toilet before clean it.

This product has been designed and manufactured with great care and attention to detail. If you follow a few simple cleaning instructions you will be able to enjoy its comfort, quality and beauty every day.

#### ► **CLEANING INSTRUCTIONS SEAT, LID AND BACK COVER**

Use a mild soap solution to clean the seat and please take care that the seat and hinges are not left damp. Dry off any residual water or cleaning agent with a soft cloth. Avoid contact of the seat and hinges with abrasive, corrosive or chlorine-based cleaners, as these may cause damage or lead to flash rust. Therefore, when cleaning the bowl, make sure that the seat and cover are kept in an upright position until all cleaning agent has been flushed away.

#### ► **CLEANING INSTRUCTIONS CERAMIC**

Under no circumstances should you use harsh or abrasive cleaning substances such as abrasive cream cleansers, scouring powder or drain cleaner on your ceramic surfaces. Also avoid using steam cleaners and hard, abrasive sponges. Please bear in mind that hair colouring products can reduce the effectiveness of AXENT Easy Clean.

If you follow this guidance then you should remain satisfied with the performance of AXENT Easy Clean for many years. Recommended cleaners for sanitary ceramic surfaces with AXENT Easy Clean finish. The use of acidic cleaners with a pH value between 1 and 4 is highly recommended. Cleaners with a pH value in the neutral range (5 to 8) are not always suitable. We strongly advise against using either weak or strong alkaline cleaners, i.e. substances with pH values from 9 to 12.

### 7.5 REMOVING THE TOILET SEAT AND LID



#### **NOTE!**

- The toilet seat and lid can be removed, cleaned and remounted quickly and easily when heavily soiled.

1. Lift up the toilet seat and toilet lid.
2. Remove the toilet seat and toilet lid by vertical lifting them out of the bracket.
3. Clean the toilet seat and toilet lid.
4. Insert the toilet seat and toilet lid vertically from the top into the bracket in the same way as removed.
5. Let the toilet seat and toilet lid glide down.



### ► UNINSTALLING AND INSTALLING THE LID AND SEAT

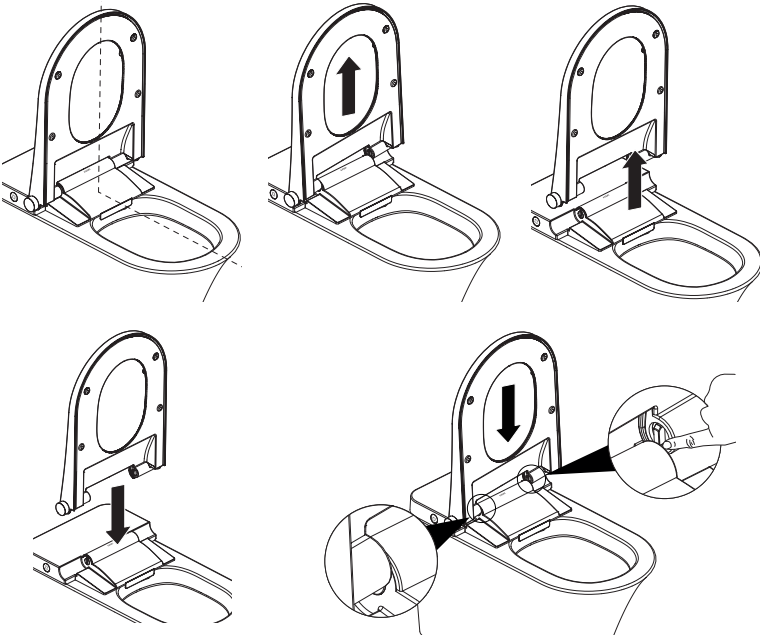

## 7.6 LEAKAGE PROTECTIVE MAINTENANCE

Please check the leakage current protector regularly, at least monthly.

Checking Methods:

- Press the Reset button of the leakage protector. Indicator light turns on, showing that it has been connected to power.
- Press the Test of the leakage protector. Indicator light turns off, showing that it is disconnected from the power.

In case of wrong notification information after operating, please stop using this product and contact the local supplier or the service hot line to replace the leakage protector.

Please assure that the indicator light of the leakage protector is on continuously on when this product is working.

In case that the leakage protector has been installed in the existing circuit, please check the protector following the above method.



# MAINTENANCE

---

## ► LEAKAGE PROTECTIVE GRAPH

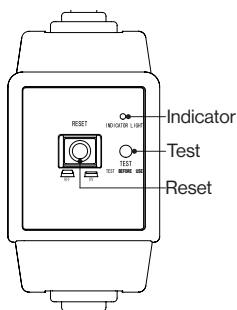

## 7.7 WINTER MAINTENANCE

Please make sure water in the system is of proper temperature, so as to guarantee that the water in the shower toilet and the hose could not be frozen.

When the environment temperature is lower than 0 , please stop using this product.

- Cut off the power of the shower toilet or press the Test of the leakage protector.
- Shut off the angle valve.
- Press **B** Empty for 5 sec. to empty water inside heating pipe.
- Discharge the hose-set and empty water inside.
- Press **A** Flush.

## 7.8 LONG-TERM NONUSE MAINTENANCE

When this product is not used for a long time, please cut off the power of the shower toilet and empty the water in it.

- Cut off the power of the shower toilet or press the Test button of the leakage protector.
- Shut off the angle valve.
- Press **B** Empty for 5 sec. to empty water inside heating pipe.
- Discharge the hose-set and empty water inside.
- Press **A** Flush.
- Please check according to the manual before use it again.



## MALFUNCTIONS DURING OPERATION

### ■ MALFUNCIONS AND SOLUTIONS

When you think the product is malfunction, please follow the methods below. If those methods could not make the product work normally, please return the product to a service center for examination and repair.



#### NOTE!

- In case of water leakage, please shut off the angle valve and cut off the power at the same time.

**Please first check the following things when you think the product is malfunction.**

Check the Power Supply: check whether the power resource works normally and whether the leakage current protector trips.

Check Water Supply: check whether the water supply is normal and the angle valve shut off.

**In case of the following phenomena, please cut off the power immediately:**

The buzzer making the «beep» sound continuously or the leakage current protector trips frequently.

### ■ No Function

MALFUNCTION	CAUSE	FAULT CLEARANCE
No Function	Product in Stand-by-Mode	Open lid to deactivate the Stand-by Mode
	Leakage protective trips	Press Reset button of the leakage protective

### ■ Remote Control

MALFUNCTION	CAUSE	FAULT CLEARANCE
Not working	Remote control turned off	Press <b>23</b> Setting for 2 sec. to turn it on
<b>8</b> Logo Indicator blinks on and off	The storage battery is low	Connect the standard charge cable to the <b>23</b> Charging on the remote control
Not sensitive	Beyond the inductive distance	Please use the remote control within the inductive distance

### ■ Rear and Front Wash

MALFUNCTION	CAUSE	FAULT CLEARANCE
Spray arm move out too slowly	Self-cleaning	Please wait for a moment
Low Water Volume	Water Volume set too low	Increase Water Volume
Low Water Temperature	Water Temperature set too low	Increase Water Temperature
Water stop suddenly	Leaving the seat during washing	Seated and restart the washing
Spray arm extending without water spraying out	Seat fails to sense seated	Move or resealed to cover the sensing area and restart the function



# MALFUNCTIONS DURING OPERATION

---

## ■ Dry

MALFUNCTION	CAUSE	FAULT CLEARANCE
Low Air Temperature	Air Temperature set too low	Increase Air Temperature
Not working	Seat fails to sense seated	Move or resealed to cover the sensing area and restart the function

## ■ Massage

MALFUNCTION	CAUSE	FAULT CLEARANCE
Not working	Started not during washing	Restart Massage during washing

## ■ Heating of the Seat

MALFUNCTION	CAUSE	FAULT CLEARANCE
Low Seat Temperature	Seat Temperature set too low	Increase Seat Temperature
High Seat Temperature	Seat Temperature set too high	Reduce Seat Temperature
Low Seat Temperature when seated and go normal then	Eco mode on	Turn off Eco mode

## ■ Opening and Closing the lid and seat

MALFUNCTION	CAUSE	FAULT CLEARANCE
Auto Open not working	Auto Open off	Set Auto Open as Lid or Seat
	Lid not closed	Close lid
	Less than 10 sec. after last Auto Close	Wait for 10 seconds after last Auto Close
Auto Close not working	The user still moving within the inductive distance	Leave the inductive distance or be static for 2 minutes
Seat not opened by Auto Open	Auto Open is off or set as Lid	Set Auto Open as Seat
	Lid not closed	Close lid
	Less than 10 sec. after last Auto Close	Wait for 10 seconds after last Auto Close



## MALFUNCTIONS DURING OPERATION

### ■ Deodorize

MALFUNCTION	CAUSE	FAULT CLEARANCE
Not working	Deodorize off	Turn on Deodorize
	Seat fails to sense seated	Move or reseat to cover the sensing area and restart the function
	During washing	Wait for washing to finish and Deodorize will start automatically
Still working after leaving seat	Deodorize continues for 60 seconds after leaving seat for better effect	Normal.

### ■ Night Light

MALFUNCTION	CAUSE	FAULT CLEARANCE
Night light not working	Night light in OFF mode	Switch night light to ON or AUTO mode
Night light always on	Night light in ON mode	Switch night light to AUTO or OFF mode

### ■ Descale

MALFUNCTION	CAUSE	FAULT CLEARANCE
Spray arm moving back automatically	No operations are done within 3 minutes after it moves out	Please restart the spray arm cleaning
Water is spraying out when turning on Descale	Sensing area covered by conducting medium	Please remove the conducting medium

### ■ Alarm Function

MALFUNCTION	CAUSE	FAULT CLEARANCE
Continuous «beep»	Water temperature topper regular	Disconnect the main plug and contact customer service
Leakage protector trips frequently	Current leakage exceeds the normal value	Disconnect the main plug and contact customer service



DIMENSION

■ [E322-02]

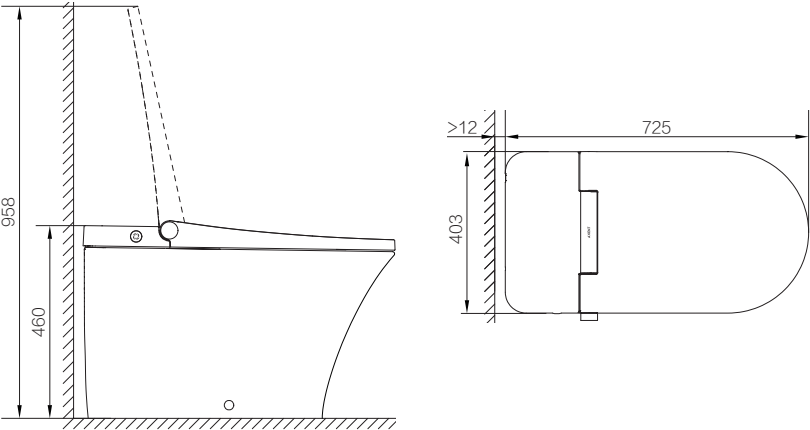

Unit: mm



## TECHNICAL DATA

ITEM		DESCRIPTION
Article No		E322-02
Nominal voltage		120V ~, 60Hz
Power consumption (max.)		1860W
Nominal power consumption		1050W
Power cord		≥ 70.8 inch (1.8 m)
Flow pressure range		14.5 - 108.8 psi ( 0.1 - 0.75 MPa )
Water outlet temperature range		39 - 95 °F ( 4 - 35 °C )
Adaptable room temperature range		39 - 104 °F ( 4 - 40 °C )
Net weight		97 lbs ( 44 kg )
Package size		32.6 × 19.6 × 23.3 inch ( 827 × 497 × 592 mm )
Protection degree		IPX4
Wash	Water volume	350 - 600 mL/min 5 levels
	Water temperature	88 - 102 °F (31 - 39°C) 5 levels
	Heater power	1600W
	Washing Period	3 min
	Spray arm position	5 levels
	Anti-backflow device	Anti-backflow valve
	Security device	Temperature sensor and relay
Dry	Wind speed	≥3.5m/s
	Air temperature	86 - 115 °F (30 - 46°C) 5 levels
	Heater power	200W
	Spray arm position	3 levels
	Security device	Thermal fuse and thermostat
Seat heating	Surface temperature	84 - 98 °F (29 - 37°C)
	Heater power	24W
	Security device	Temperature sensor
Lid and seat	Remote control	Open and close
	Automatic	Yes
	Descent control	Yes
Operation control		Remote control
Bluetooth		Bluetooth control and music
Side button		Rear wash, Front wash, Dry and Stop
Seat induction		Yes
Protection from low temperature burn		Yes
Abnormality notification		Beeping sound











**AXENT Corporation Ltd.**

info@axentbath.com  
www.axentbath.com