

FCC Compliance Statements

This device complies with Part 15 of the FCC Rules. Operation is subject to the following two conditions: (1) this device may not cause harmful interference, and (2) this device must accept any interference received, including interference that may cause undesired operation.

Note: This equipment has been tested and found to comply with the limits for a Class B digital device, pursuant to Part 15 of the FCC Rules. These limits are designed to provide reasonable protection against harmful interference in a residential installation. This equipment generates, uses and can radiate radio frequency energy and, if not installed and used in accordance with the instructions, may cause harmful interference to radio communications. However, there is no guarantee that interference will not occur in a particular installation.

If this equipment does cause harmful interference to radio or television reception, which can be determined by turning the equipment off and on, the user is encouraged to try to correct the interference by one or more of the following measures:

- Reorient or relocate the receiving antenna.
- Increase the separation between the equipment and receiver.
- Connect the equipment into an outlet on a circuit different from that to which the receiver is connected.
- Consult the dealer or an experienced radio/TV technician for help.

Caution: Changes or modifications not expressly approved by the party responsible for compliance could void the user's authority to operate the equipment.

This equipment complies with FCC radiation exposure limits set forth for an uncontrolled environment. This transmitter must not be co-located or operating in conjunction with any other antenna or transmitter.

VOLANTEX RC



1/14 RC Racing Car User Manual

CAUTIONS

The following terms are used throughout the product literature to indicate various levels of potential harm when operating this product:

NOTICE: Procedures, which if not be properly followed, will create a possibility of physical property damage AND or possibility of injury.

WARNING: Read the **ENTIRE** instruction manual to become familiar with the features of the product before operating. Failure to operate the product correctly can result in damage to the product, personal property and cause serious injury.

This is a sophisticated hobby product. It must be operated with caution and common sense and requires some basic mechanical ability. Failure to operate this Product in a safe and responsible manner could result injury or damage to the product or other property. This product is not intended for use by children without direct adult supervision. Do not use with incompatible components or alter this product in any way outside of the instructions provided by SHAANTOU CHENGHHAI TENGHUI PLASTIC TOYS FACTORY. This manual contains instructions for safety, operation and maintenance. It is essential to read and follow all the instructions and warnings in the manual, prior to assembly, setup or use, in order to operate correctly and avoid damage or serious injury.

AGE RECOMMENDATION: NOT FOR CHILDREN UNDER 14 YEARS. THIS IS NOT A TOY.

Safety Precautions and Warnings

As the user of this product, you are solely responsible for operating in a manner that does not endanger yourself and others or result in damage to the product or property of others.

Always keep a safe distance in all directions around your model to avoid collisions or injury. This model is controlled by a radio signal subject to interference from many sources outside your control. Interference can cause momentary loss of control.

Always operate your vehicle in open space away from full-size vehicles, traffic, people and animals.

Always carefully follow the directions and warnings for this and any optional support equipment(chargers, rechargeable battery packs, etc.).

Always keep all chemicals, small parts and anything electrical out of the reach of children.

Always avoid water exposure to all equipment not specifically designed and protected for this purpose. Moisture causes damage to electronics.

Never place any portion of the vehicle in your mouth as it could cause serious injury or even death.

Never operate your vehicle with low trasmitter batteries.

Always keep your vehicle in sight and under control.

Always use fully charged batteries.

Always keep transmitter powered on while your vehicle is power on.

Always remove batteries before disassembly.

Always keep moving parts clean.

Always keep parts dry.

Always let parts cool after use before touching.

Always remove battereis after use.

Never operate your vehicle with damaged wiring.

Box Contents



Charging Warnings

The battery charger included with your vehicle is designed to safely balance and charge the battery.

CAUTION: All instructions and warnings must be followed exactly. Mishandling of batteries can result in a fire, personal injury, and/or property damage.

- By handling, charging or using the included battery, you assume all risks associated with lithium batteries.
- If at any time the battery begins to balloon or swell, discontinue use immediately. If charging or discharging, discontinue and disconnect. Continuing to use, charge or discharge a battery that is ballooning or swelling can result in fire.
- Always store the battery at room temperature in a dry area for best results.
- Always transport or temporarily store the battery in a temperature range of 40–120°F (5–49°C). Do not store battery or vehicle in a car or direct sunlight. If stored in a hot car, the battery can be damaged or even catch fire.
- Always charge batteries away from flammable materials.
- Always inspect the battery before charging and never charge damaged batteries.
- Always disconnect the battery after charging, and let the charger cool between charges.
- Always constantly monitor the temperature of the battery pack while charging.
- **ONLY USE A CHARGER SPECIFICALLY DESIGNED TO CHARGE BATTERIES.** Failure to charge the battery with a compatible charger may cause fire resulting in personal injury and/or property damage
- Never discharge battery cells to below 3V under load.
- Never cover warning labels with hook and loop strips.
- Never leave charging batteries unattended.
- Never charge batteries outside recommended levels.
- Never attempt to dismantle or alter the charger.
- Never allow minors to charge battery packs.
- Never charge batteries in extremely hot or cold places (recommended between 40–120°F or 5–49°C) or place in direct sunlight.

Charging Guide



1. Power off your vehicle.
2. Carefully plug the charger into the USB port on your computer or USB adapter.
3. Connect battery into the charger.

4. The charging process takes approximately 3.5 hours. For safety reasons, never charge the battery for longer than 4 hours. While charging, the red LED will be solid, and green LED will be flashing.

When the charging is finished, the red LED will be off, and green LED will be solid.



How-to-start Guide

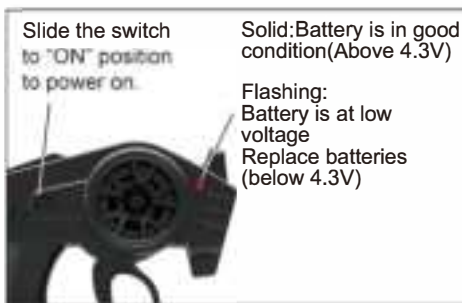

1. Install 2 x AA batteries (not included) into the transmitter, power on the transmitter.
2. Move the power switch to "ON" position on the bottom of the car.

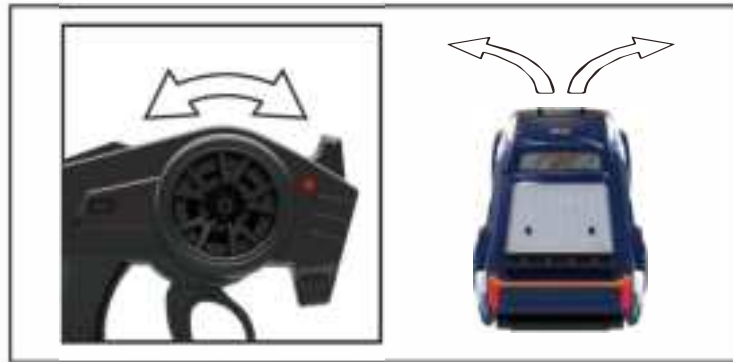
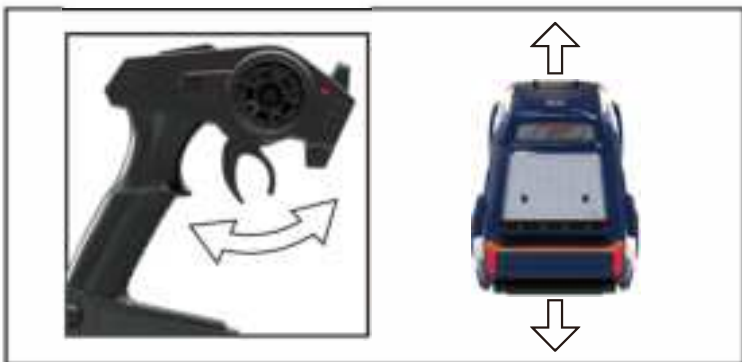

3. To slowly drive forward, pull the throttle trigger slightly. Adjust the speed by pulling the trigger. Push the trigger to brake/reverse. Release the trigger to keep your vehicle still.

4. Rotate the wheel counter-clockwise to turn left. Rotate the wheel clockwise to turn right.

Running Tips:

1. Run your vehicle on a flat surface, and keep your vehicle in sight.
2. Always release the throttle trigger right away following a crash to prevent further damages.
3. Do not run your vehicle in an area with people or property nearby.
4. When you finish, always turn off your transmitter AFTER your vehicle power.
5. Always keep the battery unplug when you are not attempt to run the vehicle.

Switch to drifting tires

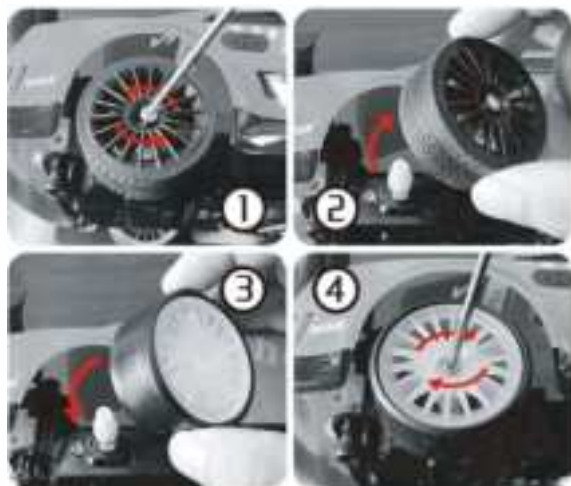

1. Use a Philips screw driver to loosen the screw from the rims by counter-clockwise direction.
2. Remove all the 4 rims with speed tires from the chassis.
3. Install the rims with drifting tires.
4. Tighten the rims to the chassis by clockwise direction.

Product Description : RADIO CONTROL TOYS NO.EXA785043