

Bluetooth Party Speaker

User's Guide for Model ISB212 v3079-01



Features

- Bluetooth wireless 5.3: range 60 ft.
- Micro SD card port
- USB port
- Built-in rechargeable battery: approximately 4 hours of playtime at 50% volume with LED lights OFF
- Micro-USB port for battery recharge

Includes

- User's Guide
- Micro-USB to USB charging cable

Controls

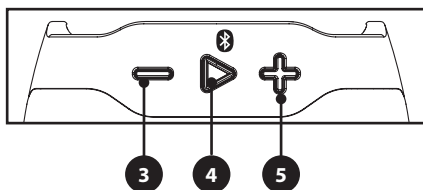
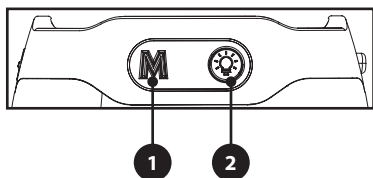

1. **Mode:** Press to change source modes to Bluetooth, USB or Micro SD/TF.
2. **LED Lights:** Press to turn LED lights ON. Repeatedly press to shuffle through different light modes. Quickly press two times to turn Rhythmic mode ON/OFF. Press and hold to power turn LED lights OFF.
3. **Volume-/Previous:** Press to decrease volume level. Press and hold to play previous track.
4. **Play/Pause/Pair:** While playing music, press to play/pause tracks. Press and hold for 3 seconds to pair Bluetooth device manually.
5. **Volume+/Next:** Press to increase volume level. Press and hold to play the next track.

Note: Press and hold both the **Volume+ & Volume-** buttons at the same time to turn voice prompts ON/OFF.

Inputs

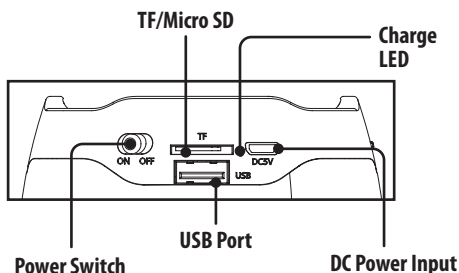

Charging the Battery

To charge the internal battery, plug the USB charging cable into the DC Power Input on the speaker and a powered-on computer or USB power adapter (not included) and standard power outlet. Charging time is approximately 5 hours.

When the battery is low a voice will announce "Low Battery," then the unit will automatically power OFF after 3-5 minutes.

While the unit is charging the **Charge LED** will display a solid red light. When the battery is fully charged the light will turn off.

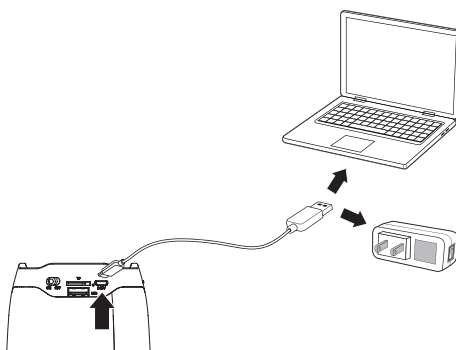

Pairing & Playing Bluetooth Audio

1. When first powered on, the speaker defaults to Bluetooth Mode and is ready to pair automatically. When pairing, remain within 3 feet of the Bluetooth device.
2. Using the controls on your Bluetooth device, select **ISB212** in the Bluetooth Settings to pair. If need be, refer to the user's manual for your specific device for more information.
3. When successfully paired, a voice will announce, "Bluetooth is connected." Your Bluetooth device will now be heard through the speaker.
4. Use the controls on the connected Bluetooth device to select and play audio. Use the speaker controls or the connected Bluetooth device to play, pause, and adjust the volume level.
5. After initial pairing, the speaker will automatically connect to the last Bluetooth device used whenever it is in Bluetooth Mode. **Note:** If your device should become unpaired or you find it is unable to connect, press and hold the **Play/Pause/Pair** button to enter to Pairing Mode. A voice will announce, "Bluetooth is connecting," and you can connect to the speaker manually.

USB & TF/Micro SD

1. Load a USB or a Micro SD memory card into the appropriate media port.
2. The speaker will automatically switch to USB/SD mode.
3. Use the controls on your device to select and play audio from the connected drive.

USB

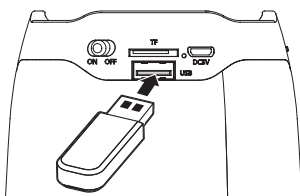

TF/Micro SD

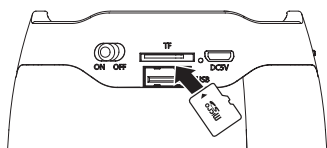

Customer Support

Customer Service: 1-888-999-4215 | **Email Support:** prodinfo@dpiinc.com | **Email Parts:** partsinfo@dpiinc.com

For Warranty Information and the most up-to-date version of this User's Guide, go to **www.iLiveElectronics.com**

To download this User's Guide in English, Spanish, or French, or to get answers to frequently asked questions, visit the support section at: **www.iLiveElectronics.com**

Para descargar este Manual del Usuario en inglés, español y francés, o para obtener respuestas a preguntas frecuentes, visite la sección de apoyo en: **www.iLiveElectronics.com**

Pour télécharger ce guide de l'utilisateur en anglais, espagnol ou français, ou pour obtenir des réponses à des questions fréquemment posées, consultez la rubrique d'assistance sur: **www.iLiveElectronics.com**



Copyright © 2022 Digital Products International (DPI, Inc.) All other trademarks appearing herein are the property of their respective owners. Specifications are subject to change without notice.

Additional Warnings

- **WARNING:** To prevent fire or shock hazards, do not expose this unit to rain or moisture.
- **WARNING:** Where the mains plug or appliance coupler is used as the disconnect device, such disconnect device shall remain readily operable.
- Lithium batteries, like all rechargeable batteries, are recyclable and should be recycled or disposed of according to state and local guidelines. They should never be disposed of in normal household waste, and they should never be incinerated, as they might explode. Contact your local government for disposal or recycling practices in your area.



WARNING: This product can expose you to chemicals including lead, which is known to the State of California to cause cancer and birth defects or other reproductive harm. For more information go to www.P65Warnings.ca.gov. This product meets and complies with required Federal product guidelines.

FCC Statement

This equipment has been tested and found to comply with the limits for a Class B digital device, pursuant to Part 15 of the FCC Rules. These limits are designed to provide reasonable protection against harmful interference in a residential installation. This equipment generates uses and can radiate radio frequency energy and, if not installed and used in accordance with the instructions, may cause harmful interference to radio communications. However, there is no guarantee that interference will not occur in a particular installation. If this equipment does cause harmful interference to radio or television reception, which can be determined by turning the equipment off and on, the user is encouraged to try to correct the interference by one or more of the following measures:

- Reorient or relocate the receiving antenna.
- Increase the separation between the equipment and receiver.
- Connect the equipment into an outlet on a circuit different from that to which the receiver is connected.
- Consult the dealer or an experienced radio/TV technician for help.

This device complies with part 15 of the FCC Rules. Operation is subject to the following two conditions:

- (1) This device may not cause harmful interference, and (2) this device must accept any interference received, including interference that may cause undesired operation.

Changes or modifications not expressly approved by the party responsible for compliance could void the user's authority to operate the equipment.