





APP quick start instruction manual



Customer Service

Our friendly customer service team will work hard to put a smile back on your face. Here's how we can connect:

-  Lifetime technical support
-  www.iscooterglobal.com
-  www.facebook.com/iScooterGlobal
-  support@iscooterglobal.com

Thank you so much for your support.



iScooter
i10MAX



EN	-----	01 ~ 09
FR	-----	10 ~ 18
ES	-----	19 ~ 27

EN

QUICK START

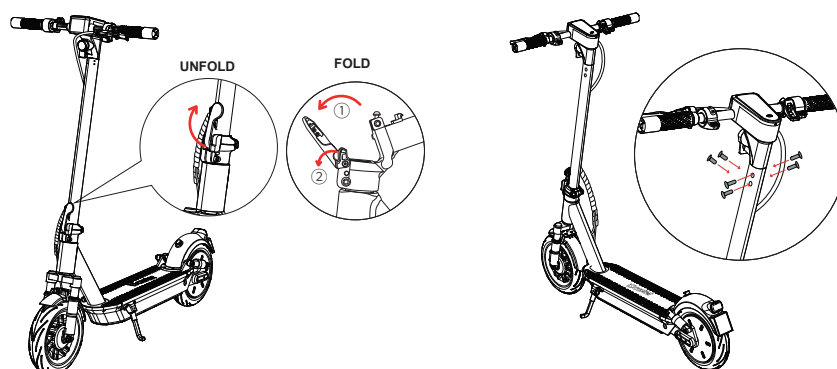

Step 1. Unfold: Close the latch properly until you hear a clicking sound. (Make sure to close tightly)
Fold: ① Open the latch ② Press down the safety switch.

Step 2. Insert the all 6pcs screws into the holes, then tighten each of them.

TIPS

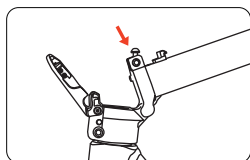

A

A) If the folding mechanism is too loose or too tight, please adjust the silver screw to make it a little higher or shorter. (Image A)

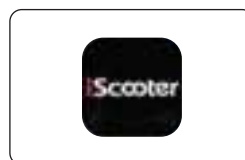

B

B) Download the "iScooter" app from the App Store (iPhone) or Google Play (Android phone) for more information and functions.

Contents

1. Package Contents	01
2. Product Overview	02
3. Charging	04
4. First Riding	04
5. Riding Basics	05
6. Riding Notice	06
7. Folding and Carrying	06
8. Daily Care and Maintenance	07
9. Specifications	08
10. Question & Answer	09
11. Contact Us	09

FR

DÉMARRAGE RAPIDE

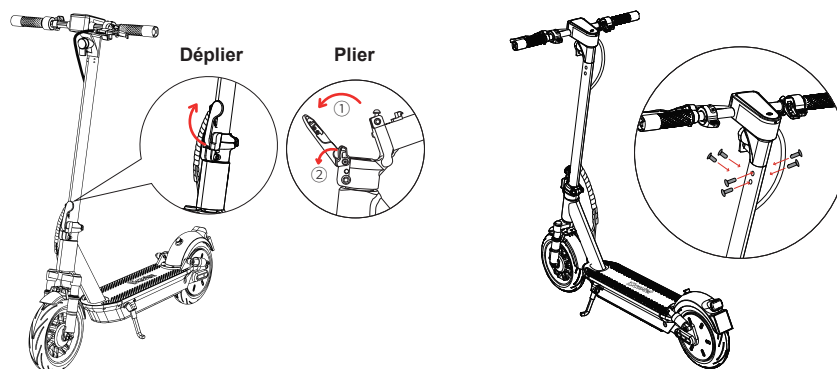

Étape 1. Déplier : Fermez correctement le loquet jusqu'à ce que vous entendiez un déclic. (Veillez à bien fermer)

Plier : ① Ouvrez le loquet ② Appuyez sur l'interrupteur de sécurité.

Étape 2. Insérez les 6 vis dans lestrous, puis serrez chacune d'entre elles.

CONSEILS

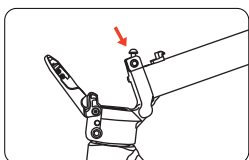

A

A) En cas de mécanisme de pliage trop lâche ou trop serré, il convient d'ajuster la vis argentée pour le rendre un peu plus haut ou un peu plus court. (Image A)

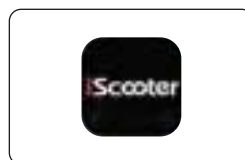

B

B) Téléchargez l'application "iScooter" sur l'App Store (iPhone) ou Google Play (téléphone Android) pour plus d'informations et de fonctionnalités.

Sommaire

1. Contenu du paquet	10
2. Aperçu du produit	11
3. Chargement	13
4. Premier tour	13
5. Bases de l'équitation	14
6. Avis d'équitation	15
7. Pliage et transport	15
8. Soins et entretien quotidiens	16
9. Spécifications	17
10. Questions et réponses	18
11. Nous contacter	18

ES

INICIO RÁPIDO

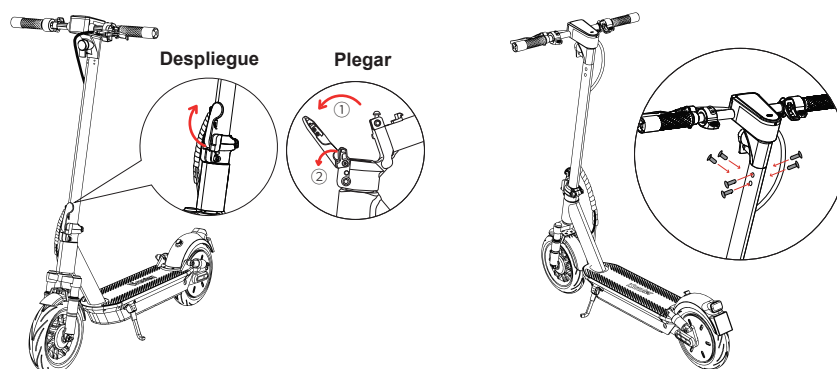

Paso 1. Despliegue: Cierra el pestillo de manera adecuada hasta que escuches un clic. (Asegúrate de cerrar con firmeza)

Plegar: ① Cierra el pestillo ② Pulsa hacia abajo el interruptor de seguridad.

Paso 2. Inserte los 6 tornillos en los orificios, y luego ajuste cada uno.

CONSEJOS

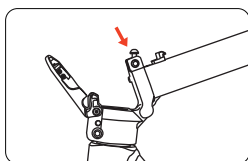

A

A) Si el mecanismo de sujeción está muy suelto o ajustado, regule los tornillos plateados para aumentar o reducir su altura (Imagen A).

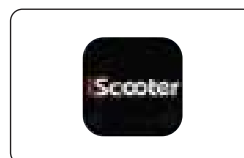

B

B) Descargue la aplicación "iScooter" de la App Store (iPhone) o Google Play (teléfono Android) para acceder a más información y funciones.

Contenido

1. Contenido del paquete	19
2. Resumen del producto	20
3. Carga	22
4. Primera cabalgata	22
5. Conceptos básicos de equitación	23
6. Aviso de montaje	24
7. Plegado y transporte	24
8. Cuidado y mantenimiento diario	25
9. Especificaciones	26
10. Preguntas y respuestas	27
11. Detalles de contacto	27



Package Contents

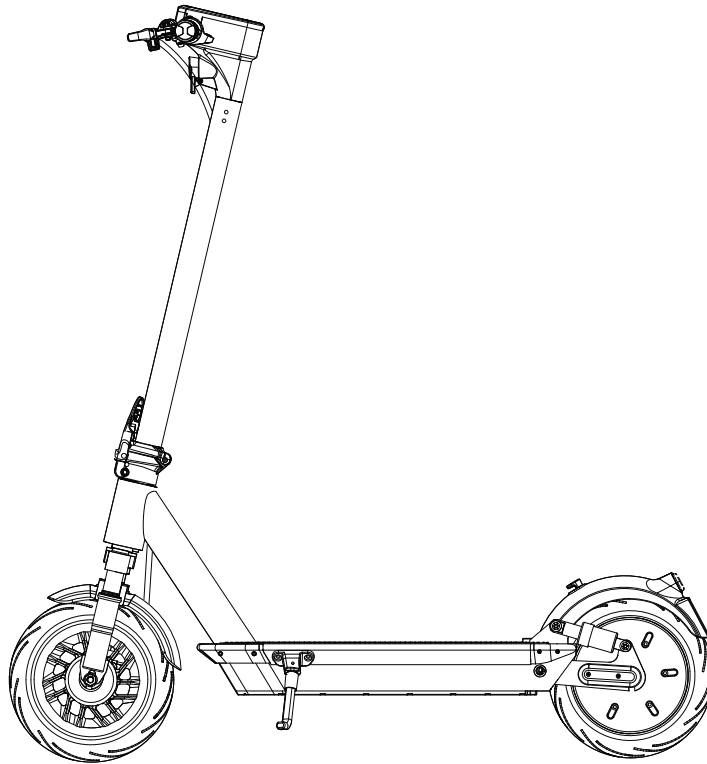

When unboxing your i10MAX electric scooter, please verify that the below items are included in the package. If anything is missing or damaged, please contact iScooter customer service for support: support@iscooterglobal.com.

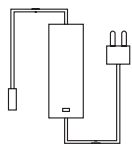

1 x Charger



6 x Screws

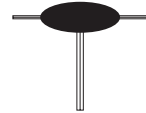

1 x Allen Wrench



Product Overview

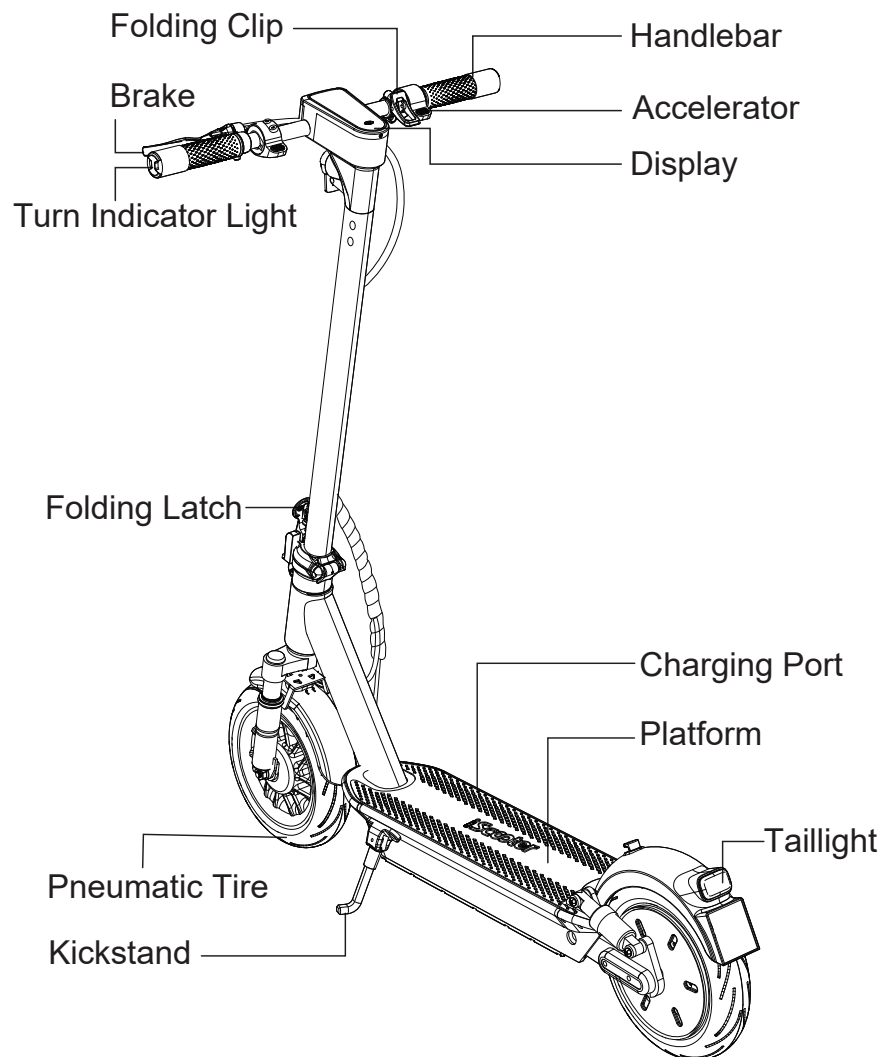



Tips

After powering on the scooter, press the throttle to accelerate. During riding, keep both feet on the deck. Or download the "iScooter" app for more information and functions.



Control Panel



Power Button

Long press for about 2 seconds to turn on / off.



Battery Indicator

The power level is indicated by four battery bar on the control panel.



Light

Turn on your scooter, one-click to turn on / off the front light.



Mode

Double-click the power button to switch speed mode.



Cruise Control

Keep same speed for 5 seconds, and it will beep and active the cruise control



Lock Indicator

The scooter can be locked and unlocked by iScooter app.



Brake tip

When braking, the icon will light up



Turning tip

Turn left or right, and the icon will light up accordingly



Temperature tip

When the motor temperature is too high, the icon lights up



Vehicle maintenance

When the vehicle breaks down, the icon lights up

Charging

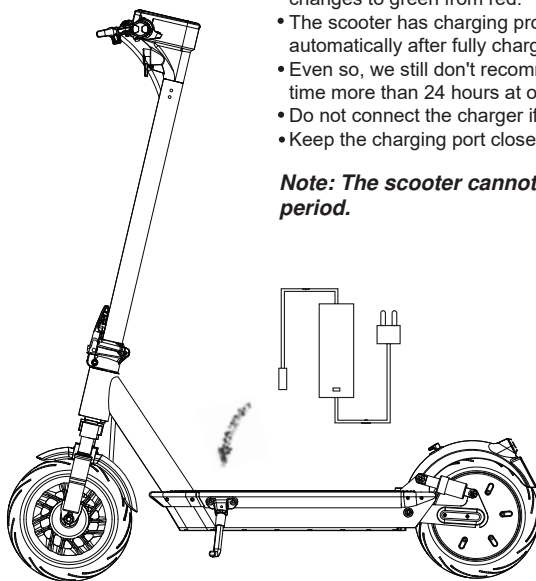

- Your scooter will be fully charged when the LED light on the charger changes to green from red.
- The scooter has charging protection and charging will cut off automatically after fully charge.
- Even so, we still don't recommend charging your scooter for a long time more than 24 hours at one time.
- Do not connect the charger if the charging port is wet.
- Keep the charging port closed when not charging.

Note: The scooter cannot be turned on during the charging period.

First Ride



Download the "iScooter" app from the App Store(iPhone) or Google Play (Android phone) for more information and functions.

When the scooter starts to coast, put both feet on the deck and press the accelerator (the accelerator initiates once the coasting speed exceeds 3 mph).



Riding Basics



❗ Wear helmets and knee pads in case of falls and injuries when you learn to ride the scooter, as shown in the figure.

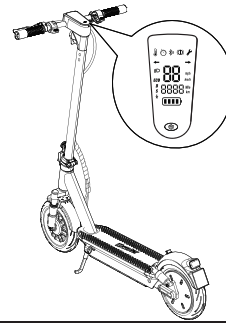

1. Turn the power on, and check the electricity indicator.

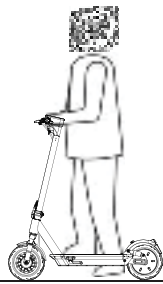

2. Stand on the base with one foot and propel yourself with the other foot.

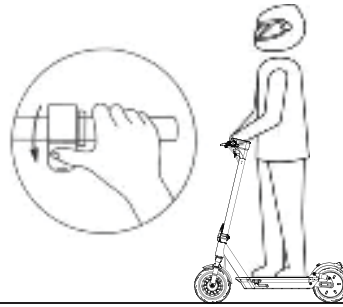

3. When the scooter starts to coast, put both feet on the deck and press the accelerator (the accelerator initiates once the coasting speed exceeds 3mph)

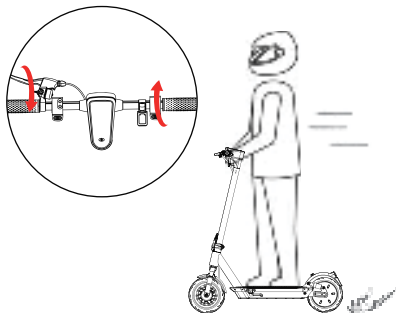

4. Release the accelerator and the kinetic energy recovery system (KERS) initiates automatically to brake slowly; And squeeze the brake lever for a sudden brake.

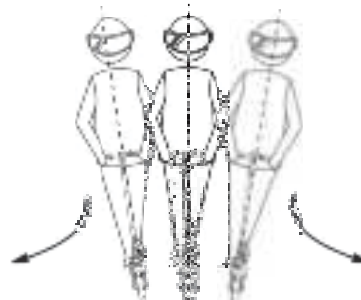

5. Tilt your body to the steering direction as you turn, and slowly turn the handlebar.



Riding Notice

The iScooter i10MAX electric scooter is a leisure device. But once they're in a public area, they'll be seen as vehicles, subjecting them to any risks faced by vehicles. For your safety, please follow instructions in the manual and traffic laws and regulations set forth by government and regulatory agencies.

- Respect pedestrians' right of way. Try not to startle them while driving, especially children. When you ride from behind pedestrians, ring your bell to give them a heads-up and slow your scooter to pass from their left (applicable to countries where vehicles drive on the right). When you ride across pedestrians, keep to the right at a low speed. When you drive across pedestrians, keep the lowest speed or getting off the vehicle.
- Closely follow the safety instructions in the manual. iScooter shall not be liable for any financial losses, physical injuries, accidents, legal disputes and other interest conflicts resulted from actions that violate user instructions.
- Check the scooter before every use. When you note loosen parts, low battery alerts, excessive wear, strange sounds, malfunctions and other abnormal conditions, stop riding.
- WARNING – Risk of Fire – No User Serviceable Parts.



Folding and Carrying

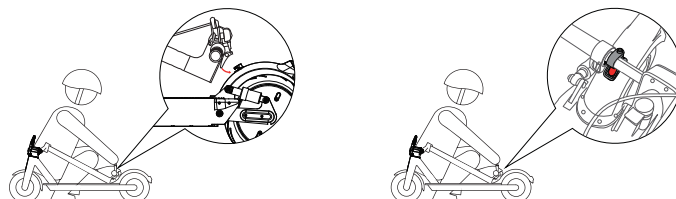
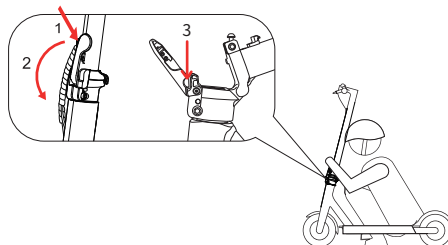

Make sure that the scooter's turned off. To fold, unlock the folding mechanism, and bend the handlebar stem to hook the buckle on the rear fender. To open, press the bell trigger to remove from the buckle, erect the handlebar and lock the folding structure.



Daily Care and Maintenance

Cleaning and storage

If you see stains on the scooter's body, wipe them off with a damp cloth. If the stains won't scrub off, put on some toothpaste, and brush them with a toothbrush, then wipe them off with a damp cloth.

Notes:

- Do not clean the scooter with alcohol, gasoline, kerosene or other corrosive and volatile chemical solvents to prevent dire damage.
- Do not wash the board with a high-pressure water spray. During cleaning, make sure that the scooter's turned off, the charging cable is unplugged, and the rubber flap is closed as water leakage may result in electric shock or other major problems. When the scooter not in use, keep it indoors where it is dry and cool.
- Do not put it outdoors for a long time. Excessive sunlight, overheating and overcooling accelerate the battery pack's lifespan.

Battery maintenance

1. Use original battery packs, use of other models or brands may bring about safety issues;
2. Do not touch the contacts. Do not dismantle or puncture the casing. Keep the contacts away from metal objects to prevent short circuit which may result in battery damage or even injuries and deaths;
3. Use original power adapter to avoid potential damage or fire;
4. Mishandling of used batteries may do tremendous harm to the environment. To protect natural environment, please follow local regulations to properly dispose used batteries.
5. After every use, fully charge the battery to prolong its lifespan.

Storage and Disposal

1. Please try to store the scooter in a cool and dry place between 14°F and 104°F. In extremely humid environments the interior of the scooter may suffer condensation or even water accumulation, which may damage the battery rapidly. Devices are not intended for use at elevations greater than 2000 m above sea level Prolonged exposure to uv rays, rain and the elements may damage the enclosure materials. Store indoors when not in use.
2. In daily use, try to avoid recharging the scooter after completely exhausting the battery. If the battery is low, charge it as soon as possible.
3. Please charge the scooter every other month to preserve the battery.

Specifications

i10MAX	Item	Electric Scooter
Dimensions	Unfolded (Length. x Width x Height)	46.8*20.8*48.8 inch/117*53*124CM
	Folded (Length. x Width x Height)	46.8*20.8*21.6 inch/117*53*55CM
Weight	Net Weight	46.7lbs/21.2 kg
User	Load	264lbs/120kg
	Recommended Age	14+
Scooter	Max.Speed	28 mph/45 km/h
	Max.Range	Up to 50miles/80km
	Max.Slope	15%
	Operating Temperature	32-104°F(0-40°C)
	IP Rating	IP54
Battery	Voltage	48 V
	Max.Charging Voltage	54.6 V
	Capacity	15.6 AH
Motor	Power	750 W
Charger	Input Voltage	100-240 V
	Output Voltage	54.6V
	Output Current	2 A
	Charging Time	8-9 h

- (1) The height of the body: Distance from the ground to the highest end of the body.
- (2) Description of the battery life: It is measured under the condition of full charge, a load of 150 lb (68kg), at 77°F(24°C), on a flat road without wind, and at a speed of 9.3 mph. The real battery life will differ with different factors of the load, humidity, wind speed and operation habits.
- (3) The maximum allowable weight shall be kept within 264 lb (120kg) (driver and objects included) in any case. Consider an extra weight of the clothes or other accessories with us during the trip and the gravity generated by speed, the scooter will not support it if this load limit is exceeded.



Question & Answer

1. What if the E-Scooter arrived missing accessory or broken part?

A: Please take a photo and send to iScooter Support Team. And iScooter Support Team will reply you soon and send correct accessory or part replacement.

2. Is the tire replaceable and how to replace the tire?

A: Yes, the tire is replaceable. Please contact iScooter support team for more information or search the video "How to replace the pneumatic tire in YouTube."

3. Why the screen returns an error code?

A: If you see any error code below, Please contact iScooter Support Team to remove the error code.

E1	Motor HOYER malfunction	E6	Instrument/controller communication malfunction
E2	MOS tube malfunction	E7	Overvoltage protection
E3	Brake malfunction	E8	Controller operational amplifier malfunction
E4	Accelerator malfunction	E9	Locked-rotor malfunction
E5	Undervoltage protection	E0	Temperature protection



Contact Us

Contact us if you experience issues relating to riding, maintenance and safety, or errors/faults with your iScooter i10MAX electric scooter.

✉ E-mail Service: support@iscooterglobal.com

🌐 www.iscooterglobal.com