

# RAVEMEN

ABF01

Product Manual  
Manuel du produit  
Bedienungsanleitung  
Manuale del prodotto  
Manual del producto  
제품 설명서  
製品マニュアル  
产品说明书



service@ravemen.com



Works with  
**Apple Find My**



Fully charge the device before first use.  
Chargez complètement l'appareil avant la première utilisation.  
Laden Sie das Gerät vor dem ersten Gebrauch vollständig auf.  
Caricare completamente il dispositivo prima del primo utilizzo.  
Cargue completamente el dispositivo antes del primer uso.  
처음 사용하기 전에 기기를 완전히 충전하세요.  
初めて使用する前にデバイスを完全に充電してください。  
首次使用前请将设备充满电。



**WARNING/AVERTISSEMENT/WARNUNG/  
ATTENZIONE/ADVERTENCIA/警告/경고**

Li-ion battery inside  
Batterie Li-ion à l'intérieur  
Batteria agli ioni di litio all'interno  
Bateria de iones de litio en el interior  
内置锂电池 / 내부에 리튬 이온 배터리  
リチウムイオン電池内蔵



Keep the charging port dry and clean to prevent corrosion/short circuits.

Gardez le port de charge sec et propre pour éviter la corrosion/les courts-circuits.

Halten Sie den Ladeanschluss trocken und sauber, um Korrosion/Kurzschlüsse zu vermeiden.

Mantenere la porta di ricarica asciutta e pulita per evitare corrosione/cortocircuiti.

Mantenga el puerto de carga seco y limpio para evitar corrosión o cortocircuitos.

부식/단락을 방지하려면 충전 포트를 건조하고 깨끗하게 유지하십시오.

腐食やショートを防ぐために、充電ポートを乾燥した清潔な状態に保ってください。

保持充电端口干燥、清洁以防止腐蚀/短路。



## Quick Guide/Guide rapide/Guía rápida/Guida rapida

빠른 가이드/クイックガイド/快速指南

- 1 Power button  
Bouton d'alimentation  
Einschalttaste  
Pulsante di accensione  
Botón de encendido  
전원 버튼  
電源ボタン  
电源按钮

- 2 Indicators  
Voyants lumineux  
Kontrollleuchten  
Luci di segnalazione  
Luces indicadoras  
표시등  
表示灯  
指示灯

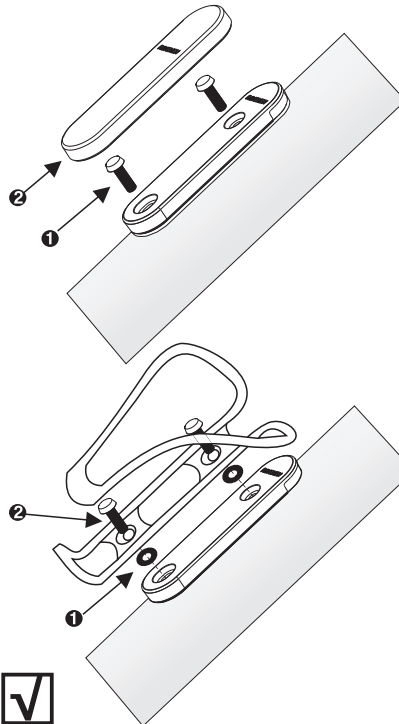
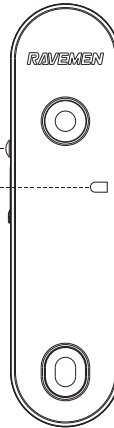

Put the hex key in a safe place for future use.

Rangez la clé hexagonale dans un endroit sûr pour une utilisation ultérieure.

Bewahren Sie den Inbusschlüssel für die zukünftige Verwendung an einem sicheren Ort auf.

Riporre la chiave esagonale in un luogo sicuro per un uso futuro.

Guarde la llave hexagonal en un lugar seguro para usarla en el futuro.

육각 렌치는 나중에 사용할 수 있도록 안전한 곳에 보관하세요.  
六角レンチは、将来使用するために安全な場所に保管してください。  
將六角扳手放在安全的地方以備將來使用。

To use the Apple Find My app to locate this item, the latest version of iOS, iPadOS, or macOS is recommended.

The Find Items app on Apple Watch requires the latest version of watchOS.

### Power button

1) On/off: Press and hold the button for 3 seconds to turn on the device with 6 beeps; Triple-click the button within 2 seconds to turn off the device, a confirmation chime will sound and the light will flash three times.

2) The device is on if there are 3 beeps after double-clicking the button, otherwise it is off.

### Pairing and time-out

The device is in pairing mode when turned on. Hold near device and open the Apple Find My app and follow onscreen instructions for pairing. The device will enter sleeping mode after 10 minutes without pairing. Click the power button again to pair.

### Lost Mode

A message will be sent to your phone (time varies) when the device is disconnected. If your item ever goes missing, you can put it in Lost Mode to display a message and contact information to anyone who might find it.

### Low battery

A low-battery message will be sent to your phone when the device is connected.

### USB-C charging

Standard charging time: about 2 hours(5V, DC/0.14A). Built-in over-charge/discharge protection.

### Charging indicator

Constant green light: charging;  
Green light off: fully charged.

### Factory reset

Turn on the device, double click the power button, then press and hold the power button for 5 seconds. You will hear beeps during the process and a confirmation chime will sound when the reset is finished.

### Warranty policy

1. Two years warranty for the products to be free of defects in material and workmanship from the day of purchase under normal use.
2. One-year warranty for accessories and battery.
3. Limited lifetime warranty support.
4. Contact the seller or us for warranty service.

### Warranty exclusions

1. Normal wear/tear and normal battery deterioration.
2. Improper use and maintenance, unauthorized modifications or alterations.
3. No sales receipt or proof of the purchase.

Use of the Works with Apple badge means that a product has been designed to work specifically with the technology identified in the badge and has been certified by the product manufacturer to meet Apple Find My network product specifications and requirements. Apple is not responsible for the operation of this device or use of this product or its compliance with safety and regulatory standards.

Apple, Apple Find My, Apple Watch, Find My, iPhone, iPad, iPadOS, Mac, macOS and watchOS are the trademarks of Apple Inc., registered in the U.S. and other countries. IOS is a trademark or registered trademark of Cisco in the U.S. and other countries and is used under license.

Apple, Apple Find My, Apple Watch, Find My, iPhone, iPad, iPadOS, Mac, macOS and watchOS are the trademarks of Apple Inc., registered in the U.S. and other countries. The trademark "iPhone" is used with a license from Aiphone K.K.

### FCC Warning

This device complies with part 15 of the FCC Rules.

Operation is subject to the following two conditions:

- (1) This device may not cause harmful interference, and
  - (2) this device must accept any interference received, including interference that may cause undesired operation.
- Any Changes or modifications not expressly approved by the party responsible for compliance could void the user's authority to operate the equipment.

This equipment has been tested and found to comply with the limits for a Class B digital device, pursuant to part 15 of the FCC Rules. These limits are designed to provide reasonable protection against harmful interference in a residential installation. This equipment generates uses and can radiate radio frequency energy and, if not installed and used in accordance with the instructions, may cause harmful interference to radio communications. However, there is no guarantee that interference will not occur in a particular installation. If this equipment does cause harmful interference to radio or television reception, which can be determined by turning the equipment off and on, the user is encouraged to try to correct the interference by one or more of the following measures:

- Reorient or relocate the receiving antenna.
- Increase the separation between the equipment and receiver.
- Connect the equipment into an outlet on a circuit different from that to which the receiver is connected.
- Consult the dealer or an experienced radio/TV technician for help.

The device has been evaluated to meet general RF exposure requirement. The device can be used in portable exposure condition without restriction.