

PMS 807 does not print. Diecut only.
Folds to 3.5in x 5in

1 DOWNLOAD THE APP



Download the Moultrie Mobile App to set up your camera, remotely control settings, view your photos and videos, and more.



SCAN HERE TO
DOWNLOAD

ACTIVE SUBSCRIPTION:
An active Moultrie Mobile subscription is required to use your camera.



Apple and the Apple logo are trademarks of Apple Inc., registered in the U.S. and other countries. App Store is a service mark of Apple Inc. Google Play is a trademark of Google Inc.

2 ACTIVATE YOUR CAMERA

- 1 Log in or sign up for a Moultrie Mobile account
- 2 Add device
- 3 Follow in-app instructions through activation

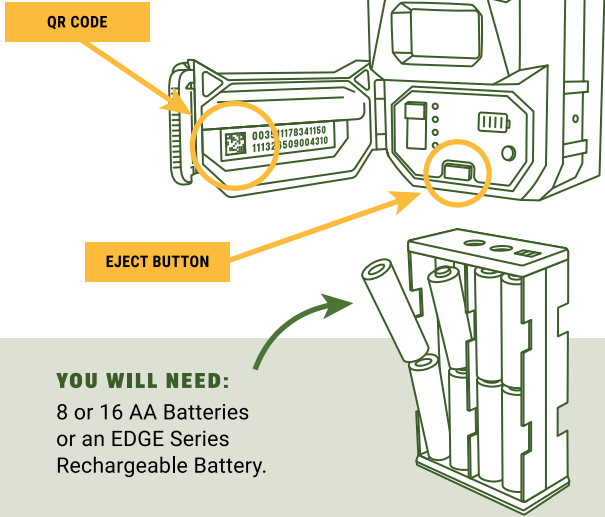

YOU WILL NEED:
8 or 16 AA Batteries
or an EDGE Series Rechargeable Battery.

IMPORTANT: (1) Do not mix battery types (Alkaline, Lithium). (2) Do not use rechargeable AA batteries. Use recommended AA batteries (Moultrie Mobile Alkaline, Energizer Alkaline, Energizer Lithium) or compatible EDGE Series Rechargeable Battery Pack.

TROUBLESHOOTING

CAMERA WON'T CONNECT

If the red **NOT CONNECTED** light is on:

- Make sure camera has an **active** subscription with Moultrie Mobile.
- Move the camera to a location with a stronger signal.

COMPARING TO CELL PHONE SIGNAL

Your camera's signal strength is not tied to your cell phone plan and may be higher or lower than your smartphone. EDGE 2 PRO will function with a weaker signal than your smartphone and **will automatically try to connect to the strongest network in your area.**

MANAGING IMAGES / MEMORY

- All pictures and downloads can be viewed and managed in the Moultrie Mobile App, even if they have been cleared from the camera's memory.
- **PRO TIP:** Request hi-res images and full video clips soon after they appear in your gallery. Hi-res versions are not automatically uploaded prior to onboard memory clean-up.

NEED HELP?

For resources, troubleshooting, and support contact our U.S.-based Customer Success team.

Support.MoultrieMobile.com

Customer Success: 1-844-908-1219

INSIDE FRONT COVER

INSIDE BACK COVER

INSIDE FLAP

TIPS

MOUNTING TIPS

- Mount the camera three to five (3-5) feet above ground.
- Clear any brush and tree limbs in the field of view.

MAXIMIZE BATTERY LIFE

To extend battery life, choose:

- An upload frequency of every 3 hours (or less frequent).
- A detection delay of 10 seconds (or longer).

ACCESSORIES

**SHOP ALL EDGE SERIES ACCESSORIES
AT MOULTRIEMOBILE.COM**



POWER MAG
RECHARGEABLE
LITHIUM BATTERIES



EDGE SERIES
SOLAR POWER
PACKS



FLEX MOUNT 2
MULTI-DIRECTIONAL
CAMERA MOUNT

WARRANTY



- This product has been thoroughly tested and inspected before shipment. **It is guaranteed from defects in material and workmanship from the date of purchase for 2 years.**
- Under this limited guarantee, we agree to replace or repair free of charge any part or parts which have been found to be defective in original material or workmanship.
- Physical damage, abuse, misuse, alterations, or tampering with the equipment is not covered and will void your warranty.
- For more warranty information, visit: **MoultrieMobile.com/shipping-returns**
- Should you require warranty service, call our Customer Success Team: **1-844-908-1219**

FCC Statements



THE MANUFACTURER IS NOT RESPONSIBLE FOR ANY RADIO OR TV INTERFERENCE CAUSED BY UNAUTHORIZED MODIFICATIONS TO THIS EQUIPMENT. SUCH MODIFICATIONS COULD VOID THE USER'S AUTHORITY TO OPERATE THE EQUIPMENT.

This device complies with the limits for a Class B digital device, pursuant to Part 15 of the FCC Rules. These limits are designed to provide reasonable protection against harmful interference in a residential installation.

This device generates, uses, and can radiate radio frequency energy and, if not installed and used in accordance with the instructions, may cause harmful interference to radio communications. However, there is no guarantee that interference will not occur in a particular installation. If this device does cause harmful interference to radio or television reception, which can be determined by turning the equipment off and on, the user is encouraged to try to correct the interference by one or more of the following measures:

- Reorient or relocate the receiving antenna.
- Connect the equipment into an outlet on a circuit different from that to which the receiver is connected.
- Increase the separation between the equipment and receiver.
- Consult the dealer or an experienced radio/TV technician for help.

Changes and modifications not expressly approved by the party responsible could void the user's authority to operate this device. This device complies with Part 15 of the FCC Rules. Operation is subject to the following two conditions: (1) This device may not cause harmful interference, and (2) this device must accept any interference received, including interference that may cause undesired operation.

MOULTRIE MOBILE



EDGE 2 PRO
CELLULAR TRAIL CAMERA

QUICK START GUIDE

INSIDE FLAP

OUTSIDE BACK COVER

OUTSIDE FRONT COVER

RF Exposure Information

This device complies with FCC radiation exposure limits set forth for an uncontrolled environment. In order to avoid the possibility of exceeding the FCC radio frequency exposure limits, human proximity to the antenna shall not be less than 20cm(8 inches) during normal operation.

ISED Notice

This device complies with Innovation, Science and Economic Development Canada license-exempt RSS standard(s). Operation is subject to the following two conditions:

- (1) this device may not cause interference, and
- (2) this device must accept any interference, including interference that may cause undesired operation of the device.

Le présent appareil est conforme aux CNR Innovation, Sciences et Développement économique Canada applicables aux appareils radio exempts de licence. L'exploitation est autorisée aux deux conditions suivantes:

- (1) l'appareil ne doit pas produire de brouillage, et
- (2) l'utilisateur de l'appareil doit accepter tout brouillage radioélectrique subi, même si le brouillage est susceptible d'en

This Class B digital apparatus complies with Canadian ICES-003.
Cet appareil numérique de la classe B est conforme à la norme NMB-003 du Canada.

ISED Radiation Exposure Statement

This device complies with RSS-102 radiation exposure limits set forth for an uncontrolled environment. In order to avoid the possibility of exceeding the ISED radio frequency exposure limits, human proximity to the antenna shall not be less than 20cm (8 inches) during normal operation.

Cet appareil est conforme aux limites d'exposition aux rayonnements de la CNR-102 définies pour un environnement non contrôlé. Afin d'éviter la possibilité de dépasser les limites d'exposition aux fréquences radio de la CNR-102, la proximité humaine à l'antenne ne doit pas être inférieure à 20 cm (8 pouces) pendant le fonctionnement normal.