

# Rapsodo®

## BASEBALL

### USER MANUAL

## YOUR RAPSODO BASEBALL KIT

### WHAT'S IN THE BOX

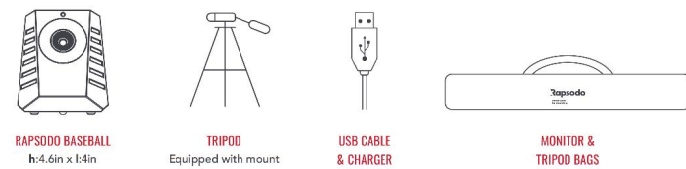

### DOWNLOAD THE RAPSODO BASEBALL APP



**THE FREE RAPSODO BASEBALL APP MUST BE DOWNLOADED IN ORDER TO USE THE DATA TRACKING MONITOR.**

#### iOS REQUIREMENTS

iPad Air, Air 2, Pro  
iOS 8.0 or later

We are always improving coverage of new devices; please refer to our website for updated list of compatible devices.



**FOR WINDOWS 10 / 8 / 7, DOWNLOAD THE APPLICATION FROM [WWW.RAPSODO.COM/BASEBALL](http://WWW.RAPSODO.COM/BASEBALL)**

## SETTING UP THE MONITOR ON THE FIELD

Rapsodo Baseball operates on a tripod that is provided in the product package. The technology is based on camera and radar. As correct positioning is important to get the quality of results, it is recommended to carefully follow the set up instructions.

### I. INSTALLING TRIPOD

1

RAISE TRIPOD

Release the legs, raise them completely in a stable position. Extend the pole so that the height of the tripod reaches approximately 6 feet.

2

POSITION TRIPOD

Position the tripod directly behind home plate: the distance between the center pole of the tripod to the back tip of the home plate should be 6 feet (approx. 2 meters). This is the optimum position for correct measurements. If you fail to place it correctly, the Strike Zone spray charts or other measured parameters may be incorrect.

### II. ATTACHING MONITOR TO TRIPOD MOUNT

3

ATTACH MONITOR TO MOUNT PLATE

Check that the extended legs are securely locked in place before mounting the monitor. A mount plate is located at the head of the tripod. Remove the mount plate and attach it to the monitor using the screw attached to the mount plate. After this step, attach the monitor to the tripod and secure it. Once the monitor is attached securely, adjust the tripod and mounts so that the camera faces the pitcher's mound.

## GETTING TO KNOW RAPSODO BASEBALL

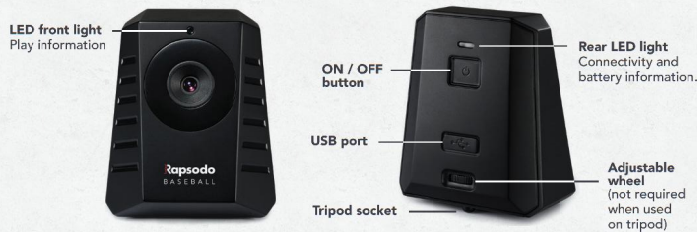

## UNDERSTANDING THE MONITOR

### CHARGING THE MONITOR

- Charge the monitor's battery by plugging in the provided USB cable (or any standard USB charger) into the port on the rear monitor panel. The rear LED will become an amber color, confirming that the device is charging.
- Once the battery level is sufficient, the rear LED will turn off.
- Note for future usages:** if the rear LED light is flashing red, the battery level is low and requires charging.
- Please refer to "Understanding LED messages" section for further details.

### TURNING ON THE RAPSODO MONITOR

- To turn the monitor on, press the ON/OFF button (located on its rear side) for 2 seconds.
- The front LED display will turn RED, which means that the monitor is switched on, but not ready to measure yet.
- The rear LED will also become active (its color depends on the state of the device. Please refer to "Understanding LED messages" section for details).

### TURNING OFF YOUR RAPSODO BASEBALL

- When the training session has concluded, just turn the Rapsodo Baseball monitor off by simply pressing on the ON/OFF button (located on its rear side), and dismantle the monitor from the tripod.
- It's recommended to store the monitor and the tripod in the bags provided with the product package.

## WHAT DATA GETS MEASURED

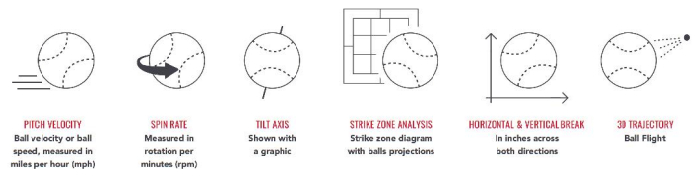

## UNDERSTANDING LED DISPLAYS

### HOW THE MONITOR WILL COMMUNICATE WITH YOU

The Rapsodo Baseball monitor features 2 LED displays, one at the front and one at the rear, which provide information during each step of the set up process and in the data tracking mode. The tables hereafter provide an overview of each status, and will be key throughout the "getting started" instructions.

### FRONT LED DISPLAY: "PLAY" INFORMATION

The front LED display provides information on the monitor status, and will give the "green light" to pitch when the device is ready to measure.



## PAIR THE MONITOR AND THE APP

To operate, Rapsodo Baseball must be connected to the Rapsodo Baseball App on a PC or tablet. Pairing can be done via USB or WIFI connection. To turn the monitor on, press the ON/OFF button (rear side) for 2 sec. The front LED display will turn RED, which means that the monitor is switched on, but not ready to measure yet.

FOR PC-WINDOWS: CONNECTING THE MONITOR VIA USB	PAIRING THE MONITOR WITH WIFI (FOR IOS DEVICES OR PC)	
	WIFI DIRECT MODE	WIFI NETWORK MODE
<ol style="list-style-type: none"><li>Turn on the monitor and start the Rapsodo Baseball app.</li><li>Make sure a USB cable is connected between the PC and the monitor. The provided cable is about 3 feet. If you need a longer distance, you must use a self-powered USB Hub (i.e. a USB Hub with its own USB power supply) for an optimum experience.</li><li>The monitor requires a "WinUSB" driver on your PC. This driver is provided by Microsoft for Windows 10, Windows 8 and Windows 7 SP1. If you are using Windows 7 without Service Pack 1, download the driver on Windows Update.</li><li>On your app, click the USB icon. A green check mark (✓) appears on it.</li></ol> <p>To confirm connection, the rear LED of the monitor will turn green, and after few seconds, the FRONT LED will turn green as well. The monitor and application are ready for measurement.</p>	<p>The WIFI Direct mode does not require an existing WIFI network or router. In this mode, the monitor will appear as a WIFI router and you can attach your device to the monitor as if it is connecting to a router. This is the <b>default mode</b> for the monitor. This means that ever if you want to connect in WIFI network mode in future uses, you need to set up this mode first to configure the Monitor to a network.</p> <ol style="list-style-type: none"><li>Connect to the access point named "RapsodoBaseball_XXXX" in WIFI. The XXXX denotes a unique number for your monitor.<ul style="list-style-type: none"><li><b>On your tablet:</b> Go to Settings -&gt; WIFI. You should see "RapsodoBaseball_XXXX". Connect by tapping it in the list.</li><li><b>On your PC:</b> Click on the WIFI signal icon on your computer and select "RapsodoBaseball_XXXX" from the dropdown menu, click "Connect". Once the connection is established, go to the Rapsodo Baseball app.</li></ul></li><li>Open the app. It will attempt to connect to the monitor. Once the connection is established, a green check mark appears on the WIFI icon and the monitor's rear LED will turn green.</li></ol>	<p>The WIFI Network mode requires an existing WIFI network. In this mode, both monitor and tablet/PC are connected to a known network and use a 3rd party router to communicate with each other. To set your monitor to join a known network, you must first connect your monitor in WIFI Direct or USB modes. After this is completed, you can configure the monitor for existing WIFI networks.</p> <ol style="list-style-type: none"><li>Double click the WIFI icon: the monitor will scan the surrounding WIFI networks and show the list of available networks.</li><li>Select the desired WIFI network and type the passphrase for the network.</li><li>The monitor will attempt to connect to the network. The connection status is displayed on the rear LED.</li></ol> <p>Once the network connection is established, the monitor will default to this configuration for WIFI and attempt to connect via a known network first. If the monitor is unable to connect to a known network after several attempts, it will default back to the WIFI Direct mode. You can always connect via USB to reset the known network configuration.</p>

**Important Note:** Only one tablet or PC can be paired to the monitor at a time. If you want to use another device, you must first disconnect the tablet and/or PC, and follow the same procedure to sync the new device.

## STARTING TO MEASURE PITCHES

The monitor should be switched on and paired to the app. The front LED display should show a green light. As a reminder, if the monitor shows a red light, it means the device is not connected.

**Anytime the monitor front LED is green, it means that it is ready for measurement, and you can pitch.**

After a pitch, the front LED of the monitor turns BLUE to indicate that it is calculating pitch data. Once the results are ready, the front LED turns GREEN and results appear automatically on your app dashboard.

**NOTE - optimum baseballs condition:** The use of synthetic cover baseballs and balls featuring surface blemishes near the seams are not recommended, as they may yield incorrect measurements.

If you have purchased a subscription, you will be able to add players and enable several other features. Please refer to [www.rapsodo.com/baseball](http://www.rapsodo.com/baseball) for further details.

The monitor captures data only if the pitched ball passes through the target area (see illustration below).

If the pitch passes beyond this target area metrics will NOT be tracked, and the monitor will not show any result. The front LED remains green, and you can immediately pitch again.

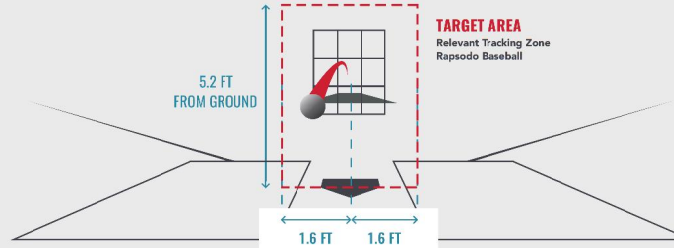

### FEDERAL COMMUNICATION COMMISSION INTERFERENCE STATEMENT

This device complies with Part 15 of the FCC Rules. Operation is subject to the following two conditions: (1) This device may not cause harmful interference, and (2) this device must accept any interference received, including interference that may cause undesired operation. This equipment has been tested and found to comply with the limits for a Class B digital device, pursuant to Part 15 of the FCC Rules. These limits are designed to provide reasonable protection against harmful interference in a residential installation. This equipment generates, uses and can radiate radio frequency energy and, if not installed and used in accordance with the instructions, may cause harmful interference to radio communications. However, there is no guarantee that interference will not occur in a particular installation. If this equipment does cause harmful interference to radio or television reception, which can be determined by turning the equipment off and on, the user is encouraged to try to correct the interference by one of the following measures:

- Reorient or relocate the receiving antenna.
- Increase the separation between the equipment and receiver.
- Connect the equipment into an outlet on a circuit different from that to which the receiver is connected.
- Consult the dealer or an experienced radio/TV technician for help.

FCC Caution: Any changes or modifications not expressly approved by the party responsible for compliance could void the user's authority to operate this equipment.

This equipment complies with FCC radiation exposure limits set forth for an uncontrolled environment. This equipment should be installed and operated with minimum distance 20cm between the radiator & your body.

### REAR LED DISPLAY: CONNECTIVITY AND BATTERY INFORMATION

The rear LED display provides information on connectivity and battery. This display will be especially important when pairing the app with the monitor.

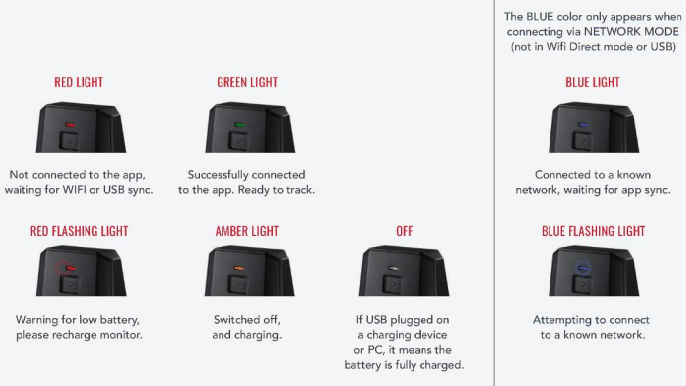

You're ready to track the pitches.