

Walkie-Talkie

OPERATING INSTRUCTION

Note:
Please read the operating instructions carefully before using the device.

Note:
- Remove the battery from radio for storage purposes. Batteries may corrode over time and cause permanent damage to your devices.
- Do not mix and use old/new/alkaline/NiMH batteries.
- Charge the supplied NiMH batteries once every 3 months when not in use.

Using the Micro-USB Charger

The micro-USB charger is a handy port that allows you to conveniently charge your NiMH battery. Use certified adaptor(5V, ≥1A). Do not attempt to charge alkaline batteries.
1. Make sure your radio is turned OFF.
2. Plug the micro-USB cable into the micro-USB charging port on your radio. Connect the other end of the micro- USB charger to wall power outlet.
3. The battery meter on LCD will move to indicate the battery is charging.

Turning your Radio On and Off

1. Press and hold on the (CALL) button to turn your radio ON/OFF.
2. The display screen then shows the current channel, code and all features that are enabled.

Setting the Volume

1. Press (▲) to increase the volume. Press (▼) to decrease the volume.
2. When the volume reached level 0 the mute (M) icon appears permanently on screen.

Setting High Low Power

1. Press (MENU) button until 'Pr' appears on the display.
2. Press (▲) or (▼) button to select HI or LO. (HI- High Power, LO- Low Power)
3. Press the PTT button to exit menu.

Keypad Tones

Press and hold the (▼) button while turning the radio ON to switch the keypad tone ON/OFF.

Roger Tone

Press and hold the (▲) button while turning the radio ON to turn the Roger Beep ON. Repeat the step to turn Roger Beep OFF.

Keypad Lock

1. To lock the radio, press and hold (MENU) button until the key lock indicator (LK) icon on display appear.
2. To unlock the radio, press and hold (MENU) button until key lock indicator (LK) icon on display disappear.
3. Repeat the step to unlock the device.

Scanning Channels

To Start Scanning:
1. Briefly press the (Mon Scan) button to start scanning. SCAN icon will appear in the display. The device will stop scrolling and receiving when matched channel and sub codes detected.
2. After the end of transmission, press the PTT button within 5 seconds to respond. The device will resume scanning after end of any received activity.
3. If you press PTT button when the device is scrolling, the transmission will be on the 'home channel'.
4. Press (Mon Scan) button to exit scanning feature.

SAFETY & GENERAL INFORMATION

FCC Warning

Any Changes or modifications not expressly approved by the party responsible for compliance could void the user's authority to operate the equipment.

This device complies with part 15 of the FCC Rules. Operation is subject to the following two conditions: (1) This device may not cause harmful interference, and (2) this device must accept any interference received, including interference that may cause undesired operation.

Note: This equipment has been tested and found to comply with the limits for a Class B digital device, pursuant to part 15 of the FCC Rules. These limits are designed to provide reasonable protection against harmful interference in a residential installation. This equipment generates, uses and can radiate radio frequency energy and, if not installed and used in accordance with the instructions, may cause harmful interference to radio communications. However, there is no guarantee that interference will not occur in a particular installation. If this equipment does cause harmful interference to radio or television reception, which can be determined by turning the equipment off and on, the user is encouraged to try to correct the interference by one or more of the following measures:
— Reorient or relocate the receiving antenna.
— Increase the separation between the equipment and receiver.
— Connect the equipment into an outlet on a circuit different from that to which the receiver is connected
— Consult the dealer or an experienced radio/TV technician for help.

KEY FUNCTIONS

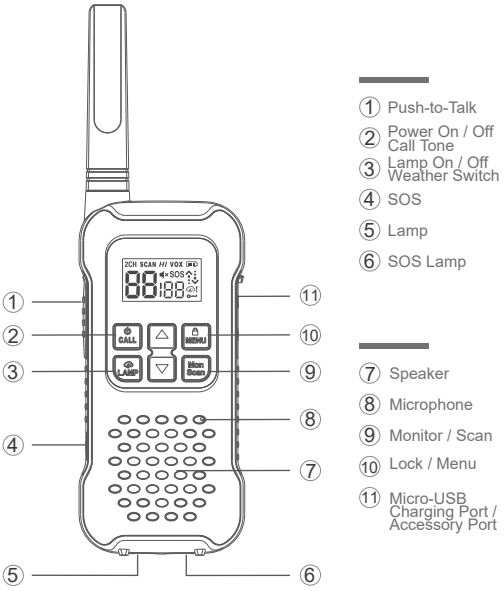

1

RECEIVING AND TRANSMITTING

To communicate, all radios in your group must be set to the same channel and sub code.
1. To talk, press and hold the PTT button. When transmitting, the (PTT) icon is shown. Release the PTT button when you are finished talking. Do not use the radios closer than five feet apart.
2. When receiving, the (R) icon is shown.

Monitor Button

1. Press and hold (Mon) button for 3 seconds to enter monitor mode and listen for weak signals on the current channel.
2. You can also press (Mon Scan) button to check for activity on the current channel before you talk.
3. Release the (Mon Scan) button to exit monitor mode.

PTT Timeout Timer

When you press PTT buttons for more than 60 seconds, radio will stop transmitting. This is to prevent accidental transmission.

Mode Button

User can use this function to switch between two-way and weather mode by press and hold (GO LAMP) for 3 seconds.

FEATURES

Setting the Channel

1. Press the (MENU) button until the channel number starts to flash.
2. Press (▲) or (▼) button to change the channel number. Press the PTT button to exit menu.

5

Notes:

If the device stops on an unintended/undesired transmission, press (▲) or (▼) button to resume scan OR temporarily remove that channel from the scan list by pressing and holding (▲) or (▼) for 3 seconds. Press (Mon Scan) to exit and re-enter scan mode to restore removed channels to the scan list.

LED Lamp

Press the (GO LAMP) button to turn ON/OFF the lamp.

Automatic Power Saving

This feature is enabled by default to enhance battery life.

Emergency SOS Mode

User can use this feature to emit SOS signal. To enter emergency SOS mode:
1. Press and hold the SOS button for 3 seconds. The RED LED light will be activated.
2. Press the button again to deactivate.

Water Activated LED

Once the devices are dropped into water, white LED will be activated automatically to ease user to locate the devices in dark environment. After retrieve the devices, press any button to deactivate except (GO LAMP) button. (GO LAMP) button will overwrite and activate LAMP feature.

9

Safety Information for Radios

Your wireless handheld portable transceiver contains a low power transmitter. When the talk button is pushed, it sends out radio frequency (RF) signals. The device is authorized to operate at a duty factor not to exceed 50%. In August 1996, the Federal Communications Commissions (FCC) adopted RF exposure guidelines with safety levels for handheld wireless devices.

Important

FCC RF Exposure Requirements: For body-worn operation, this radio has been tested and meets the FCC RF exposure guidelines when used with accessories supplied or designated for this product. Use of other accessories may not ensure compliance with FCC RF exposure guidelines. Use only the supplied antenna. Unauthorized antennas, modifications or attachments could damage the transmitter and may violate FCC regulations.

Normal Position

Hold the transmitter approximately 25 mm from your face and speak in a normal voice, with the antenna pointed up and away.

13

DISPLAY SCREEN GUIDE

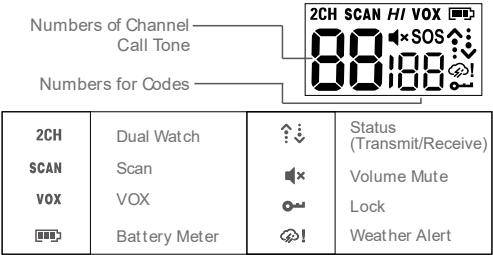

GETTING STARTED

Installing the Three AA NiMH Rechargeable Battery

1. Take the belt clip off.
2. Unlock two screws counterclockwise and open the cover to install the three AA NiMH battery according to orientation shown in battery compartment.

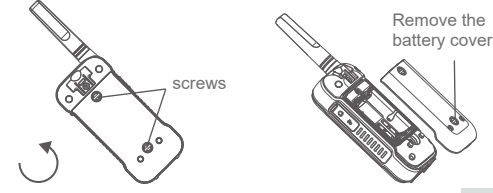

2

Channels and Frequencies

CH	Frequency (MHz)	Max Power Output	CH	Frequency (MHz)	Max Power Output
1	462.5625	2W	12	467.6625	0.5W
2	462.5875	2W	13	467.6875	0.5W
3	462.6125	2W	14	467.7125	0.5W
4	462.6375	2W	15	462.5500	2W
5	462.6625	2W	16	462.5750	2W
6	462.6875	2W	17	462.6000	2W
7	462.7125	2W	18	462.6250	2W
8	467.5625	0.5W	19	462.6500	2W
9	467.5875	0.5W	20	462.6750	2W
10	467.6125	0.5W	21	462.7000	2W
11	467.6375	0.5W	22	462.7250	2W

Setting the Sub Codes

1. Press the (MENU) button until the code number starts to flash.
2. Press (▲) or (▼) button to select code number. Press the PTT button to exit menu .

6

WEATHER RECEIVE

Entering Weather Mode

press and hold (GO LAMP) button for 3 seconds to enter weather mode.

Setting the Weather Channel

Your radio receives weather frequencies:

1. In weather mode, press the (MENU) button until weather channel number flashes.
2. Press (▲) or (▼) button to select the appropriate channel.
3. Press the PTT button to set and exit menu.

Setting the Weather Alert

Your radio can be set to respond to NOAA Weather Radio emergency messages.

1. In weather mode press the (MENU) button twice until (WA) icon displays.
2. Press (▲) or (▼) button to select On/Off.
3. Press the PTT button or (MENU) button to exit the weather menu set up. Repeat the step to disable the weather alert.

10

ISED Warning

This product meets the applicable Industry Canada technical specifications. / Le présent matériel est conforme aux spécifications techniques applicables d'Industrie Canada. This device complies with ISED license-exempt RSS standard (s). Operation is subject to the following two conditions: (1) this device may not cause interference, and (2) this device must accept any interference, including interference that may cause undesired operation of the device.

Le présent appareil est conforme aux CNR d'ISED applicables aux appareils radio exempts de licence. L'exploitation est autorisée aux deux conditions suivantes: (1) l'appareil ne doit pas produire de brouillage, et (2) l'utilisateur de l'appareil doit accepter tout brouillage radioélectrique subi, même si le brouillage est susceptible d'en compromettre le fonctionnement.

14

3. Close the battery and tighten the two screws clockwise.

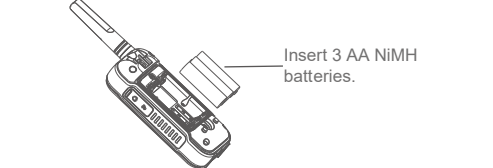

4. Tighten the screws clockwise to close the battery cover firmly.

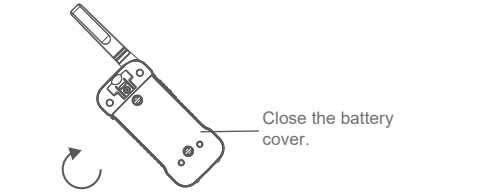

Radio Battery Meter

Battery full bars indicates battery high (Full). When battery meter shows 1 bar, device is on low battery mode and will indicate low battery alert in the forms of alert tone and blinking bar display.

3

Setting and Transmitting Call Tones

1. Press (MENU) button until call tone 'CA' appears. The current call tone setting flash.
2. Press (▲) or (▼) button to change and listen to the call tone. Press the PTT button to exit menu .

Voice Operated Transmission (VOX)

1. To activate VOX, press (MENU) button until 'VOX' appears on the display. The current setting (0, 1-3) will flash.
2. Press (▲) or (▼) button to select the sensitivity level. Press the PTT button to exit menu .

L3=High Sensitivity
L2=Medium Sensitivity
L1=Low Sensitivity
L0=Turn Off VOX function

Dual Channel Monitor

With this feature enabled, you can scan current channel and another channel alternately.

1. Press (MENU) button until '2CH' appears on the display. The current setting (OF, 1-22) will flash.
2. Press (▲) or (▼) to select channels. Press the PTT button to exit menu. The screen will alternate between Home Channel and Dual Watch Channel. To end Dual Watch mode, re-enter Dual Watch menu to select the OFF setting. If you set the same channel and code as current channel, Dual Watch does not work.

7

WEATHER CHANNELS & FREQUENCIES

Weather Channel	Frequency (MHz)	Weather Channel	Frequency (MHz)
WX1	162.550	WX7	162.525
WX2	162.400	WX8	161.650
WX3	162.475	WX9	161.775
WX4	162.425	WX10	161.750
WX5	162.450	WX11	162.000
WX6	162.500		

ISED Radiation Exposure Statement

For body worn operation, this model device has been tested and meets the FCC/ISED RF exposure guidelines when used with an accessory designated for this product or when used with an accessory that Contains no metal and that positions of the face up minimum distance is 25 mm. Any Changes or modifications not expressly approved by the party responsible for compliance could void the user's authority to operate the equipment.

Pour le corps, ce modèle d'appareil a été testé et adapté à la RF renforcée Lignes directrices relatives à l'exposition lorsqu'elles sont utilisées avec un accessoire pour ce produit ou lorsqu'elles sont utilisées avec celui-ci Un accessoire ne contenant pas de métal et dont la distance minimale de la face est de 25 mm. Tout changement ou modification non expressément approuvé par la partie responsable de la conformité l'équipement.

Your wireless handheld portable transceiver contains a low power transmitter. When the talk button is pushed, it sends out radio frequency (RF) signals. The device is authorized to operate at a duty factor not to exceed 50%.

Votre émetteur-récepteur portable sans fil contient un émetteur de faible puissance. Lorsque le bouton de conversation est enfoncé, il envoie des signaux de radiofréquence (RF). L'appareil est autorisé à fonctionner avec un facteur d'utilisation ne dépassant pas 50%.

15