

Product Introduction

Appearance and Components

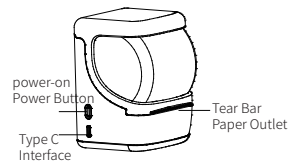
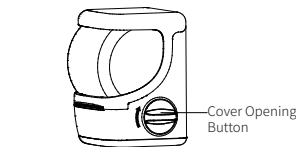

- This position means that the working temperature is high, please do not touch it.
- This position is a sharp edge, do not touch.

Packing List



Printer



Quick Start Guide



USB Cable(选配)

Product Introduction

LED Indicator State

- Red Light Exception status
 - on always: Exception (paper jam/Out-of-paper/Cover Opening)
 - flashes quickly: TPH is over temperature.
 - flashes slowly: Low power
- White Light Basic status
 - on always: Charging is complete/Charging Begins
 - flashes slowly: Charging

Button Operation

- 1 Long press the Power button: power-on/power-off
- 2 Double-click the power button: Position and calibrate label paper and heating line positions.

Loading Paper

- 1 Hold the fuselage with one hand, turn the cover opening knob clockwise with one hand, implement cover opening.
- 2 Load the roll in the direction shown and print face down.
- 3 Push both sides of the paper roll baffle inward (arrow direction) until the paper roll is clamped.
- 4 Pull out a small piece of paper, Make sure that there is a paper section after closing, on the outside of the machine.

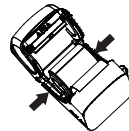
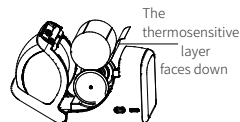

APP Download

Scan the QR code below and download the APP:



Connection and Printing

01

Long press the power button to boot, first open the phone Bluetooth, and then open the APP, click on "Connect devices", select "New 1".



02

Click on "New Tab", use the official supplies, the APP will automatically identify and guide the jump, to the corresponding template editing, in the template editing required content, and select print.



Note: App operation shall be subject to the latest version.

Manufacturer: Xiamen Hanin Electronic Technology Co.,Ltd.
TEL: 400-766-7666
Add: No.96, Rongyuan Road, Tong'an District, Xiamen, China, 361100
Web: cn.hprrt.com

Battery Charging

When the battery power is low, the red LED indicator will flash slowly. Please charge it by the exclusive USB cable in time. If you continue printing, it may power off automatically.

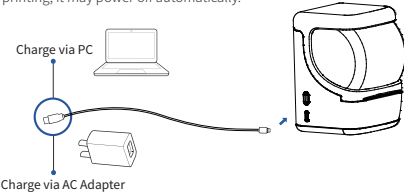

⚠ Note: The printer can be charged via computer USB port or AC adapter. Please note that the AC adapter is not supplied.

FCC WARNING

This device complies with part 15 of the FCC Rules. Operation is subject to the following two conditions: (1) this device may not cause harmful interference, and (2) this device must accept any interference received, including interference that may cause undesired operation.

Any changes or modifications not expressly approved by the party responsible for compliance could void the user's authority to operate the equipment.

NOTE: This equipment has been tested and found to comply with the limits for a Class B digital device, pursuant to Part 15 of the FCC Rules. These limits are designed to provide reasonable protection against harmful interference in a residential installation. This equipment generates, uses and can radiate radio frequency energy and, if not installed and used in accordance with the instructions, may cause harmful interference to radio communications. However, there is no guarantee that interference will not occur in a particular installation.

If this equipment does cause harmful interference to radio or television reception, which can be determined by turning the equipment off and on, the user is encouraged to try to correct the interference by one or more of the following measures:

- Reorient or relocate the receiving antenna.
- Increase the separation between the equipment and receiver.
- Connect the equipment into an outlet on a circuit different from that to which the receiver is connected.
- Consult the dealer or an experienced radio/TV technician for help.



FCC-ID:2AUTE-NEW1

⚠ Note: All the drawings of product and accessories in the manual are for reference only, please subject to the actual product.



New 1
HCS-2LB23L