

# USER MANUAL

Smart Ultrasonic Humidifier  
Model: WB-JS2101

If you have any questions, please feel free to contact  
[service@kfcsmart.com](mailto:service@kfcsmart.com)

# CONTENTS

---

03 Product Accessories List

03 Product Specification

04 Important Tip

05 Safety Instructions (Please Read Carefully Before Use)

06 Product Components

07 Getting to Know Humidifier LED Screen Icon

08 How to Control Your Smart Humidifier

09 How to Control Your Smart Humidifier (cont.)

10 Steps for Filling Water

11 Precautions

12 Cleaning and Maintenance

13 Set up Your Humidifier in the App

14 Add a Humidifier to the App

15 Add a Humidifier to the App (cont.)

16 Troubleshooting

17 Warranty

17 Customer Support

# Product Accessories List



Smart Ultrasonic Humidifier x 1

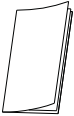

User Manual x 1



Quick Guide x 1

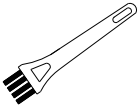

Cleaning Brush x 1

# Product Specification

Model	WB-JS2101
Voltage	AC100-240V
Wattage	25W
Capacity	8.0L
Atomization Time	Max Mist: 30H
Mist Output	1: 120mL/H 2: 180mL/H 3:260mL/H
Gross Weight	3.6lb
Product Size	9.4 x 9.4 x 12in
Executive Standard	GB4706.1-2005 GB4706.48-2009

**Note:** Use additional smart humidifier function, download the free 'KFC Smart' app (see page 13).

# Important Tip

Important Tip: **DO NOT** leave the humidifier unused for a long time (i.e. several days or more). This may cause premature failure of the circuitry. When the humidifier is not in use, please press the power button '⏻' and unplug the power plug.

## OFF POSITION

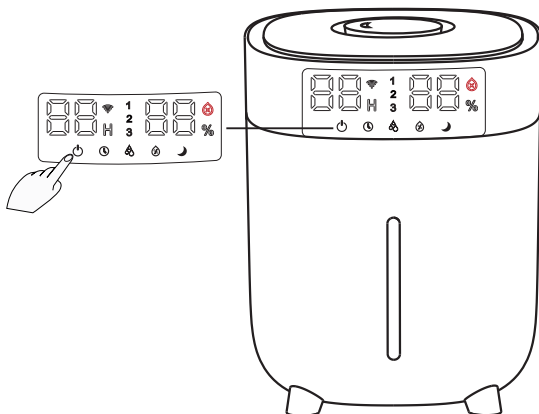

Fig.1

## UNPLUG FROM POWER SOURCE

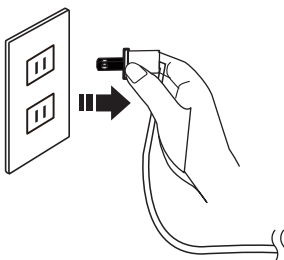

Fig.2

# Safety Instructions

---

## (Please Read Carefully Before Use)

---

- Please follow the operation steps in the user manual (See page 9) to operate the humidifier correctly at home;
- Keep the plug and power supply away from liquids;
- Please check the device before use for any cracks, chips or damage that may cause leakage of the device. If you find any damage, **DO NOT** use it. Only professional or authorized maintenance personnel can repair the appliance. **DO NOT** replace parts or add other items as replacement parts by yourself;
- **DO NOT** pour out the remaining water in the base without unplugging the power plug, otherwise it will cause the atomizer to burn out;
- **DO NOT** add essential oils directly in the water tank. The humidifier has specific locations where you can add essential oils (See page 10);
- When plugging in any power source, make sure your hands are dry to avoid the risk of electric shock;
- When adding water, please hold the water tank with two hands to prevent the water tank from falling. If the equipment is in working condition, **DO NOT** move the water tank;
- When unplugging the plug, **DO NOT** pull the power cord with your hands to unplug the plug. The disconnected part is prone to short-circuit and leakage, which may cause fire and electric shock.
- **DO NOT** let children clean or maintain the humidifier alone;
- **DO NOT** use this appliance in any kind of inflammable environment. Keep the equipment away from any heat sources (e.g. stoves, ovens, radiators) and avoid direct sunlight.

# Product Components

- |                                 |                             |                             |
|---------------------------------|-----------------------------|-----------------------------|
| <b>A.</b> Nozzle                | <b>G.</b> Water Tank        | <b>M.</b> Water Onlet       |
| <b>B.</b> Water Tank Cover      | <b>H.</b> Max Water Line    | <b>N.</b> Air Outlet        |
| <b>C.</b> Upper Half Water Tank | <b>I.</b> Water Inlet 1     | <b>O.</b> Atomization Piece |
| <b>D.</b> Display               | <b>J.</b> Mist Outlet       | <b>P.</b> Float             |
| <b>E.</b> Humidity Sensor       | <b>K.</b> Essential oil box |                             |
| <b>F.</b> Water Pump            | <b>L.</b> Water Inlet 2     |                             |

