

FCC/ISED E-Label Information:

Date: May 15, 2020

FCC ID: 2AUXS-NYON350

ISED Certification Number: 25847-NYON350

PMN: Nyon

HVIN: BUI350

FVIN: N/A

HMN: N/A

A. Information to be displayed

1. The information that will be displayed on the e-label and information that will remain in the user manual is shown below:

Information	On E-label	In Manual
FCC ID number	Yes	No
ISED Certification Number	Yes	No
15.19 statement ("This device complies with part 15 of the FCC Rules. Operation is subject to the following two conditions: (1) This device may not cause harmful interference, and (2) this device must accept any interference received, including interference that may cause undesired operation.")	Yes	Yes
Class A / B Digital Device user manual statements*	No	Yes
Caution to the user that changes or modifications not expressly approved by the party responsible for compliance could void the user's authority to operate the equipment*	No	Yes
Describe any other FCC regulatory information included in e-label*		
* If the e-label includes information typically included in the manual then the e-label shall clearly differentiate between information required to be on the device's surface and information required to be in the manual – refer to KDB 784748 D02 e labelling v01 section II D 3(b) and RSS-Gen Annex B.		

Images of the e-label screen are provided below:

Model BUI350

Manufacturer

**Robert Bosch GmbH
Bosch eBike Systems
Gerhard-Kindler-Straße 3
72770 Reutlingen
Germany**

This device complies to:



IPx5

Europe



USA / Canada

**FCC ID: 2AUXS-NYON350
IC: 25847-NYON350**

This device complies with part 15 of the FCC Rules and Industry Canada RSSs Rules. Operation is subject to the following two conditions:

- (1) This device may not cause interference; and**
- (2) This device must accept any interference, including interference that may cause undesired operation of the device.**

Australia



B. Access to the required information on the e-label

1. Users are able to access the information in no more than three steps in a device's menu. The actual steps are:

To access the e-label information, in the device,

On < Status Screen>:

- Choose: s1 <Settings> -> <Information> -> <Certificates>

No special access codes or permissions are required to go through the above steps beyond entering a user-defined password to protect against unauthorized access to the device.

2. The information is stored on the device, no special accessories or supplemental plug-ins (e.g., a SIM/USIM card) are required to access the information.

Yes

3. Users are provided specific instructions on how to access the information.

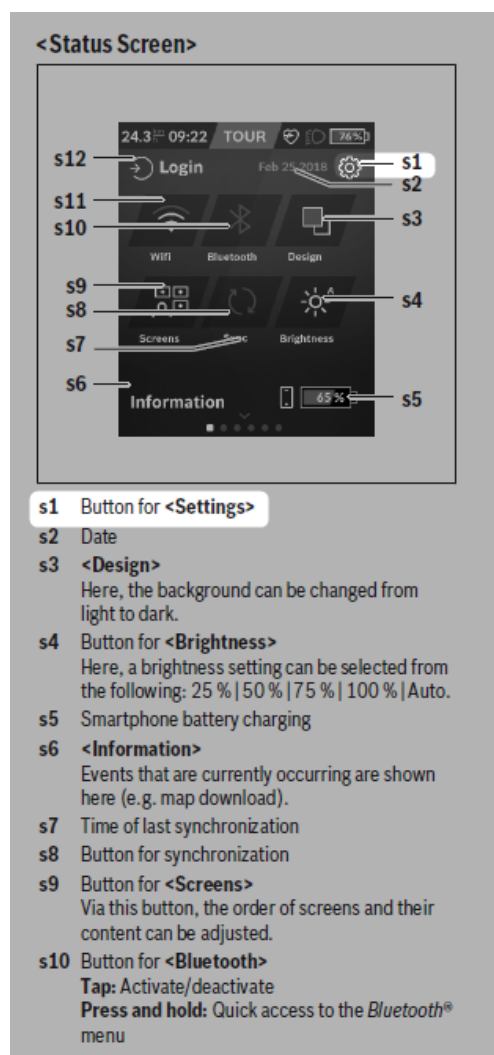

s11 Button for **<WiFi>**

Tap: Activate/deactivate

Press and hold: Quick access to the Wi-Fi menu

s12 **<Login>**

Here, the user can connect with their ID.

<Settings>

You can access the settings menu via the status screen. The **<Settings>** cannot be accessed or changed while riding.

Tap the settings button **<Settings>** and select the required setting or submenu. Press the back arrow in the header to move to the previous menu. Press the **x** symbol (in the right of the header) to close the settings menu.

You can find the following superordinate sections on the first level of settings:

– **<Map Settings>**

Via **<Map Settings>**, the map display format (2D/3D) can be selected, downloaded maps and map updates can be reviewed, and recommended maps can be downloaded.

– **<My eBike>** – Your eBike settings:

You can reset the counters (such as the number of kilometers traveled that day or average values) to zero either automatically or manually, and you can reset the range. You can change the wheel circumference value that was preset by the manufacturer by $\pm 5\%$. If your eBike features **eShift**, you can also configure your eShift system here. The bike retailer can schedule the service based on a mileage and/or a time period. The bike component page displays the serial number and hardware and software versions for each component, in addition to other key data that is relevant for the components.

– **<Screen Management>**

You can select this menu item to adjust the screen and tile contents to your personal requirements.

– **<Connections>**

Here, the **Bluetooth®** and Wi-Fi connections can be adjusted.

– **<My Profile>**

The data of the active user is entered or adjusted here.

– **<System Settings>**

You can display the speed and distance in kilometers or miles, display the clock in 12- or 24-hour format, adjust the time, date and time zone and select your preferred language. You can reset the Nyon to its factory settings, run a software update (if available) and choose between a black and white design.

– **<Information>**

Information on FAQ (frequently asked questions), certification, contact information, information on licenses. You can find a detailed description of each parameter in the online operating instructions at www.Bosch-eBike.com.

– **<Certificates>**

Model BUI350

Manufacturer

Robert Bosch GmbH
Bosch eBike Systems
Gerhard-Kindler-Straße 3
72770 Reutlingen
Germany

This device complies to:



Europe



USA / Canada

FCC ID: 2AUX5-NYON350
IC: 25847-NYON350

This device complies with part 15 of the FCC Rules and Industry Canada RSSs Rules. Operation is subject to the following two conditions:

(1) This device may not cause interference; and
(2) This device must accept any interference, including interference that may cause undesired operation of the device.

Australia

