

Product Description

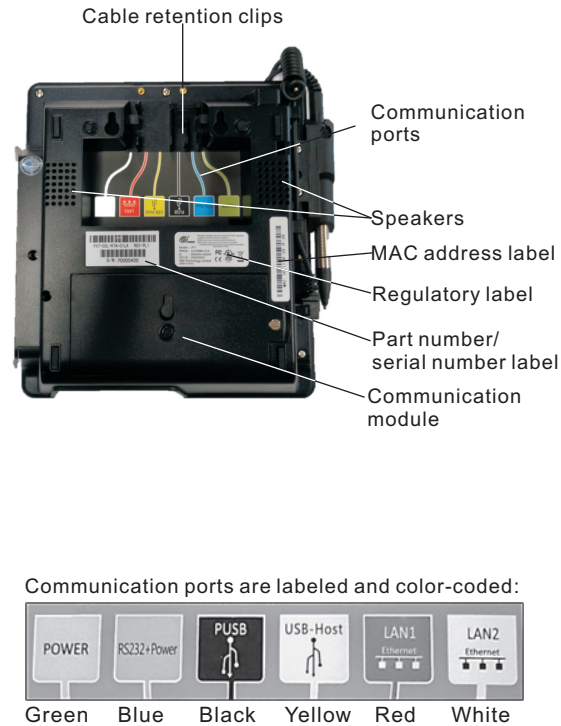

1



2

Communication Module

2 P* terminals that include a default communication module come standard with one Ethernet port and RS232, USB, and PUSB network capabilities. However, if the default communication module is replaced with an optional communication module, your choice of these additional network capabilities are available:

- A second Ethernet port
- Power over Ethernet
- An Ethernet hub
- Wi-Fi and Bluetooth LE
- Wi-Fi and Cellular GSM

The communication module is located on the underside of the terminal.

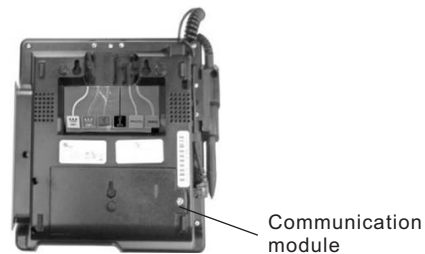

A communication module must be installed before power can be applied to the terminal. Once the new communication module is properly installed, operate the terminal as usual.

3

Power Connections

3 Power can be supplied via the power port or a single data cable that carries power. This power can be provided via a "powered cable" where the connected POS terminal provides the power (i.e. PUSB or Power over Ethernet) or by connecting a P* power supply directly to the data cable (i.e. RS232 or USB).

1) Power Port

Insert the power connector into the green POWER port. Turn the power connector, locking the tab behind the short plastic wall. Dress the cable through the retention clips. A separate data cable is also required.

2) POS Cable

Insert the cable connector into the appropriate port on the terminal. Dress the cable through the retention clips opposite the port. Connect power supply to cable as required. The cash register could also supply power to terminal.

3) Power over Ethernet (PoE)

Power is available over the red LAN1 port when the optional PoE and Ethernet hub communication module is installed.

Working Environment: Temperature -10°C ~ 50°C (14°F ~ 122°F)

R.H.: 10% ~ 93% (non-condensing)

Storage Environment: Temperature -20°C ~ 60°C (-4°F ~ 140°F)

R.H.: 5% ~ 95% (non-condensing)

4

Stylus Holder and Pen

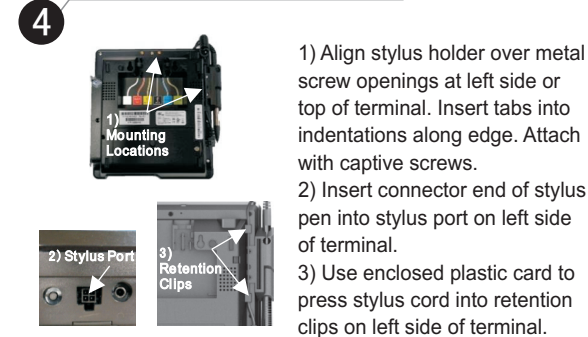

Privacy Shield



5

Plugs

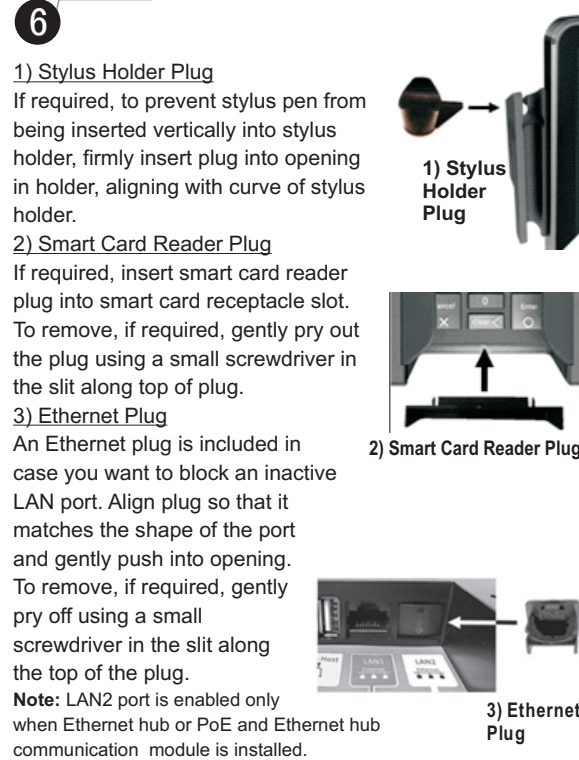

6



PAX Technology Inc.
4901 Belfort Road, Suite 130
Jacksonville, FL 32256, USA
T: 877-859-0099
W: www.pax.us
E: sales@pax.us



PAX TECHNOLOGY INC.

Reset Button and Audio Jack

7

If required, restart the terminal by pressing in and holding the reset button for 2-3 seconds.

If required, a visually disabled person can connect a headphone to the terminal for audio prompting using the 3.5mm output audio jack.

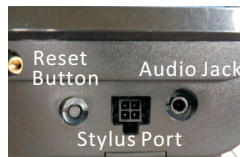

Cable Lock

8

If required, insert customer-provided cable lock into K-Slot®. Loop cable around permanent object to secure in place.



Stand Installation

9

If required, the P^x terminal may be mounted to a stand. Instructions may vary depending on stand specifications.

Carefully route the required cables up through the stand pipe and out the top. Connect the cables to the P^x terminal ports.



Insert the three mounting slots on the underside of the terminal into the three metal prongs on the stand base.

Slide the terminal firmly into position, locking the terminal in place on the stand. Secure with fastening screw or locking device as required.

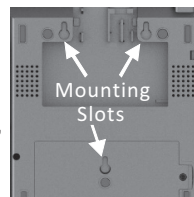

PAX TECHNOLOGY INC.

Cleaning the Device

10

WARNING:

Do not use industrial strength or abrasive cleaner as it may damage or scratch the screen.

Do not immerse device in water (or liquid.)

Do not spray water or cleaner into the MSR slot, Smart Card Reader or ports.

To clean screen, apply distilled water or mild glass cleaner onto a soft, lint-free cloth and gently wipe terminal screen.

To clean terminal, apply distilled water or plastic-safe cleaner onto a soft, lint-free cloth and gently wipe terminal.

Available Accessories

11



RS232 Cable
200204020000140
Requires Power Supply



USB Cable
200204020000141
Requires Power Supply



Installation Manual

PX7 Payment Terminal



PAX TECHNOLOGY INC.



Power Supply
200310110000070
Requires Power Cord



Power Cord
200311020000023
Requires Power Supply



Stylus Pen
200209090000929



Stylus Holder Plug
200209090000930



Privacy Shield
200209060000040



Decorative Privacy Shield Plug
2002090900001037