

FCC ID:2ASPY-ALD-Y200

INSTRUCTION MANUAL

PeriPage Mini Printer

Product Sketch

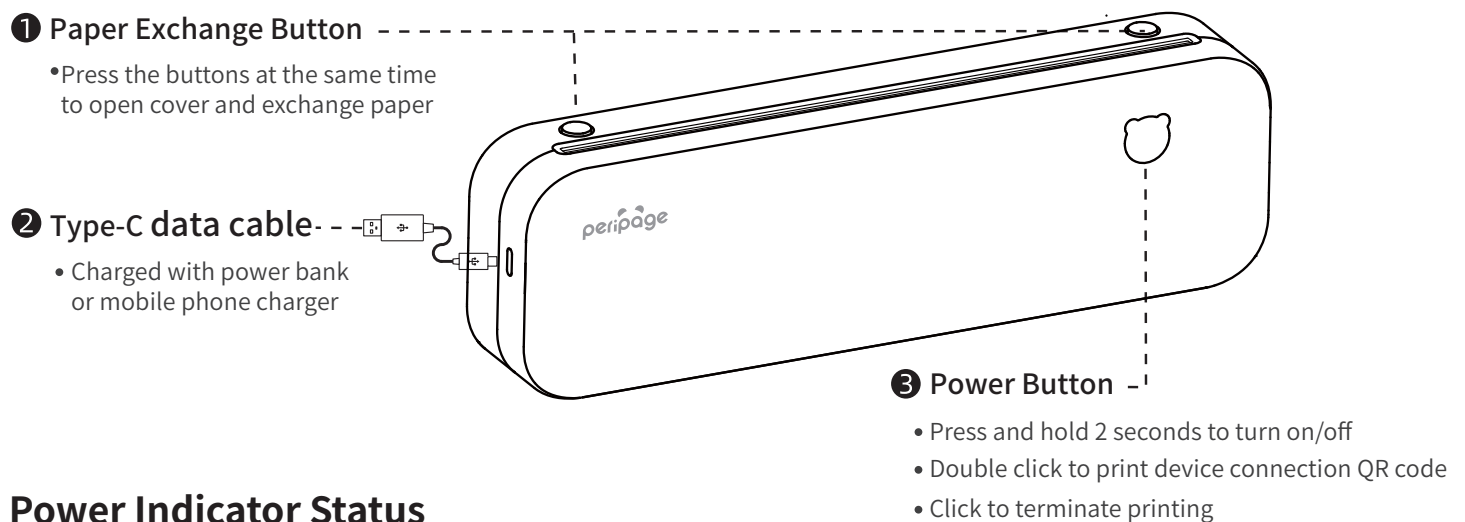

Power Indicator Status

- Green light on: Normal use status/full charged
- Red light on: Cover opened/No paper/Over-heat/Charging
- Green light flashing: Paper suction mode, please install the folded paper
- Red light flashing: Low battery, please charge in time

Mobile App Printing

- Step 1: Press and hold the power button for 2 seconds to turn on the printer.
- Step 2: Search 【PeriPage】 and download PeriPage App in the mobile app store.
- Step 3: Open the App, and search for the connected printer according to the prompts in the App.
Or double click the power button to print the QR code, and scan the code with the App to connect to the printer. (Tips: Don't connect printer in the mobile phone Bluetooth settings.)
- Step 4: Select and edit the content to be printed in the App, confirm and print.

App Download: Search for 【PeriPage】 on Google Play or App Store, or scan the following QR code to download App.



Computer Printing

- Step 1: Press and hold the power button for 2 seconds to turn on the printer.
- Step 2: Connect the printer and computer with the original Type-C data cable.
- Step 3: Visit the official website <https://www.ileadtek.com> download and install the print driver.
- Step 4: When printing the required documents, select the printer to print.

Replace Paper

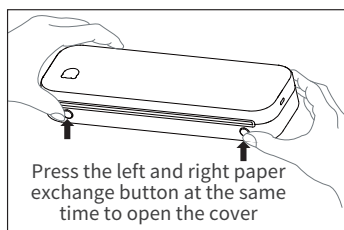

❶ Open The Cover

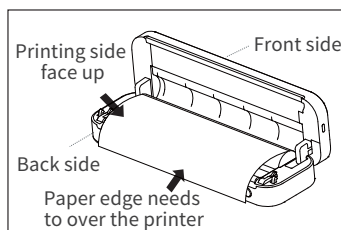

❷ Put Paper

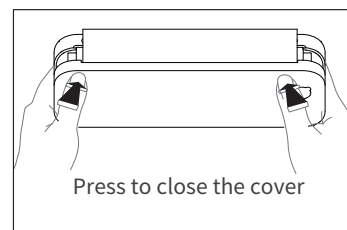

❸ Close The Cover

Folding Paper Installation Guide (Make sure there is no roll paper in the printer)

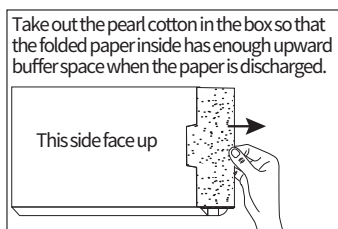

❶ Unpack

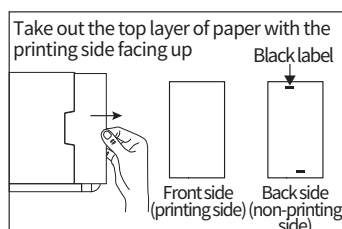

❷ Take out Paper

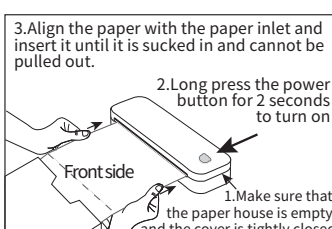

❸ Loading Paper



❹ Tear Paper

Paper Holder Installation/Removal

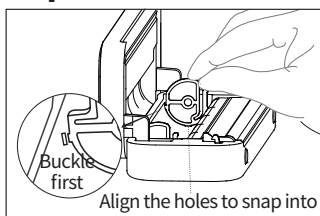

①

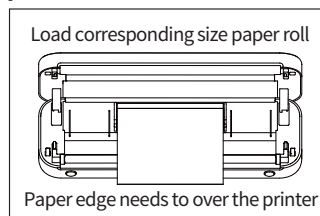

②

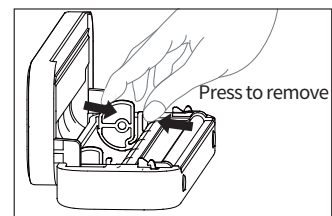

③

Charging Instructions

- 5V $\overline{\sim}$ 2A input, recommend to use mobile phone charger for charging.
- Recommend to charge the battery fully before using.
- Please charge it every 3 months if you don't use it for a long time, to avoid the long time natural loss of lithium battery and can not be charged.

Clean The Printer Head

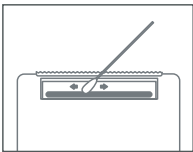

- ① Please turn off the printer and open the printer cover and take out the paper.
- ② Dip a cotton cloth or cotton swab with medical alcohol, and wipe gently along the center to the periphery of the printer head.
- ③ After cleaning the printer head, do not use the printer immediately. Please wait for 1 to 2 minutes, use the printer after the alcohol has completely evaporated.

Federal Communications Commission (FCC) Statement.

This device complies with part 15 of the FCC Rules. Operation is subject to the following two conditions:

- (1) This device may not cause harmful interference, and
- (2) this device must accept any interference received,

including interference that may cause undesired operation. Note: This equipment has been tested and found to comply with the limits for a Class B digital device, pursuant to part 15 of the FCC Rules. These limits are designed to provide Reasonable protection against harmful interference in a residential installation. This equipment generates, uses and can radiate radio frequency energy and, if not installed and used in accordance with the instructions, may cause harmful interference to radio communications. However, there is no guarantee that interference will not occur in a particular installation. If this equipment does cause harmful interference to radio or television reception, which can be determined by turning the equipment off and on, the user is encouraged to try to correct the interference by one or more of the following measures:

- Reorient or relocate the receiving antenna.
- Increase the separation between the equipment and receiver.
- Connect the equipment into an outlet on a circuit different from that to which the receiver is connected.
- Consult the dealer or an experienced radio/TV technician for help.

Warning: Changes or modifications made to this device not expressly approved by **Xiamen Ilead Tek Co., Ltd.** may void the FCC authorization to operate this device. Note: The manufacturer is not responsible for any radio or TV interference caused by unauthorized modifications to this equipment. Such modifications could void the user's authority to operate the equipment.

RF exposure statement:

This device complies with FCC RF radiation exposure limits set forth for an uncontrolled environment.

This transmitter must not be co-located or operating in conjunction with any other antenna or transmitter.

This equipment should be installed and operated with minimum distance 20cm between the radiator&you body.



Xiamen Ilead Tek Co., Ltd.

**Room 01, Unit 2101, No.50 Chengyi North Street,
Software Park Phase III, Xiamen, Fujian, China**

🌐 www.ileadtek.com

✉ service@ileadtek.com

☎ (+86)400-8550-520

V2.0