



i.Tech Music Master



Bluetooth Stereo Speaker with Remote Control

User Guide

Version 1

Product Model : C51-A05153-XX

Date : 11-May-2006

## Contents

<b>i.Tech Music Master Overview</b>	<b>1</b>
<b>Getting Start</b>	<b>2-3</b>
<b>Powering your speaker from mains adaptor</b>	<b>2</b>
<b>Powering your speaker with batteries</b>	<b>3</b>
<b>Operating Performance</b>	<b>4</b>
<b>Talk Time and Standby Time</b>	<b>4</b>
<b>Music Play Time</b>	<b>4</b>
<b>Low Battery</b>	<b>4</b>
<b>Turning your Speaker On &amp; Off</b>	<b>5</b>
<b>Turning On your speaker</b>	<b>5</b>
<b>Turning Off your speaker</b>	<b>5</b>
<b>Pairing Your Speaker</b>	<b>6-7</b>
<b>Using Your Speaker</b>	<b>8-9</b>
<b>Answering a Call</b>	<b>8</b>
<b>Answering a Call when Listening to Stereo Audio</b>	<b>8</b>
<b>Ending a Call</b>	<b>8</b>
<b>Rejecting a Call</b>	<b>8</b>
<b>Dialing from Your Mobile Handset</b>	<b>8</b>
<b>Voice Dialing from Your Headset</b>	<b>9</b>
<b>Last Number Redialing from Your Speaker</b>	<b>9</b>
<b>Listening to Stereo Audio from A2DP Ready Device</b>	<b>9</b>
<b>Remote Control Function (AVRCP)</b>	<b>10</b>
<b>Sound Enhancement (SRS WOW®)</b>	<b>10</b>
<b>Adjusting the Volume</b>	<b>11</b>
<b>Resetting / Removing the Pairing</b>	<b>11</b>
<b>Troubleshooting</b>	<b>12</b>
<b>Care and Maintenance</b>	<b>13</b>
<b>Safety Information</b>	<b>14</b>
<b>Product Specifications</b>	<b>15</b>
<b>Declaration of Conformity (DoC)</b>	<b>16</b>

**i.Tech Music Master Overview (The Speaker)**

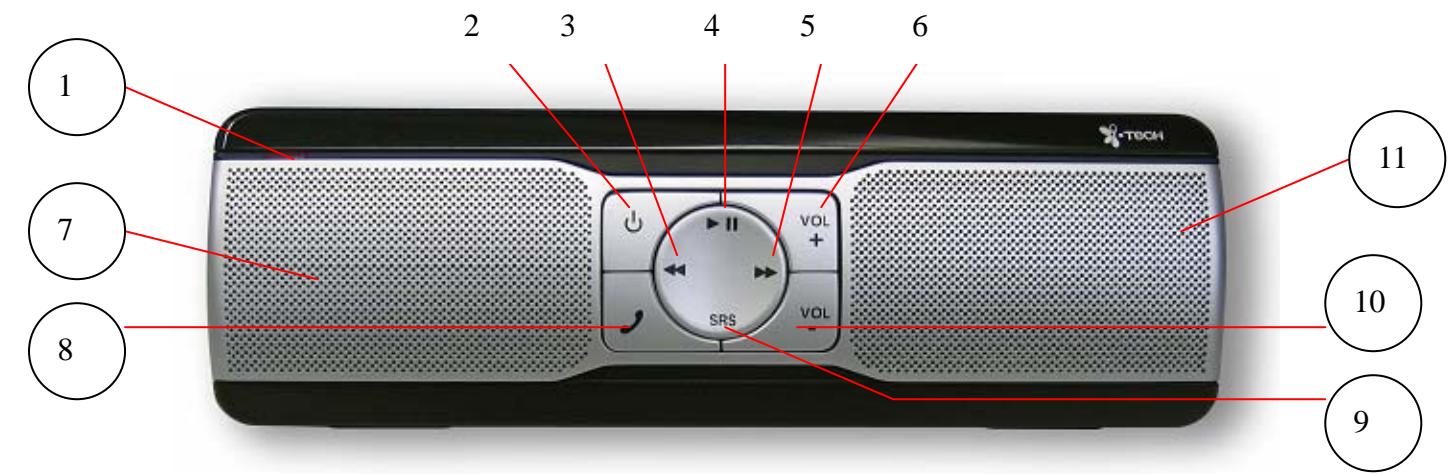

Fig. 1 Front View

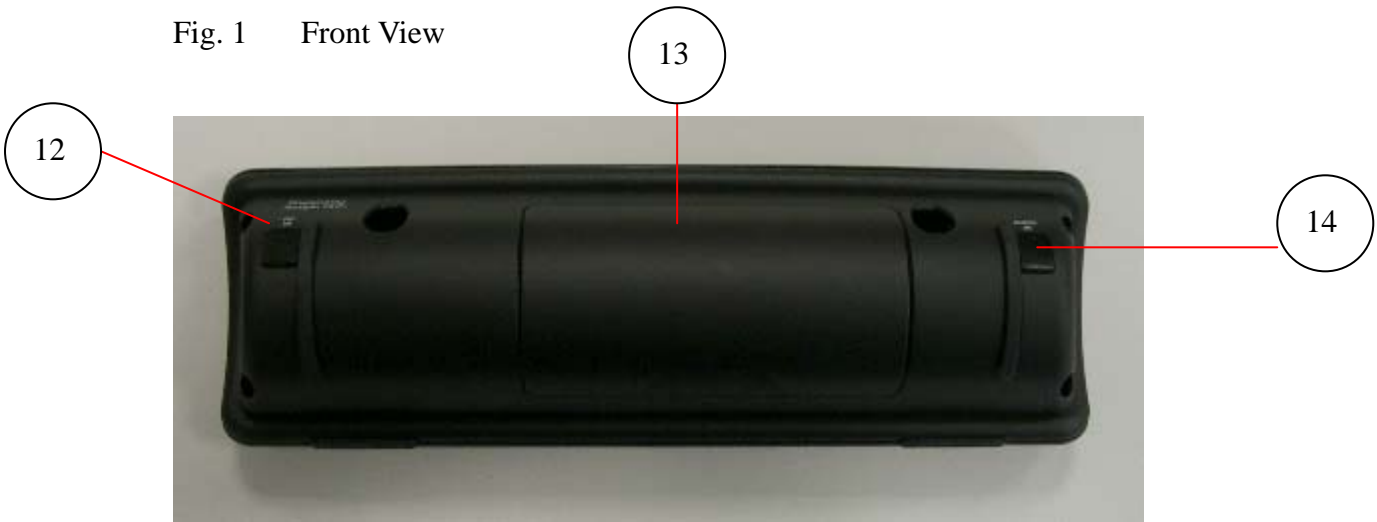

Fig. 2 Back View

1. Status Indicator	8. Call Answer Button
2. Multi-Function Button (MFB)	9. SRS Sound Enhancement
3. Backward Button	10. Volume -
4. Play / Pause Button	11. Right Speaker
5. Forward Button	12. Power Socket
6. Volume +	13. Battery Compartment
7. Left Speaker	14. Line IN (3.5mm Stereo Jack)

## Getting Start

To use your i.Tech Music Master (the “speaker”), please follow these simple steps:

### *Powering your speaker from the mains adaptor*

1. The speaker is powered by the mains adaptor (Optional accessory).
2. The power socket for the mains adaptor is located on the back of the speaker.



Fig. 3

Connect the mains adaptor to an AC wall outlet and AC adaptor plug to the speaker's charging socket – DC IN (fig.3).

### **Notes:**

- ✧ This speaker can only be used with mini USB AC adaptor and it is not included in the box.
- ✧ When using the AC outlet to power the speaker, it will also power up the speaker. However, when you use the speaker system in portable mode using 4xAA batteries, please note that the batteries will not recharge by using the mains adaptor.
- ✧ The Charging function of the unit may experience some occasional radio interference. The unit will revert to normal operation when the interference stops.

*Powering your speaker with batteries*

1. For portable use, or in places where there is no mains plug, insert 4 x AA batteries into the battery compartment (refer to Fig 4). Make sure that the batteries are placed in the right direction. (Batteries are not supplied with the speaker.)
2. Before inserting the batteries please make sure that the speaker is turned off.
3. Press the catch of the battery compartment downward and pull up the battery cover to open. Make sure that the catch clicks into place when you want to close it.



Fig. 4 Battery Compartment

## **Operating Performance**

### **Talk & Standby Time**

The portable mode offers up to 6 hours talk time and up to 150 hours standby time. When no calls are in progress, the headset remains turned on in standby mode.

### **Music Play Time**

The portable mode offers up to 6 hours music play time.

### **Low Battery**

When the speaker is on and the battery becomes low, the Status Indicator flashes red. Please replace the battery as described above.

<Page 5>

## **Turning Your Speaker On and Off**

### **Turning On the Speaker**

Press and hold the **MFB** for 2 seconds until you hear a short beep. The **Status Indicator** will flash blue.

**IMPORTANT** Press the MFB again each time you turn on the speaker to reactivate pairing so that the connection between the speaker and the mobile handset is resumed. For pairing, please refer to “Pairing Your Speaker” on page 6-7.

### **Turning Off the Speaker**

Press and hold the **MFB** for 3 seconds until you hear a long beep. The **Status Indicator** flash stops.

**IMPORTANT** To disconnect the Bluetooth connection, please firstly turn of your speaker by pressing the MFB key.

## Pairing Your Speaker

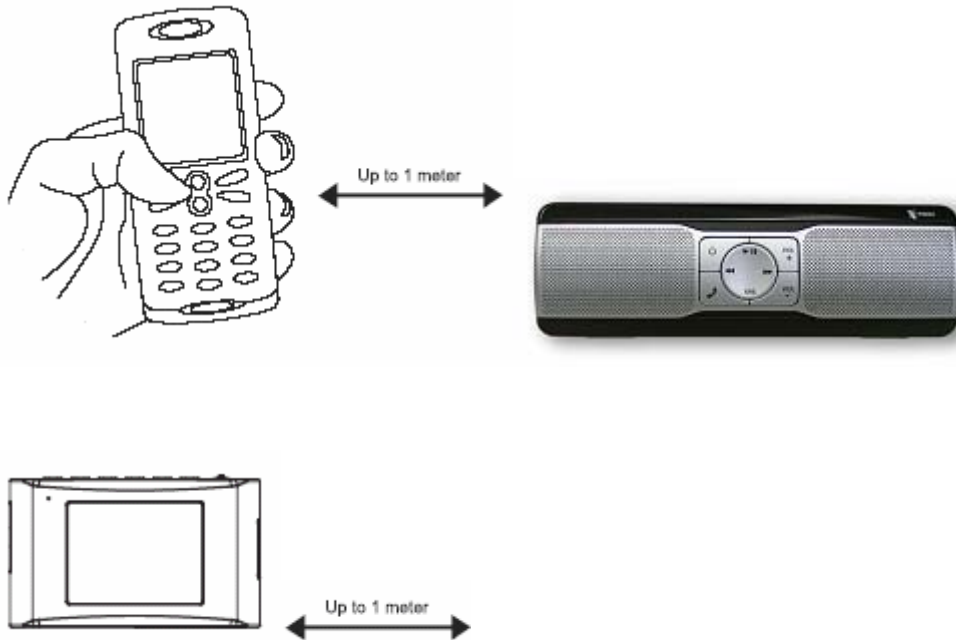

Prior to using your speaker for the first time, you must pair it with a Bluetooth-enabled mobile handset or Portable Media Player.

The information on the next page describes pairing instruction for typical Bluetooth-enabled mobile handset. Speaker pairing procedure is subject to different models of mobile handsets and portable media player.



## Pairing Your Speaker

1. Place the Speaker and the device where they are easily viewable by no more than 1 meter apart.
2. Ensure the speaker is OFF.
3. Ensure that your mains **adaptor is plugged in the speaker**. For portable use, place 4 AA batteries into the battery compartment.
4. Press and hold the **MFB** until the speaker **Status Indicator** alternately flashes blue and red.
5. Activate your mobile handset's Bluetooth function by referring to your mobile handset user guide for details.
6. Set the device to search for Bluetooth devices within about 1 meter as instructed in the mobile handset user guide and select "i.Tech Music Master" from the list.
7. Enter the preprogrammed passkey "8888" and press "OK" to pair your earphone and device. When the pairing is complete, the speaker **Status Indicator** will flash blue rapidly for 5 times followed by a long beep.
8. Go back to your device's main menu. For certain device models, a headset / audio icon will be shown on the screen. You should now be able to make and receive calls using your earphone and listen stereo music via your earphone.

**IMPORTANT** If the pairing cannot be completed within 2 minutes while the pairing mode is activated, the speaker Status Indicator flashes purple red with 3 beeps and the headset is turned off. Please repeat Steps 2 to 7 to pair the headset and the mobile handset again.



## Using Your Speaker

### Answering a Call

When there is an incoming call, you will hear ringing through the speaker. Press the  once to accept the call or answer the call via your mobile handset in the normal way.

For transfer the sound from speaker to mobile handset during the call active, long press the **volume key** for 5 seconds. For transfer the sound from mobile handset to speaker during call active, press the **MFB** once.

### Answering a Call when Listening to Stereo Audio

Press the  once to answer the call and when finished, press the  once to resume stereo audio.

If the other party you are speaking to ends the call, stereo audio will automatically resume without having to pressing the .

**NOTE** To receive stereo audio from your mobile handset or portable media player, please make sure they support the Bluetooth A2DP profile.

### Ending a Call

Press the  once to end your call or end the call via your mobile handset in the normal way.

### Rejecting a Call

To reject an incoming call during ringing of the headset, press and hold the **Volume Key** for 2 seconds until you hear 2 beeps.

### Dialing from Your Mobile Handset

Simply make calls on your mobile handset in the normal way.

## Using Your Earphone

### Voice Dialing from Your Earphone

If your mobile handset is equipped with a voice dialling function, simply press the **MFB** on your headset and when you hear a beep, say the voice tag.

**IMPORTANT** Please make sure to record voice tag into the mobile handset first before using voice dialling function.

### Last Number Redialling from Your Headset

Press the  on your speaker twice or press the calling button via your mobile handset in the normal way.

**IMPORTANT** The above functions are only applicable to mobile handsets with **Bluetooth Handsfree Profile**. Functionality varies depending on the mobile handset model you have. Please refer to your mobile handset user guide for additional information.



### Listening to Stereo Audio from Bluetooth A2DP-Ready Device

By connecting your speaker to your Bluetooth A2DP-ready device, you must first pair your speaker with your device and activate the A2DP service.

For further details regarding this procedure, please refer to the section of this user guide entitled “Pairing Your Speaker”.

## **Remote Control Function (AVRCP)**

### **Play / Pause**

1. Press  once to play the music
2. Press  once again to pause the music or long press to pause the music

### **Forward**

Pressing  once to skip or select a new track

### **Backward**

Pressing  once to repeat or select a previous track

**NOTE** To active the Remote Control Features (AVRCP), your speaker must support AVRCP profile.

## **Sound Enhancement (SRS WOW)**

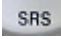
Press  once to enable the speaker on sound enhancement mode.

**NOTE** SRS, the SRS symbol and WOW® are trademarks or registered trademarks of SRS Labs, Inc. and licensed to i.Tech Dynamic Limited.

### Adjusting the Volume

Press the **Volume Key** repeatedly until you reach the desired volume level.

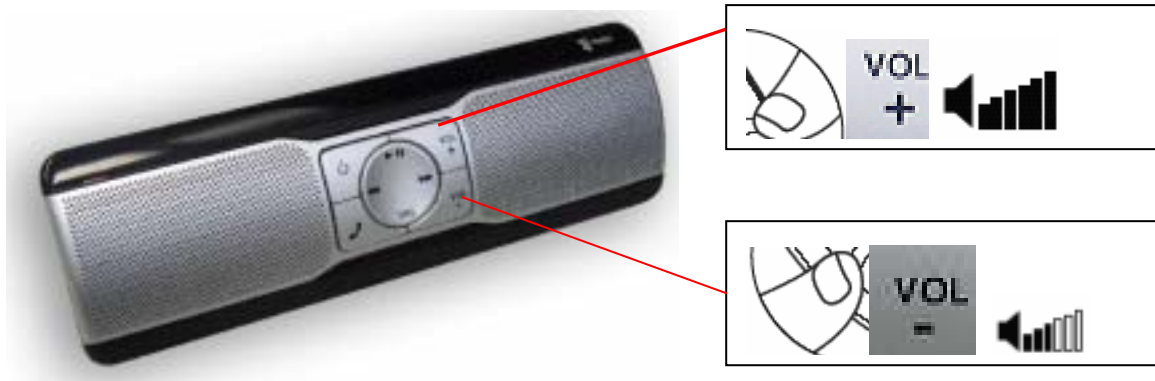

### Resetting / Removing the Pairing

You may want to reset the speaker to its original settings. This also clears all current pairings.

1. Ensure the speaker is OFF.
2. Connect the speaker with mains adaptor
3. Press and hold the **Volume Key** for 20 seconds until the **Status Indicator** alternately flashes blue and red rapidly.
4. Release the **Volume Key**.
5. Press and hold the **Volume Key** again until you hear 2 beeps.

The speaker is turned off and returns to the original settings. All current pairings are cleared.

## **Troubleshooting**

If you are experiencing problems with your device, please try the following:

- Ensure that you have inserted 4 x AA batteries in the right direction. Please always check the battery life of the batteries if you are experiencing problems with sound, music quality or usage of the device.
- Check the connection of the mains charger to ensure that it is securely plugged into the device.
- Ensure your device is turned off and is properly inserted 4 x AA batteries. The perform pairing again.
- Ensure the speaker system is turned on.
- Ensure the device is paired with your mobile handset or connect to the external audio source.
- Ensure your mobile handset's Bluetooth feature is activated. Please refer to your mobile handset user guide for specific instruction.
- Press and HOLD the (+) volume switch on the speaker system to turn the volume up to a desired level.
- Ensure the device is within a maximum of 10 meters of your mobile handset(s) and there are no obstructions, such as walls or other electronic devices in between.

If the above steps do not solve your problem, please connect the power source to the device and remove your mobile handset battery for a short time.

If there is no reaction when pressing the buttons, please remove the batteries or follow the “Resetting / Removing Pairing” section to return to factory default setting. The device is turned on again and all pairings are cleared.

The i.Tech Music Master is compliant with and adopts the Bluetooth Specification 1.2. However, interoperability between the device and other Bluetooth-enabled products is not guaranteed because it depends on compatibility. For more information on the compatibility between the device with other Bluetooth-enabled products, please check with the manufacturer or browse <http://www.itechdynamic.com>

## Care and Maintenance

1. Do not expose the speaker to **liquid**, moisture or humidity as it is not waterproof.
2. Do not use the speaker outdoors when it is raining.
3. Do not use abrasive cleaners to clean the speaker.
4. Do not expose the speaker to extremely high or low temperatures.
5. Do not dispose the speaker in a fire as it may result in an explosion.
6. Do not bring your speaker into contact with any sharp objects as this will cause scratches and damage.
7. Do not stick anything inside the speakers as this may damage internal components.
8. Do not attempt to disassemble the speaker system as it does not contain serviceable components.
9. If you will not use the Speaker for a long period, please remove all the batteries before you put it away. Please store the speaker system in a dry place that is free from extreme temperatures and dust.
10. The power function of the unit may malfunction when there is radio signal interference on the power lines. The Speaker will revert to normal operation when the interference stops.
11. When you are storing the Speaker, please do not stack any heavy objects on top of it and please remove the support stand
12. Avoid touching the speakers. When you pick up the Speaker, please do not place your thumbs over the speakers, the diaphragm of the speakers is made of delicate material.
13. Do not clean the casing with abrasive cleaners, they may damage the finish.

## **Safety Information**

- ✧ Never allow children to play with the speaker as it contains small parts that may be of choking hazard.
- ✧ Observe all signs and displays that require an electrical device or RF radio product to be switched off in designated areas. These could include hospitals, blasting areas, and potentially explosive atmospheres.
- ✧ Always place the device on a flat and level surface for operation.
- ✧ Do not use the speaker while driving.
- ✧ Do not place the speaker on the dashboard as it may fly off when the car brakes suddenly.
- ✧ Do not hang the speaker on the wall. The device is not designed for wall-hanging.
- ✧ When carry the speaker around, please make sure that the removable support stand is fitted into the slots securely. There is a chance that the support stand will come loose.
- ✧ Remove the batteries from the battery compartment before plugging the AC adaptor into the AC outlet.



## Product Specifications

### 1. Bluetooth Part

Bluetooth Specification:	Version 1.2 Class 2
Bluetooth Profile Supported:	Headset, Handsfree, A2DP and AVRCP
Range of Frequency:	2.4GHz Spectrum
Operating Range :	10 meters
Talk Time*:	Up to 6 hours
Music Play Time*:	Up to 6 hours
Standby Time*:	Up to 150 hours

### 2. Audio Part

Power output:	2 W
Equalizer:	SRS WOW®
Power source:	4 x AA or AC outlet
Socket:	3.5mm Stereo Socket
Music play time:*	Up to 6 hours (4 x AA Alkaline Batteries)
Dimensions:	212 mm (L) x 45 mm (W) x 67 mm (H)
Weight:	258 g (TBD)

*\* May vary due to different modes of operation and condition and using alkaline batteries..(To Be Define)*

<Page 15>

## **Declaration of Conformity (DOC)**

We, i.Tech Dynamic Ltd., declare that the following product:

Product Name: **i.Tech Music Master**

Model No.: C51-A5153-XX

Is in conformity with the following essential requirements of Council Directive 1999/5/EC (referred to as R&TTE Directive): Article 3.1a, 3.1.b and 3.2. and the product is manufactured in accordance with Annex II of the above directive.

A copy of the Declaration of Conformity can be found at:

<http://www.itechdynamic.com>

<Back Cover>

**© 2006 Hutchison Harbour Ring Enterprises Limited**

All rights in this publication are reserved and no part may be quoted or reproduced without the prior written permission of the company. The contents of this publication are believed to be correct at the time of going to print, but any information, specifications, products or services mentioned may be modified, supplemented or withdrawn without any prior notice.

Bluetooth® and the Bluetooth logos are trademarks owned by Bluetooth SIG, Inc, USA and licensed to i.Tech Dynamic Limited.



SRS, the SRS symbol and WOW® are trademarks or registered trademarks of SRS Labs, Inc. and licensed to i.Tech Dynamic Limited.

The Stylized i.Tech logos are trademarks owned by Hutchison Harbour Ring Enterprises Limited and/or its affiliates.



i.Tech declare under our sole responsibility that the speaker system is in conformity with the provisions of the following Council Directives: 1999/5/EC.

This device complies with Part 15 of the FCC Rules. Operation is subject to the following two conditions:

- (1) this device may not cause harmful interference, and
- (2) this device must accept any interference received, including interference that may cause undesired operation.

Caution: Changes or modifications not expressly approved by the party responsible for compliance could void the user's authority to operate the equipment.

**FCC RF Radiation Exposure Statement:**

This equipment complies with FCC radiation exposure limits set forth for an uncontrolled environment. End users must follow the specific operating instructions for satisfying RF exposure compliance. This transmitter must not be co-located or operating in conjunction with any other antenna or transmitter.

## Notes on Environmental Protection



After the implementation of the European Directive 2002/96/EU in the national legal system, the following applies: Electrical and electronic devices may not be disposed of with domestic waste. Consumers are obliged by law to return electrical and electronic devices at the end of their service lives to the public collection points that are set up for this purpose or designated points of sale. However, such details are defined by the national law of the respective country. This symbol on the product, the instruction manual or the package indicates that the product is subject to these regulations. By recycling, reusing the materials, or other forms of utilizing old devices, you are making an important contribution in protecting our environment.

Printed in China