

WARRANTY OVERVIEW

Carvaan comes with a 1 year Warranty on all parts, excluding accessories. This includes servicing/ repair or replacement of damaged parts.

The warranty does not apply and does not cover the following:

- Liability for loss of data/content loaded in the product due to misuse or tampering.
- Damage caused due to force majeure events; events caused by fire, water, electrical disturbances etc.; events beyond the control of Saregama; acts of negligence or mishandling; usage for commercial, business, industrial, educational or rental purposes

WARRANTY CARD

Customer's Name: _____

Customer's Address: _____

Product Serial No.: _____

Date of Purchase: _____

Expiry Date: _____

I accept the terms and conditions of the warranty.

Retailer's Name: _____

Retailer's Signature/Seal: _____

Customer's Signature

WARRANTY TYPE

Home service and carry in warranty are provided.

Home service warranty requires customers to have a technician visit their home and service the product. This type of warranty can be availed by customers living in locations where there is an authorized service center. The list of authorized service centers is available on www.saregama.com/carvaan/2018/service-center

Carry-in Warranty service requires that the Product be brought by the Customer, at his/her sole cost and responsibility, to the Authorized Dealers along with the original invoice.

Once the Product is serviced/ repaired/ replaced, the Customer shall be responsible to pick-up the Product from the concerned Authorized Dealer.

IMPORTANT LINKS

Station List & Song List:
www.saregama.com/carvaan/2018/songlist

Detailed Warranty:
www.saregama.com/carvaan/2018/warranty

Download the "Saregama Carvaan" app from the **Apple/ Android** store.



SAREGAMA CARVAAN™

USER MANUAL

BUTTONS & PORTS ON SAREGAMA CARVAAN

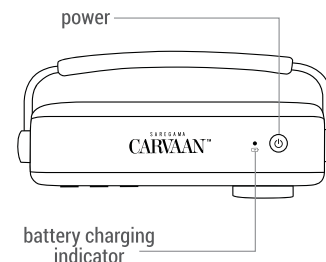

Full battery charge time: 2-3 hours;
Battery usage: Approximately 5 hours once the battery is fully charged

To choose a mode, press the corresponding mode button on the unit/ remote

1. **SAREGAMA**: 5000 pre-loaded evergreen songs categorized into Artistes, Specials & Geetmala; this is the default mode on first power on/reset

2. **USB* / AUX IN**: Plug in a USB into the USB port on Carvaan to enjoy your personal collection of songs. You can also connect an Aux cable in the Aux IN port on the back panel of Carvaan to play songs from your phone/tablet. Press the mode button to switch between USB and Aux In

3. **FM/AM****: Listen to local FM/AM stations. Press the mode button to switch between FM and AM

FM frequency: 87.5 to 108 MHZ

AM frequency: 520 to 1710 KHZ

Note: We recommend that you do not put the unit on charge while listening to FM/AM as it will interrupt the signal

4. **BLUETOOTH*****: Pair your mobile phone / tablet with Carvaan. Enjoy songs stored on your personal device on Carvaan speakers

**support for USB 2.0*

***AM station will play as per broadcast timings*

****support for BT version 4.1*

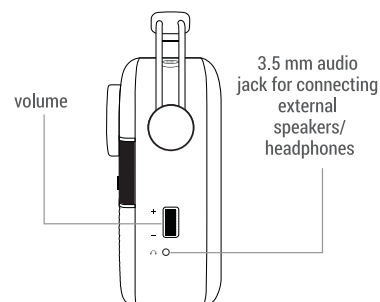
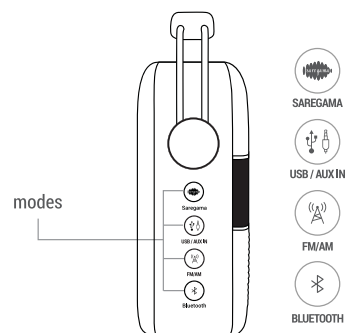

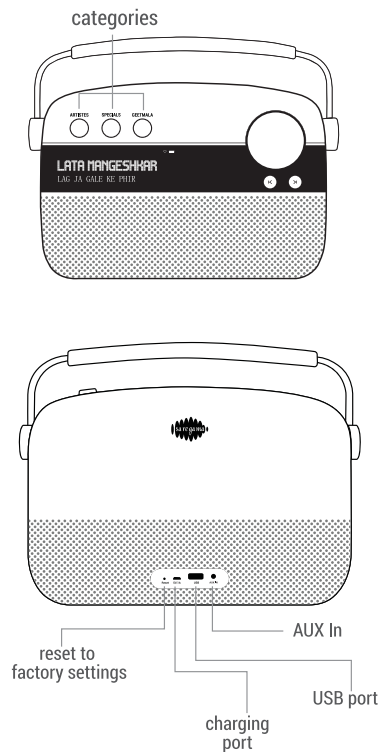

Download the “Saregama Carvaan” app from the Apple/ Android store. Use the app to browse through the collection of songs available on Carvaan. You can even search for a song or create playlists of songs you would like to enjoy on Carvaan.



Choose a category in Saregama Mode

1. Artistes: 65+ music stations dedicated to legends like Lata Mangeshkar, Kishore Kumar, Asha Bhosle, Mohd. Rafi, R.D. Burman, Gulzar, Rishi Kapoor, Amitabh Bachchan, Noor Jehan, Mukesh, Nargis, Rekha etc.

2. Specials: 15+ music stations dedicated to Specials like Romance, Ghazal, Gurbani, Bhakti, Kapoor, Instrumental, Sad, Songs with Dialogues, Hindustani Instrumental, Favourites etc.

3. Geetmala: 50 years of Ameen Sayani’s Geetmala spanning across 50 music stations

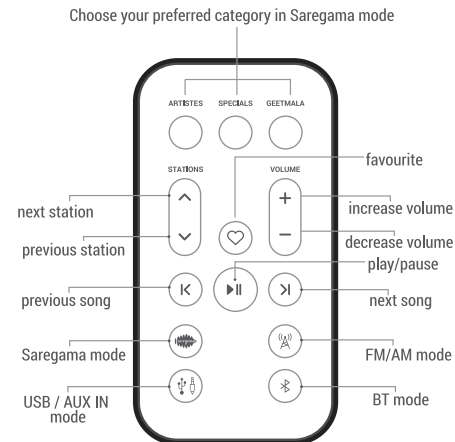
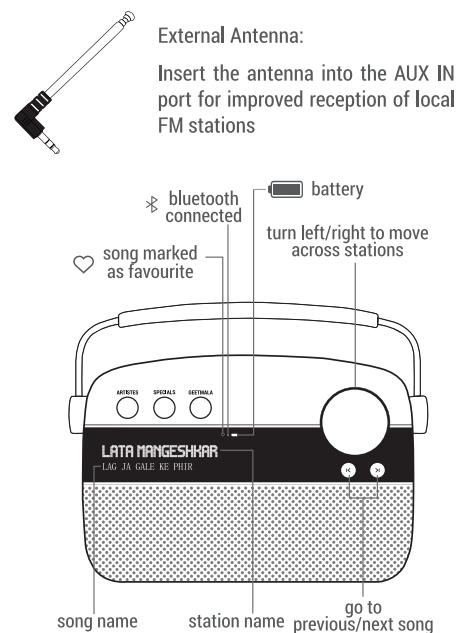

SAFETY HANDLING

1. CARE FOR PRODUCT

- Keep Carvaan away from dust and excessive heat (heat registers, stoves etc.)
- Prevent spillage of water or any other liquid as this can cause failure of Carvaan or could prove to be a potential fire hazard
- Clean the unit with a dry cloth only
- Do not walk on or pinch the power cord close to the plug
- Do not immerse Carvaan or the remote into water
- Remove the remote battery when it is not used for longer duration
- Do not mix different brands or types of batteries in the remote

2. CARE FOR BATTERY

- Do not expose the battery to heat sources greater than 60°C
- Recycle or dispose the battery when essential. Please ensure proper battery handling and disposal methods

To replace the remote control battery:

- Open the battery compartment
- Insert a fresh CR2025 battery with the correct polarity (-/+)
- Close the battery compartment
- Discard the used battery

- Do not subject the battery pack to a mechanical shock
- In the event of a battery leak, do not allow the liquid to come in contact with the skin or eyes. If contact has been made, wash the affected area with water and seek medical advice
- For prolonging battery life, avoid discharging the battery completely

3. OTHERS

- Use attachments/accessories as specified by the manufacturer
- Please contact an authorized service center for any repair/ servicing requirements or call the toll free no. 1800-102-7799

 Waste electrical products should not be disposed of with household waste. Please follow disposal and recycling instructions issued by the concerned local authority.

FCC Warning

This device complies with Part 15 of the FCC Rules. Operation is subject to the following two conditions:

(1) This device may not cause harmful interference, and (2) this device must accept any interference received, including interference that may cause undesired operation.

NOTE 1: This equipment has been tested and found to comply with the limits for a Class B digital device, pursuant to part 15 of the FCC Rules. These limits are designed to provide reasonable protection against harmful interference in a residential installation. This equipment generates, uses and can radiate radio frequency energy and, if not installed and used in accordance with the instructions, may cause harmful interference to radio communications. However, there is no guarantee that interference will not occur in a particular installation. If this equipment does cause harmful interference to radio or television reception, which can be determined by turning the equipment off and on, the user is encouraged to try to correct the interference by one or more of the following measures:

- Reorient or relocate the receiving antenna.
- Increase the separation between the equipment and receiver.
- Connect the equipment into an outlet on a circuit different from that to which the receiver is connected.
- Consult the dealer or an experienced radio/TV technician for help.

NOTE 2: Any changes or modifications to this unit not expressly approved by the party responsible for compliance could void the user's authority to operate the equipment.

IC WARNING

This device complies with Industry Canada's licence-exempt RSSs. Operation is subject to the following two conditions:

- (1) This device may not cause interference; and
- (2) This device must accept any interference, including interference that may cause undesired operation of the device.

Le présent appareil est conforme aux CNR d'Industrie Canada applicables aux appareils radio exempts de licence. L'exploitation est autorisée aux deux conditions suivantes: (1) l'appareil ne doit pas produire de brouillage, et (2) l'utilisateur de l'appareil doit accepter tout brouillage radioélectrique subi, même si le brouillage est susceptible d'en compromettre le fonctionnement.