

55mm

80mm

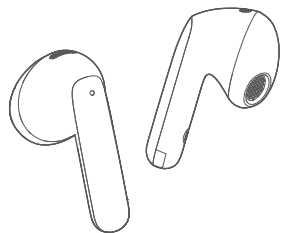

BH23HT10A



Download the QCY App to experience the full range of features such as ambient sound modes, EQ tuning, firmware updates, and more.

## Overview

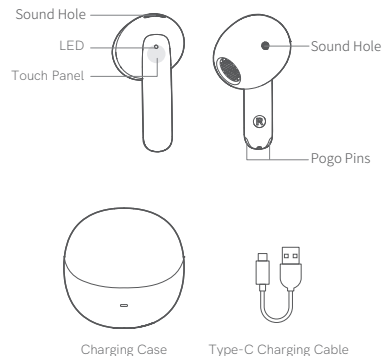

Note: The images in this manual are for reference only and may vary from the actual product. Please refer to the actual product for accuracy.

## Bluetooth Pairing

### Initial Pairing:

1. Take out both earbuds, peel off the isolation film from each, and place them back into the charging case. Close the lid to activate the new device.
2. Retrieve both earbuds again. Refresh your phone's Bluetooth devices, pair with QCY AilyBuds Pro+, and complete the setup.

\*Opening the charging case turns on the earbuds. If not, try again after charging.

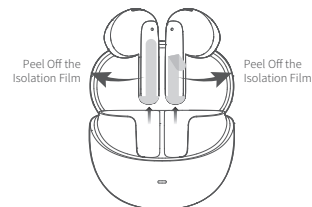

### One-Click Device Switching: (This step switches from Device A to Device B.)

Open the lid, keep both earbuds in the charging case, and press the case button for about 3 seconds. The earbuds will flash red once. Search for them on the device and click to connect.

\*The earbuds support connecting to two devices simultaneously. (Enable in the QCY APP settings)

## Multi-Device Connection

### Steps for Multi-Device Connection: (Enable in the QCY APP settings)

1. Power on the earbuds to initiate pairing. After connecting to Device A, turn off Bluetooth on the phone. The earbuds will enter pairing mode again.
2. Enable Bluetooth on Device B and select "QCY AilyBuds Pro+" for pairing.
3. On Device A, turn on Bluetooth and click the paired earbuds' name. Successful pairing means the earbuds are now connected to both devices simultaneously.

(Note: The one-drag-two function and LDAC audio decoding format cannot be enabled simultaneously.)



## Factory Reset

### Clearing Pairing Records (Use in case of connection issues)

Place the earbuds in the charging case, open the lid, and press the charging case button for 10 seconds. The earbuds will flash red 5 times, indicating the reset is complete after the blinking stops.

\* After the factory reset, follow the initial pairing method to connect for normal usage.

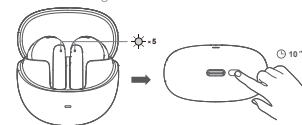

## User Guide

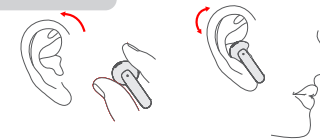

1. Properly wear the earbuds on both the left and right sides. After wearing them, you can make slight adjustments by rotating to find a personally comfortable and secure position.
2. Ensure the microphone opening is facing downward towards the mouth.
3. Incorrect earbuds placement may affect both calls and hearing to varying degrees.

\* If the fit is not snug enough, the ANC noise cancellation effectiveness may decrease. Try adjusting the wearing angle and direction before reactivating the adaptive noise cancellation mode.

### Earbuds Charging

While charging, the red light stays on and turns off when fully charged.

### Charging Case Charging

During charging: The red light stays on.  
Fully charged: The white light stays on.

### Charging Case Battery Status

Sufficient battery: When the charging case is opened, the white light will stay on for 5 seconds before turning off.  
Low battery: When the charging case is opened, the red light will stay on for 5 seconds before turning off.  
Insufficient battery: When the charging case has insufficient battery, the red light will quickly flash three times before turning off.

## Functions

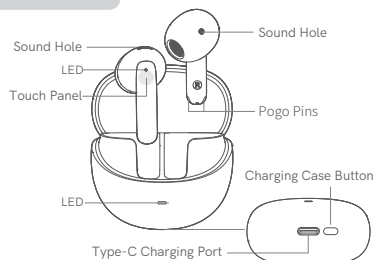

- Ⓜ Power On: Open the charging case (earbuds inside) or, if the earbuds are outside the case, long-press the touch panel for 1.5 seconds.
- Ⓜ Power Off: Place the earbuds into the charging case and close the lid.
- Ⓜ Answer/End Call: Double-tap the touch panel.
- Ⓜ Reject Call: Long-press the touch panel for 1.5 seconds.
- Ⓜ Play/Pause: Double-tap the touch panel.
- Ⓜ Next Track: Triple-tap the right ear touch panel.
- Ⓜ Voice Assistant: Triple-tap the left ear touch panel.
- Ⓜ Low-latency Mode: Keep touching left panel for 1.5s
- Ⓜ Adaptive ANC: Keep touching right panel for 1.5s to turn on/off

## Warranty

Your QCY product purchase is covered by a one-year limited manufacturer warranty from the date of delivery. Please ensure you retain your purchase receipt. If any defects occur due to quality issues within the warranty period, kindly bring both the warranty card and the purchase receipt to the authorized dealer for complimentary replacement services.

Model Number:
Date of Purchase:
User's Name:
User's Phone:
User's Address:
Shop's Name:
Shop's Address:
Comments:

The manufacturer's warranty is void under the following circumstances but not limited to:

- Improper or inadequate maintenance or modification.
- Accident, misuse, abuse, contamination, or other external causes.
- The use of unspecified adapter and accessories.
- Malfunctions or damages resulting from natural disasters, earthquakes, lightning, abnormal voltage, or environmental factors.
- Damages that occur as a result of one's failure to follow the instructions.

## FCC Statement

This equipment has been tested and found to comply with the limits for a Class B digital device, pursuant to Part 15 of the FCC Rules. These limits are designed to provide reasonable protection against harmful interference in a residential installation. This equipment generates uses and can radiate radio frequency energy and, if not installed and used in accordance with the instructions, may cause harmful interference to radio communications. However, there is no guarantee that interference will not occur in a particular installation. If this equipment does cause harmful interference to radio or television reception, which can be determined by turning the equipment off and on, the user is encouraged to try to correct the interference by one or more of the following measures:

- Reorient or relocate the receiving antenna.
- Increase the separation between the equipment and receiver.
- Connect the equipment into an outlet on a circuit different from that to which the receiver is connected.
- Consult the dealer or an experienced radio/TV technician for help.

This device complies with part 15 of the FCC Rules. Operation is subject to the following two conditions:

- (1) This device may not cause harmful interference, and (2) this device must accept any interference received, including interference that may cause undesired operation.

Changes or modifications not expressly approved by the party responsible for compliance could void the user's authority to operate the equipment.

Right earphone : FCCID:RDR-BH23HT10AR

Left earphone : FCCID:RDR-BH23HT10AL

## Safety Precautions

1. Please carefully read and retain this user manual before using the product.
2. If the product is not used for an extended period (more than 2 weeks), please recharge it.
3. You must choose a charger produced by a legitimate manufacturer and certified by the national safety authority.
4. If your phone cannot detect the Bluetooth earbuds, either re-enter pairing mode or perform a factory reset on the Bluetooth earbuds. If there is a phone program error, close and reopen Bluetooth on the phone or restart the phone.
5. Do not disassemble or modify the battery, insert foreign objects, expose it to high temperatures, or immerse it in water or other liquids to prevent battery leakage, overheating, ignition, or explosion. Battery replacement should only be done by the manufacturer.
6. Do not drop, crush, or puncture the battery. Prevent external pressure that may lead to internal short circuits and overheating.
7. Do not dismantle or modify the earbuds for any reason, as it may result in fire, electronic breakdown, or permanent damage to the product.
8. Do not expose the product to extremely low or high temperatures (below 0°C or above 45°C).
9. Do not the product indicator light near the eyes of children or animals.
10. Do not use the product during thunderstorms, as it may cause abnormal operation and increase the risk of electric shock.
11. Do not use oil or other volatile liquids to clean the product.
12. please do not use this device for long periods of time and at high volume, as there is a risk of hearing damage.



**Manufacturer:** Dongguan Hele Electronics Co., Ltd.  
**Address:** No. 325 Yuehui Rd. Daojiao Town Dongguan City Guangdong Province China

**Notice:** This marking indicates that this product should not be disposed with other household wastes throughout the EU. To prevent possible harm to the environment or human health from uncontrolled waste disposal, recycle it responsibly to promote the sustainable reuse of material resources. To return your used device, please use the return and collection systems or contact the retailer where the product was purchased. They can take this product for environmental safe recycling.



RoHS  
Made in China