

# TreatArcade

## Pet Game Console

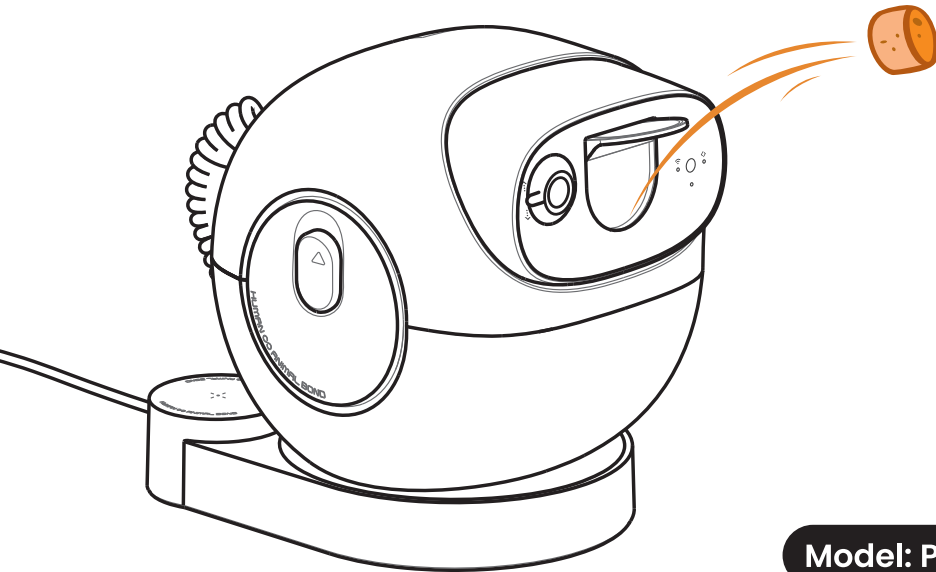

Model: P301201

User Manual

# IMPORTANT SAFETY INSTRUCTIONS

**BEFORE USING THIS PRODUCT READ ALL INSTRUCTIONS AND WARNINGS IN THIS MANUAL.**

## **WARNING**

**To reduce the risk of burns, fire, electric shock, or injury to persons:**

1. Do not let children handle the product and keep them away from the range of treat-tossing. Keep a close eye on children when they approach the product.
2. Please keep children and pets away from the plastic bags filled with product accessories which pose the risk of suffocation.
3. Do not place the product in water, which may damage its electronic components.
4. Do not place or store the product where it may fall or get pulled into bathtubs or sinks. Do not place the product in puddling or damp places.
5. Please check the product after installation, and do not connect power supply if water marks are spotted on the product, the adaptor, the USB cable or the power port.
6. The product should be placed on a level and smooth surface. To avoid tripping, please always place the product out of the paths people walk. Do not place the product near stairs.
7. The product is for indoor use only.
8. The product is intended for tossing treats and monitoring dogs and cats. Please do not use it beyond its intended purposes. Please do not apply it to puppies or kittens aged less than 3 months or pets with disabilities.
9. The product is applicable only to dry pet food with a diameter of 1/8" to 5/8". Please do not use it with wet food, cans, liquid treats, or powder.
10. Please do not place any foreign matters in the treat hopper which could lead to disfunctions or even cause harm to people or the pets.
11. Please do not touch or near the tossing outlet and keep away from the range of treat-tossing when the product works.
12. Use only accessories sold by the manufacturer. Using accessories not approved or sold by the manufacturer may result in unsafe situations. Do not disassemble or modify the product by yourself, except for detachable accessories as shown in this user manual.
13. Please do not let your pets chew or swallow any part of the product.
14. The plastic used for this product is BPA-free, but some of the pets could be sensitive to plastic itself. Please stop using the product in case of any sign of allergy from your pet and seek your veterinarian's advice.
15. Please check the state of the product and clean the treat hopper on a regular basis to ensure normal functioning.
16. Please lift the product with both hands if you need to remove it and keep it upright. Please do not lift it by holding the cable.
17. The ambient temperature for operating and charging should be 32 °F to 113 °F.

**READ AND SAVE THESE INSTRUCTIONS**



Please do not let children handle the product and keep them away from the range of treat-tossing. Keep a close eye on children when they approach the product.



Please keep children and pets away from the plastic bags filled with product accessories which pose the risk of suffocation.



Please place the product on a horizontal and flat surface. Keep it away from your daily route to avoid being tripped. Please do not place it near the stairs.



The product is applicable only to dry food. Please do not use it with wet food, cans or liquid food. Please do not place any foreign matters in the treat hopper.



Please do not touch or near the tossing outlet and keep away from the range of treat-tossing when the product works.



The product is not waterproof except for the bowl. Please keep the product away from water.

## No Connection? Quick Guide

Please place the product as near as possible to the router to ensure stable network connection and better using experience.

**Keep the product within 20 ft from the router.**

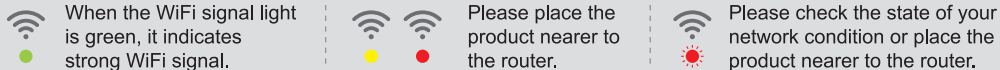
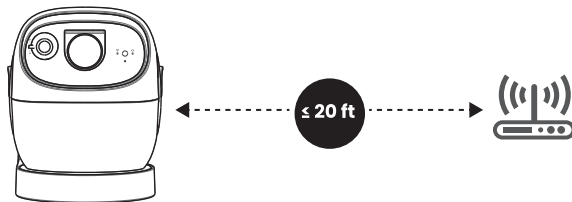

## In the Box

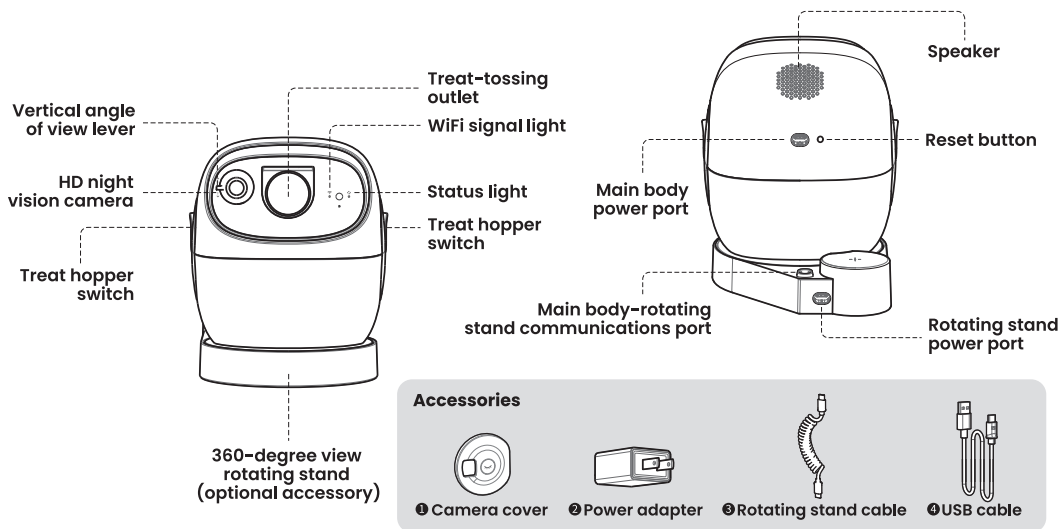

# INSTALLATION

If you have a rotating stand: Please read step 1-5. If you do not have a rotating stand: Please read step 3. and 6.

## 1. Remove the rotating stand from the packaging box.

With a rotating stand

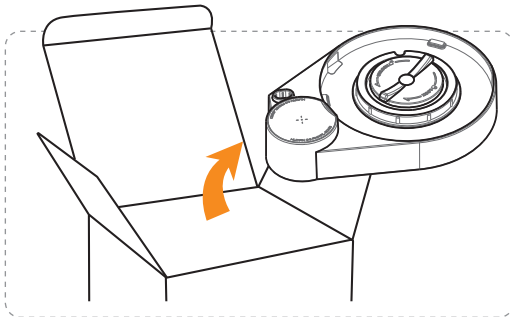

## 2. Rotate the rotating stand fixator counterclockwise to remove it.

With a rotating stand

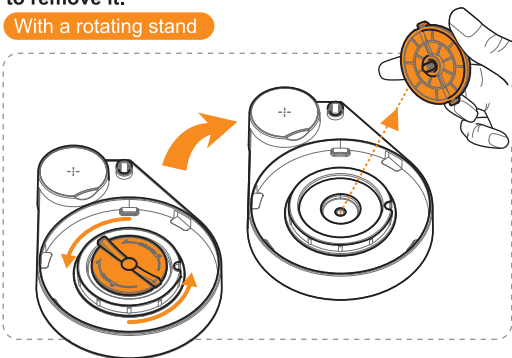

## 3. Open the treat hopper.

With a rotating stand

Without a rotating stand

①. Slide both hands up while pressing the switch buttons.

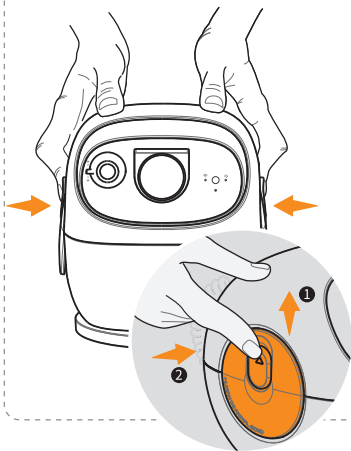

②. Lift the lid.

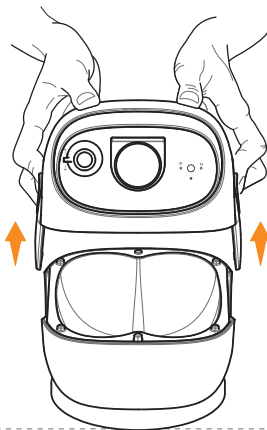

③. Remove the bowl.

Remove the camera cover stored inside the bowl.

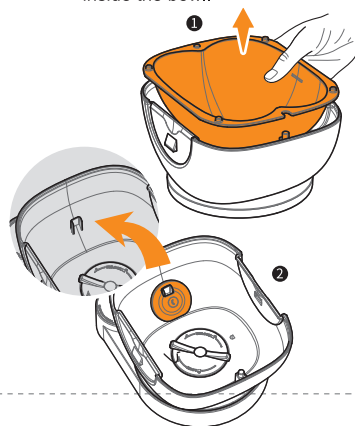

# INSTALLATION

If you have a rotating stand: Please read step 1-5. If you do not have a rotating stand: Please read step 3. and 6.

## 4. Connect the rotating stand to the product. With a rotating stand

①. Place the treat hopper above the rotating stand.

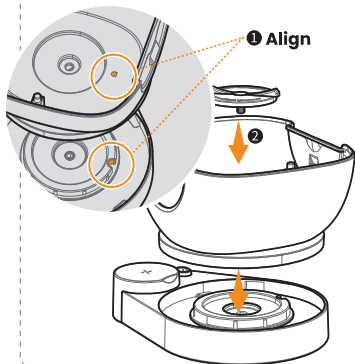

②. Rotate the fixator clockwise to connect the rotating stand with the treat hopper so that they are held in position.



③. Insert the main body-rotating stand communications cable into the port on the product until you hear a click, and insert the other end of the cable into the port on the rotating stand.

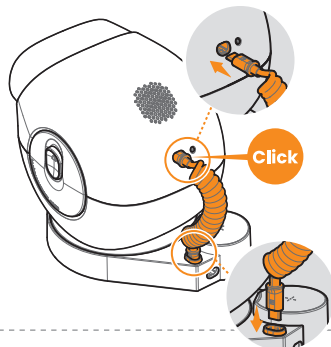

## 5. Connect the power supply

With a rotating stand

①. Connect the USB cable to the rotating stand power port.

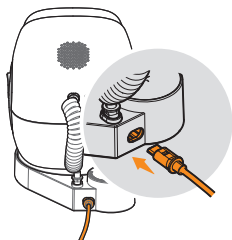

②. Connect the adaptor to the power supply. Please do not use adaptors that are not provided in the box.

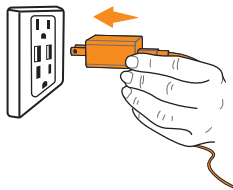

## 6. Connect the power supply

Without a rotating stand

①. Connect the USB cable to the main body power port.

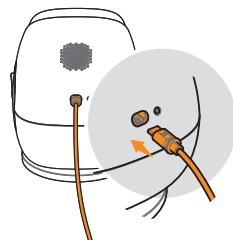

②. Connect the adaptor to the power supply. Please do not use adaptors that are not provided in the box.

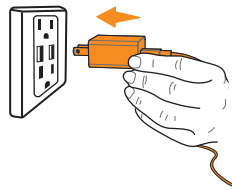

# Usage

## 1. Add treats

①. Slide both hands up while pressing the switch buttons.

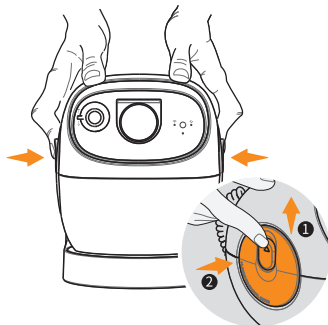

②. Lift the lid.

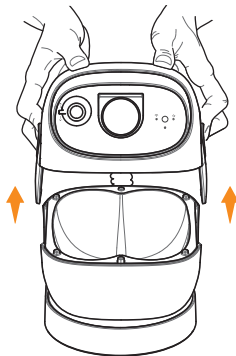

③. Add treats, but do not pass the MAX mark.



## i Tips



**Applicable food**



1/8"-5/8"



Dry, freeze-dried, air-dried or raw blend pet food with a diameter of 1/8"-5/8"



**Inapplicable food**



Wet cans, liquid food, drinks or fresh food

## 2. Placement

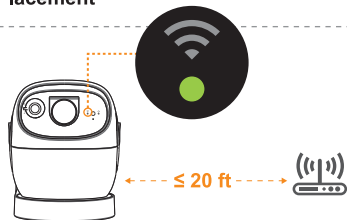

Keep the product within 20 ft from the router to ensure stable connection. When the WiFi signal light is green, it indicates strong WiFi signal.

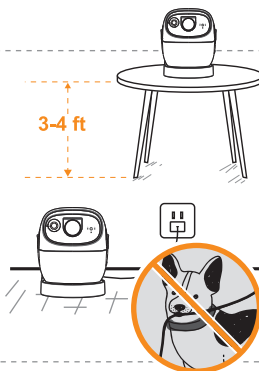











Place the product on tables that are 3-4 ft above the ground for better vision and tossing distance.

Avoid using power supplies near the ground to prevent your pet from biting the cable.

# Usage

## 3. Indicators

Indicator	State	Indicating
 Status light	 Steady orange light	Power connected
	 Blinking orange light	Unconnected
	 Blinking blue light	Connected with app, offline
	 Steady blue light	Connected with app
 WiFi signal light	 Steady orange light	Power connected
	 Steady green light	Strong WiFi signal
	 Steady yellow light	Moderate WiFi signal – move the product closer to the router
	 Steady red light	Moderate WiFi signal – move the product closer to the router
	 Flashing red light	WiFi connected, but no signal – check the network connection, or move the product closer to the router

## 4. Product reset

Press the button for 5 seconds and release after you hear a prompt.  
When the indicator lights up in orange and blinks, it means the product has been reset.

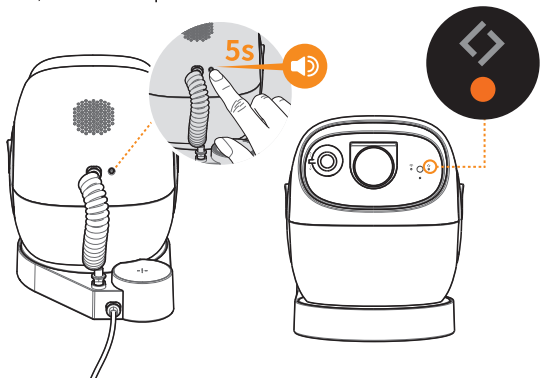

## 5. App connection

- ①. Scan the QR code below with a smartphone to download and install the app.
- ②. Click on the **[+]** button on the front page of the app, and connect the product following the on-screen instructions.



Download by scanning the QR code on **Android** phones



Download by scanning the QR code on **iOS** phones