

OPEN-EAR
HEADPHONES

INSTRUCTIONS MANUAL

Packing List

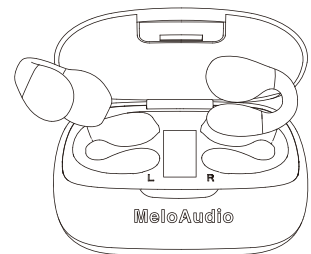
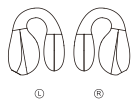

Headphone*2



Charging Case*1



Instructions Manual*1

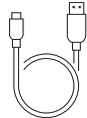

Type-C Charging Cable*1

1

Product Schematic Description

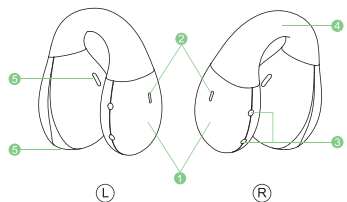

1. Multi-function buttons
2. Indicator
3. Magnetic Charging
4. Memory silicone

5. Multi-function buttons
6. Digital Display
7. Charging port
8. USB output

2

Product operating instructions



Power On

Method 1: Open the charging case, the headphones will turn on automatically.
Method 2: Long touch the MF button of the headphones for 3s to turn on the headphones.



Power Off

Method 1: Put the headphones into the charging case and close the cover.
Method 2: When the headphones are not connected to the Bluetooth device, long touch the MF button of the headphones for 5s to turn off the headphones.
Method 3: After disconnected from the Bluetooth device for 3 minutes.

Pairing

Step one: Open the charging case, the headphones will start pairing automatically.
Step two: Search and click for "MeloAudio S12" on the Bluetooth list of the smart device.

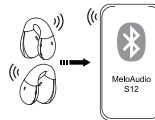

3

Operation

Normal

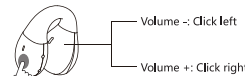

Music playback

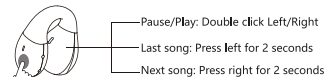

Phone

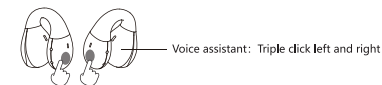
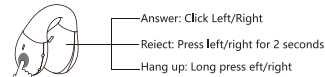

4

Restore factory settings



When not connected to the phone, four clicks on the headphones (both left and right operations are required) will automatically shut down after the four clicks take effect, completing the reset. Then, put the headphones into the charging compartment and take them out to pair again.

Wearing Guide

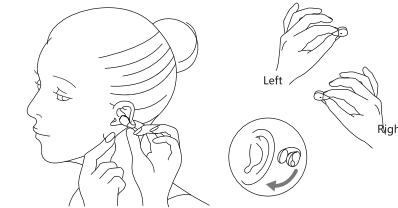

5

FCC Statement

This equipment has been tested and found to comply with the limits for a Class B digital device, pursuant to Part 15 of the FCC Rules. These limits are designed to provide reasonable protection against harmful interference in a residential installation. This equipment generates uses and can radiate radio frequency energy and, if not installed and used in accordance with the instructions, may cause harmful interference to radio communications. However, there is no guarantee that interference will not occur in a particular installation. If this equipment does cause harmful interference to radio or television reception, which can be determined by turning the equipment off and on, the user is encouraged to try to correct the interference by one or more of the following measures:

- Reorient or relocate the receiving antenna.
- Increase the separation between the equipment and receiver.
- Connect the equipment into an outlet on a circuit different from that to which the receiver is connected.
- Consult the dealer or an experienced radio/TV technician for help.

This device complies with part 15 of the FCC Rules. Operation is subject to the following two conditions:

- (1) This device may not cause harmful interference, and (2) this device must accept any interference received, including interference that may cause undesired operation.

Changes or modifications not expressly approved by the party responsible for compliance could void the user's authority to operate the equipment
FCC ID: 2BA20-S12

6