

400.973 mm

125.77 mm

67.3 mm

65.214 mm

338.008 mm

169.5 mm

TYLT
CORE

TYLT

venti

Car MagSafe® Compatible Mount +15W Charger

WIRELESS
PHONE
CAR CHARGER

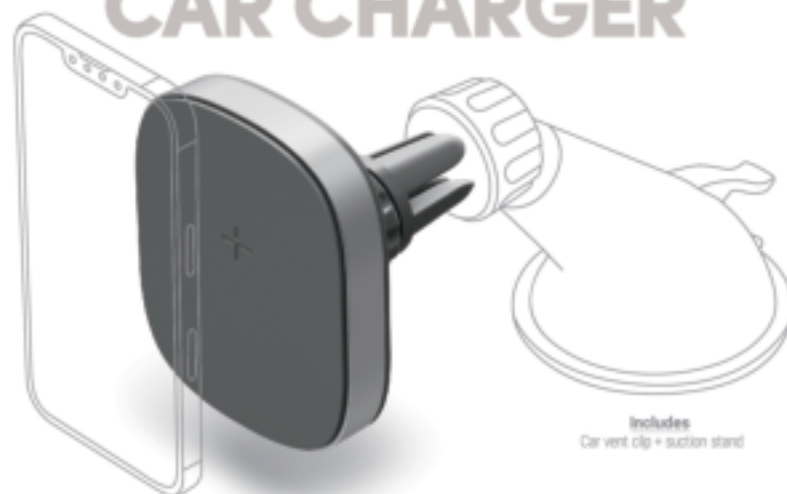

Includes
Car vent clip + suction stand



MagSafe®
Compatible



iPhone 12
and Newer



Qi Compatible
Charging



EACH PRODUCT
SOLD HELPS
PLANT A TREE

venti

Car MagSafe Compatible Mount +15W Charger

car magsafe® compatible mount +15w charger

Fast charge up to 15W • Magnetic wireless charging • Charges MagSafe® compatible devices • Vent clip and suction stand included • Input: 5V, 9V, 12V up to 3A • Output: up to 15W



MagSafe®
Compatible



Suction
Stand



Vent
Clip



Qi Compatible
Charging

Includes: Venti, Vent Clip, Suction Stand, USB-C Cable, Car Charger Made For: iPhone 12 mini, 12, 12 Pro, 12 Pro Max, 13 mini, 13, 13 Pro, 13 Pro Max



EACH PRODUCT
SOLD HELPS
PLANT A TREE

TYLT has partnered with One Tree Planted to help with reforestation efforts across the world. To learn more, visit www.tytl.com/cares



WARNING: Batteries, battery packs, battery terminals, and related accessories can expose you to chemicals including lead and lead compounds, which are known to the State of California to cause cancer and birth defects or other reproductive harm. For more information go to www.PSGWarnings.ca.gov

Limited 1 year warranty. To receive a free 1 year warranty extension (2 years total), register your product at: www.tytl.com/warranty

iPhone is a trademark of Apple Inc., registered in the U.S. and other countries.
© 2022 Tytl. Tytl and the logo are trademarks of Tytl Inc. Made in Vietnam. Designed in the U.S.A. in Sini Valley, CA. P60622

TYLT FC RoHS

www.TYLT.com

QIVMS15BK-T



8 43257 10174 4

6"

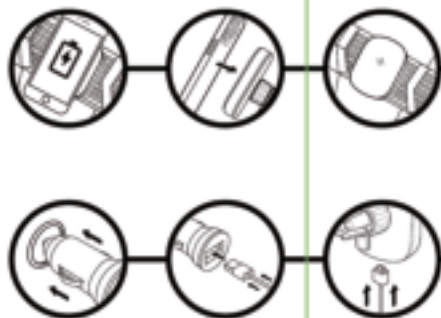
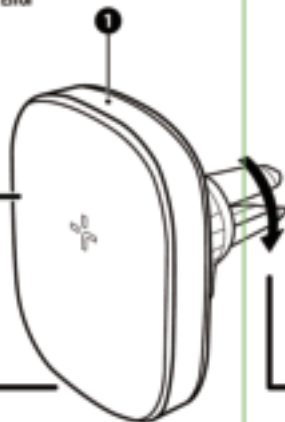
TYLT
+ / **venti**Car MagSafe® Compatible
Mount + 15W Charger**1****LIGHT INDICATION**
White – Charging
Blinking White – Error

IC3879



3.5"

FCC Caution: Any changes or modifications not expressly approved by the party responsible for compliance could void the user's authority to operate this equipment.

This device complies with Part 15 of the FCC Rules. Operation is subject to the following two conditions:

- (1) This device may not cause harmful interference, and
- (2) this device must accept any interference received, including interference that may cause undesired operation.

This equipment should be installed and operated with minimum distance 20cm between the radiator and your body.

NOTE:

This equipment has been tested and found to comply with the limits for a Class B digital device, pursuant to Part 15 of the FCC Rules.

These limits are designed to provide reasonable protection against harmful interference in a residential installation. This equipment generates, uses and can radiate radio frequency energy and, if not installed and used in accordance with the instructions, may cause harmful interference to radio communications.

However, there is no guarantee that interference will not occur in a particular installation. If this equipment does cause harmful interference to radio or television reception, which can be determined by turning the equipment off and on, the user is encouraged to try to correct the interference by one or more of the following measures:

- Reorient or relocate the receiving antenna.
- Increase the separation between the equipment and receiver.
- Connect the equipment into an outlet on a circuit different from that to which the receiver is connected.
- Consult the dealer or an experienced radio/TV technician for help.