



## Content

In the box	02
Product Overview	04
Basic parameters	06
Set Up Your Camera	07
Mount Your Camera	11
Customer Service	15

## In the box

After opening the box, please check the following picture to see if the accessories are complete.

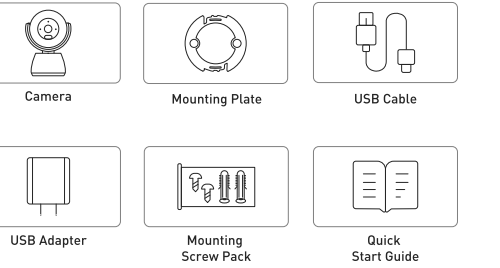

The indoor camera's power adapter is not weatherproof and should only be plugged into an indoor outlet.

## Introduction

### 1.Excellent clarity:

Real 3M pixels provide you with an unrivaled visual experience.

### 2.Color night vision:

Device has the built-in IR LEDs and spotlights that allow you to capture a color image even at the night.

### 3.Enhanced AI:

Support Human and Pet Detection.

### 4.Clear Two-way audio:

Built-in microphone and speaker allow you to carry on a conversation from anywhere with your phone.

### 5.Storage:

Support Local storage and cloud storage which work in a mode of 24/7 constant video recording or event-triggered video recording.

## Product Overview

### Appearance

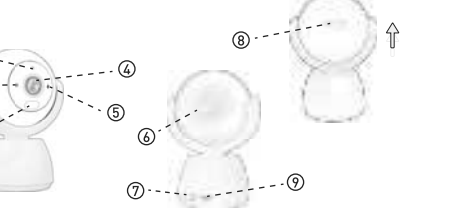

- |                          |                      |               |
|--------------------------|----------------------|---------------|
| ① Photosensitive Sensors | ② Status LED         | ③ Spotlights  |
| ④ Lens                   | ⑤ Microphone         | ⑥ Speaker     |
| ⑦ Reset Button           | ⑧ Micro SD Card Slot | ⑨ Power input |

## Status LED

LED Status	Description
Slow blinking Red	Ready to connect
Fast blinking Red	Disconnected from the internet
Slow blinking Blue	Connected to the router successfully
Solid Blue	The camera has been added successfully and working normally
Flashing blue and red alternately	A firmware update is in progress

## Basic parameters

Active pixels	2304*1296	Storage	SD Card (MAX128G)
Clarity Resolution	3Mp	Wi-Fi	Only 2.4GHz Wi-Fi
FOV	100°	Network Security	WPA-PSK /WPA2-PSK
Lens	3.6mm F2.0	Operating Temp	-10~+50 ℃
IR LED	26 ft	Power Source	DC 5V/1A
Spotlights	16 ft	Item Weight	5.65 ounces
Audio	MIC/Speaker	Product Dimensions	2.99 x 2.47 x 4.33 inches
Pan/Tilt	Pan: 0~345°, Tilt: -90°~90°		

## Set Up Your Camera

### Step 1 Download

Download the Tuya Smart or Smart Life App from the Apple AppStore or Google Play, or by scanning the QR code below.

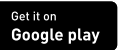

### Step 2 Connect it to the APP

1. Sign up a App account, go to the app homepage, tap Add Device, and select the smart camera(Wi-Fi).

⚠ Please follow the prompts of the App to allow relevant permissions, otherwise it will affect the addition and use of the device.

8

⚠ Please choose a 2.4GHz Wi-Fi, the camera does not support the 5GHz Wi-Fi.

9

⚠ When adding devices, please make the camera and mobile phone connect to a same Wi-Fi router.

10

## Mount Your Camera

### Choose a good spot for Mounting

The camera can be placed on a table, shelf, or can be mounted on a wall or ceiling. Choose a spot where you can get the desired view, and can reach a power outlet easily.

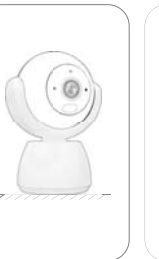
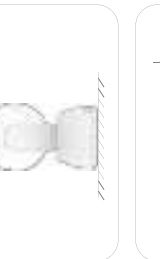
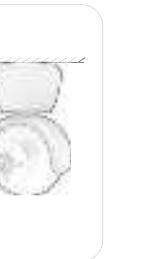

Table or shelf



Mounted on a wall



Mounted on a ceiling

11

## Placement Guidelines

### Consider the surroundings

Is a walls, light or anything blocking the view? It might throw off exposure, focus or Night Vision. Please Keep the Indoor Cam at least 0.7 ft / 20 cm away from walls or anything.

### Keep Camera in range of router

Make sure to choose a place within the signal range of your home WiFi. Please finish the Adding device steps before you mount your camera.

### Near the outlet

An electrical outlet is required near the installation spot to power the camera.

### Safe

To avoid risk of overheating and burns:  
Use only in temperatures between 14° and 122°F (-10° to 50°C). Do not block airflow to Indoor Cam.  
To avoid risk of fire and shock:  
Use only provided power cable and power adapter. install in accordance with building and installation codes where you live.  
To avoid risk of other serious injury:  
Keep camera and all components out of the reach of children and pets.

12

## Mount the Indoor Camera

Place your camera on a flat surface, or install it on a wall or ceiling with the provided mounting screws.

### To mount the Camera on the ceiling:

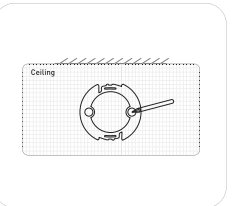

Step 1

Align the mounting plate and mark the two circles where the holes need to be drilled.

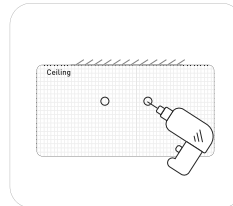

Step 2

Drill two holes above the two marked circles.

13

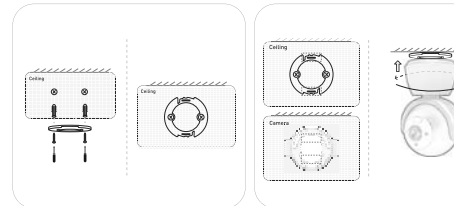

Step 3

Align the holes on the mounting plate with those in the ceiling. Insert two anchors into the holes and use the screws to affix the mounting plate over the anchors.

### To mount the Camera on the wall:

Please follow the steps 1-4 to secure the camera onto the wall.

Step 4

Align the grooves with the mounting plate and rotate the Camera clockwise until it clicks into place.

14

## How to Uninstall Your Camera:

Hold the main body of the camera, then rotate anticlockwise to remove the camera from the camera base.

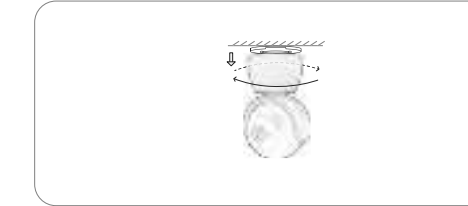

## Customer Service

### Warranty

12-month Limited Warranty

### Customer Support

yonggang.xie@ce-link.com

15

### RF exposure statement

This equipment complies with the FCC RF radiation exposure limits set forth for an uncontrolled environment. This equipment should be installed and operated with a minimum distance of 20cm between the radiator and any part of your body.

This equipment meets the exemption from the routine evaluation limits in section 2.5 of RSS-102. It should be installed and operated with a minimum distance of 20cm between the radiator and any part of your body.

Cet é quipement est conforme à l'exemption des limites d'é valuation habituelle de la section 2.5 de la norme RSS-102. Il doit é tre install é et utilis é à une distance minimale de 20 cm entre le radiateur et toute partie de votre corps.

### FCC Warning

This device complies with Part 15 of the FCC Rules. Operation is subject to the following two conditions:  
(1) This device may not cause harmful interference, and (2) this device must accept any interference received, including interference that may cause undesired operation.

NOTE 1: This equipment has been tested and found to comply with the limits for a Class B digital device, pursuant to part 15 of the FCC Rules. These limits are designed to provide reasonable protection against harmful interference in a residential installation. This equipment generates uses and can radiate radio frequency energy and, if not installed and used in accordance with the instructions, may cause harmful interference to radio communications. However, there is no guarantee that interference will not occur in a particular installation. If this equipment does cause harmful interference to radio or television reception, which can be determined by turning the equipment off and on, the user is encouraged to try to correct the interference by one or more of the following measures:  
- Reorient or relocate the receiving antenna.  
- Increase the separation between the equipment and receiver.  
-Connect the equipment into an outlet on a circuit different from that to which the receiver is connected.  
-Consult the dealer or an experienced radio/TV technician for help.

NOTE 2: Any changes or modifications to this unit not expressly approved by the party responsible for compliance could void the user's authority to operate the equipment.

### IC WARNING

This device contains licence-exempt transmitter(s) that comply with Innovation, Science and Economic Development Canada's licence-exempt RSS(s). Operation is subject to the following two conditions:  
(1) This device may not cause interference.  
(2) This device must accept any interference, including interference that may cause undesired operation of the device.

L' é metteur/r é cepteur exempt de licence contenu dans le pr é sent appareil est conforme aux CNR d' é Innovation, Sciences et D é veloppement é conomique Canada applicables aux appareils radio exempts de licence.  
L' exploitation est autoris é e aux deux conditions suivantes:  
1. L' appareil ne doit pas produire de brouillage;  
2. L' appareil doit accepter tout brouillage radio é lectrique subi, m é me si le brouillage est susceptible d' é en compromettre le fonctionnement.