

PRODUCT MANUAL

TTC-H40 CNC Router



Note: The picture is for reference only. The actual product is the standard

To our customers

Dear Customer:

To ensure a smooth assembly and usage experience, we have prepared this assembly and user guide manual. Please read the following content carefully and follow the instructions to ensure safety and convenience when using the product. If you encounter any issues during use, you can scan the QR code, access our company's website, and read USB drive information to access relevant instructional videos. In case of machine malfunction, please refer to the names of the corresponding parts inside the machine and inform us of the issue and the machine's condition via the after-sales email provided on this page.

After-sales Email: service@twotrees3d.com

Wikipedia: wiki.twotrees3d.com

InquiryEmail: info@twotrees3d.com



Webpage for information

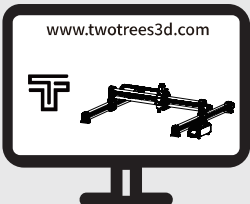

Visit www.twotrees3d.com to find the specific model information and device usage tutorials.

TF card information



Find the USB drive in the tool kit



Safety Warning:

1. Please make sure that the machine installation is firm, when first using the machine.
2. Please press the emergency stop button quickly when danger occurs.
3. Please wear safety goggles when operating machinery.
4. Please use a brush to remove debris, do not blow with your mouth.
5. Please be careful of the sharp parts when using milling tools or grinding workpieces.
6. Please ensure they are securely fastened when installing milling tools.
7. Please ensure that the machine is stopped before loading/unloading, adjusting tools, measuring, and cleaning.
8. Never wear cotton gloves during operation.
9. Never place measuring tools or other clutter within the working area.
10. Please ensure the workpiece is securely fastened when clamping it. Never start engraving if it is loose or not properly clamped.
11. This engraving machine is intended for using in indoor settings.
12. Considering the size and weight of the machine, you need to carry more than one person in order to protect the operator as well as the safety of the equipment.

TABLE OF CONTENTS

1. Unboxing operation	01
2. Part list	04
3. Machine assembly	08
3.1.Machine wiring	14
4. Operation manual	18
4.1.Tool installation	18
4.2.Jig setup	19
4.3.Electrical wiring	20
4.4.Turn on	21
4.5.Get familiar with the operation interface	22
4.6.Set the origin of coordinates	23
4.7.Select the engraving file	24
5. FAQ	25
5.1.Motherboard	25
5.2.Power supply	25
5.3.Screen	26
5.4.Motor	27
5.5.TF card issue	28
6. Machine parameters	29

1.Unboxing operation

After unboxing, remove the top cover wrapped in pearl cotton.

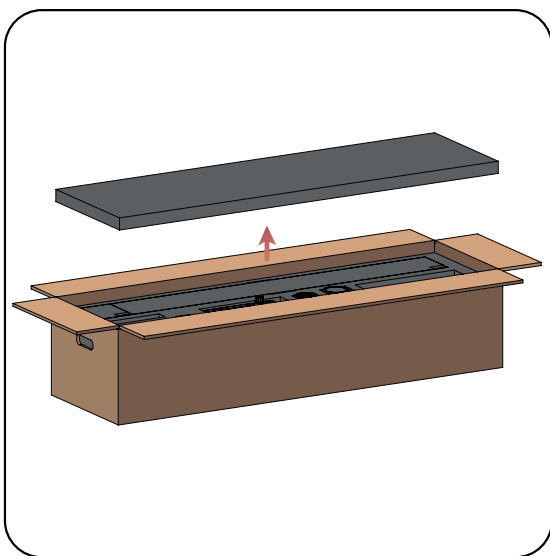

Then, take out the following items in order: cable chain and wires, spindle, spindle mounting bracket, edge trimming machine mounting bracket, Z-axis module, head-mounted ear muffs, tool kit, and a bag of screws.

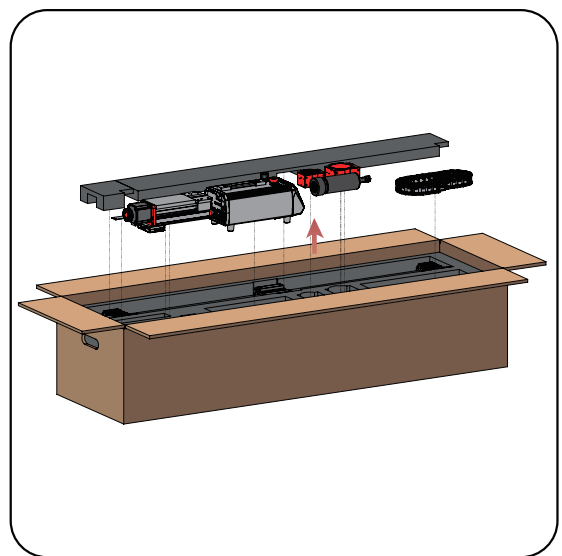

Take out the X-axis module.

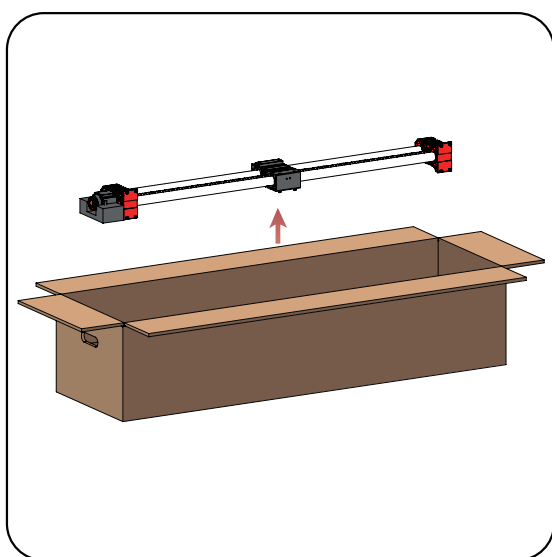

Take out the pearl cotton.

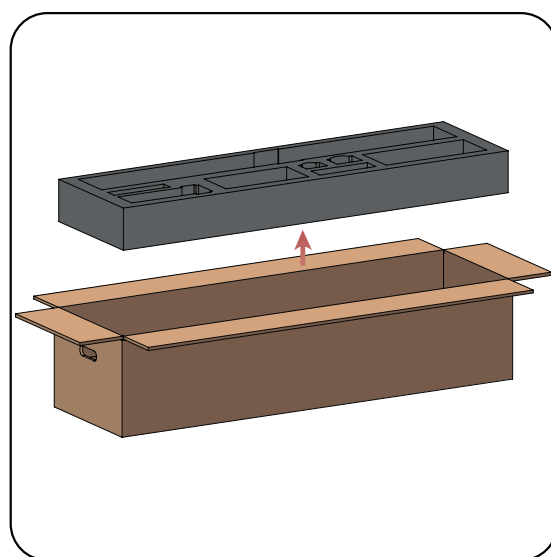

Take out the interlayer cotton, cable chain support bracket, and positioning strip in order.

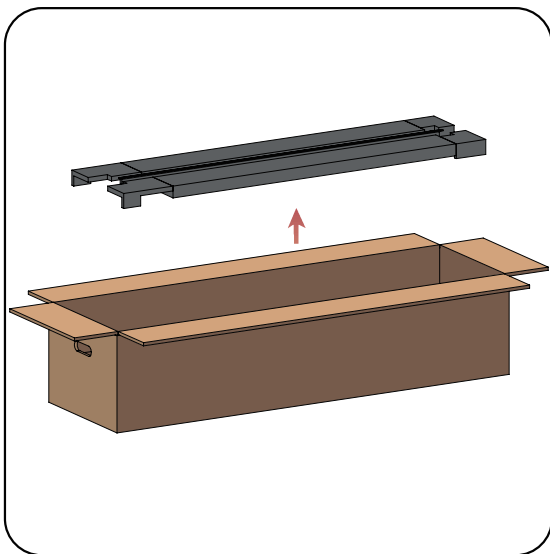

Take out the Y1 and Y2 modules in sequence.

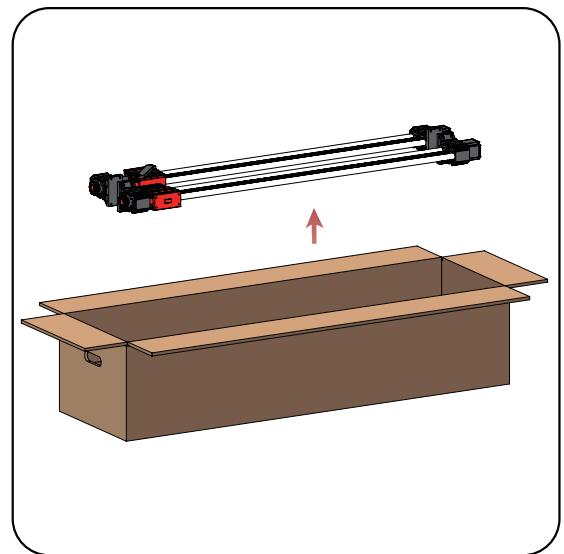

2.Part list

EN

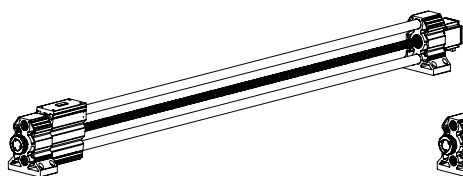

Left Y2 module x1

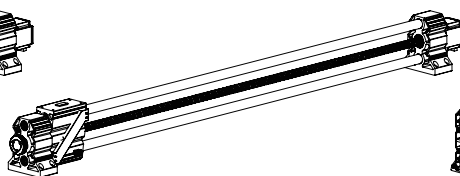

Right Y1 module x1

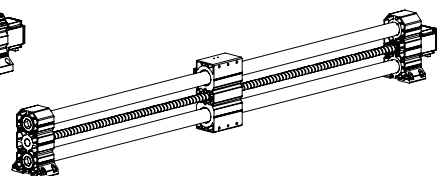

X-axis module x1

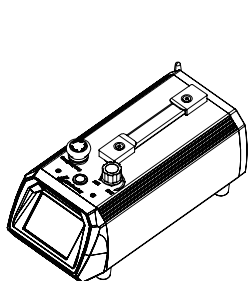

Control box
x1

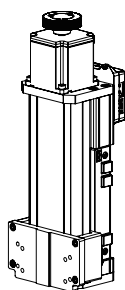

Z-axis module
x1



Spindle motor
x1

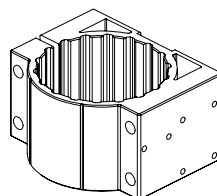

Spindle Mounting Seat
x1

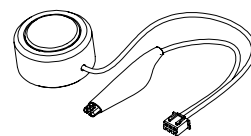

tool setting probe
x1

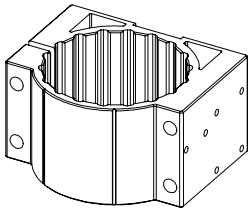

Trimming Machine
Mounting Seat x1

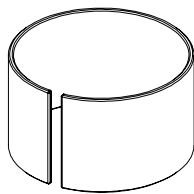

Adapter Sleeve x1

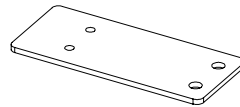

Fixed Cable Carrier
Sheet Metal x1

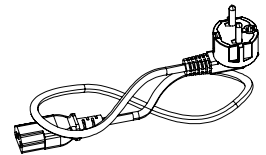

Power cable x1

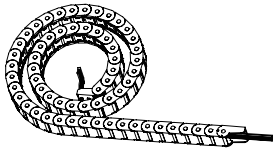

Drag Chains
and Cables x1

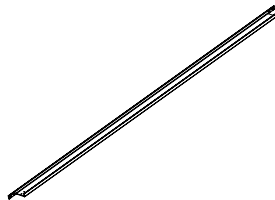

Drag chain
support bracket x1

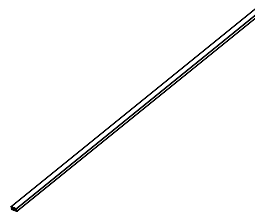

positioning
strip x1

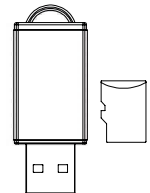

memory card x1



Phillips screwdriver x1

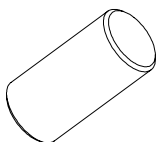

dowel pin x2

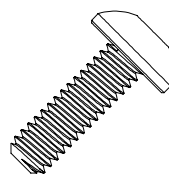

M3*8 semi-circular head screws x2

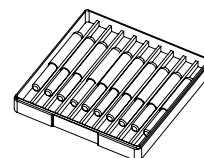

Cutter box x1

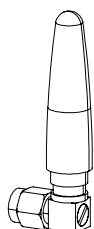

Antenna x1

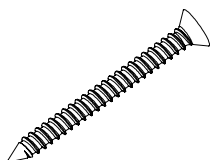

M3.5*35 selftapping Screw x30

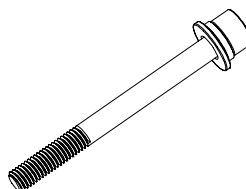

M5*55 cup head screw x4

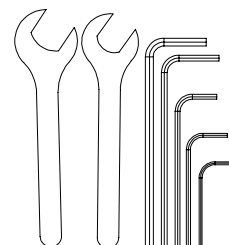

tool kit x1

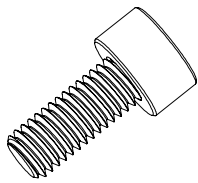

M5*12 cup head screw x8

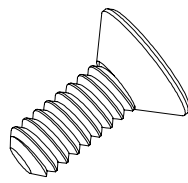

M3*6 countersunk screw x4

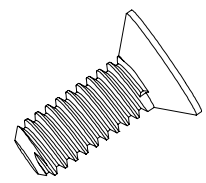

M4*8 countersunk screw x4

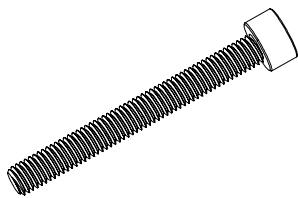

M5*45 cup head screw x4

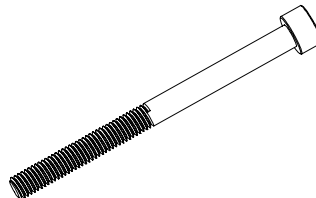

M5*65 cup head screw x4

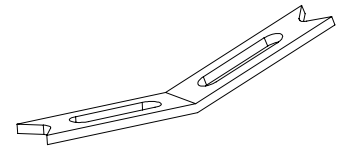

Workpiece clamping plate x6

3. Machine assembly

3.1. Move the right side of Y1 module and the left side of Y2 module to the front, and make sure they are flush against the base.

use :

Right Y1 module x1

Left Y2 module x1

3.2. Make sure that the moving blocks of the modules on the right side of Y1 and the left side of Y2 are already in tight contact with the base.

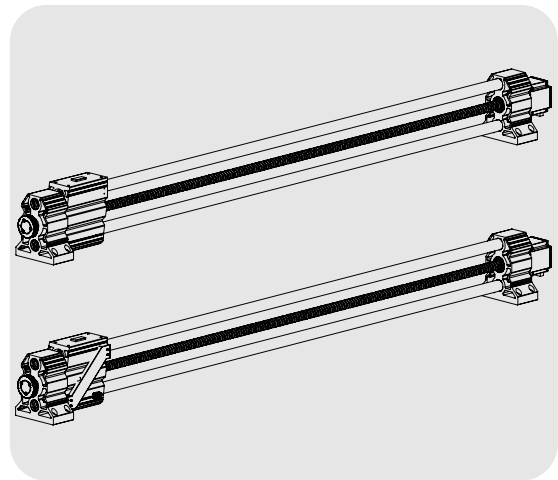
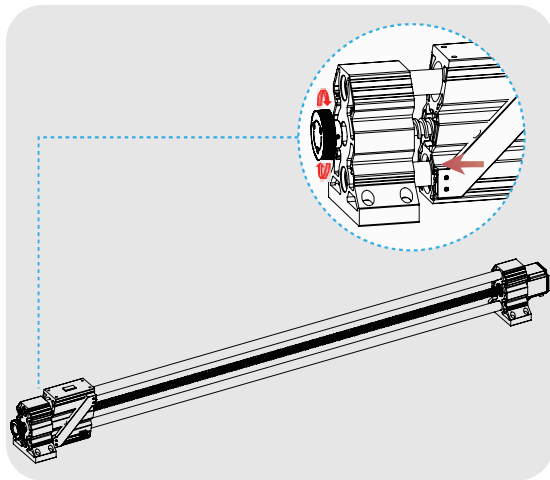

3.3. Place the Y2 module on the left side and the Y1 module on its right, and make sure that the positioning strip is at the front of the base.

use :

positioning strip x1

Right Y1 module x1

Left Y2 module x1

3.4. Place the positioning strip between the bases of the Y1 and Y2 motors and make sure that both modules are aligned.

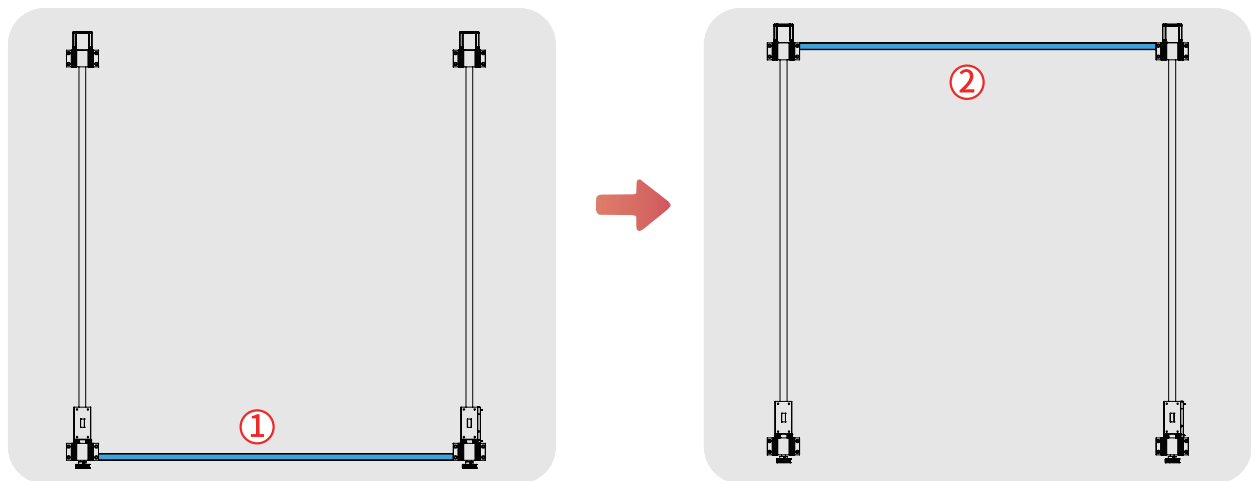

3.5. Ensure that the side of the moving block with multiple holes faces the front, when installing the X-axis module.

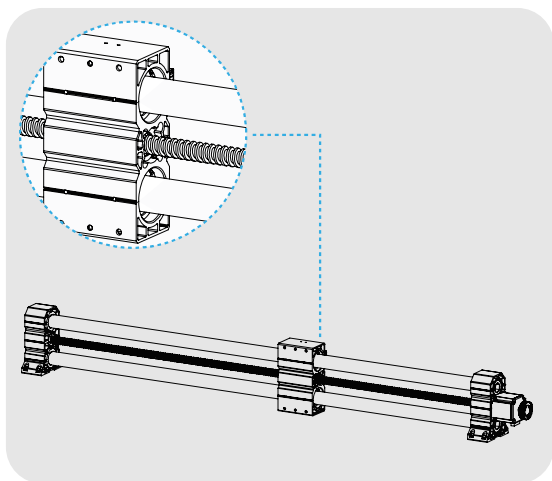

3.6. Place the X-axis module onto the surface of the Y1 and Y2 modules, and secure it with M5*12 cup head screws.

use :
X-axis module x1
M5*12 cup head screw x8

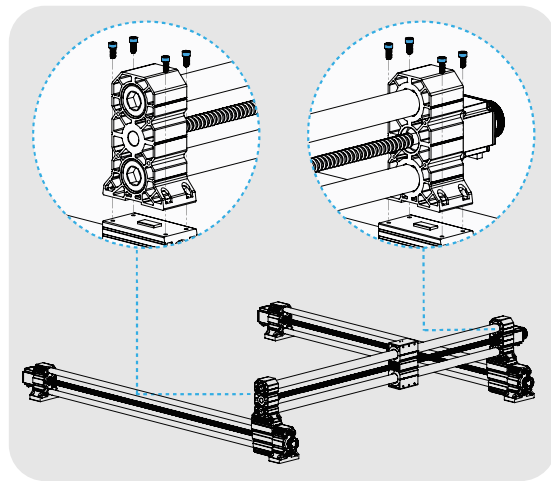

3.7. Install a pin in each of the upper and lower pin holes of the X-axis carriage block.

use :
dowel pin x2

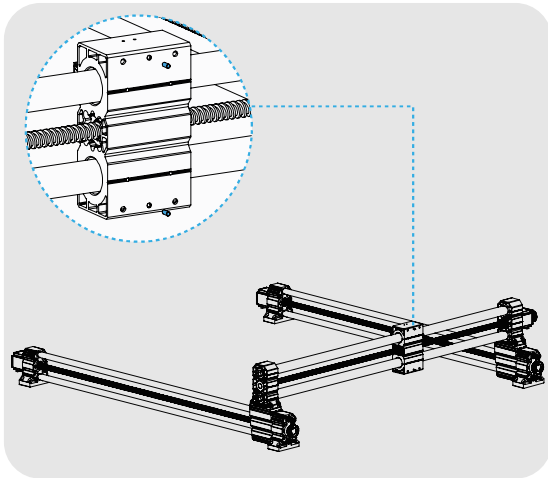

3.8. Align the back side of the Z-axis module with the front side of the X-axis module, and secure them with M5*45 cup head screws.

use :
Z-axis module x1
M5*45 cup head screw x4

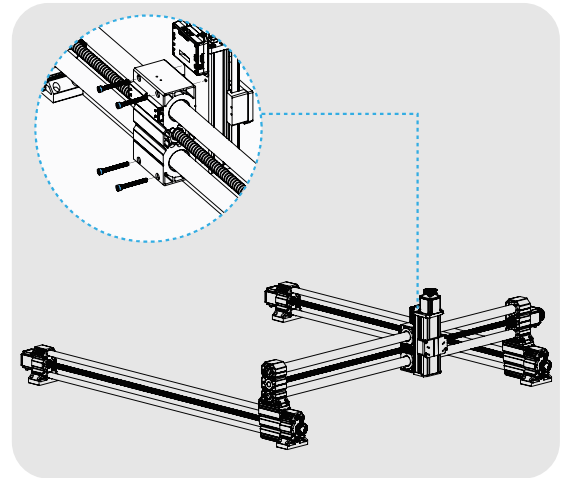

3.9. Install the cable chain bracket onto the plane of the X-axis module and secure it with M3*8 flat head countersunk screws.

use :

Fixed Cable Carrier Sheet Metal x1
M3*8 semi-circular head screws x2

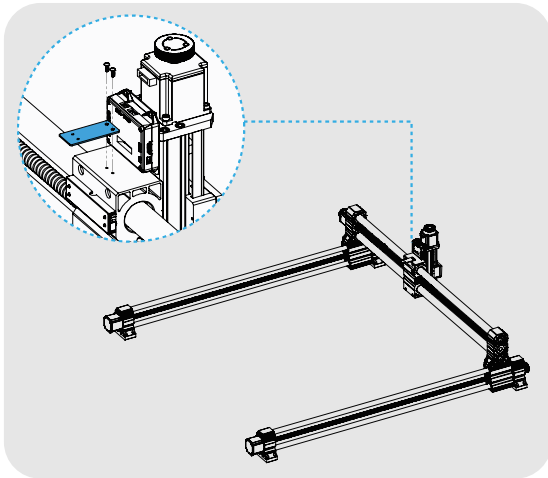

3.10. Install the cable chain support bracket on the backside of the X-axis module and secure it with M4*8 flat head countersunk screws.

use :

Drag chain support bracket x1
M4*8 countersunk screw x4

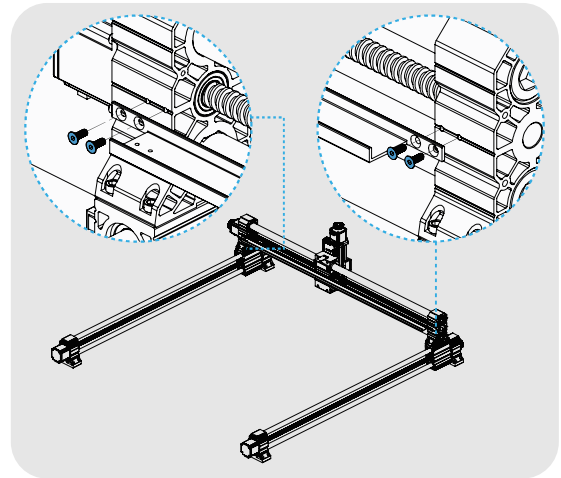

3.11. Position the cable chain and wires onto the support bracket, and fix the ends of the cable chain with M3*6 countersunk screws.

use :

Drag Chains and Cables x1
M3*6 countersunk screw x4

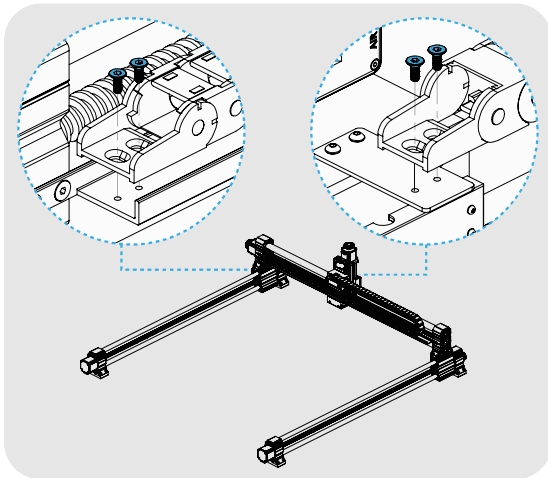

3.12. First, insert the M5*55 cup head screws into the spindle mounting bracket and align it with the hole of the Z-axis carriage module. Then, place the spindle motor in position, and tighten the screws.

use :

Spindle motor x1
Spindle Mounting Seat x1
M5*55 cup head screw x4

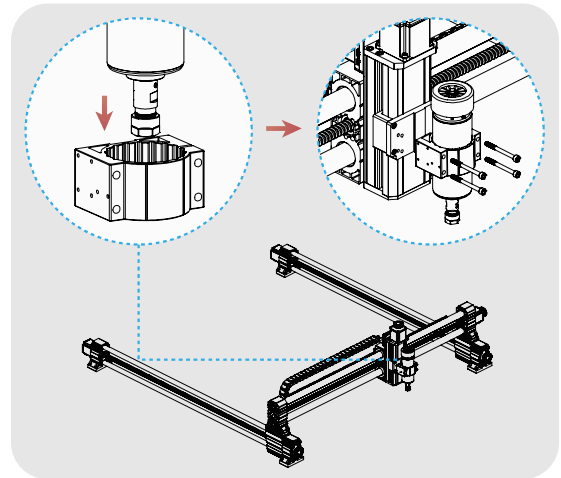

3.1. Machine wiring

3.1.1. Please insert the spindle motor cable into the corresponding port on the interface board at the back of the Z-axis module.

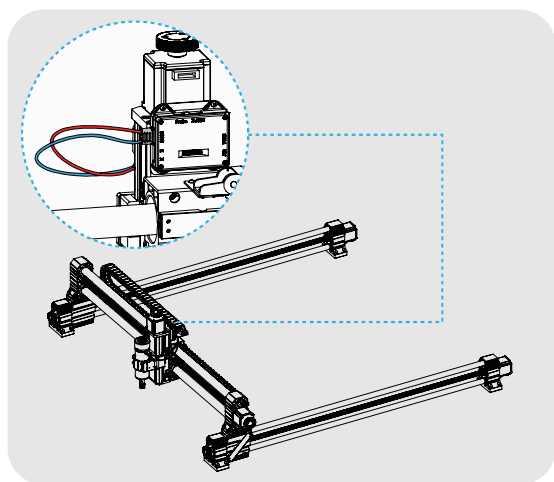

3.1.2. Plug the X-axis limit switch cable and the main control cable into their corresponding ports on the adapter board.

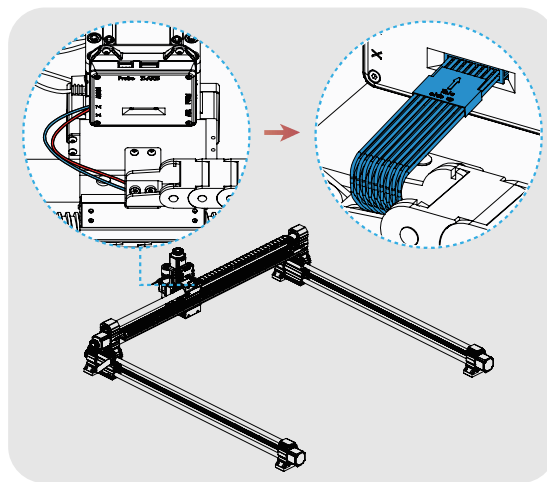

3.1.3. First, connect the limit switch cable to the limit terminal on the Y-axis. Then, insert the X-axis terminal into the corresponding port of the X-axis motor.

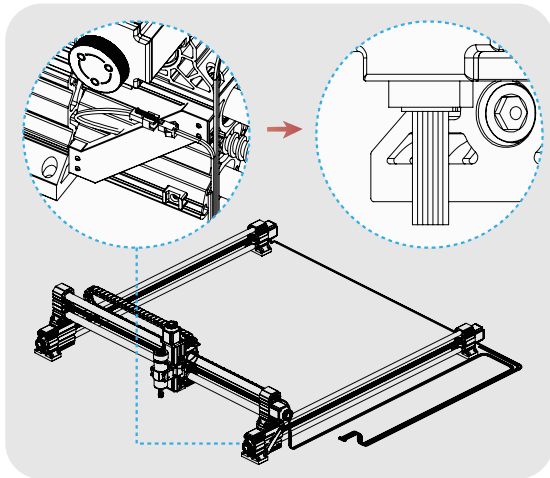

3.1.4. Align the antenna with the hole, and then tighten the nut clockwise.

