

# WATCH 9

## Pedometer

The watch monitors pedometer automatically, short press once, the second hand indicates the current movement completeness.

Declaration: Set in app before use.

## Remote Shutter

Enter into app photo interface, Press the button of watch to remote control phone take photo.

## Sleeping Monitor

Monitor sleep Automatically and check sleep data via app.

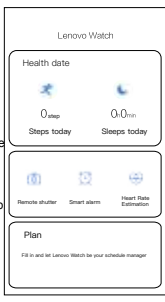

## Smart Time Sync

When the APP enters the calibration interface, the watch stops moving and input the position of the watch pointer into the APP. When the calibration starts, the watch pointer will synchronize with the time of the mobile phone system

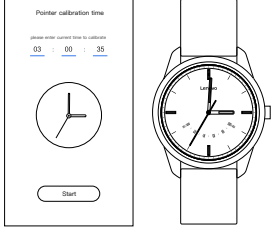

## OTA Upgrade

It will remind you update automatically once app updated with new version.

Declaration: There will be a little possibility to update failure due to special difference between cellphone. But you can try again if upgrade fail.

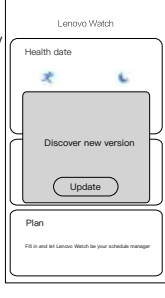

## Change Battery

Use professional tool to open the back cover of watch. Take out the old battery and put new battery into the battery jar. Click the reset button on the back.

Turn on to make sure the battery is installed in place. Then close the cover with the tool and start to use the watch. PS: suggest to change battery in specialized watch repair shop. Battery model No. CR2032.

## Low battery alert

After entering low power state, Watch will turn off the bluetooth and intelligent function automatically and only pointer walking. Then you should change battery. Declare: Now long press the button for 3 seconds, the light flashes once won't turn on bluetooth.



## Dialplate description

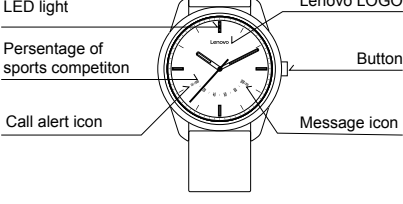

## Material

Shell case: zinc-alloy (sand blast)  
Bottom cap: Stainless steel  
Glass: Blue diamond glass  
Watch band: silicon band

## Size & configuration

Diameter: 40mm  
Thickness: 11.2mm  
Width: 18mm  
Net weight: 51g  
Waterproof: 50metres

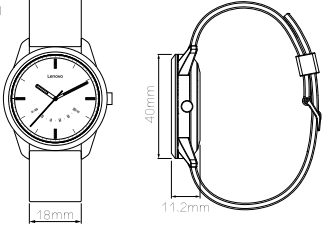

## Turn on

Long press the button for 3 seconds, and the 12 o'clock position light flicker continuously.

## Open the bluetooth

Long press the button for 3 seconds to open bluetooth, the 12 o'clock position light flicker continuously.

## Connect Bluetooth

enter the APP bluetooth search interface and choose the bluetooth name to connect, the watch will vibrate during the connection. Meanwhile press the button or shake the watch to confirm the connection, then the APP will skip to the function page.

## Close the Bluetooth

Press the button for 3 seconds, to turn off the bluetooth, and the 12 o'clock position light flashes once



## Check bluetooth

Short press the button, if the 12 o'clock position light flashes continuously, the bluetooth is not connected. If the 12 o'clock position light is on for 2 seconds, the bluetooth is connected; if the 12 o'clock position light flashes once, bluetooth is closed.

## Looking for cellphone

Short press the button twice continually (the time interval is 0.5-1 second). Turn on the finding phone function. The watch will vibrate once while the phone rings.

## Recover original factory mode

Long press the button for 12 seconds, enter power off status and recover factory setting.



## Call Alert

Authorize and turn on call alerts function in app before using. Watch vibrates to alert you of incoming call. Short press the button of watch or shake it to reject an incoming call.

## Sedentary Alert

Setting sedentary function in APP. Watch vibrates to alert you of being sedentary for too long.

## Message Alert

Authorize APP alerts before use app message remind function. Watch vibrates when message is coming.

## Silent Alarm

Turn on the APP to set the alarm, and the alarm reminder will be saved into the watch automatically. watch will vibrate at the right time.

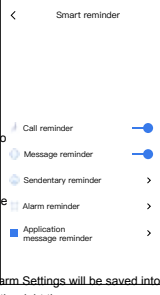

iOS version APP download



Android version APP download



Android version APP download



lenovo service

## EU Regulatory Conformance

Hereby, We, LENOVO(BEIJING), LTD., declares that the radio equipment type WATCH 9 is in compliance with the Directive 2014/53/EU.

## RF exposure

This equipment complies with RED's RF radiation exposure limits for general population without SAR evaluation.

Manufacturer: LENOVO(BEIJING), LTD.  
Address: NO.6 CHUANGYE ROAD, SHANGDI INFORMATION INDUSTRY BASE, HAIDIAN DISTRICT, BEIJING, CHINA, 100085  
Importer: Lenovo, Einsteinova 21, 851 01 Bratislava, Slovakia

Location to indicate: on the radio equipment or its packaging or manual.  
The device operates with the following frequency bands and transmitting power:

Frequency bands	Maximum output power
Bluetooth 2402-2480MHz	-1.11 dBm

CAUTION RISK OF EXPLOSION IF BATTERY IS REPLACED BY AN INCORRECT TYPE. DISPOSE OF USED BATTERIES ACCORDING TO THE INSTRUCTIONS

The maximum operating ambient temperature of the equipment declared by the manufacturer is 50°C



Waste Electrical and Electronic Equipment (WEEE)

This symbol means that according to local laws and regulations your product and/or its battery shall be disposed of separately from household waste. When this product reaches its end of life, take it to a collection point designated by local authorities. Proper recycling of your product will protect human health and the environment.

## Federal Communication Commission Interference Statement

This device complies with Part 15 of the FCC Rules. Operation is subject to the following two conditions: (1) This device may not cause harmful interference, and (2) this device must accept any interference received, including interference that may cause undesired operation.

This equipment has been tested and found to comply with the limits for a Class B digital device, pursuant to Part 15 of the FCC Rules. These limits are designed to provide reasonable protection against harmful interference in a residential installation. This equipment generates, uses and can radiate radio frequency energy and, if not installed and used in accordance with the instructions, may cause harmful interference to radio communications. However, there is no guarantee that interference will not occur in a particular installation. If this equipment does cause harmful interference to radio or television reception, which can be determined by turning the equipment off and on, the user is encouraged to try to correct the interference by one of the following measures:

- Reorient or relocate the receiving antenna.
- Increase the separation between the equipment and receiver.
- Connect the equipment into an outlet on a circuit different from that to which the receiver is connected.
- Consult the dealer or an experienced radio/TV technician for help.

## FCC Caution:

- > Any changes or modifications not expressly approved by the party responsible for compliance could void the user's authority to operate this equipment.
- > NOTE: The manufacturer is not responsible for any radio or TV interference caused by unauthorized modifications or changes to this equipment. Such modifications or changes could void the user's authority to operate the equipment.
- > This transmitter must not be co-located or operating in conjunction with any other antenna or transmitter.

## Radiation Exposure Statement:

This equipment complies with FCC's RF radiation exposure limits for general population without SAR evaluation.

The full text of the EU declaration of conformity is available at the following internet address: <http://www.lenovo.com>.