

## DUAL USB SMART CHARGER WITH PULSING LIGHT



USER'S MANUAL

### SAFETY

Please read and understand all instructions before use. Failure to follow these safety instructions could result in damage, the warranty does not apply.

1. Keep the Manual.
2. This product can be damaged if dropped, punctured or disassembled, or if it comes in contact with dripping liquid.
3. Avoid in direct sunlight for extended periods of time, which may cause damage.
4. Burn this product may explode.
5. Do not use this product in strong magnetic fields.
6. Use a soft dry cloth to clean this product , don't use cleaning products or abrasive oil.

### INSTRUCTION

#### Features

1. Dual USB ports, one USB quick charge 3.0, one current 5V-2.1A
2. Companion Smart 12V+ APP to monitor car battery and check car location.
3. Customize the colors of LED ring via Smart 12V+ APP to accentuate interior atmosphere; lights up to the beat of music.



- 1 USB charging port (5V-2.1A)
- 2 USB charging port (Quick Charge 3.0)
- 3 LED ring indicator
- 4 Car charger adapter

### HOW TO USE

- 1 Download the Smart 12V+ APP from the App Store (iOS devices) or Google Play (Android devices).



- 2 Plug this product into the vehicle's cigarette lighter socket. Start up the car and the charger automatically switch on.

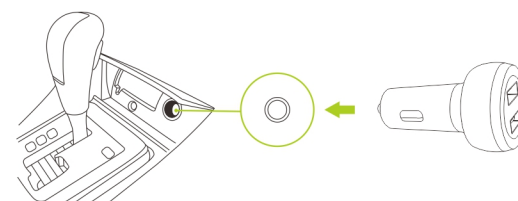

- 3 Open the Smart 12V+ APP and follow the instructions to connect the device via Bluetooth. Once connected, the LED ring indicator will light up.



- 4 With Smart 12V+ APP, you can to locate your car, monitor car battery and customize the colors of LED ring.

### FUNCTION

Open the Bluetooth and location functions of the phone, then open the Smart 12V+ APP.

Click the button "MASTER", the icon will be illuminated after the Bluetooth connected successfully. Click [About] to view "Common Problems", "User Instruction", "Clear Cache", "Present Version".

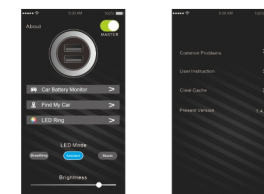

User Instruction



Common Problems



Clear Cache

### Car Battery Monitor

Click [ Car Battery Monitor ] to enter the interface.

**GOOD:** When battery voltage is 11.8V-12.8V (23.6V-26.2V) and engine voltage is 13.2V-14.5V (27.0V-27.5V), it's good enough to keep your driving.

**CHECK:** When voltage is 10.9V-11.7V (21.8V-23.5V), perhaps the battery needs charging , and when voltage is above 14.5V (27.5V), perhaps the battery needs checking.

**DAMAGED:** When battery voltage or engine voltage is less than 10.9V (21.8V), perhaps you need to change a new battery.

Click [ ] to view the record of Car Battery Monitor.

When using [ ] port for quick charging, the icon " Qualcomm Quick Charge 3.0 " will appear on the screen.

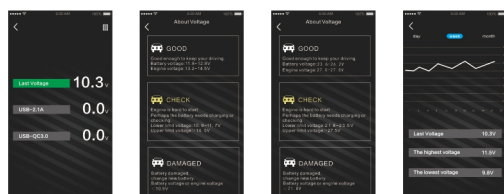

### Find My Car

After parking, the current parking position and time will be automatically recorded. Click [ Find My Car ] to enter the interface, you can use the map in the phone to find the car.

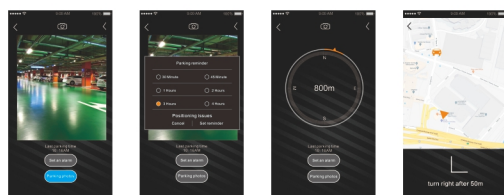

Click [ ] to enter camera interface, click [ ] to view parking photos, click [ ] to enter alarm setting interface. When you are 10 meters away from your car, the words "The car is nearby, please unlock your car." appear on screen.

### LED Ring

Breathing lamp editing: click [ Breathing ], then click [ LED Ring ] to edit the favorite color and then click [ Confirm ] to complete the color editing of breathing lamp.

Ambient lamp editing: click [ Ambient ], then click [ LED Ring ] to edit the favorite color and then click [ Confirm ] to complete the color editing of ambient lamp.

Slide "Brightness" to adjust the brightness of the LED lamp.

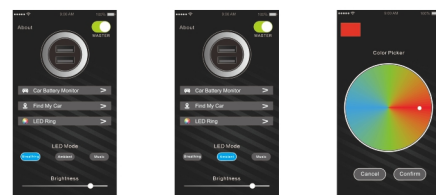

LED lamp editing in music mode: click [ Music ] to enter the music player interface, click [ + ] in the upper right corner to add the music you want. (Note: iOS only supports music downloaded with its own player, and does not support music downloaded by third-party players.) Click on the blank space to return to the music interface after finish adding.

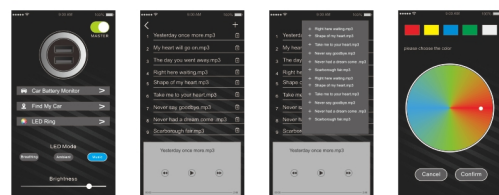

Turn back to main menu, click [ LED Ring ] to enter the color picker, click [ ], user can choose up to five favorite colors, the LED light up following music rhythm.

### CHARGING

The smart charger contains dual USB charging ports. You can charge two devices at the same time with maximum output power of 28.5W.

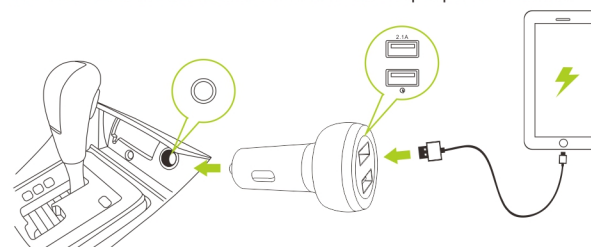

Parameters are subject to change without notice

Model : VC-6019D

DC input : 12V-24V DC 3A

Standard output : 5V-2.1A

Quick Charge 3.0 output : 5V=3A , 9V=2A , 12V=1.5A

Total Wattage : 28.5W

Bluetooth version : V 4.0

Operating temperature range : 0°C - 40°C

### NOTICE

#### FCC Statement

This device complies with part of the FCC Rules. Operation is subject to the following two conditions:

- (1) this device may not cause harmful interference, and
- (2) this device must accept any interference received, including interference that may cause undesired operation.

**Warning:** Changes or modifications not expressly approved by the party responsible for compliance could void the user's authority to operate the equipment.

**Note:** This equipment has been tested and found to comply with the limits for a Class B digital device, pursuant to Part 15 of the FCC Rules. These limits are designed to provide reasonable protection against harmful interference in a residential installation.

This equipment generates uses and can radiate radio frequency energy and, if not installed and used in accordance with the instructions, may cause harmful interference to radio communications. However, there is no guarantee that interference will not occur in a particular installation. If this equipment does cause harmful interference to radio or television reception, which can be determined by turning the equipment off and on, the user is encouraged to try to correct the interference by one or more of the following measures: (1) Reorient or relocate the receiving antenna. (2) Increase the separation between the equipment and receiver. (3) Connect the equipment into an outlet on a circuit different from that to which the receiver is connected. (4) Consult the dealer or an experienced radio/TV technician for help.

#### FCC Radio Frequency Exposure Statement

The device has been evaluated to meet general RF exposure requirements. The device can be used in fixed/mobile exposure conditions. The minimum separation distance is 20cm.

#### Bluetooth

"The Bluetooth" word mark and logos are registered trademarks owned by Bluetooth SIG, Inc. and any use of such marks by Wal-Mart Stores, Inc. is under license. Other trademarks and trade names are those of their respective owners."

If a footnote cannot be applied on a product, the footnote must be clearly printed on the product's associated packaging and printed matter.



Qualcomm Quick Charge is a product of Qualcomm Technologies, Inc. Qualcomm and Quick Charge are trademarks of Qualcomm Incorporated, registered in the United States and other countries. All Qualcomm Incorporated trademarks are used with permission.