

Installation Guide

For Vendors



Contents

Product Information	3
Safety Information.....	3
FCC	3
Class 1 Laser Information.....	3
Exempt Group LED Information.....	3
ADA Audio Jack	3
Welcome	4
Installation	4
Parts List	4
Step 2: Set up the Palm Scanner	5
Step 3: Virtually set up the Device	6
Step 4: Test the Device	7
Step 5: Sign up and pay for an item:.....	7

Product Information

Card Reader Terminal:

- Model Number: PFAY0H
- Input: 15 VDC, 2 A
- Power Adaptor
 - Model: MDS 030AAC15
 - Input: 100-240 VAC, 0.6-0.8 A, 50/60 Hz
 - Output: 15 VDC, 2 A, 30W, LPS

Safety Information

Power PFAY0H using the power adaptor shipped with the equipment (model MDS 030AAC15).

The device is for indoor use only.

Plug the power adaptor directly into a power outlet.

Do not use the power adaptor if it is broken, damaged or prongs are damaged.

Do not use the power adaptor in wet locations.

Do not use the power adaptor if the power cable is broken, damaged or frayed.

The device contains Li-ion battery that is not serviceable.

The device complies with UL/CSA 60950-1: Information Technology Equipment Safety Part 1: General Requirements

Changes or modifications not expressly approved by Nalloy LLC could void the user's authority to operate the equipment

FCC



This equipment has been tested and found to comply with the limits for a Class B digital device, pursuant to part 15 of the FCC Rules. These limits are designed to provide reasonable protection against harmful interference in a residential installation. This equipment generates, uses, and can radiate radio frequency energy and, if not installed and used in accordance with the instructions manual, may cause harmful interference to radio communications. Operation of this equipment in a residential area is likely to cause harmful interference in which case the user will be required to correct the interference at the user's expense.

To meet RF exposure requirements, this device needs to be placed at least 20 cm away from the body of the user as well as other radio antennas.

Card Reader Terminal (PFAY0H):

FCCID: 2AVOB PFAY0H

Class 1 Laser Information

Model PFAY0H contains a laser module that complies with CLASS 1 limits per IEC60825-1:2007 and IEC60825-1:2014. The module complies with 21 CFR 1040.10 and 1040.11, except for devices pursuant to Laser Notice No. 50, dated June 24, 2007.

CLASS 1 LASER PRODUCT

Exempt Group LED Information

Model PFAY0H LED illumination limit complies with the EXEMPT Group of IEC 62471.

ADA Audio Jack

Model PFAY0H is equipped with ADA audio headphone jack.

Welcome

Device is an identity and payments solution that provides customers an effortless way to identify and pay at a variety of brick-and-mortar retail experiences. The device associates customer identity with the transaction, feeding into existing rewards or loyalty programs, and removes friction and time spent at the checkout counter.

Once set up, a first-time customer will insert their credit card into the device and hover their palm above the device to sign up. Any subsequent visits to any store that uses the device, the customer will simply hover their palm over the device to pay and a text receipt is sent to their phone.

The device has a simple set-up process that connects it to an existing POS system in a store.

Installation

Parts List

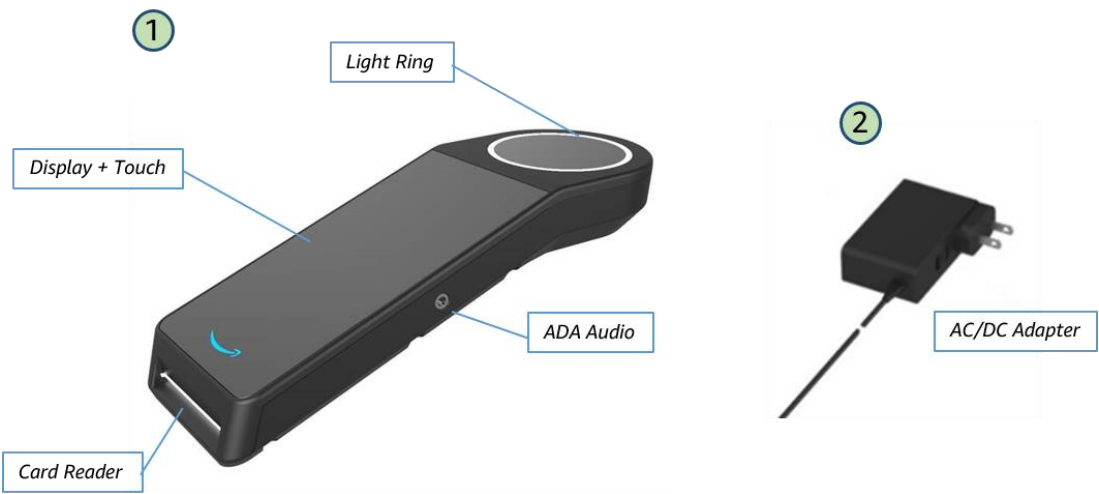

1	Palm Scanner
2	Palm Scanner AC/DC Adapter

Step 2: Set up the Palm Scanner

1. Insert the power plug end of the power cord through the mounted base on the table.
2. Insert the power cord into the wall and the opposite end into the back of the scanner.
The device will turn on automatically.



Palm Scanner power cord connection

3. Loosen the mount screw (if necessary) and place the scanner face up on the mounted base. The device screen and card reader insert needs to be facing towards the customer.
4. Place the scanner firmly in the base and twist the black screw into the mount to firmly secure.

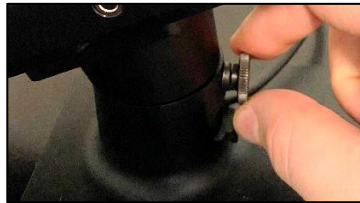

Palm Scanner mounting screw

5. Push down gently on the scanner to see if it moves. If it does, tighten the screw a little more until secure.

Step 3: Virtually set up the Device

Once IGT is installed, complete the following virtual set up steps:

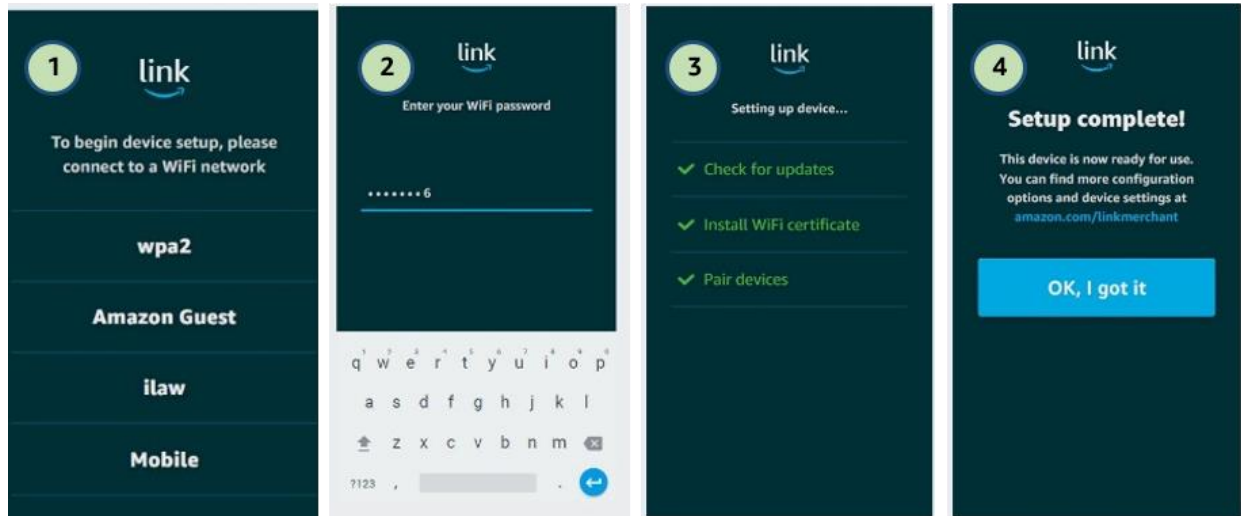

1. Search for and connect to a WiFi network.
2. Enter your WiFi password.
3. Set up device.
This will be completed automatically device will check for updates, install WiFi certificate, and pair with the other devices.
4. Select **OK, I got it** to complete set up.

IMPORTANT NOTE: Do **NOT** unplug the machine during the virtual set up process.

NOTE: If any of the steps fail, select the row to restart that step.

Step 4: Test the Device

Once the **Pay with your palm** page displays, the device is ready for use, no testing is required.

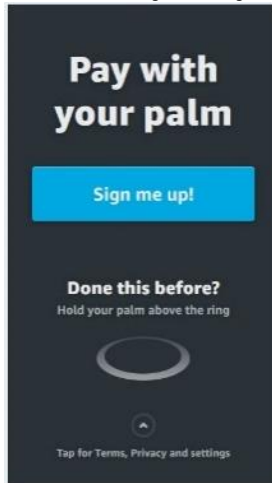

If you want to test the device with a supported credit card, follow the sign-up process as if you were a new customer to test the sign up process and the pay for an item.

NOTE: If you have signed up with a credit card before, then you can sign up with different credit card to walk through the steps or you can use your other palm to sign up again.

Step 5: Sign up and pay for an item:

1. At the Pay with your palm screen, select **Sign me up!**



2. Follow the prompts on the screen for when to insert a credit card, enter a phone number, and hover your palm above the scanner.

Once signed up, purchase something by going through the purchase process by holding your palm above the scanner. If you do not want to purchase anything skip this step.