

OWS 6.0 Bluetooth headset manual



Model:
OWS-S39

Search name: S39
Pairing mode: automatic pairing
Boot-on prompt sound: Boot-on.
Shutdown prompt sound: Shutdown.
Paired status prompt: Bluetooth is connected
Connection tip: Bluetooth is connected
Low power prompt: low power supply
Key function: long press on / long press shutdown / click music pause / call answer / hang up the phone double click cut song / three click volume adjustment / long press call SIRI
Not connected to standby: automatically shut down after five minutes

1.Left and right headphone diagram

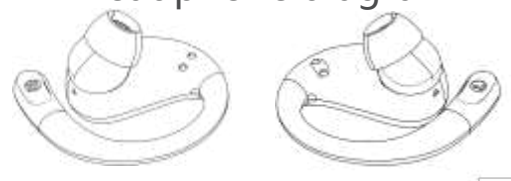

2.Openclosed ear switch diagram



The ear cap can rotate

Removable Bluetooth headset

Product parameter information:

Bluetooth version: 6.0

Battery capacity: 50 mAh polymer lithium battery

Song listening time: 4-6 hours (single use with full charge)

Standby time: 100 hours (with charging case) Charging time: 1.5 hours

Working current: 8 mA

Idle current: 4UA

Bluetooth level: Level 2 and level 3

Band / band: 2.4-2.485 GHZ

Support Agreement: A2DP / AVRCP / HSP/HFP

Modulation process: GFSK

Maximum transmission power: +2 DBm

Mobile charging chamber parameters:

1. Input current: 5V 300 A
2. Output current: 5V~300 A
3. Battery type: 3.8V, 300 mAh lithium ion polymer battery
4. Battery capacity of the charging chamber: 300 mAh
5. Charging time of charging chamber: about 1.5H
6. Working temperature: -10°C-55°C

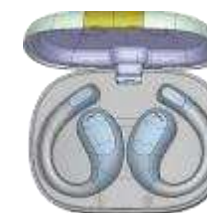

operation declaration:

Product connection name: S39

Headphone prompt switching: The red and white lights of a single headset will flash when it is turned on. Before the bluetooth connection with the phone is established, touch the headset twice in succession to switch between Chinese and English voice prompts.

Steps to use the dual-ear headphones:

Turn on both headphones simultaneously; the red and white lights will alternate for about 6 seconds. The system will automatically pair them, defaulting to the main channel with continuous flashing lights. The other auxiliary headphone will have its red and white lights off. The headphones will simultaneously display "Left Channel" and "Right Channel," indicating that the TWS pairing has been successful. At this point, you can turn on your phones Bluetooth to pair and search for connections. Once paired, the headphones will not flash during use.

Operation steps for single ear use of the adphon

ES : Takeout any one of the headphones from the charging case, turn on the power, and the red and white lights will

flash alternately for about 6 seconds. At this time, open the bluetooth of the mobile phone to pair and search for connection. After successful pairing, the headphones will not flash during use.

Headset on: Long press the touch button for about 5 seconds, the red and white lights of the headset alternate flashing, there is a "on" prompt sound;
Earphone shutdown: Long press the touch button for about 3 seconds, the red light of the headset flashes three times, and there is a "shutdown" sound;

No connection disconnect:

The headset enters the boot pairing or the mobile phone connection is disconnected from Bluetooth, and it will automatically shut down within 5 minutes;

Play/pause operation:

the headset is connected to standby mode. Click the touch button to play the song, and touch again to pause the song;

Song switching operation:

When the headset is connected to play a song, double-click the touch button on the right ear to switch to the next song, double-click the touch button on the left ear to switch to the previous song;

Call answering/dialing:

After connecting the headset, touch and click once to answer the call when a call comes in, and touch and click once again to hang up the call when the call ends;

Volume operation: During the process of connecting the headset to play or talk, press the left ear touch button three times in a row to reduce the volume, and press the right ear touch button three times in a row to increase the volume.

Operation to reject incoming calls:

If you do not want to answer a call, you can press the touch button twice in a row to reject incoming calls;

Call the voice assistant:

after the headset is connected and the standby process is over, long press the touch button for 1.5 seconds and release to wake up the voice assistant (SIRI) function;

Master-slave switching operation: After TWS connection, both master and slave connections can be used separately (for example, if one headset is turned off or in charging state due to power failure, it will not

affect the normal use of the other headset); two headsets can alternate as master channels.

Bluetooth reconnection operation:

Bluetooth has been successfully paired with the phone and the phone has not deleted the address code information (pairing name). Restart the headset again and it will automatically pair and connect (or when the headset is inserted into the charging case, dial up the headset and it will automatically reconnect).

Charging box charging/discharging

1. Put the earphone in the charging and discharging chamber, the earphone will display a red light, and the charging chamber will display a white light. After the earphone is fully charged, turn off the white light for about 2 minutes, and then all the earphones will be turned off and the charging chamber light will go out.
3. When charging the battery in the charging chamber, the red light will flash slowly. After being fully charged, the red light will stay on. Remove the charging cable in time when fully charged.

Note: If the Bluetooth headset is not used for a long time, please charge it fully and charge it once a week to extend the service life of the Bluetooth headset; Do not let the Bluetooth headset near the fire source; Do not put the Bluetooth headset and charging case next to inflammable and explosive items;
Safety instructions: Use a standard DC charger (DC 5v/500 MA-2A) to charge the charging chamber; Do not disassemble the charging chamber and Bluetooth headset or insert other items into the product to avoid damage or injury to you.

serious warning:

Do not use this product while charging. Please use the adapter specified by the manufacturer to charge this product.

Do not open the built-in lithium battery and leave it in fire. Do not let metal products contact or short circuit the electrode. Do not touch or squeeze the battery. Avoid placing it in a humid corrosive environment or overheating (>60C). Packaging list:
Bluetooth headset 2 PCS charging case
1 PCS manual 1 PCS certificate of conformity 1 PCS charging cable 1

to try to correct the interference by one or more of the following measures:
-- Reorient or relocate the receiving antenna.
-- Increase the separation between the equipment and receiver.
-- Connect the equipment into an outlet on a circuit different from that to which the receiver is connected.
-- Consult the dealer or an experienced radio/ TV technician for help.

This device and its antenna(s) must not be co-located or operation in conjunction with any other antenna or transmitter.

Radiation Exposure Statement
The device has been evaluated to meet general RF exposure requirement in portable exposure condition without restriction.

Warranty regulations

The effective warranty period of this product is within one year from the date of sale. Under the condition of normal use and maintenance within the warranty period, the materials and functions of the machine itself have problems and failure. After verification, the company will provide free repair and replacement of the parts.

The warranty of this product does not apply to:
A. The headset has exceeded the warranty period;
B. Break the headset according to the instructions;
C. Remove, repair and change the structure without the authorization of the Company;
D. Unable to provide the warranty card and consumption certificate;
E Product failure or damage caused by force majeure (such as earthquake and fire);
Note: The warranty service does not include the product transportation cost and does not provide door-to-door maintenance service

Warranty feedback form (check)

- A. No sound in the headphones
- B. Poor sound quality
- C. The button cannot operate
- D. Unable to pair the equipment
- E Unable to charge
- F. other _____

User purchase time

The dealer who bought it

When the problem occurred

Contact information of users

This device complies with Part 15 of the FCC Rules. Operation is subject to the following two conditions: (1) this device may not cause harmful interference, and (2) this device must accept any interference received, including interference that may cause undesired operation.

Changes or modifications to this unit not expressly approved by the party responsible for compliance could void the user's authority to operate the equipment.

NOTE: This equipment has been tested and found to comply with the limits for a Class B digital device, pursuant to Part 15 of the FCC Rules. These limits are designed to provide reasonable protection against harmful interference in a residential installation. This equipment generates uses and can radiate radio frequency energy and, if not installed and used in accordance with the instructions, may cause harmful interference to radio communications. However, there is no guarantee that interference will not occur in a particular installation. If this equipment does cause harmful interference to radio or television reception, which can be determined by turning the equipment off and on, the user is encouraged