

1. Product Composition :

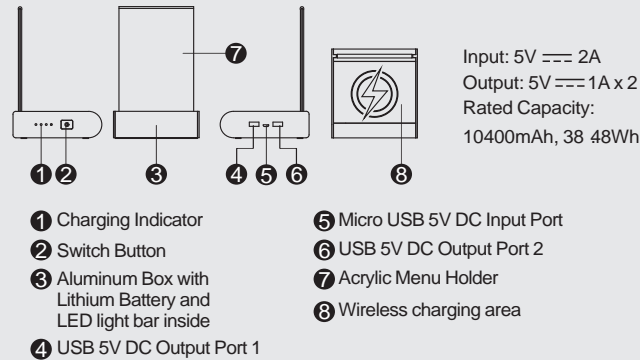

2 Product Setup and Usage Instruction

1) Setup acrylic menu holder :

Insert menu poster into acrylic holder and then insert into the slot of the aluminum box as image showed below.

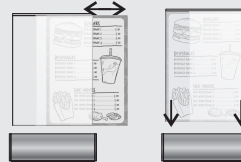

2) Phone charging :

- Turn on the device: Press the switch button once to turn on the power bank, the charging indicator will light up at the same time, and then start to have charging as below.
 - a. Wire charging : Plug the charging cable into USB port 1 or port 2, the phone will be charged immediately.
 - b. Wireless charging : Put the phone with wireless charging function on the charging platform, the phone will be charged immediately.
 - c. Battery charging : Insert the AC to 5V DC adapter into cable plug. Connect AC power and the battery can be recharged immediately. The indicator will blink one by one according to the degree of charge.

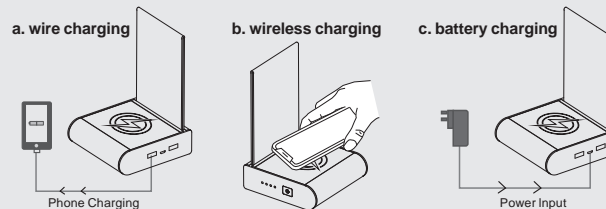

- Turn off the device : Press the switch button twice to turn off the power bank, the charging indicator will light off at the same time.
- Turn on/off led light bar : Long press the switch button for 5 second, the led light bar will be turn on accordingly, and then long press press the switch button for 5 second, the led light bar will be turn off.

Notes and Warnings

- 1) Please charge the battery completely when you use it for the first time before using it.
- 2) Please use the appropriate AC to 5V DC adapter for battery charging and please note that the product cannot be used during battery charging.
- 3) Do not attempt to disassemble the product, replace the battery, to prevent electric shock, fire or chemical burning risk.
- 4) Do not use the product in the outdoors, in wet places, in fire places or in the environment that is too hot/cold, battery charging at temperatures away from range of 0°C ~ 45°C and phone charging away from range of -20°C ~ 60°C, in situation of heavy strike or drop, to prevent device damage or electric shock, fire or chemical burning risk.
- 5) The product provide warranty for one year from the delivery date, but the damage caused by abnormal use is not covered by the warranty.

Wireless Menu Power Bank User Manual

MPBK02-0406S

1. Product Composition :

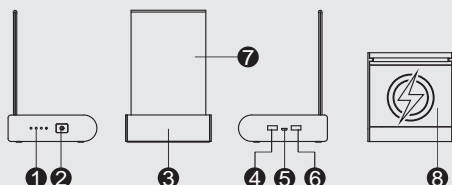

Input: 5V--- 2A
Output: 5V--- 1A x 2
Rated Capacity: 10400mAh, 38.48Wh

- ① Charging Indicator
- ② Switch Button
- ③ Aluminum Box with Lithium Battery and LED light bar inside
- ④ USB 5V DC Output Port 1
- ⑤ Micro USB 5V DC Input Port
- ⑥ USB 5V DC Output Port 2
- ⑦ Acrylic Menu Holder
- ⑧ Wireless charging area

2. Product Setup and Usage Instruction

1) Setup acrylic menu holder :

Insert menu poster into acrylic holder and then insert into the slot of the aluminum box as image showed below.



2) Phone charging :

- Turn on the device: Press the switch button once to turn on the power bank, the charging indicator will light up at the same time, and then start to have charging as below.

- a. Wire charging : Plug the charging cable into USB port 1 or port 2, the phone will be charged immediately.
- b. Wireless charging : Put the phone with wireless charging function on the charging platform, the phone will be charged immediately.
- c. Battery charging : Insert the AC to 5V DC adapter into cable plug. Connect AC power and the battery can be recharged immediately. The indicator will blink one by one according to the degree of charge.

a. wire charging

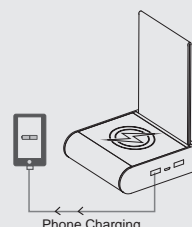

b. wireless charging



c. battery charging

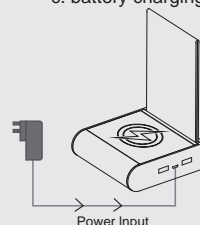

- Turn off the device : Press the switch button twice to turn off the power bank, the charging indicator will light off at the same time.
- Turn on/off led light bar : Long press the switch button for 5 second, the led light bar will be turn on accordingly, and then long press press the switch button for 5 second, the led light bar will be turn off.

Notes and Warnings

- 1) Please charge the battery completely when you use it for the first time before using it.
- 2) Please use the appropriate AC to 5V DC adapter for battery charging and please note that the product cannot be used during battery charging.
- 3) Do not attempt to disassemble the product, replace the battery, to prevent electric shock, fire or chemical burning risk.
- 4) Do not use the product in the outdoors, in wet places, in fire places or in the environment that is too hot/cold, battery charging at temperatures away from range of 0°C ~ 45°C and phone charging away from range of -20°C ~ 60°C, in situation of heavy strike or drop, to prevent device damage or electric shock, fire or chemical burning risk.
- 5) The product provide warranty for one year from the delivery date, but the damage caused by abnormal use is not covered by the warranty.



Wireless Menu Power Bank User Manual

MPBK02-0406S

FCC Statement

Changes or modifications not expressly approved by the party responsible for compliance could void the user's authority to operate the equipment.

This equipment has been tested and found to comply with the limits for a Class B digital device, pursuant to Part 15 of the FCC Rules. These limits are designed to provide reasonable protection against harmful interference in a residential installation. This equipment generates uses and can radiate radio frequency energy and, if not installed and used in accordance with the instructions, may cause harmful interference to radio communications. However, there is no guarantee that interference will not occur in a particular installation. If this equipment does cause harmful interference to radio or television reception, which can be determined by turning the equipment off and on, the user is encouraged to try to correct the interference by one or more of the following measures:

- Reorient or relocate the receiving antenna.
- Increase the separation between the equipment and receiver.
- Connect the equipment into an outlet on a circuit different from that to which the receiver is connected.
- Consult the dealer or an experienced radio/TV technician for help

This device complies with part 15 of the FCC rules. Operation is subject to the following two conditions (1) this device may not cause harmful interference, and (2) this device must accept any interference received, including interference that may cause undesired operation.