

Watercraft

Installing the Battery

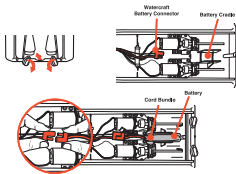

1. Turn the Body Locks as shown and lift up on the tab to remove the body shell.
2. Place the Battery Pack in the Battery Cradle as shown, with the cord bundle at the top of the battery pack and the connector end pointing towards the front of the boat.
3. With thumbs and forefingers, grab the large red connector ends and push them together.
4. Replace the body cover and secure by returning the locks back into their locked position.

ALWAYS Fully Secure the Battery Connector as shown.



Watercraft

Important Safety Feature

This boat is equipped with a safety circuit system which senses water and prevents the propeller from functioning while the boat's hull is out of the water.



CAUTION: Always keep hands away from propeller while battery pack is installed in battery compartment. Always remove the battery pack from the battery compartment before cleaning debris from, clearing or replacing propeller. Always move Transmitter Power Switch to the "OFF" position after use.

For propeller to operate the two water sensors must be submerged in water. To avoid injury lift the boat from the water by holding the sides of the boat. Do not hold the boat from the back near the propeller.

Lift from sides.



Do not lift from rear.



Proper use

Precautions and Care

- Always wash hands off with soap when not in use. Do not breathe fumes.
- Do not operate watercraft where there are water plants, rubbish or other obstacles in the pond.
- Do not fly where there is strong water current or when there is strong wind blowing.
- Do not fly outdoors during thunderstorms.
- Do not operate watercraft in water without top of watercraft attached. Electronics must be covered when in use.
- Be sure to bring the watercraft back to shore (out of water) before the battery power runs out.
- When filling watercraft, be sure to hold the body securely.
- Wipe down with towel after flying.
- Drain watercraft periodically and before storing. Drain watercraft to a dry place. Turn watercraft upside down until all water is drained from the hull. Dry watercraft well before putting it away.

CAUTION!

Do not recharge Battery pack if it is hot or warm to the touch. Allow Battery to cool before recharging. Recharging a hot or warm Battery will shorten the life of the unit. After use the internal boat motors can become hot. Avoid touching the motors. Do not touch propeller while it is spinning. This is extremely dangerous. Do not recharge the Battery if it appears to be damaged or leaking. Do not dispose batteries in fire. Leakage, explosion and personal injury may occur. Do not attempt to disassemble Battery pack or Battery charging case. Only an authorized charge station. Do not attempt jumps or touch with the watercraft. Always remove Batteries from transmitter when not in use. Always remove Battery Pack from Battery Compartment when not in use. Dispose of Lithium-Ion Battery Pack properly.

Support

Troubleshooting

- 50% of all difficulties experienced with radio controlled watercraft are due to either weak batteries or batteries that have been installed incorrectly. When batteries become weak, the watercraft may not necessarily stop completely. However, watercraft may exhibit slow response, slow speed or erratic behavior.
- Problem - Watercraft does not move, moves slowly or moves sporadically.**
 - Make certain the water sensor is making contact with water.
 - Make certain there are fresh alkaline batteries in the Transmitter and watercraft, refer to sync instructions in Transmitter sync-up section.
 - Are the **ON** and **OFF** minus **+** markings on the **+** and **-** batteries in the same position as the **+** and **-** on the battery in the Battery Compartment of the Transmitter?
 - Are the head control tabs touching, rusty or dirty in the Transmitter?
 - Make certain that the Transmitter ON/OFF is under the "OFF" position.
 - Has the battery soft pack been fully charged?
 - Has the battery soft pack been installed in the watercraft?
- Problem - Watercraft exhibits reduced range from the transmitter.**
 - Make certain there is no outside radio interference in your area. The best way to test this is to take the watercraft as far away from radio towers, electrical lines, or Wi-Fi towers as possible. If the watercraft operates correctly in the new area, radio interference was the problem.
- Problem - Propeller does not move.**
 - The watercraft is equipped with a safety sensor. Located on the hull bottom, that prevents the propeller from moving when not in water.
- FCC CAUTION:** Operation or modification not expressly approved by the party responsible for compliance could void the user's warranty and/or void the user's license.
- This device complies with Part 15 of the FCC Rules. Operation is subject to the following two conditions: (1) This device may not cause harmful interference, and (2) this device must accept any interference, including interference that may cause undesired operation.
- NOTE:** The equipment has been tested and found to comply with the limits for Class B digital devices, pursuant to Part 15 of the FCC Rules. These limits are designed to provide reasonable protection against harmful interference in a residential environment. This equipment generates, uses, and can radiate radio frequency energy and, if not installed and used in accordance with the instructions, may cause harmful interference to radio communications. However, there is no guarantee that interference will not occur in a particular installation. If you experience any of the above listed interference problems, you should attempt to correct the interference by using the suggestions of one of the user is encouraged to try to correct the interference by one or more of the following:
 - Reorient or relocate the receiving antenna.
 - Increase the separation between the equipment and receiver.
 - Connect the equipment into a different electrical outlet, which is on a different circuit than the one to which the receiver is connected.
 - Consult the dealer or an experienced radio/TV technician for help.



OWNER'S MANUAL

Please read and understand all precautions prior to use.

Contact Motor Dayz Customer Service at:
 1-800-483-3388
 Monday - Friday
 8:00am to 5:00pm Eastern Time
 Motor Dayz Customer Service
 2001 E. Paradise Trail
 Commerce Township, MI 48390
<http://www.motordayz.com/>

REF10020101218

JN023-20

What's included

Component Checklist

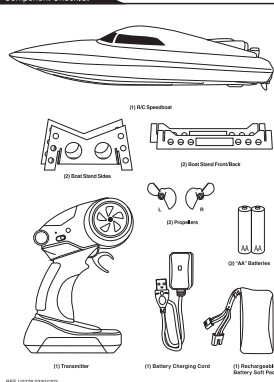

REF: U0279 0226202

Transmitter

Battery Installation

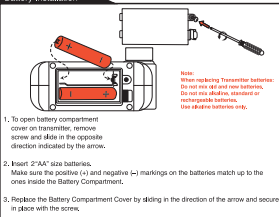

Synching

The transmitter is equipped with 2.4GHz technology which allows up to 8 watercrafts to be used at the same time.

Before first use and after any time the batteries are replaced, the transmitter must be paired to the watercraft.

To sync transmitter and watercraft, follow the steps below:

1. Correctly install the battery in the watercraft.
2. Correctly install batteries in the transmitter.
3. Slide the ON/OFF Switch on the Transmitter to the ON position and pull back on the trigger and hold. The indicator light will flash while pairing with the watercraft. Release trigger when the light stops flashing. The light will stop flashing and remain constant when the sync is complete.

Transmitter

Functions

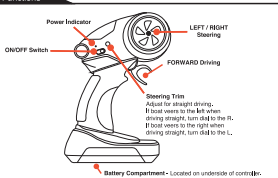

How to Drive

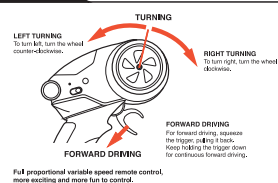

Watercraft

Features

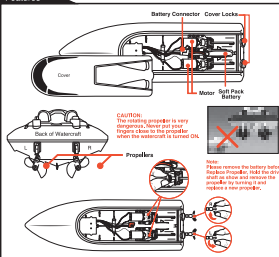

Assemble the Stand

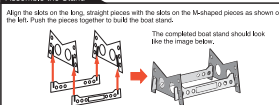

Watercraft

Charging the Battery

