

101K数码相框说明书

尺寸：105*143mm

材质：封面200g铜版纸彩色印刷

内页80g书纸黑白印刷



Digital Picture Frame

User Manual



101K

We provide 12 MONTHS warranty from the date of purchase, if you experience any problem not covered by FAQ, please don't hesitate to email us.

English user Manual	Page 01-12
Manual del usuario en español	Page 13-24

Table of Contents

FCC Warning Statement	01
ISED Warning Statement	02
Security Instructions	03
Packing and List	03
Frame Features	04
Getting Started	05
Photo management	07
User management	08
Video tutorials	08
Functional Overview.....	09
Frameo+	11
FAQ	12
Warranty	12

FCC Warning Statement

FCC Statement

This equipment has been tested and found to comply with the limits for a Class B digital device, pursuant to part 15 of the FCC Rules. These limits are designed to provide reasonable protection against harmful interference in a residential installation. This equipment generates, uses and can radiate radio frequency energy and, if not installed and used in accordance with the instructions, may cause harmful interference to radio communications. However, there is no guarantee that interference will not occur in a particular installation. If this equipment does cause harmful interference to radio or television reception, which can be determined by turning the equipment off and on, the user is encouraged to try to correct the interference by one or more of the following measures:

- Reorient or relocate the receiving antenna.
- Increase the separation between the equipment and receiver.
- Connect the equipment into an outlet on a circuit different from that to which the receiver is connected.
- Consult the dealer or an experienced radio/TV technician for help.

Caution: Any changes or modifications to this device not explicitly approved by manufacturer could void your authority to operate this equipment.

This device complies with part 15 of the FCC Rules. Operation is subject to the following two conditions: (1) This device may not cause harmful interference, and (2) this device must accept any interference received, including interference that may cause undesired operation.

RF Exposure Information

This equipment complies with FCC radiation exposure limits set forth for an uncontrolled environment. This equipment should be installed and operated with minimum distance 20cm between the radiator and your body.

FCC ID: 2ATFT-101K

ISED Warning Statement

ISED Statement

English: This device contains licence-exempt transmitter(s)/receiver(s) that comply with Innovation, Science and Economic Development Canada's licence-exempt RSS(s). Operation is subject to the following two conditions:

- (1) This device may not cause interference.
- (2) This device must accept any interference, including interference that may cause undesired operation of the device.

The digital apparatus complies with Canadian CAN ICES-3 (B)/NMB-3(B).

French: Cet appareil contient des émetteurs/récepteurs exempts de licence qui sont conformes aux RSS exemptés de licence d'Innovation, Sciences et Développement économique Canada.

L'exploitation est soumise aux deux conditions suivantes :

- (1) Cet appareil ne doit pas provoquer d'interférences.
 - (2) Cet appareil doit accepter toute interférence, y compris les interférences susceptibles de provoquer un fonctionnement indésirable de l'appareil.
- l'appareil numérique du ciem conforme canadien peut-3 (b) / nmb-3 (b).

This device meets the exemption from the routine evaluation limits in section 2.5 of RSS 102 and compliance with RSS 102 RF exposure, users can obtain Canadian information on RF exposure and compliance.

cet appareil est conforme à l'exemption des limites d'évaluation courante dans la section 2.5 du cnr - 102 et conformité avec rss 102 de l'exposition aux rf, les utilisateurs peuvent obtenir des données canadiennes sur l'exposition aux champs rf et la conformité.

This equipment complies with Canada radiation exposure limits set forth for an uncontrolled environment.

Cet équipement est conforme aux limites d'exposition aux rayonnements du Canada établies pour un environnement non contrôlé.

This equipment should be installed and operated with minimum distance 20cm between the radiator & your body.

Cet équipement doit être installé et utilisé à une distance minimale de 20 cm entre le radiateur et votre corps.

Security Instructions

1. The digital frame has a capacitive touch screen, which can be operated by touching it with your finger or by clicking it with a capacitive pen. Do not use sharp objects to click the screen.
2. Avoid placing the digital frame in high-temperature, high-humidity, or dusty areas.
3. To prevent violent impact between the display and the capacitive touch screen, do not drop or crash the digital frame.
4. Use only the charger adapter that comes with the digital frame. Using a different type of charger may cause the digital frame to burn.
5. Do not disconnect the digital frame while formatting it. This may result in an error, and our company will not bear the responsibility for memory loss due to damage, repair, or any other reason. Please refer to the user manual for proper operation and back up important data in time.
6. Do not attempt to dismantle the digital frame yourself, and avoid polishing it with alcohol, dilution, or benzene.
7. The digital frame's Type-C port is for transferring photos or videos, but not for charging the device.
8. A virus can damage the digital frame. Please use proper antivirus software on your computer and keep it updated.
9. If you need support for the digital frame, please email us at: 101k-frameo@eitack.com

Packing and List

Please make sure the following items are included in the package.

If any item is damaged or missing, contact us anytime to get a new one for free.

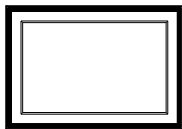

Digital Picture Frame

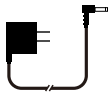

DC Adapter



Stand



Screw



User Manual

Frame Features

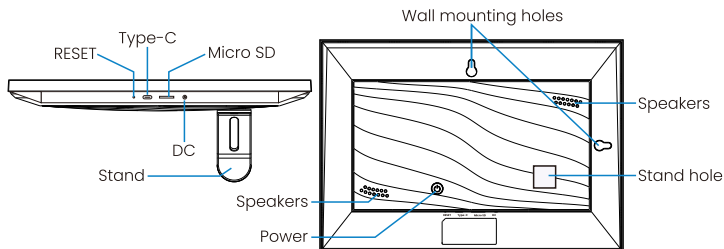

Power	After connecting power adapter, the unit will power on automatically for the first time. When it is on, press and hold power button for approximately 3 seconds to access reboot or power off menu. Short press on power button with turn off/on screen.
Wall mounting holes	To mount the frame on the wall, use the screws provided with the product. The frame can be mounted either in portrait or landscape orientation.
Speakers	
RESET	Use a needle or paper clip to reset unit.
Type-C	<p>1. Connecting with a USB-C to USB-C cable or a USB-A to USB-C cable, you can import photos/videos from your computer to the digital frame.</p> <p>2. Connecting with a USB disk via an OTG cable can import photos/videos from the USB disk.</p> <p>Note:</p> <p>① The OTG cable, USB-C to USB-C cable, or USB A to USB-C cable is not included in the package, you need to purchase additional cables.</p> <p>② The Type-C port is only for data transferring, not for charging.</p>
Micro SD	The digital picture frame supports a Micro SD card. You can insert a micro SD card into the frame and import photos to the digital frame. They can also copy photos from the digital frame to the micro SD card, but cannot play back photos directly from the micro SD card.
DC	Connect DC adapter to power on the device.
Stand hole	Please use the stand to insert into the stand hole, you can stand it horizontally or vertically.

Getting Started

① Install the stand

Aim at the bracket hole on the back of the frame to plug the stand into it, the stand will be firmly connected it! You can place the frame either in landscape or portrait orientation. For the initial setup, we recommend placing it in landscape mode. Alternatively, you can mount the frame on the wall using the Wall Mount Hole on the back.

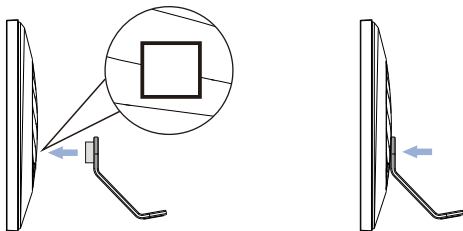

② Power on

Connect the power cable to your frame and plug the power adapter into the wall socket, the frame will enter the system in seconds.

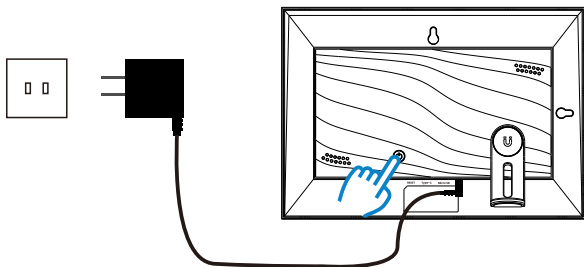

③ Initial settings

There are several initial settings (Language, Wi-Fi, Device info, Sleep Mode, etc.) when you enter the system for the first time.

④Connect to Wi-Fi

Select the Wi-Fi network you would like to connect to and enter the password if required. If your Wi-Fi network is not on the list, move your frame closer to your router, wait for seconds, and check it again.

⑤Download "Frameo" App

Download the "Frameo" App on iOS or Android and send photos to your digital frame.



Scan code to find the App





Android



iOS

⑥Navigating your frame

- You interact with your frame through its touchscreen.
- Swipe left or right to go through your photos.
- To access the menu bar, simply tap once on the screen, this will show the menu.
- In the menu bar you will find quick access to the add friends dialog  and the settings menu .



⑦Connecting a new friend

- Make sure that your friend has downloaded and installed "Frameo" App.
- Click the add friend icon  on your frame. A dialog will appear showing a unique code that is valid for 24 hours.
- Now share this code in whatever fashion you prefer e.g. SMS, Email, IM, or phone call to your friend.
- After connecting the frame to your friends' "Frameo" app, they will automatically appear on your Frameo digital frame and be able to share photos with you.

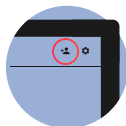

⑧Share photos/videos to digital frame

Two ways to transfer photos to the frame:

- Share photos/videos to digital frame via "Frameo" App;
- Import photos/videos to digital frame via micro SD card.

Photo management

①Memory usage

The Manage Photo section shows you the number of photos stored in the frame and the storage space occupied/remained.

②Show/Hide photos

Select the photo you want to hide by tapping the photo. Hidden photos will not be deleted from the frame and can be re-displayed at any time.

③Delete photos

Select the photos you want to permanently delete from your frame by tapping the photo.

Use  to select the photos you want to permanently delete from your frame and  to delete the selected photos.

④Import photos

Allows you to import photos from a micro SD card.

—How to import photos to your frame?

1. Insert a micro SD card into your digital frame.
2. Select the photos you want to import into the photo frame.
3. Tap on the import button to start the import process.

Once the import process is complete, your selected photos will be available for display on your digital picture frame.

⑤Export photos

Allows you to export photos from the digital frame to a micro SD card.

—How to export photos from your frame to a micro SD card?

1. Select the photo you want to export from the photo frame.
2. Tap the export button to start the export process.

Once the export process is complete, the selected photo will be saved onto the micro SD card, allowing you to transfer it to other devices or store it as a backup.

User management

①Manage account

The "Manage account" feature on the digital frame contains a list of all connected accounts that are authorized to send photos to your device. This allows you to easily view and manage which accounts have access to your Frameo digital picture frame.

②Account Setting

- Remove an account: Once an account is removed from your frame, it will no longer be able to share photos with your photo frame.
- Delete shared photos: You can delete all photos that were shared by a specific account.
- Delete the account (without deleting the shared photos): This option allows you to remove an account from the list without deleting any of the photos that were shared by that account.

Video tutorials

Check out our "Frameo Tutorials" playlist on YouTube with informative videos where we guide you on how to get started using Frameo. Scan the code to the right or use the link to find the playlist.

If you have any questions, you can either scan the QR code to watch the video or reach out to us for assistance. Thank you very much.



Functional Overview

Transfer Photos/Videos via APP or Micro SD Card	✓ (There is no time limit for the video uploads via SD card; Free Frameo app allows uploading only 15-second videos.)
IPS HD Touch Screen	✓
1280*800 Pixel	✓
Support Micro SD Card	✓
Multi User Connections	✓
Fit to frame/Fill frame	✓ (This toggles how the photo is shown. The Fill frame option is the default. The photo is scaled so that it fills the whole screen. Fit to frame will make sure that the entire photo is shown on the screen.)
Adjust Photos	✓ (Allows you to adjust the position of the photo in the frame for an even better fit.)
Auto-rotate	✓
Desk/Wall Mounted	✓
Frame Name	✓
Frame Location	✓
Set Languages	✓
Set Time Zone	✓
Show/Hide Photos	✓
Delete Photos	✓
Import/Export Photos/Videos via Micro SD Card	✓
Brightness Adjustment	✓
Sleep Mode	✓ (Default setting 23:00-07:00, Customizable settings based on personal schedule)
Timer	✓ (Define the duration a photo should be displayed)
12/24 Hour Format	✓
Show Caption	✓ (Record the story of each photo, can display or hide subtitles)

Clock and Weather Widgets	✓
Slideshow	✓
Sound Adjustment	✓
Interacting with videos	✓ (When a video is shown, two additional controls are shown. One for play/pause of the video and one to control the volume level for video sounds.)
React Interaction	✓ (Tap one of the reactions to let the sender know how it made you feel.)
Automatic Backup	✓(Backup the content of the photo frame to the micro SD card)
Reset Frame	✓
Software Update	✓ (Frameo software will be continuously updated to introduce new features to meet customer needs.)
Privacy	✓ (For more information regarding privacy, please visit http://privacy.frameo.net)

Frameo+

To meet the needs of a small segment of customers, Frameo company has launched Frameo+, which adds four features to the original free Frameo.



See frame photos

See photos from your own or a friend's frame in the Frameo app.



Cloud backup

Keep your precious photos and videos safely backed up in the cloud.



Send more photos

Send up to 100 photos at a time.



Send longer videos

Send videos up to 2 minutes long via Frameo APP.

Upgrading to Frameo+ requires a paid membership. If you do not need the enhanced features of Frameo+, you can continue to use the free version of Frameo without any cost.

NOTE: The Frameo app is still available for free download. Only when you need to upgrade to the Frameo+ version, you need to pay for the Frameo+ membership.

FAQ

1. Is the frame install a battery?

Answer: No, this photo frame without a battery, it can only work by supporting an adapter.

2. Why can't I power on when I plug in the adapter and press the power button?

Answer: You need to confirm whether the adapter is plugged in, and also check whether the power supply is normal.

3. What kind of app should I download for the photo frame?

Answer: To send photos to your frame, use the frameo app for iOS or Android.

Find the frameo app on: Google play by searching for "frameo" or App Store by searching for "frameo".

4. Can this digital frame operate with a 220V outlet?

Answer: Yes, this digital frame operate with 110-220V outlet.

5. Can I send photos to the frame by mail?

Answer: No!

Way one: transfer photos to digital frame via "Frameo" App;

way two: import photos to digital frame via micro SD card.

6. Can I transfer photos from my computer to the frame?

Answer: You can transfer the photos on the computer to the micro SD card, and then insert the micro SD card into the photo frame to import the photos to the frame.

7. Are my photo transfers safe?

Answer: Absolutely safe! The frameo digital frames are authorized genuinely by "Frameo" App company, SO there is no need to worry about photos and videos being leaked.

For more information regarding privacy, please visit <http://privacy.frameo.net>

Warranty

* If there is a malfunction of the machine or damage to any part of the machine, stop using it and consult a licensed electrician for repairs.

* Do not attempt to modify or repair the machine yourself. If you have any problem with the product, please don't hesitate to email us at: **101k-frameo@eitack.com**

We will reply to you within 24 hours and give you the best solution. Thank you!