

Lenovo Bluetooth In-ear Headphones

https://support.lenovo.com

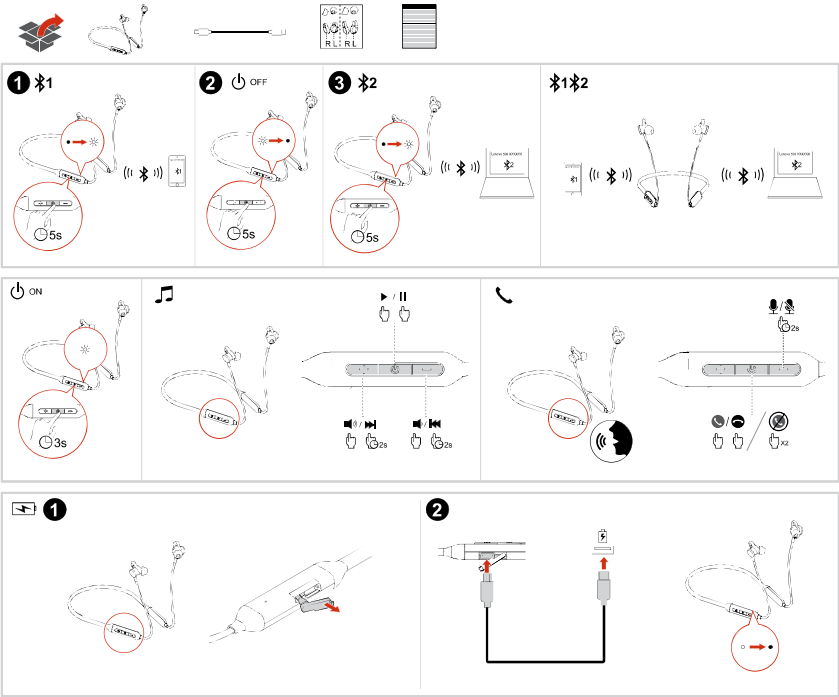

Lenovo



**Quick Start**

**Unboxing:**

- Remove the headphones from the retail box.
- Remove the headphones from the retail box.
- Remove the headphones from the retail box.

**Charging:**

- Connect the charging cable to the charging port on the back of the headphones.
- Connect the other end of the charging cable to a power source.
- Charge the headphones for at least 2 hours before use.

**Pairing:**

- Press and hold the power button for 5 seconds to turn on the headphones.
- Press and hold the power button for 5 seconds to turn on the headphones.
- Press and hold the power button for 5 seconds to turn on the headphones.

**Usage:**

- Press the power button to turn on the headphones.
- Press the power button to turn on the headphones.
- Press the power button to turn on the headphones.

**Storage:**

- Store the headphones in the carrying case when not in use.
- Store the headphones in the carrying case when not in use.
- Store the headphones in the carrying case when not in use.

**Warranty:**

- Lenovo provides a limited warranty for this product.
- Lenovo provides a limited warranty for this product.
- Lenovo provides a limited warranty for this product.

**Support:**

- Visit the Lenovo support website for more information.
- Visit the Lenovo support website for more information.
- Visit the Lenovo support website for more information.

**Notes:**

- Do not use the headphones near fire or open flames.
- Do not use the headphones near fire or open flames.
- Do not use the headphones near fire or open flames.