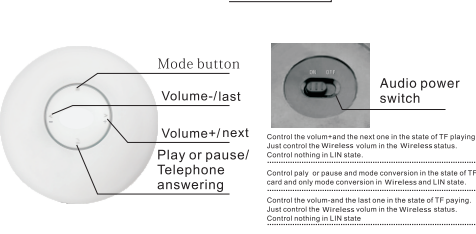

4、Products parameter

| Products parameter | |
|-----------------------------|-------------------------------------|
| Product size: 102*130*36 mm | GN5 5050 |
| Power: 32.7W | Security: 8008+290 |
| Cash: 94% | Working time: 4 hours |
| Speaker: 40mm X 40mm | Frequency: 20K-2000K |
| Battery: as model | Input mode: Wireless, AUX, USB, USB |

BT-118
user manual

Freshly crafted and attractive appearance
 being from excellent design, or pushing
 processing, delicate design, compact and
 convenient, concise features, simple
 operation, unique packaging... fashion
 science and technology.

Functions highly integrated
In addition to wireless, Wireless (the function of BT-155 has been highly integrated. Then the answering phones, inquiry time, TF card player, AEC input, highlight indication, touch control functions that makes it more practical fashion.

In addition to wireless wireless, the function of BT-118 has been highly integrated. Thanks to answering phones, enquiry line, TF card player, A/D input, nightlight, induction, touch control functions that makes it more practical function.

Not cumbersome connections BT-118 is hand, just use the integrated wireless device search for BT-118 and pair connection to play to make your life of wireless music more convenient



Note: This equipment has been tested and found to comply with the limits for a Class B digital device, pursuant to part 15 of the FCC rules. These limits are designed to provide reasonable protection against harmful interference in a residential installation. This equipment generates, uses, and can radiate radio frequency energy and, if not installed and used in accordance with the instructions, may cause harmful interference to radio communications. However, there is no guarantee that interference will not occur in a particular installation. If this equipment does cause harmful interference to radio or television reception, which can be determined by turning the equipment off or on, the user is encouraged to try to correct the interference by one or more of the following measures:

- Reorient or relocate the receiving antenna.
- Increase the separation between the equipment and receiver.
- Connect the equipment into an outlet on a circuit different from that to which the receiver is connected.
- Consult the dealer or an experienced radio/TV technician for help.

Note: This equipment has been tested and found to comply with the limits for a Class B digital device, pursuant to part 15 of the FCC rules. These limits are designed to provide reasonable protection against harmful interference in a residential installation. This equipment generates, uses, and can radiate radio frequency energy and, if not installed and used in accordance with the instructions, may cause harmful interference to radio communications. However, there is no guarantee that interference will not occur in a particular installation. If this equipment does cause harmful interference to radio or television reception, which can be determined by turning the equipment off or on, the user is encouraged to try to correct the interference by one or more of the following measures:

- Reorient or relocate the receiving antenna.
- Increase the separation between the equipment and receiver.
- Connect the equipment into an outlet on a circuit different from that to which the receiver is connected.
- Consult the dealer or an experienced radio/TV technician for help.