

# 360 Photobooth Product User Guide (V2.2)



# Catalogue

I	Attention	1
II	Component Introduction	2
III	Installation guide	4
IV	Operation Instructions	8

## 1.Attention

1.Before using, please check whether the power cord, base LED Strip cord and other items are stuck on the rotating table or not, to prevent the cables from being damaged.

2.For users safety, don't jump hard on the Stage.

3.Don't make the edge of the Stage bear too much weight, better distribute the weight evenly on the stage.

4.The Stage should be adjusted paralleled to the ground by rotating the foot cup before using.

5.Do not stop the rotating rod deliberately when it was running.

6.Do not put heavy objects on the Angle Adjuster and Selfie Telescopic Rod.

7.Children should not use it alone, but must be accompanied by an adult.

## 2.Component Introduction

The attachments received are subject to



Tablet Holder



Mobile Photo Holder



Metal Bracket



Remote Control



5V Adapter (for LED Strip)



Remote Shooting



Fixed Bracket



Ring Light



Foot Cup For Base



Portable Bag



Trolley



Wheel



Fixing Screw



Angle Adjuster



Selfie Telescopic Rod



Motor Controller



LED Strip Remote Control



LED Strip



Wrench



AC-DC Adapter



Universal Holder



Accessories Handbag



LOGO Sticker



Mask

# 3.Installation Guide

Step1: Take the Stage out of the package and adjust it parallel to the ground with the Foot Cups. Then connect the AC-DC adapter to the control box.

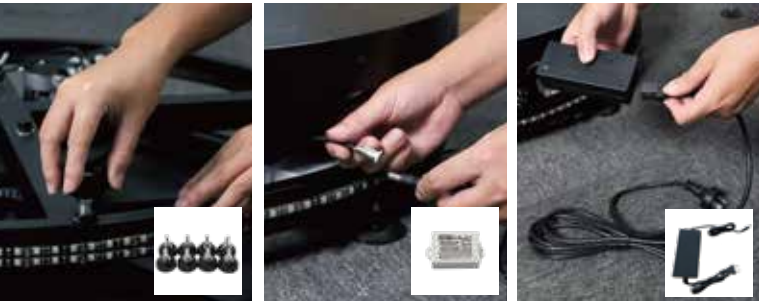

Step 1 Scan it

Step 2: Install the Angle Adjuster, and lock it with Fixed Screw.

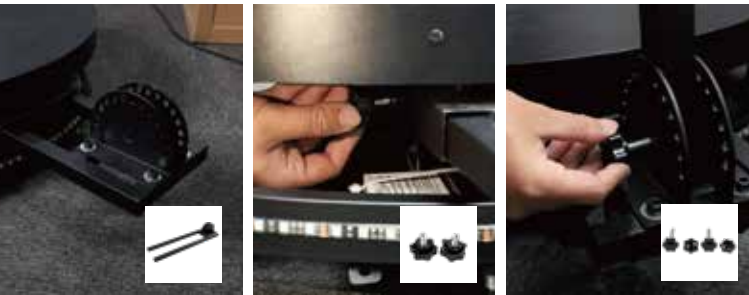

Step 2 Scan it

Step 3: Install the Selfie Telescopic Rod.



Step 3 Scan it

Step 4: Stick the LED Strip to the base and connect it to 5V Adapter (for LED Strip).



Step 4 Scan it

Step 5: Install Ring Light.

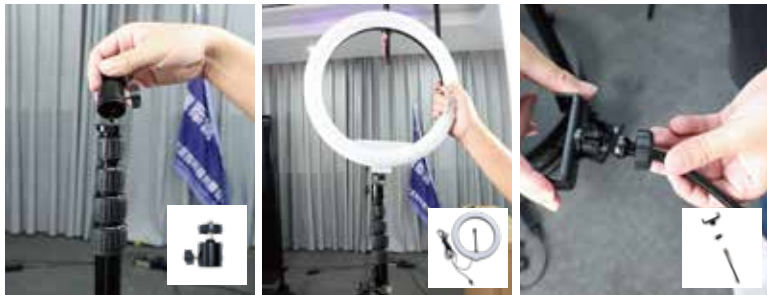

Step 5 Scan it

Step 6: : Install Fixed Bracket and Phone Holders.

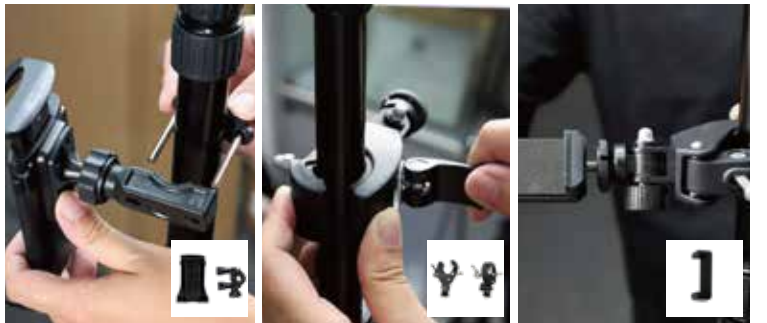

Step 6 Scan it



Step7: Power bank, lithium battery connection and usage(**Power Bank and lithium battery are not our standard accessories**). The Ring Light should connect with USB port of the power bank. The motor controller should connect with the lithium battery s DC 24V power port. And the LED strip should connect with the lithium battery s DC 5V USB port.



- ①Lithium Battery.
- ②Power switch of the Battery.
- ③DC 12V output port.
- ④DC 24V output port. Supply the photo booth power with this port connection. Also this is the Lithium Battery charging port.
- ⑤5V USB port, connected with the LED Strip.
- ⑥Motor Controller.



Normal Light



Warm Light



Cold Light

- ①Ring Light USB connection with Power Bank.
- ②Brightness Increase Button.
- ③Brightness Decrease button.
- ④Temperature Switch.
- ⑤Power Button.

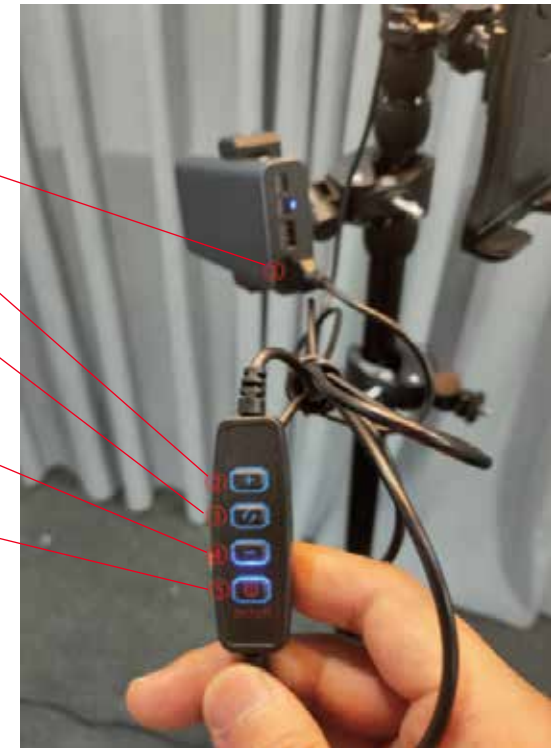

## 4.Operation Instructions

Install suitable batteries for all remote controls(**CR-2032**).  
Power up the AC-DC adapter.

Plug the two USB(Ring Light& LED Strip) into the power bank and 5V adapter.

### Remote Control Instructions

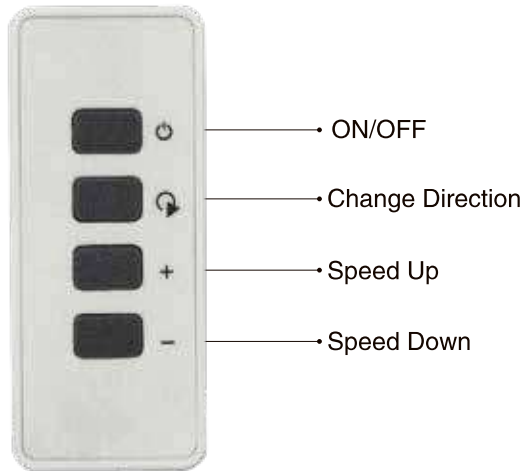

### Lightband Controller Instructions

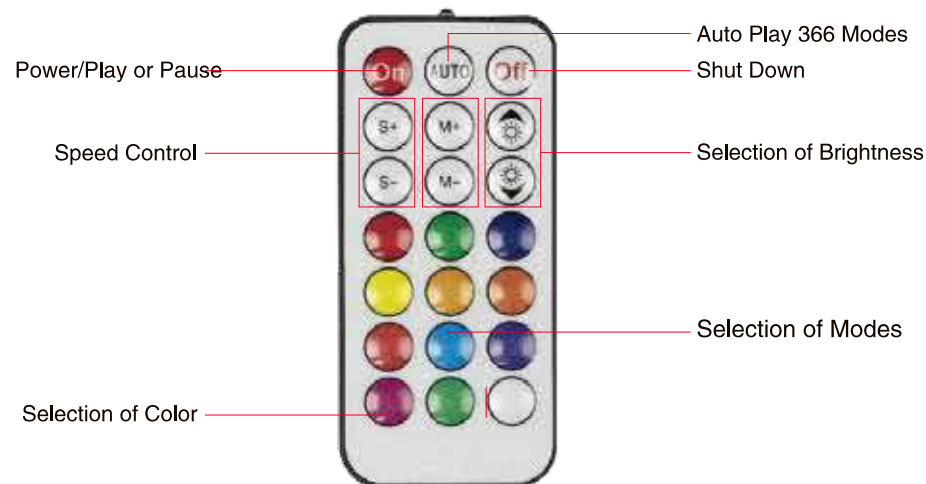

### **FCC Statement**

This equipment has been tested and found to comply with the limits for a Class B digital device, pursuant to part 15 of the FCC rules. These limits are designed to provide reasonable protection against harmful interference in a residential installation. This equipment generates, uses and can radiate radio frequency energy and, if not installed and used in accordance with the instructions, may cause harmful interference to radio communications. However, there is no guarantee that interference will not occur in a particular installation. If this equipment does cause harmful interference to radio or television reception, which can be determined by turning the equipment off and on, the user is encouraged to try to correct the interference by one or more of the following measures:

- Reorient or relocate the receiving antenna.
- Increase the separation between the equipment and receiver.
- Connect the equipment into an outlet on a circuit different from that to which the receiver is connected.
- Consult the dealer or an experienced radio/TV technician for help.

To assure continued compliance, any changes or modifications not expressly approved by the party.

Responsible for compliance could void the user's authority to operate this equipment. (Example- use only shielded interface cables when connecting to computer or peripheral devices).

This equipment complies with Part 15 of the FCC Rules. Operation is subject to the following two conditions:

- (1) This device may not cause harmful interference, and
- (2) This device must accept any interference received, including interference that may cause undesired operation.

RF warning statement:

The device has been evaluated to meet general RF exposure requirement.  
The device can be used in portable exposure condition without restriction.