

215 mm

140 mm

# Bobtot



## Quick Setup Guide K38

### 5.1 CHANNEL HOME THEATER SYSTEM



Scan the QR code to access how-to videos, the user's manual, and other important information you may need to get the most of your item

Like our product?  
Share your experience with our customers on your page!

Having troubles?  
Contact us: [service@bobot.net](mailto:service@bobot.net)

<b>What's in the box</b>	
*Subwoofer	1PC
*Satellite Speakers(Center & FL & FR & SL & SR)	5PCS
*3.5mm to RCA Audio Stereo Cable	1PC
*TV ARC Cable	1PC
*Optical Audio Cable	1PC
*Remote Control	1PC
*FM Antenna Cable	1PC
*User Manual	1PC
*Mounting Brackets and Screws	1SET

### IMPORTANT SAFETY INSTRUCTIONS



**TO REDUCE THE RISK OF ELECTRICAL SHOCK, DO NOT REMOVE AMPLIFIER PLATE. NO USER SERVICEABLE PARTS INSIDE. WE RECOMMEND TAKING THE UNIT TO A QUALIFIED SERVICE TECHNICIAN FOR ANY REPAIRS.**

Read the following safety instructions before operating your home theater system.

- Do not place these speakers on an unstable surface. The speaker may fall over, causing serious injury to a child or adult and serious damage to the unit.
- Do not use these speakers near water or expose them to rain or moisture.
- The speakers should be situated away from heat sources such as radiators, heat registers, stoves, or other devices that produce heat.
- To reduce the risk of electric shock or component damage, unplugged the power before moving your speakers or connecting other components to your device.
- Clean only with a soft dry cloth. Unplug the main unit from the wall outlet before cleaning.

**CAUTION:** Always use a power outlet that is properly grounded.

2

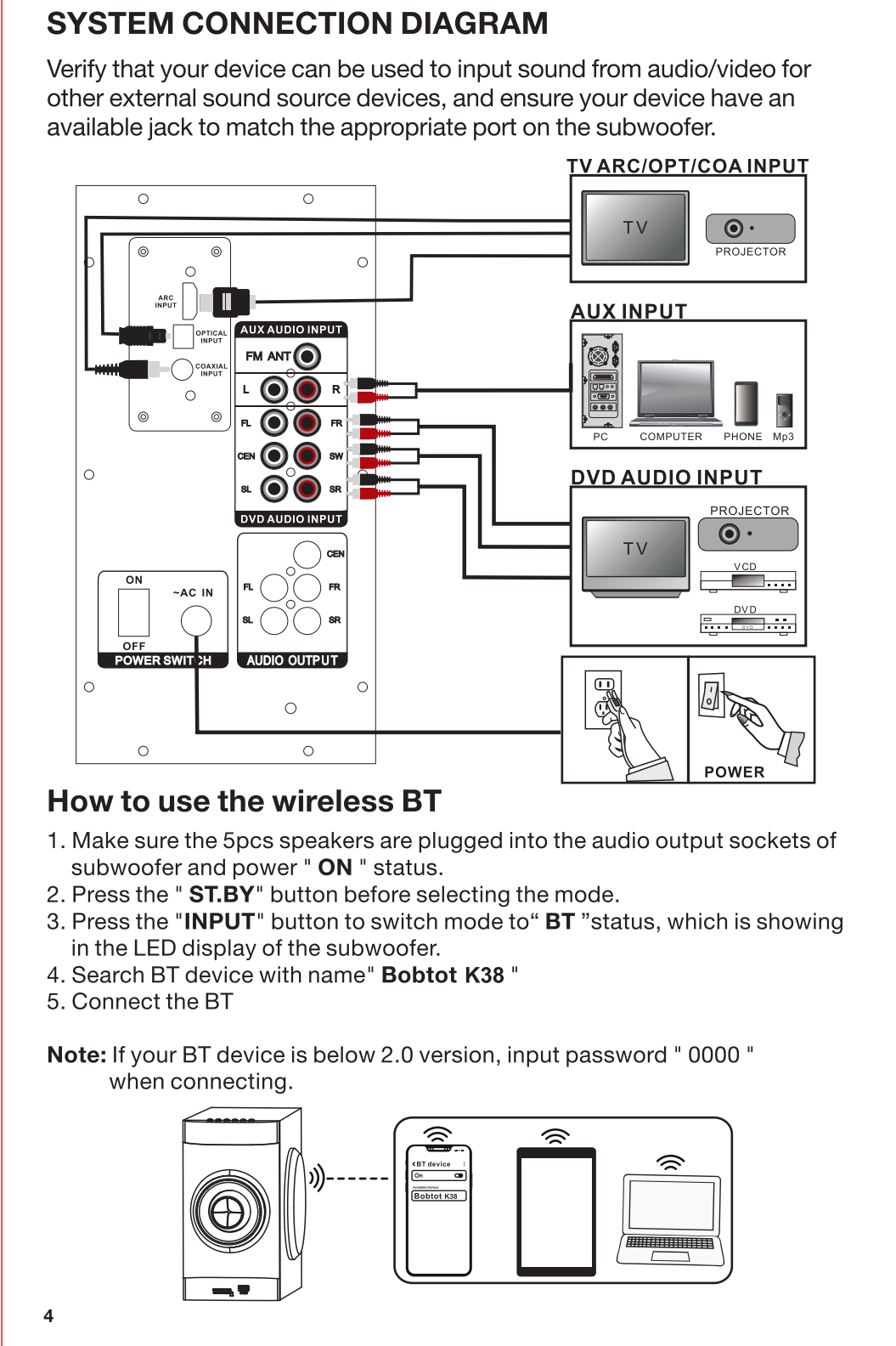
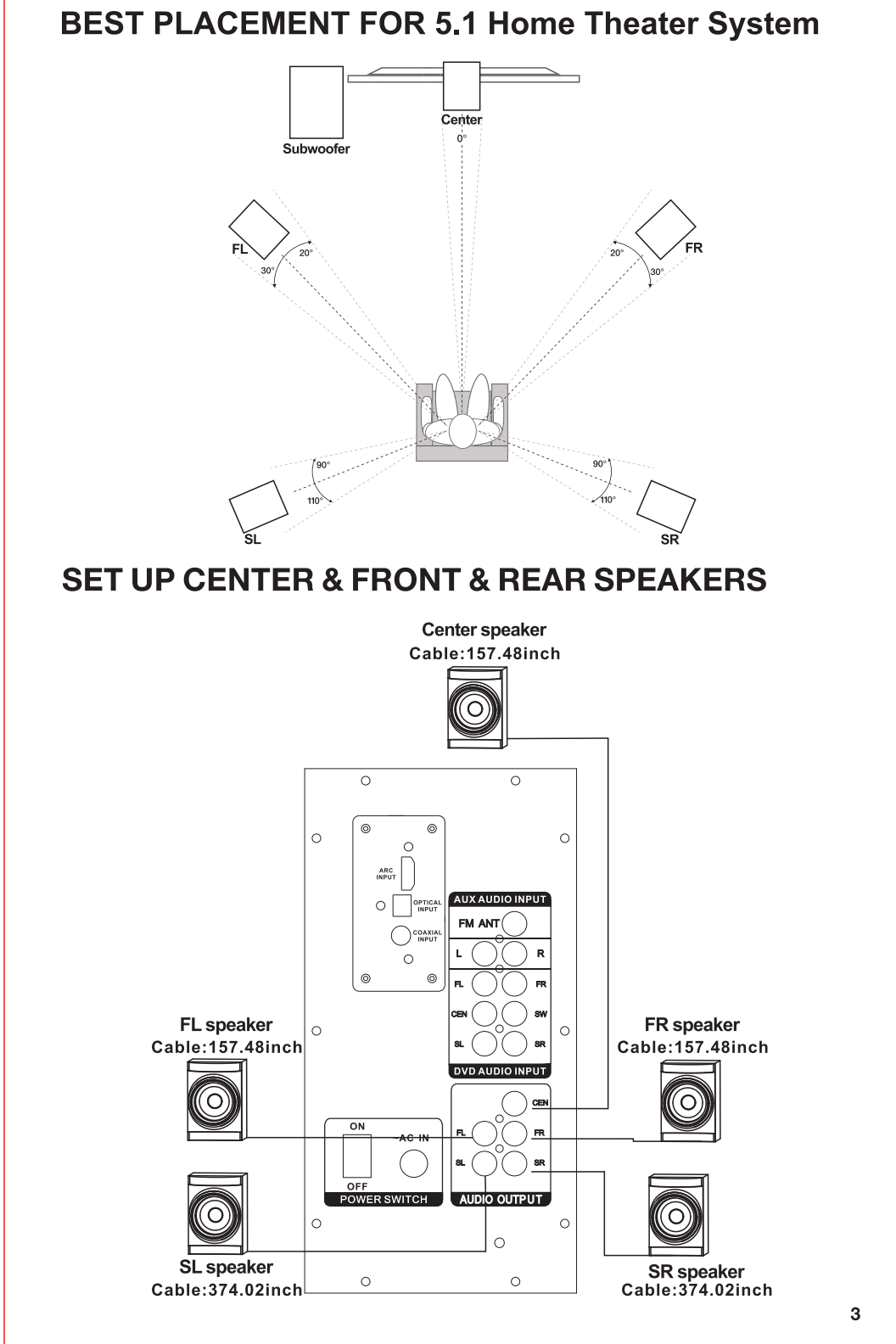

**FRONT PANEL OF SUBWOOFER**

**ST.BY:** Press to start this sytem.

**INPUT:** Switch from BT/TV-ARC/COA/ DVD/FM/USB/AUX mode.

**5.1/2.1:** Switch from 5.1 surround and 2.1 mode.

**AUTO/HL:** Press to play/pause when BT/ USB/SD mode.  
Press to automatic search and save when in FM mode.

**CH-/|◀:** Press to previous song when BT/ USB/SD mode.  
Press to previous channel when in FM mode.

**CH/▶/|:** Press to next song when BT/USB/SD mode.  
Press to next channel when in FM mode.

**LED Display**

**Volume +/Volume -:** Turn the knob to decrease or increase the volume.

**U DISK:** USB socket ( Max file 64G )

**SD/MMC CARD:** SD socket ( Max file 64G)

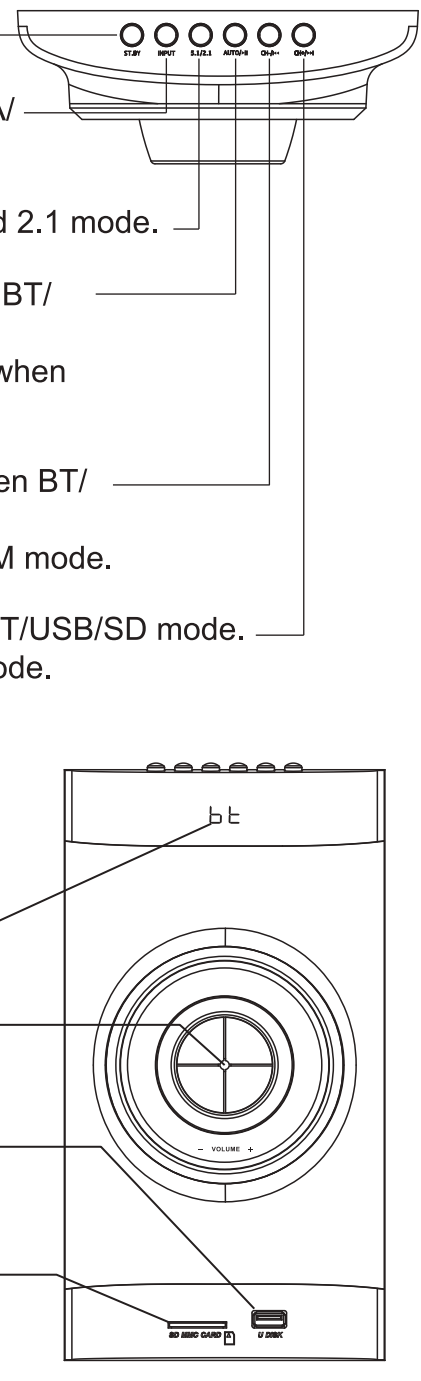

5

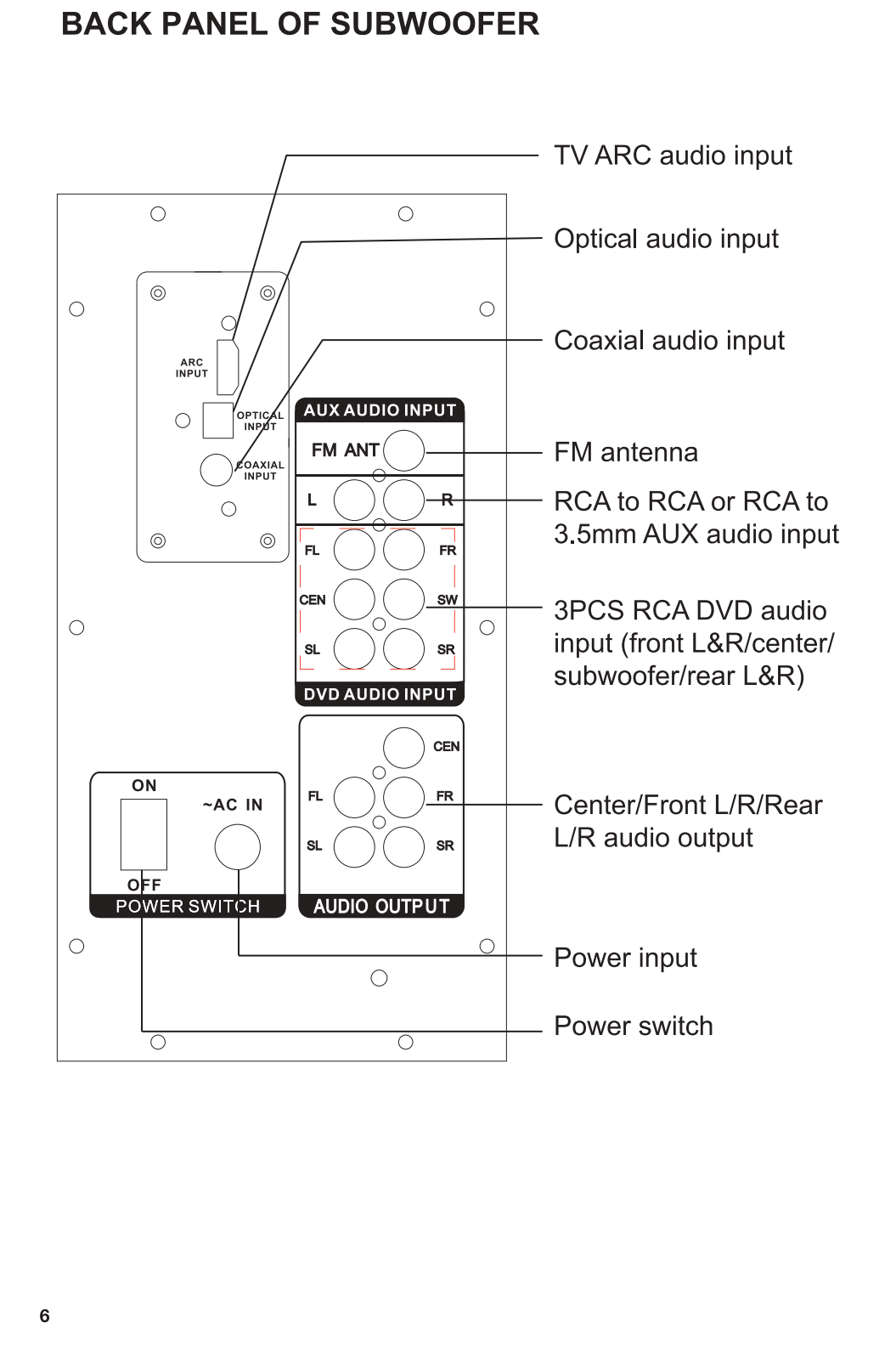

**MOUNTING INSTRUCTIONS**

Mounting brackets and screws (included)  
Speaker cable (built-in, included)  
Wall hooks (not included)  
Screwdriver (not included)

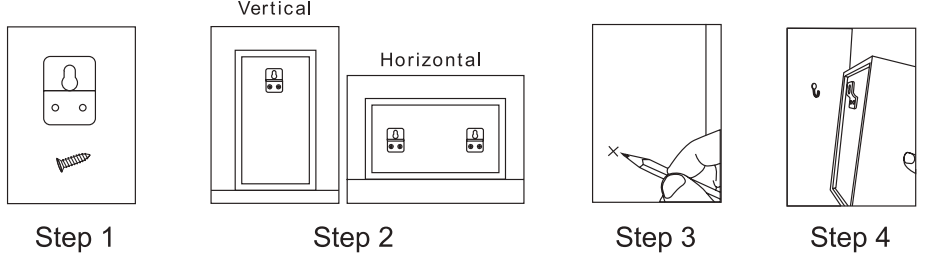

**SPECIFICATIONS**

Input voltage: AC 100-240V~50/60Hz

Frequenc yresponse: 20Hz~20KHz

System impedance: 4"; 4 Ohm / 2.75"driver: 8 Ohm

Signal to noise ratio:≥70dB

Subwoofer dimensions: W140 xH258 x D313mm

Center satellite speaker dimensions:W90xH130xD95mm

Front L/R satellite speaker dimensions: W90xH130xD95mm

Rear L/R satellite speaker dimensions: W90xH130xD95mm

Cable length:Front L/R:157.48inch, Rear L/R:374.02inch, Center: 157.48inch

Net weight: 12.98lb(5.89 Kg)

7

**REMOTE CONTROL FUNCTIONS**

: Power/Standby

**MUTE:** Press "MUTE" to mute all output.

**BT:** Press "BT" to use BT input mode. The LED Display will blink while searching for a BT device, pair with "Bobtot K38" in your mobile device BT menu.

**ARC/OPT/COA/DVD/AUX/USB/SD/FM:** Press the corresponding mode on the remote control to enter directly.

**5.1/2.1:** Press "5.1/2.1" to change from 2.1 to 5.1 surround sound.

**SLEEP +/-:** Set the sleep time.

**SAVE:** Press "SAVE" to save FM channels for memory.

**TUNE +/-:** Tuning the FM channels

**◀/▶:** In BT/USB/SD mode, press to play the previous song.

**CH:** In FM mode, press to go to the previous radio station channel.

**▶/▶:** Short Press to play/pause in BT/USB/SD mode.

**AUTO:** Long press to search for the FM channels automatically/ stop to search for the FM channels in FM mode

**▶/▶:** In BT/USB/SD mode, press to play the previous song.

**CH+:** In FM mode, press to go to the next radio station channel.

**FRONT:** Press "FRONT" to select the front speakers, the output level can be adjusted by using the "VOL +/-" buttons.

**CENT:** Press "CENT" to select the center speakers, the output level can be adjusted by using the "VOL +/-" buttons.

**REAR:** Press "REAR" to select the rear satellite speakers, the output level can be adjusted by using the "VOL +/-" buttons.

**SUBWOOFER:** Press "SUB" to select the subwoofer, the output level can be adjusted by using the "VOL +/-" buttons.

**VOL +/-:** Adjust the main volume.

**EQ +/-:** In BT/USB/SD mode, they will allow you to navigate the 5 preset EQ curves.

**DISP +/-:** They will to adjust the LED display brightness showing in the front of subwoofer.

**0-9 NUMBER:** In USB/SD mode, press the number buttons to select the desired track. In FM mode, press the number buttons to select the desired radio station.

**REPEAT:** Press to single loop (music)/repeat all songs/random playback in BT/USB/SD mode.

**RESET:** Press to default state.

**NOTE:**

1. Turn on the unit, please press the "Power" button before selecting the input mode.
2. If the remote control does not work, please replace the batteries and try again.

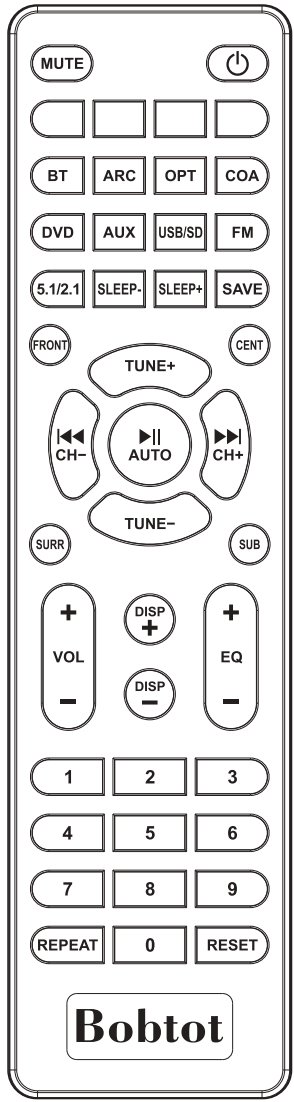

8

**Connect your TV**

1. Plug the **TV ARC / Optical / Coaxial cable** into the audio input on the back of the subwoofer, the other port plugs into the socket of your TV.
2. Make sure the 5 satellite speakers have been plugged into the audio output of the subwoofer and are in the "Power On" status.
3. Press the "ST. BY" button on the subwoofer or press "ON" on the remote to start this system.
4. Press the "INPUT" button on the subwoofer to switch mode "ARC/OPT/COA", which is showing in the LED display of the subwoofer, or press the "ARC/OPT/COA" button on the remote.
5. TV Setting- Sound output - select your mode to "TV ARC / Optical / Coaxial"
6. TV Setting- Expert Setting - Digital Output Audio Format Setting to "PCM".

**Note:**

- 1.For optical connections, please make sure the protective caps at the ends of the optical cable are removed before plugging it in.
- 2.The coaxial cable is not included.

**Other System Connection**

1. For 5.1 surround sound, insert audio cables from your device into the corresponding DVD speaker sockets at the back of subwoofer. (FL/FR, CEN/SW,SL/SR input )
2. For dimensional sound, you can insert the audio cable connected to the AUX port of your device into the back of subwoofer, or insert a USB flash drive into the USB socket at the front of the subwoofer, or insert an SD/MMC card into SD input at the front of subwoofer.
3. For clear, stronger FM signal, insert white antenna cord into FM Antenna socket at the back of subwoofer. Press "FM" on the remote control to enter FM mode, and then press "AUTO/▶|◀" to search the stations automatically and will save the FM station automatically.
4. In FM mode, semi - automatic station - searching, press "TUNE +/-" to select a station you like.

9

**Certification**

**FCC Statement**

This device complies with part 15 of the FCC Rules. Operation is subject to the following two conditions:

- (1) This device may not cause harmful interference, and
- (2) this device must accept any interference received, including interference that may cause undesired operation.

Any Changes or modifications not expressly approved by the party responsible for compliance could void the user's authority to operate the equipment.

**Note:** This equipment has been tested and found to comply with the limits for a Class B digital device,pursuant to part 15 of the FCC Rules. These limits are designed to provide reasonable protection against harmful interference in a residential installation. This equipment generates uses and can radiate radio frequency energy and, if not installed and used in accordance with the instructions, may cause harmful interference to radio communications. However, there is no guarantee that interference will not occur in a particular installation. If this equipment does cause harmful interference to radio or television reception, which can be determined by turning the equipment off and on, the user is encouraged to try to correct the interference by one or more of the following measures:

- Reorient or relocate the receiving antenna.
- Increase the separation between the equipment and receiver.
- Connect the equipment into an outlet on a circuit different from that to which the receiver is connected.
- Consult the dealer or an experienced radio/TV technician for help.

This equipment complies with FCC radiation exposure limits set forth for an uncontrolled environment. This equipment should be installed and operated with minimum distance 20cm between the radiator & your body.

10

**Need Help ?**

**Customer Care Guide**

At our company, we strive to provide exceptional customer care to every one of our clients. We believe that building strong relationships with our customers is essential to the success of our business. To help us achieve this goal, we have put together the following customer care guide.

**Time**

We understand that our customers' time is valuable, so we will respond to any inquiries within 24 hours.

**Feedback**

We know that our customers are the heart of our business so we value your feedback. We encourage you to share your thoughts and ideas with us.

**Solutions**

If our customers encounter any issues, we will try our best to find a quick and efficient solution that meets your needs. Here at Bobtot, we take customer care very seriously. Our customers are our first priority, and we are committed to providing the highest quality service. If you have any questions or concerns, please don't hesitate to reach out to us. We will be happy to assist you.  
Call or Message: +1 (888) 572-1718  
Email: [service@bobot.net](mailto:service@bobot.net)

11

**Bobtot**

[bobot.net](http://bobot.net)

© BOBTOT // Features and specifications are subject to change and or improvement without notice.

12

说明：尺寸：140x215mm  
材质：128G铜版纸 四色双面印刷装订本