

N331 Wireless Mini Optical Mouse User's Guide

Mouse

1. Left mouse button
2. Right mouse button
3. Scroll wheel
4. Charge port
5. Battery cover
6. Receiver storage compartment
7. Battery cover release button
8. Receiver release button
9. Connect button
10. Power ON/OFF Switch

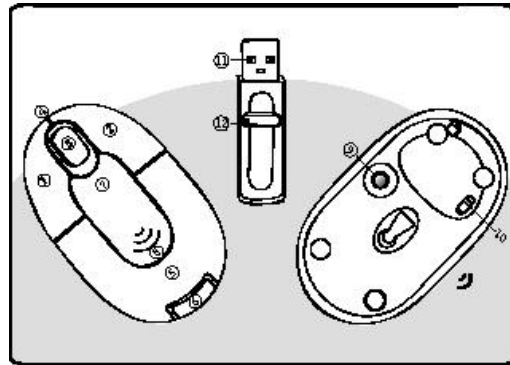

Receiver

11. USB connector
12. Connect button

Charging Cable

13. Charging cable

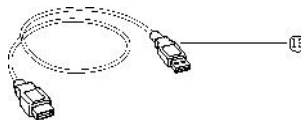

System Requirements

IBM® compatible PC or Macintosh system

Microsoft Windows® 98SE, 2000, Me, XP or Mac® OS X

An available USB port

Installation Instructions

Battery Installation

Step 1. Press the "Battery Cover Release Button" to remove the battery cover.

Step 2. Load two AAA rechargeable batteries into the mouse.

Step 3. Slide and lock the battery cover back into place.

NOTE:

- Please insert the batteries correctly as the pictures. Don't insert the batteries upside down.
- Do not use Ni-Cd or alkaline batteries, or mix batteries of different types. Otherwise leakage of chemicals from or damages to the batteries may occur.

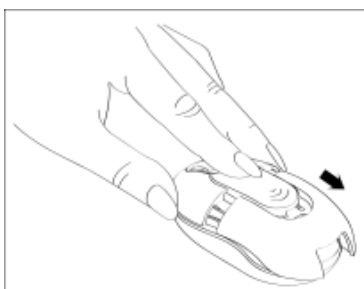

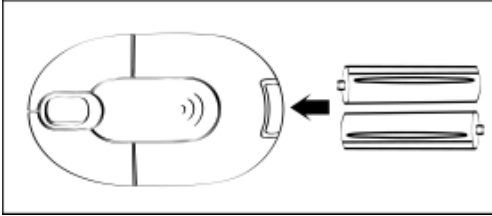

Operating Instructions

Step 1. To ensure correct operation, please make sure that the receiver is installed at least 20cm (8 inches) away from electronic devices (such as monitors or speakers).

Step 2. Plug the receiver unit into a USB port on your system. The system will automatically detect the new hardware and install the device.

Step 3. To activate, first press the CONNECT button on the receiver, and then the CONNECT button located on the bottom of the mouse within 10 seconds of each other.

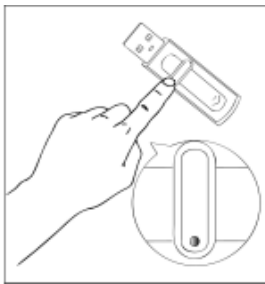

NOTE:

- The receiver/mouse may not function properly if placed on or near a metal surface.
- If the mouse does not activate, please Repeat Step 3.
- It is necessary to repeat Step 3 after any loss of power from battery replacement.

Power-Saving Modes

1. The mouse can be manually powered OFF by using the "Power ON/OFF Switch".
2. The mouse can be manually powered OFF by pressing both Left and Right Mouse Buttons and the Scroll Wheel Button simultaneously. Press any mouse button to turn the power back ON.
3. If not manually powered OFF, the mouse will go into automatic sleep mode when not used for 5 minutes.

Receiver Storage

1. Insert the receiver from the rear of the mouse.
2. To EJECT the receiver, press the receiver release button on the top of the mouse.

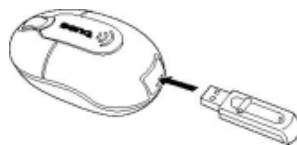

Charging Instructions

When the mouse batteries are low on power, the LED scroll wheel will turn RED to indicate that they need recharging.

Step 1. Press the "Power ON/OFF Switch" to the OFF position.

Step 2. Connect the supplied USB charging cable to a USB port on your computer and to the charge port on the mouse.

Step 3. The LED scroll wheel will turn RED when the mouse is charging, and will turn OFF when charging is complete.

NOTE:

1. To avoid possible damage during charging, please ensure the ON/OFF switch on the underside of the mouse is in the OFF position whilst the

mouse is being charged.

2. If the mouse is going to remain unused for a long period of time, remove the rechargeable batteries from it to avoid unwanted battery power consumption.
3. DO NOT charge the battery unless it is labeled as a “rechargeable” battery.

Trouble Shooting

If you experience problems setting up your M310 Plus Wireless Mini Optical Mouse, please check the following:

1. Make sure the mouse “Power ON/OFF Switch” is in the ON position.
2. Check that the batteries are loaded correctly and have been charged.
3. Check that the receiver is connected to the USB port correctly.
4. Please make sure the wireless mouse & receiver are connected properly and activated as described in Step 3 of the Operating Instructions.
5. Please try to avoid operating the optical mouse on metallic or glass surfaces as the optical sensor may not function correctly.
6. Please ensure that the battery cover is properly secured.

Warranty Information

Warranty

- One year parts/labor from the date of purchase.
- Please refer to the Warranty Terms and Conditions for your local region for further warranty details.
- For more information, please visit: www.BenQ.com

FCC Warning

This equipment has been tested and found to comply with the limits for a Class B digital device, pursuant to part 15 of the FCC Rules. These limits are designed to provide reasonable protection against harmful interference in a residential installation. This equipment generates, uses, and can radiate radio frequency energy and, if not installed and used in accordance with the instructions, may cause harmful interference to radio communications. However, there is no guarantee that interference will not occur in a particular installation. If this equipment does cause harmful interference to radio or television reception, which can be determined by turning the equipment off and on, the user is encouraged to try to correct the interference by one or more of the following measures:

- Reorient or relocate the receiving antenna.
- Increase the separation between the equipment and receiver.
- Connect the equipment into an outlet on a circuit different from that to which the receiver is connected.
- Consult the dealer or an experienced radio/TV technician for help.

This device complies with Part 15 of the FCC Rules.

Operation is subject to the following two conditions:

- (1) this device may not cause harmful interference and
- (2) this device must accept any interference received, including interference that may cause undesired operation.

The user manual or instruction manual for an intentional or unintentional radiator shall caution the user that changes or modifications not expressly approved by the party responsible for compliance could void the user's authority to operate the equipment.

N332 Wireless Mini Optical Mouse User's Guide

Mouse

1. Left mouse button
2. Right mouse button
3. Scroll wheel
4. Charge port
5. Battery cover
6. Receiver storage compartment
7. Battery cover release button
8. Receiver release button
9. Connect button
10. Power ON/OFF Switch

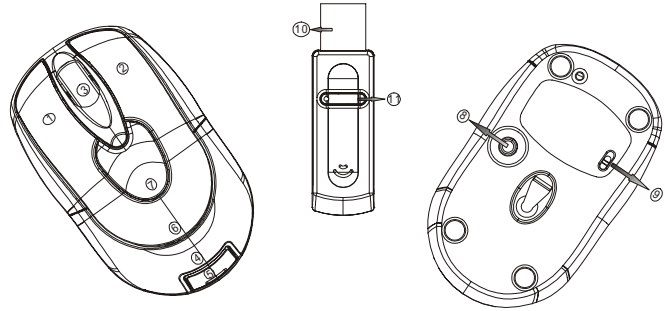

Receiver

11. USB connector
12. Connect button

Charging Cable

13. Charging cable

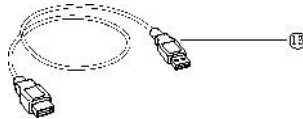

System Requirements

IBM® compatible PC or Macintosh system

Microsoft Windows® 98SE, 2000, Me, XP or Mac® OS X

An available USB port

Installation Instructions

Battery Installation

Step 1. Press the “Battery Cover Release Button” to remove the battery cover.

Step 2. Load two AAA rechargeable batteries into the mouse.

Step 3. Slide and lock the battery cover back into place.

NOTE:

- Please insert the batteries correctly as the pictures. Don't insert the batteries upside down.
- Do not use Ni-Cd or alkaline batteries, or mix batteries of different types. Otherwise leakage of chemicals from or damages to the batteries may occur.

Operating Instructions

Step 1. To ensure correct operation, please make sure that the receiver is installed at least 20cm (8 inches) away from electronic devices (such as monitors or speakers).

Step 2. Plug the receiver unit into a USB port on your system. The system will automatically detect the new hardware and install the device.

Step 3. To activate, first press the CONNECT button on the receiver, and then the CONNECT button located on the bottom of the mouse within 10 seconds of each other.

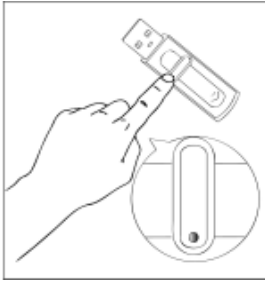

NOTE:

- The receiver/mouse may not function properly if placed on or near a metal surface.
- If the mouse does not activate, please Repeat Step 3.
- It is necessary to repeat Step 3 after any loss of power from battery replacement.

Power-Saving Modes

1. The mouse can be manually powered OFF by using the “Power ON/OFF Switch”.
2. The mouse can be manually powered OFF by pressing both Left and Right Mouse Buttons and the Scroll Wheel Button simultaneously. Press any mouse button to turn the power back ON.
3. If not manually powered OFF, the mouse will go into automatic sleep mode when not used for 5 minutes.

Receiver Storage

1. Insert the receiver from the rear of the mouse.
2. To EJECT the receiver, press the receiver release button on the top of the mouse.

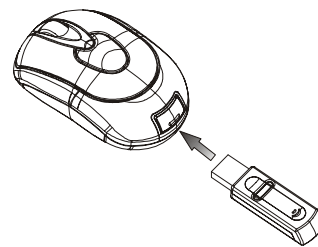

Charging Instructions

When the mouse batteries are low on power, the LED scroll wheel will turn RED to indicate that they need recharging.

Step 1. Press the “Power ON/OFF Switch” to the OFF position.

Step 2. Connect the supplied USB charging cable to a USB port on your computer and to the charge port on the mouse.

Step 3. The LED scroll wheel will turn RED when the mouse is charging, and will turn OFF when charging is complete.

NOTE:

1. To avoid possible damage during charging, please ensure the ON/OFF switch on the underside of the mouse is in the OFF position whilst the mouse is being charged.
2. If the mouse is going to remain unused for a long period of time, remove the rechargeable batteries from it to avoid unwanted battery power consumption.
3. DO NOT charge the battery unless it is labeled as a “rechargeable” battery.

Trouble Shooting

If you experience problems setting up your mouse, please check the following:

1. Make sure the mouse “Power ON/OFF Switch” is in the ON position.
2. Check that the batteries are loaded correctly and have been charged.
3. Check that the receiver is connected to the USB port correctly.
4. Please make sure the wireless mouse & receiver are connected properly and activated as described in Step 3 of the Operating Instructions.
5. Please try to avoid operating the optical mouse on metallic or glass surfaces as the optical sensor may not function correctly.
6. Please ensure that the battery cover is properly secured.

Warranty Information

Warranty

- One year parts/labor from the date of purchase.
- Please refer to the Warranty Terms and Conditions for your local region for further warranty details.
- For more information, please visit: www.BenQ.com

FCC Warning

This equipment has been tested and found to comply with the limits for a Class B digital device, pursuant to part 15 of the FCC Rules. These limits are designed to provide reasonable protection against harmful interference in a residential installation. This equipment generates, uses, and can radiate radio frequency energy and, if not installed and used in accordance with the instructions, may cause harmful interference to radio communications. However, there is no guarantee that interference will not occur in a particular installation. If this equipment does cause harmful interference to radio or television reception, which can be determined by turning the equipment off and on, the user is encouraged to try to correct the interference by one or more of the following measures:

- Reorient or relocate the receiving antenna.
- Increase the separation between the equipment and receiver.
- Connect the equipment into an outlet on a circuit different from that to which the receiver is connected.
- Consult the dealer or an experienced radio/TV technician for help.

This device complies with Part 15 of the FCC Rules.

Operation is subject to the following two conditions:

- (1) this device may not cause harmful interference and (2) this device must accept any interference received, including interference that may cause undesired operation.

The user manual or instruction manual for an intentional or unintentional radiator shall caution the user that changes or modifications not expressly approved by the party responsible for compliance could void the user's authority to operate the equipment.