

Smart Tape Measure +



Model: R-Y002

Thank you for choosing the RENPHO Smart Tape Measure +! This Bluetooth body tape measure is your personal health assistant. It will help you easily measure various body parts so you can keep track of your health and fitness. We hope that you enjoy using it!

Important Safety Instructions

READ ALL INSTRUCTIONS CAREFULLY BEFORE USE.

1. The device is for household use only and not for medical or commercial purposes.
2. DO NOT disassemble or modify the device, as there are no user-serviceable parts inside.
3. DO NOT expose the device to extreme conditions, such as high temperatures, humidity, direct sunlight, or dusty environments.
4. DO NOT use excessive force on the tape or the gear as this may cause permanent damage to the device.
5. DO NOT fold or twist the tape as this may cause permanent damage.
6. DO NOT pull the tape with excessive force beyond the maximum length of 150cm/60inch.
7. Be cautious when retracting the tape to avoid minor injuries.
8. Exercise caution when measuring neck circumference to avoid accidental choking.
9. Children under 10 years old must be supervised by an adult when using the device.
10. Keep the batteries out of reach of children. In case of ingestion of a battery, seek medical assistance promptly.

11. Exhausted batteries should be immediately removed from the device and properly disposed of. Do not dispose of batteries in fire. When discharged batteries are kept in the device for a long time, electrolyte leakage can occur causing damage to the device and/or personal injury.
12. Do not heat, short-circuit, force discharge, encapsulate and/or modify the batteries. Do not deform or dismantle the batteries.
13. Do not weld or solder directly to batteries.
14. Store unused batteries in their original packaging away from metal objects. If already unpacked, do not mix or jumble batteries.
15. Remove batteries from the device if it is not to be used for an extended period of time unless it is for emergency purposes.
16. Do not expose the device or batteries to excessive temperatures.

SAVE THESE INSTRUCTIONS



What's in the Box

- 1 x Smart Tape Measure +
- 3 x 1.5V AAA Batteries
- 1 x User Manual

Technical Specifications

Product Name: Smart Tape
Model: R-Y002
Unit: cm/in
Size: 128x75x33mm/5x3x1.3in
Measuring Range: 150cm/60in
Resolution: 1mm, 1/16in
Accuracy: $\pm 3\text{mm}$, $\pm 3/32\text{in}$
Working Temperature: 32°F~122°F
Working Humidity: $\leq 85\%$
Power Supply: 3 x 1.5V AAA Batteries

Product Overview

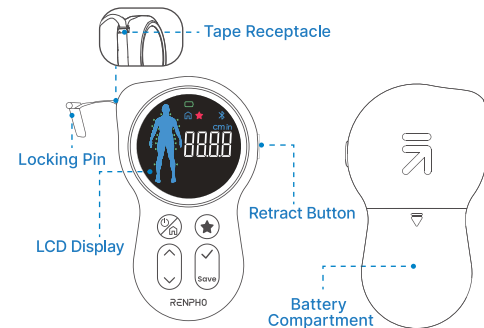

Tip: For optimal performance, hold the retract button while pulling out the tape.

Icons

	Low battery indicator
	General mode: measure 12 body parts
	Favorite mode: add body parts you measure frequently
	Bluetooth: solid blue indicates a successful connection
	Unit: switch the unit via the app

Buttons

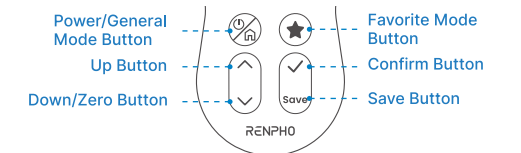

- : Short press to turn on the device or enter the General Mode. Press and hold for 3s to turn off the device.
- : Press to enter the Favorite Mode.
- : Press “^” / “v” to move up/down to the next body part. Press and hold “v” for 5s to zero the measurement.
- : Press “v” to confirm the measurement. Press “Save” to save the measurement.

Warranty Policy

Your RENPHO product purchase is covered by a one-year limited manufacturer warranty from the date of delivery.

For warranty terms and conditions, please visit:
<https://renpho.com/pages/warranty-terms-and-conditions>

Note: Product registration is not required for the warranty. If you choose not to register your product, it will not void the product warranty.

Customer Service

Please feel free to contact us if you have any questions or concerns. RENPHO Customer Service Team guarantees a quick response and hassle-free solutions to any issue you may have within business hours.

TEL: +1(844) 417 0149 (US ONLY)
Monday-Friday 9:00AM-4:30PM
1800 MY RENPHO (1800 69 7367) (AU ONLY)
Monday-Friday 9:00AM-6:00PM (AEST)
Email: support@renpho.com (US&CA)
support-au@renpho.com (AU)

*For defective products or the return of items, please contact us with your order number within the specified warranty period. DO NOT dispose of any product parts as they may be required for inspection/repair.

US Importer: JOICOM CORPORATION

14129 The Merge Street, Building 3 Unit A, Eastvale, CA 92880

Manufacturer: Shenzhen Ruiyi Business Technology Co., Ltd.

No. 810-C063, 8th Floor, Xiangbin International Financial Centre, No.18, West Free Trade Street, China Special Economic Zone, Qianhai Bay, Shenzhen, Guangdong Province, 518000 China

Install the Batteries



Note:

- Always select the correct size and type of battery most suitable for the intended use. Do not mix new and used batteries or batteries of different types or brands. Do not charge the batteries.
- Clean the battery contacts and also those of the device prior to battery installation.
- Replace all batteries of a set at the same time.

Download the App

Search for “Renpho Health” from the Apple Store or Google Play Store or scan the QR code to download the app.



Note: Due to continuous updates and improvements, the "Renpho Health" App may appear slightly different.

Pair with the App

1. Enable Bluetooth on your smartphone.
2. Press the Power Button to turn on the device. Bluetooth is enabled by default.
3. Open the “Renpho Health” App and tap “Connect” once a window pops up. When the Bluetooth icon on the device turns solid blue, it indicates a successful connection.



Measure

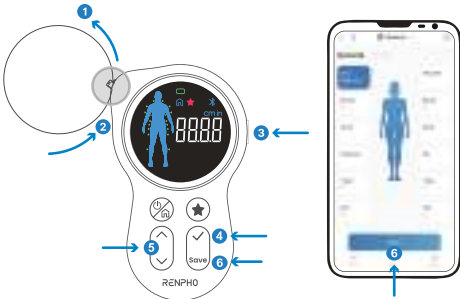

1. Pull out the tape, and wrap it around your target body part.
2. Insert the locking pin into the tape receptacle until a “click” is heard.
3. Press the Retract Button to tighten the tape and get your measurement.
4. Press “ ✓ ” to confirm the measurement, and the pointer will automatically move to the next body part.
5. If needed, press “ ^ ” / “ v ” to choose the body part you want to measure.
6. Press “ Save ” or tap “ Save ” on the app to save the measurements.

Note:

1. After each measurement, make sure to press “ ✓ ” to confirm the data.
2. If the device is turned on and left idle, it will automatically enter standby mode after 20 seconds and shut off after 8 minutes.
3. To turn on the device, press the Power Button or pull the tape. When the device is in standby mode, simply press any button or pull the tape to activate it.

Manually Add the Measurement

*** When the app connection is lost, manually input the measurements.**



1. Tap the body part name (e.g. Waist).
2. Swipe the “ruler” right or left to select a size.
3. Choose the date.
4. Tap “ ✓ ” on the app to confirm the measurement.
5. Tap “ Save ” on the app to save the measurements.

Troubleshooting Guide

Problem	Possible Cause	Solution
The display is blank, or the measurement appears blurred.	Low battery or wrong battery installation.	Replace or reinstall the batteries.
Erratic display.	Casual malfunction caused by high vibration or strong shaking.	Press and hold “ v ” for 5 seconds to zero the measurement.
Fail to connect to the app.	Your phone is too far away from the device.	Keep your phone within 26ft (8m) of the device.

FCC Regulatory Compliance

This device complies with part 15 of the FCC Rules. Operation is subject to the following two conditions:
(1) This device may not cause harmful interference, and (2) this device must accept any interference received, including interference that may cause undesired operation.
Warning: Changes or modifications not expressly approved by the party responsible for compliance could void the user's authority to operate the equipment.
Note: This equipment has been tested and found to comply with the limits for a Class B digital device, pursuant to Part 15 of the FCC Rules. These limits are designed to provide reasonable protection against harmful interference in a residential installation. This

equipment generates, uses and can radiate radio frequency energy and, if not installed and used in accordance with the instructions, may cause harmful interference to radio communications. However, there is no guarantee that interference will not occur in a particular installation.
If this equipment does cause harmful interference to radio or television reception, which can be determined by turning the equipment off and on, the user is encouraged to try to correct the interference by one or more of the following measures:
- Reorient or relocate the receiving antenna.
- Increase the separation between the equipment and receiver.
- Connect the equipment into an outlet on a circuit different from that to which the receiver is connected.
- Consult the dealer or an experienced radio/TV technician for help.

RF Exposure Compliance
This equipment complies with FCC radiation exposure limits set forth for an uncontrolled environment. This transmitter must not be co-located or operating in conjunction with any other antenna or transmitter.

ISED Regulatory compliance
This device contains licence-exempt transmitters that comply with Innovation, Science and Economic Development Canada's licence-exempt RSS(s).
Operation is subject to the following two conditions:
(1) This device may not cause interference.
(2) This device must accept any interference, including interference that may cause undesired operation of the device.

Le présent appareil est conforme aux CNR d'Industrie Canada applicables aux appareils radio exempts de licence. L'exploitation est autorisée aux deux conditions suivantes:
(1) l'appareil ne doit pas produire de brouillage, et (2) l'utilisateur de l'appareil doit accepter tout brouillage radioélectrique subi, même si le brouillage est susceptible d'en compromettre le fonctionnement.
This equipment complies with IC RSS-102 radiation exposure limits set forth for an uncontrolled environment.
Cet équipement est conforme aux limites d'exposition aux radiations IC CNR-102 établies pour un environnement non contrôlé.

尺寸:375mmX 105mm,

装订方式:风琴页

材质:128g銅版紙

印刷方式:雙面彩色印刷

(此页不印刷)

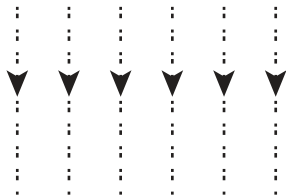

此分割线不印刷(压褶线)