

# Magnetic Phone Vlog Selfie Screen

User Manual



## Catalogue

Production description and Specifications.....	29 2
Features, Instructions.....	31
Charging, Dimensions.....	33
iPhone Wireless Screen Mirroring Connection Steps.....	34
Android Smartphone Wireless Screen Mirroring Connection Steps.....	40
Wired Connection Mode(Plug and play).....	47
Warranty period.....	50

This product is a mini phone rear camera selfie& vlogging monitoring screen. It provides a practical solution to easily and efficiently capture higher quality photos or videos using the phone's rear camera. It's suitable for YouTuber, Instagramer, Vlogger and any content creator who wants to create high-quality selfie photos or videos.

Using this screen, you can monitor your framing status and ensure you are in the shooting while using the phone's rear camera. The screen can be connected to a smartphone through both wireless and wired methods. It is equipped with a 3.97-inch screen that can help you monitor more clearly. It has functions such as Bluetooth shooting, 180 degree screen rotation, full screen or 1:1 screen switching, mirroring mode switching, etc. It has a compact structure, it's easy to carry and simple to use.

## Specifications

Input:5V $\overline{=}$ 1A

Rated Power:1.75W

Powerinput Port:USB-C

Audio/Video Transmission Port:UsB-C

Applicable with: IOS system 9.0 or above, Android system 12.0 or above, HarmonyOS system 3.0 or above, MagicOS system 4.0 or above.

## Features

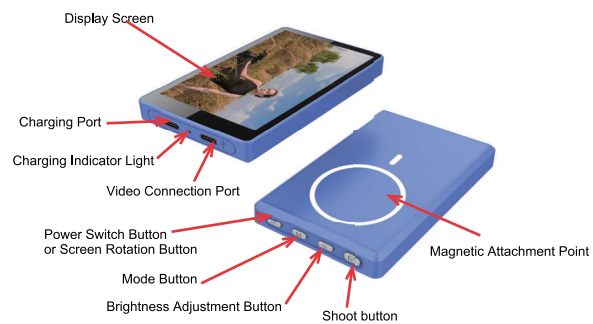

If there are any future upgrades to the product and the manual isn't updated in time, please kindly understand.

## Instructions

### Power Button :

1. Power On/Off: Press and hold the "POWER" button for 3 seconds to turn the screen on or off.
2. Screen 180° Rotation: Short press the "POWER" button to rotate the screen 180 degrees.

### Shoot Button:

When the screen's Bluetooth is connected to the mobile phone's Bluetooth, you can take photos and record videos directly from the screen.

### Mode Button:

1. Long press the mode button to switch between full screen mode and 1:1 screen mode.
2. Short press the mode button to switch between mirroring mode and normal mode.

Brightness adjustment button:

1. Press one brightness level at a time to cycle through

### Attention:

- Powering on or off will not affect the full screen and 1:1 screen settings, and the last used state will be retained.

## Charging

The charging indicator light stays on RED during charging and remains on GREEN after being fully charged



## Product Connection Instructions

### Wireless Connection Mode (Screen Mirroring)

Suitable for iPhone and Android smartphones

### iPhone Wireless Screen Mirroring Connection Steps

1.1 Long press the "Power" button for 3 seconds to turn on the Vlog screen (it takes 6 seconds to open the system)





U200

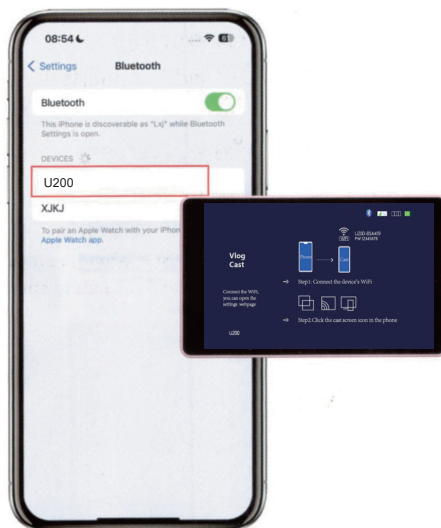

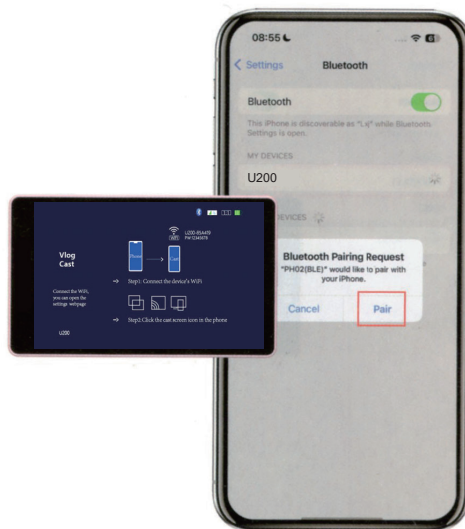

1.2 Open the phone settings -wireless LAN or WIFI menu bar  
search for the device name corresponding to the SSID,  
enter the PW password to connect.

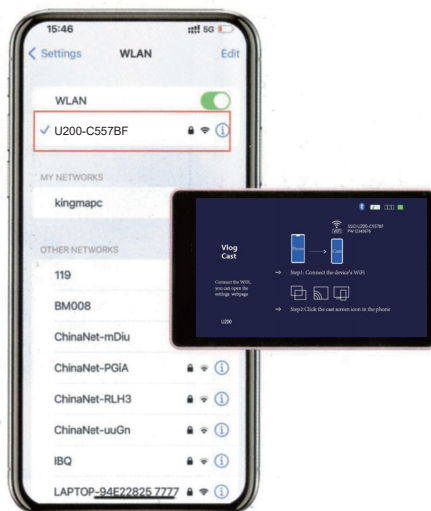

1.3 Slide down the settings on the right side of the phone screen, find the “Screen Mirroring” icon and click to open it

1.4 Click on the corresponding SSID device name that pops up to connect



(1.3)

(1.4)

### 1.5 Wireless Projection Successfully



## **Android Smartphone Wireless Screen Mirroring Connection Steps**

1.1 Long press the "Power" button for 3 seconds to turn on the Vlog screen (it takes 6 seconds to open the system)



U200

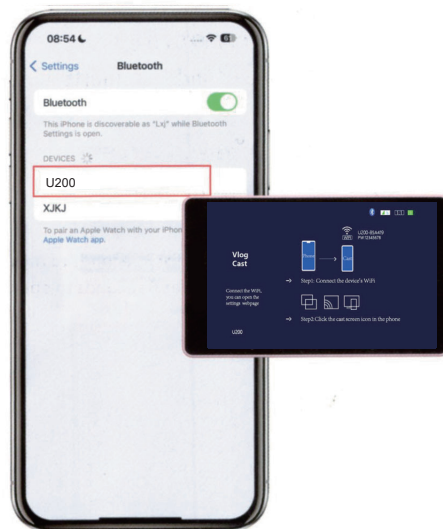

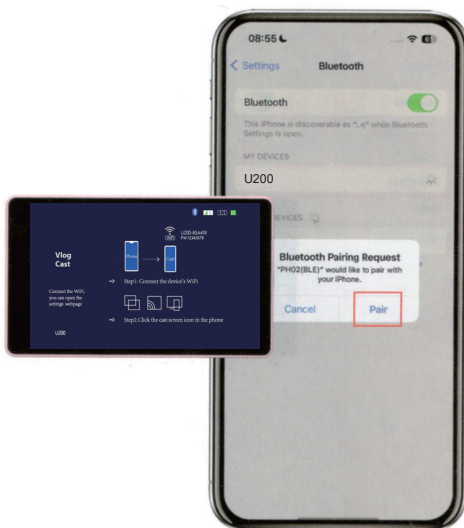



1.4 Slide down the settings on the right side of the phone screen, find the "Wireless Projection" icon and click to open it.

1.5 Mobile prompt: Enable WLAN and Bluetooth, then click on enable.

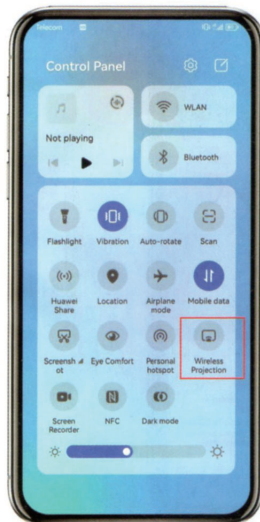

(1.4)



(1.5)

1.6 Mobile prompt: Wireless Projection, searching for available devices.



1.7 Click on the corresponding U200 SSID device name that pops up to connect



(1.7)

### 1.8 Wireless Projection Successfully



### **Wired Connection Mode (Plug and play)**

Only suitable for iPhones (iOS system)

1.1 Long press the "Power" button for 3 seconds to turn on the Vlog screen (it takes 6 seconds to open the system)



1.2 For iPhone 15 and above series phones can use with original USB C-C data cable to connect the iPhone and the screen to enable screen mirroring, plug and play.

For iPhone 14 and below models, please use a Lightning to USB-C data cable(NOT included).



### 1.3 Wireless Projection Successfully



**FCC Caution:**

This device complies with part 15 of the FCC Rules. Operation is subject to the following two conditions: (1) This device may not cause harmful interference, and (2) this device must accept any interference received, including interference that may cause undesired operation.

Any Changes or modifications not expressly approved by the party responsible for compliance could void the user's authority to operate the equipment.

**Note:** This equipment has been tested and found to comply with the limits for a Class B digital device, pursuant to part 15 of the FCC Rules. These limits are designed to provide reasonable protection against harmful interference in a residential installation. This equipment generates uses and can radiate radio frequency energy and, if not installed and used in accordance with the instructions, may cause harmful interference to radio communications. However, there is no guarantee that interference will not occur in a particular installation. If this equipment does cause harmful interference to radio or television reception, which can be determined by turning the equipment off and on, the user is encouraged to try to correct the interference by one or more of the following measures:

- Reorient or relocate the receiving antenna.
- Increase the separation between the equipment and receiver.
- Connect the equipment into an outlet on a circuit different from that to which the receiver is connected.
- Consult the dealer or an experienced radio/TV technician for help.

The device has been evaluated to meet general RF exposure requirement. The device can be used in portable exposure condition without restriction.