

FCC WARNINGS

NOTE: This equipment has been tested and found to comply with the limits for a Class B digital device, pursuant to part 15 of the FCC Rules. These limits are designed to provide reasonable protection against harmful interference in a residential installation. This equipment generates uses and can radiate radiofrequency energy and, if not installed and used in accordance with the instructions, may cause harmful interference to radio communications. However, there is no guarantee that interference will not occur in a particular installation. If this equipment does cause harmful interference to radio or television reception, which can be determined by turning the equipment off and on, the user is encouraged to try to correct the interference by one or more of the following measures:

- Reorient or relocate the receiving antenna.
- Increase the separation between the equipment and receiver.
- Connect the equipment into an outlet on a circuit different from that to which the receiver is connected.
- Consult the dealer or an experienced radio/TV technician for help.

Changes or modifications not expressly approved by the party responsible for compliance could void the user's authority to operate the equipment. This device complies with Part 15 of the FCC Rules. Operation is subject to the following two conditions:

- (1) this device may not cause harmful interference, and
- (2) this device must accept any interference received, including interference that may cause undesired operation.

ADDITIONAL WARNINGS

- WARNING: To prevent fire or shock hazards, do not expose this unit to rain or moisture.
- WARNING : Where the mains plug or appliance coupler is used as the disconnect device, such disconnect device shall remain readily operable.
- Lithium batteries, like all rechargeable batteries, are recyclable and should be recycled or disposed of according to state and local guidelines. They should never be disposed of in normal household waste and they should never be incinerated, as they might explode. Contact your local government for disposal or recycling practices in your area.
- WARNING: This product may contain chemicals known to the State of California to cause birth defects, or other reproductive harm (California Prop 65). Wash hands after handling.
- This product meets and complies with all Federal regulations.
- **To avoid hearing damage**, make sure that the volume on your music player is turned down before connecting your earbuds. After placing earbuds in/on your ears, gradually turn up the volume until you reach a comfortable listening level.

International Support

To download this User's Guide in English, Spanish, or French, or to get answers to frequently asked questions, visit the support section at: www.iLiveElectronics.com

Para descargar este Manual del Usuario en Inglés, Español y Francés, o para obtener respuestas a preguntas frecuentes, visite la sección de apoyo en: www.iLiveElectronics.com

Pour télécharger ce guide de l'utilisateur en Anglais, Espagnol ou Français, ou pour obtenir des réponses à des questions fréquemment posées, consultez la rubrique d'assistance sur: www.iLiveElectronics.com

Contact Information

Website: www.iLiveElectronics.com
Email Support: prodinfo@dpiinc.com
Email Parts: partsinfo@dpiinc.com
Phone Support: 1-888-999-4215

Warranty

For Warranty Information and the most up-to-date version of this User's Guide, go to: www.iLiveElectronics.com.



Specifications are subject to change without notice.
Copyright © 2017 Digital Products International (DPI, Inc.)
All other trademarks appearing herein are the property of their respective owners.



Wireless Stereo Earbuds
User's Guide for Model IAEB37-1879-01

Features

- Bluetooth wireless
- Sweatproof
- Wireless range: 33 feet
- Voice prompts announce earbud operations
- Built-in microphone
- Micro-USB port for battery recharge
- DC battery power: built-in rechargeable battery
- Battery life: approx. 4 hrs

Includes

- 3 sets of eartips
- Micro-USB to USB charging cable
- User's guide

Overview & Controls

Power / Pair / Play / Pause / Speakerphone

Press and hold for 8-9 sec. to power ON and begin pairing.
Press and hold for 5-6 sec. to power ON/OFF.
Press to play/pause audio or answer/end a phone call.

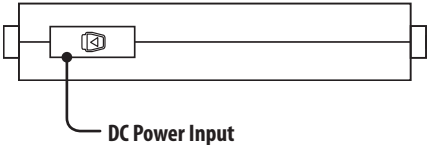
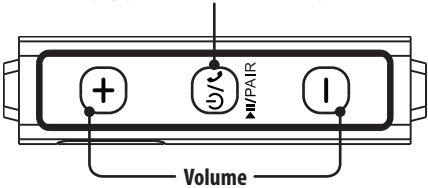

Charging the Battery

Initial charge time is approximately 2 hours. Charge fully before use. The low battery indicator will flash for 1 minute, then the unit will automatically power OFF.

1. Using a **Micro-USB to USB** cable (included), connect to the USB port of a powered on computer or USB power adaptor to charge.

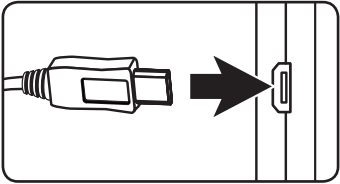

Power Status	Indicator Light
Power ON	Flashing blue light
Low Battery	Flashing red light
Charging	Solid Red light
Finished Charging	Solid Blue light

Pairing a Bluetooth Device

1. While the unit is OFF, press and hold the **Play/Pause/Speakerphone/Pair** button for **approximately 8-9 seconds** until the indicator light flashes red and blue. *When pairing, remain within 3 feet of the unit.*
2. Using the controls on your Bluetooth device, select **IAEB37** in your Bluetooth settings to pair. *If your device requests a password, enter the default password **0000**. Refer to the user's manual for your specific device for specific instructions on pairing to Bluetooth devices.*
3. When successfully paired, an audible chime will sound and the LED indicator will slowly flash blue. Audio from the connected Bluetooth device should now be heard through the earbuds, use the controls on the connected Bluetooth device to select and play audio.

After initial pairing, the unit will stay paired unless unpaired manually by the user or erased due to a reset of the device. Repeat these steps if your device should become unpaired or will not connect normally.

Bluetooth Status	Indicator Light
Pairing Bluetooth	Flashing red and blue lights
Successfully Paired	Slowly flashing blue light

Playing Audio Wirelessly

1. If the unit is OFF and has already been paired to a Bluetooth device, press and hold the **Play/Pause/Speakerphone/Pair** button for **approximately 5-6 seconds** until it automatically connects to your device. An audible chime will sound and the LED indicator will turn solid blue.
2. Use the controls on the connected Bluetooth device to **select and play** audio.
3. To play or pause audio, press the **Play/Pause** button or use the controls on the connected Bluetooth device.

Using the Speakerphone

1. To accept a call, press the **Speakerphone** button or use the controls on the connected phone.
2. To end a call, press the **Speakerphone** button or use the controls on the connected phone.
3. To re-dial the last dialed number, press the **Speakerphone** button twice.