

USER MANUAL

AiBOX

1、Connect 'AI BOX' to the car using a USB cable

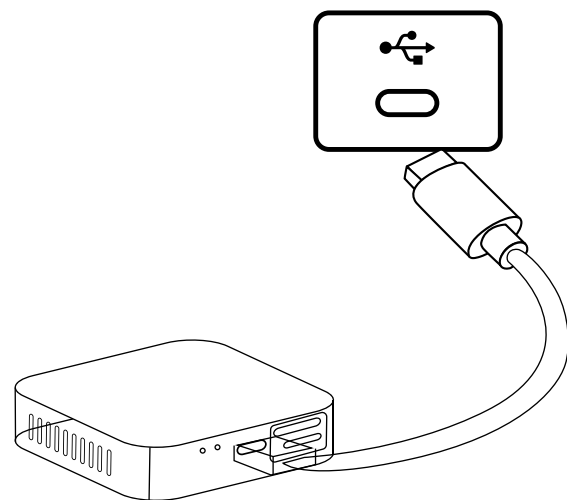

2、Make sure to turn on Bluetooth on your phone.



3、Open the phone settings, click on the Bluetooth option in the list, click on "AI BOX", and the connection is successful

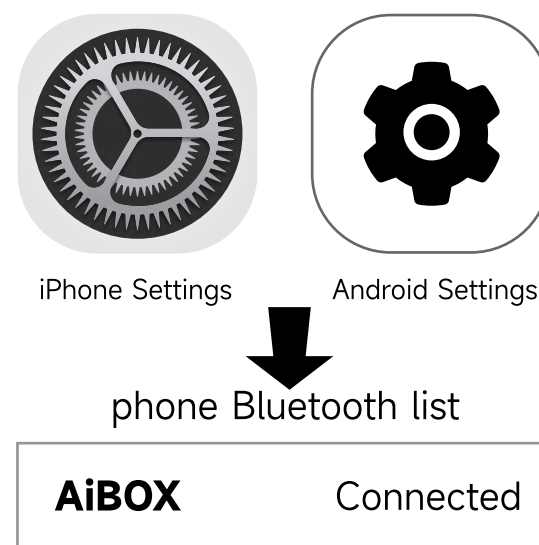

4、Click on CarPlay or Android Auto in the car's built-in display screen

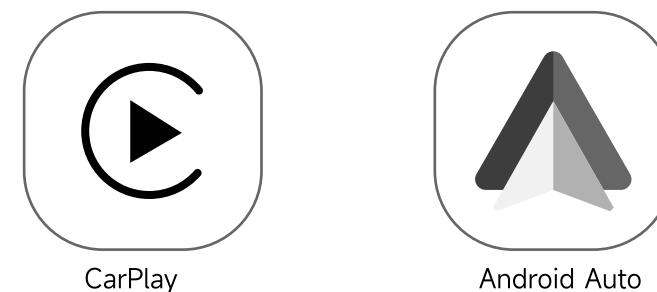

5、After successful connection, the SpeedPlay interface appears on the car's built-in display screen, Click on the SpeedPlay App on the car's built-in display screen

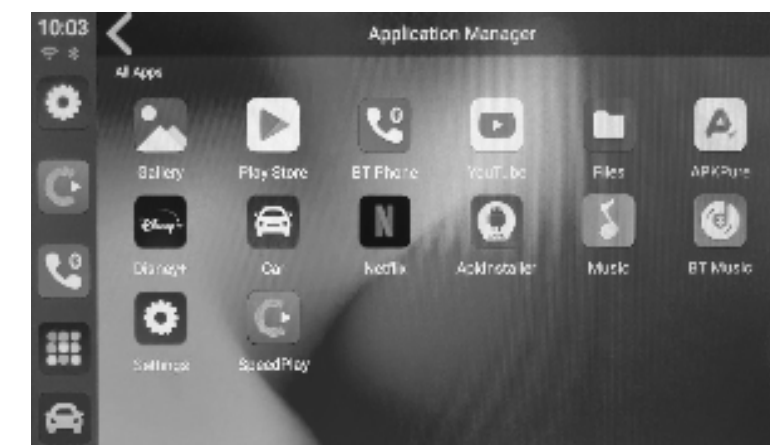
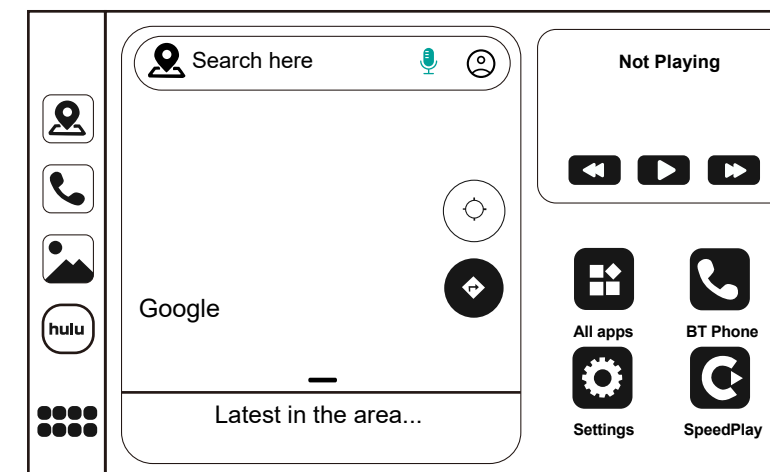

6、iPhone users will automatically connect to the CarPlay on their phone; Users of Android phones automatically connect to Android Auto on their phones.

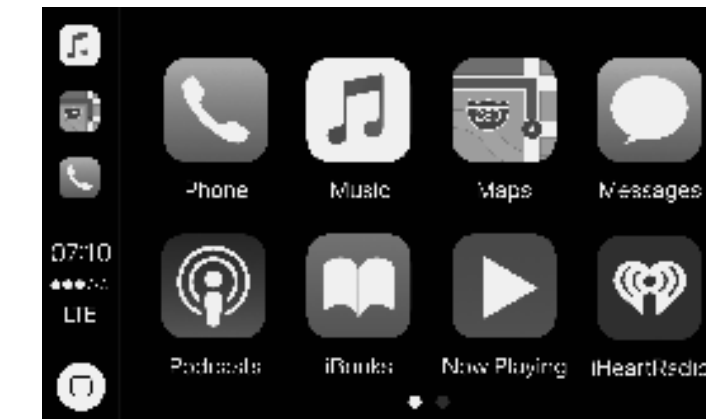

CarPlay interface

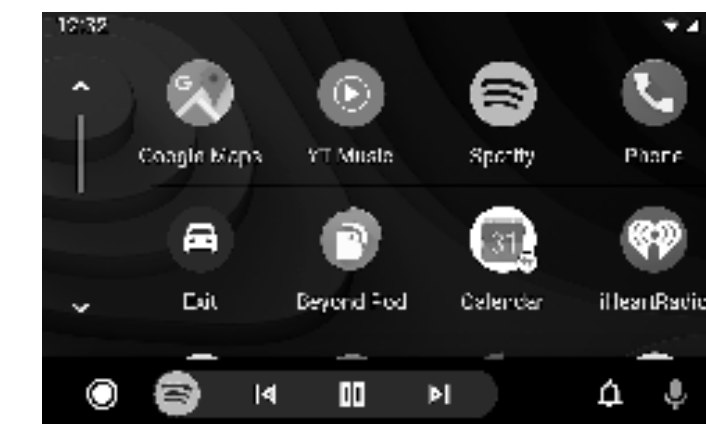

Android Auto

FCC Warning:

This equipment has been tested and found to comply with the limits for a Class B digital device, pursuant to part 15 of the FCC Rules. These limits are designed to provide reasonable protection against harmful interference in a residential installation. This equipment generates, uses and can radiate radio frequency energy and, if not installed and used in accordance with the instructions, may cause harmful interference to radio communications. However, there is no guarantee that interference will not occur in a particular installation. If this equipment does cause harmful interference to radio or television reception, which can be determined by turning the equipment off and on, the user is encouraged to try to correct the interference by one or more of the following measures:

- Reorient or relocate the receiving antenna.
- Increase the separation between the equipment and receiver.
- Connect the equipment into an outlet on a circuit different from that to which the receiver is connected.
- Consult the dealer or an experienced radio/TV technician for help.

Caution: Any changes or modifications to this device not explicitly approved by manufacturer could void your authority to operate this equipment.

This device complies with part 15 of the FCC Rules. Operation is subject to the following two conditions:

(1) This device may not cause harmful interference, and (2) this device must accept any interference received, including interference that may cause undesired operation.

This equipment complies with FCC radiation exposure limits set forth for an uncontrolled environment. This equipment should be installed and operated with minimum distance 20cm between the radiator and your body.