

Toast Go[®] 3

User Guide



Meet the Toast Go[®] 3 — your new hardest worker.

Like all our hardware, we designed the Toast Go[®] 3 to meet the demands of busy restaurants, making it durable enough for everyday spills, grease, and heat. More to love? The lightning fast processing speeds, intuitive layout, and sleek design – all thoughtfully engineered by our team of restaurant experts to help you do what you do best. We hope you're as excited about this as we are.

Use this booklet to install your new hardware. With intuitive, simple packaging, color-coded wiring, and easy step-by-step instructions, most people should be able to complete installation in under 30 minutes. (We know you've got other things on your plate.) Of course, if you need additional support, we're here for you.

Do this first:

1. If you have existing POS hardware set up, unplug it and remove it.
2. Make sure your setup surface is cleared.
3. Wipe your surface with an alcohol wipe. (A clean restaurant is a happy restaurant.)

Getting Started

Power on.

Press down **Power Button** for 2 seconds.

Power off.

Simultaneously press down **Power Button** and **Volume Up** key and select **Power Off**.

Wake screen.

Double tap the screen or press **Power Button**.

Hard reboot.

Hold down **Power Button** and **Volume Up** key simultaneously for 15 seconds.

Toast Go® 3

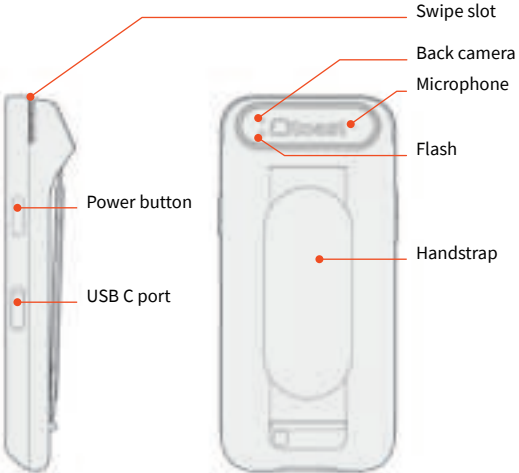
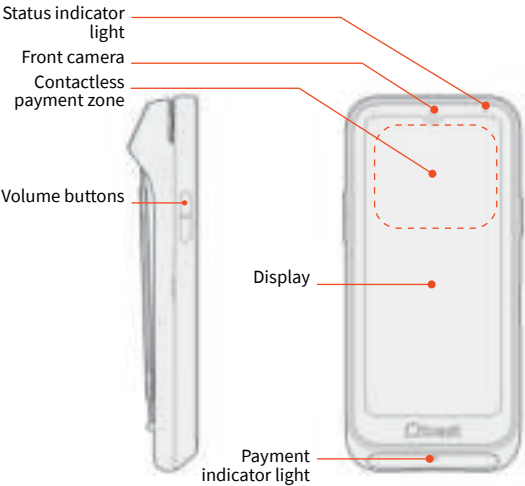

Payment methods

You can accept the following payment methods using your Toast Go 3:

Chip or tap-enabled cards, NFC-enabled devices and/or magnetic strip cards.

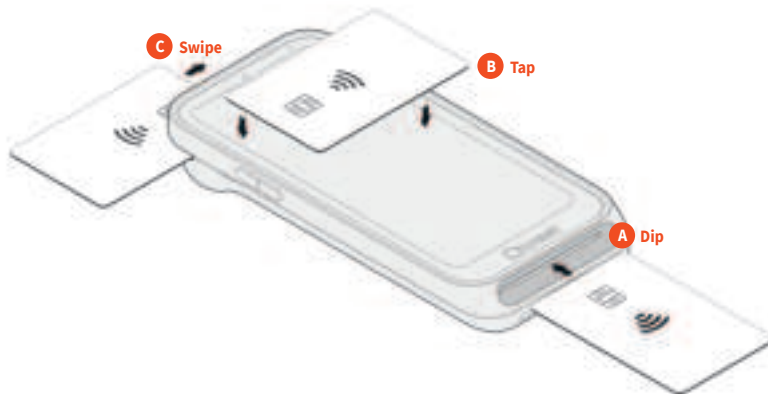

(A) Chip or tap-enabled cards: To dip, insert the card chip first into the Dip Slot at the bottom of your device.

(B) NFC-enabled devices: Tap the device on the Contactless Payment Zone to pay using Apple Pay®, Samsung Pay, Google Pay™.

(C) Magnetic strip cards: Swipe cards that have a magnetic strip in the Swipe Slot at the top of your device.

Cleaning your Toast Go® 3

Apply the cleaning fluid to a cloth then wipe down the device.

Do not spray directly on to the device.



User manual

Product name Toast Go® 3
Model name: TG310, TG300
Specifications: Toast Go®

Processor	Octa-core A78 + A55, 2.7GHz
RAM	8GB LPDDR5/5x
Storage	32GB eMMC
Operation system	Android 14
Display	6.52"
Resolution	720 x 1600
Brightness	500 Nits
Battery	5200mAh Lithium-Ion
WiFi	2.4GHz & 5GHz, IEEE 802.11 a/b/g/n/ac/WiFi6/6E
Cellular	LTE and 3G Capable (TG310 only)

Bluetooth	Bluetooth 5.2 BLE supported
Regulatory approvals and declarations	Rohs WEEE FCC CE IC UL UKCA
I/O Port	USB Type-C for charging and data.
Camera	5MP Fixed-Focus front facing camera. 8MP Auto-Focus rear camera with flash LED.
Card reader	MSR 3-track MSR ISO 7810/7811 Swipe Speed 15cm/s - 100 cm/s EVM reader ISO 7816 Compliant Class A, B, C EVM Contactless, ISO 14443 A/B

Federal Communications Commission Interference Statement

This equipment has been tested and found to comply with the limits for a Class B digital device, pursuant to part 15 of the FCC Rules. These limits are designed to provide reasonable protection against harmful interference in a residential installation. This equipment generates, uses and can radiate radio frequency energy and, if not installed and used in accordance with the instructions, may cause harmful interference to radio communications. However, there is no guarantee that interference will not occur in a particular installation. If this equipment does cause harmful interference to radio or television reception, which can be determined by turning the equipment off and on, the user is encouraged to try to correct the interference by one or more of the following measures:

- Reorient or relocate the receiving antenna.
- Increase the separation between the equipment and receiver.
- Connect the equipment into an outlet on a circuit different from that to which the receiver is connected.
- Consult the dealer or an experienced radio/ TV technician for help.

Caution:

Any changes or modifications not expressly approved by the grantee of this device could void the user's authority to operate the equipment.

- This device meets all the other requirements specified in Part 15E, Section 15.407 of the FCC Rules.
- This device complies with Part 15 of the FCC Rules. Operation is subject to the following two conditions: (1) this device may not cause harmful interference, and (2) this device must accept any interference received, including interference that may cause undesired operation.
- Operation of transmitters in the 5.925-7.125 GHz band is prohibited for control of or communications with unmanned aircraft systems.
- Control of or communications with unmanned aircraft systems is prohibited, including drones.

RF Exposure Warning

This device meets the government's requirements for exposure to radio waves. This device is designed and manufactured not to exceed the emission limits for exposure to radio frequency (RF) energy set by the Federal Communications Commission of the U.S. Government.

The exposure standard employs a unit of measurement known as the Specific Absorption Rate, or SAR. The SAR limit set by the FCC is 1.6 W/kg. Tests for SAR are conducted using standard operating positions accepted by the FCC with the EUT transmitting at the specified power level in different channels.

The FCC has granted an Equipment Authorization for this device with all reported SAR levels evaluated as in compliance with the FCC RF exposure guidelines. SAR information on this device is on file with the FCC and can be found under the Display Grant section of <https://apps.fcc.gov/oetcf/eas/reports/GenericSearch.cfm> after searching on FCC ID: 2AMNG-TG310 FCC ID: 2AMNG-TG300.

Innovation, Science and Economic Development Canada(ISED) Compliance Statement

This device complies with ISED's licence-exempt RSSs. Operation is subject to the following two conditions: (1) This device may not cause harmful interference, and (2) this device must accept any interference received, including interference that may cause undesired operation.

Le présent appareil est conforme aux CNR d'ISED applicables aux appareils radio exempts de licence.

L'exploitation est autorisée aux deux conditions suivantes : (1) le dispositif ne doit pas produire de brouillage préjudiciable, et (2) ce dispositif doit accepter tout brouillage reçu, y compris un brouillage susceptible de provoquer un fonctionnement indésirable.

(i) the device for operation in the band 5150-5250 MHz is only for indoor use to reduce the potential for harmful interference to co-channel mobile satellite systems;

(ii) the maximum antenna gain permitted for devices in the bands 5250-5350 MHz and 5470-5725 MHz shall comply with the e.i.r.p. limit; and

(iii) the maximum antenna gain permitted for devices in the band 5725-5825 MHz shall comply with the e.i.r.p. limits specified for point-to-point and non point-to-point operation as appropriate. High-power radars are allocated as primary users (i.e. priority users) of the bands 5250-5350 MHz and 5650-5850 MHz and that these radars could cause interference and/or damage to LE-LAN devices.

(i) les dispositifs fonctionnant dans la bande 5150-5250 MHz sont réservés uniquement pour une utilisation à l'intérieur afin de réduire les risques de brouillage préjudiciable aux systèmes de satellites mobiles utilisant les mêmes canaux;

(ii) le gain maximal d'antenne permis pour les dispositifs utilisant les bandes 5250-5350 MHz et 5470-5725MHz doit se conformer à la limite de p.i.r.e.;

(iii) le gain maximal d'antenne permis (pour les dispositifs utilisant la bande 5725-5825 MHz) doit se conformer à la limite de p.i.r.e. spécifiée pour l'exploitation point à point et non point à point, selon le cas.

De plus, les utilisateurs de radars de haute puissance sont désignés utilisateurs principaux (c.-à-d., qu'ils ont la priorité) pour les bandes 5250-5350 MHz et 5650-5850 MHz et que ces radars pourraient causer du brouillage et/ou des dommages aux

dispositifs LAN-EL.

Devices shall not be used for control of or communications with unmanned aircraft systems.

Les appareils ne doivent pas être utilisés pour contrôler ou communiquer avec des systèmes d'aéronefs sans pilote.

Radio Frequency (RF) Exposure Information

The radiated output power of the Wireless Device is below the Innovation, Science and Economic Development Canada (ISED) radio frequency exposure limits. The Wireless Device should be used in such a manner such that the potential for human contact during normal operation is minimized.

This device has been evaluated for and shown compliant with the ISED Specific Absorption Rate ("SAR") limits when operated in portable exposure conditions. (Antennas are greater than 5mm from a person's body).

Informations concernant l'exposition aux fréquences radio (RF)

La puissance de sortie rayonnée de l'appareil sans fil est inférieure aux limites d'exposition aux radiofréquences d'Innovation, Sciences et Développement économique Canada (ISDE). L'Appareil sans fil doit être utilisé de telle manière que le potentiel de contact humain pendant le fonctionnement normal soit minimisé.

Cet appareil a été évalué et démontré conforme aux limites de débit d'absorption spécifique ("SAR") ISDE lorsqu'il est utilisé dans des conditions d'exposition portables. (Les antennes sont à plus de

5 mm du corps d'une personne).

CE RED / UK RER Compliance Statement

EU Declaration of Conformity

Hereby, Toast, Incorporated declares that the radio equipment type Handheld Tablet is in compliance with Directive 2014/53/EU.

UK Declaration of Conformity

Hereby, Toast, Incorporated declares that the radio equipment type Handheld Tablet is in compliance with the essential requirements and other relevant provisions of the Radio Equipment Regulations 2017.

The device is restricted to indoor use only when operating in the 5150 to 5350 MHz frequency range.

This device is intended for indoor use only when operating in the frequency range 5945 to 6425 MHz which is applicable in countries that support WiFi 6E.

The device is restricted to indoor use only when operating in the 5925 to 6425 MHz frequency range.

RF Exposure warning

This device meets the EU requirements (2014/53/EU) on the limitation of exposure of the general public to electromagnetic

fields by way of health protection.

The limits are part of extensive recommendations for the protection of the general public. These recommendations have been developed and checked by independent scientific organizations through regular and thorough evaluations of scientific studies. The unit of measurement for the European Council's recommended limit for mobile devices is the "Specific Absorption Rate" (SAR), and the SAR limit is 2.0 W/Kg averaged over 10 grams of body tissue. It meets the requirements of the International Commission on Non-Ionizing Radiation Protection (ICNIRP).

For next-to-body operation, this device has been tested and meets the ICNRP exposure guidelines and the European Standard EN 50566 and EN 62209-2. SAR is measured with the device directly contacted to the body while transmitting at the highest certified output power level in all frequency bands of the mobile device. (MAX SAR @ TG300 : 0.987 W/Kg; TG310 : 1.445 W/Kg)

If the product belongs to Class II device, the package should follow the RED Article 10(10) rules. (see the icon on the right)

Red:



AT	BE	BG	CH	CY	CZ	DK	DE	EE	EL
ES	FI	FR	HR	HU	IE	IS	IT	LT	LU
LV	MT	NL	PL	PT	RO	SI	SE	SK	NI

UKCA: UK only



UK

CAUTION

Risk of explosion if battery is replaced by an incorrect type. Dispose of used batteries according to the instructions. The adapter shall be installed near the equipment and shall be easily accessible.

Safety

UL / IEC 62368-1

- Warning:
Power cord shall be connected to a socket-outlet with earthing connection.
- Warning:
Risk of explosion if battery is replaced by an incorrect type. Dispose of expended battery in accordance with local disposal regulations.
- Warning:
This product is intended to be supplied by a Listed Power Adapter "L.P.S." (Or "Limited Power Source") and is rated at 5 Vdc, 3 A min., Tma = 50 degrees C.

- **Warning:**
The maximum ambient for charging mode is 50 degrees C and for discharge mode is 50 degrees C.

- **Attention:**
le cordon d'alimentation doit être branché sur une prise secteur avec mise à la terre.

- **Attention:**
Risque d'explosion si la batterie est remplacée par une de type incorrect Éliminer la pile usagée conformément à la réglementation locale en vigueur.

- **Attention:**
Le produit est destiné à être alimenté par un adaptateur secteur répertorié « L.P.S. » (ou “Source d'alimentation limitée”) et est évalué à 5 Vdc, 3 A min., Tma = 50 degrés C.

- **Attention:**
La température ambiante maximale pour le mode de charge est de 50 degrés C et pour le mode de décharge est de 50 degrés C.

Max, radio-frequency power transmitted	
NFC	13.57215 MHz
BT 2402-2480 MHz	9.30 dBm
BLE 2402-2480 MHz	9.36 dBm
Wi-Fi 2.4G 2412-2472 MHz	19.984 dBm
Wi-Fi 5G 5150-5850 MHz	22.306 dBm
Wi-Fi 6G 5925-6425 MHz	17.805 dBm
LTE/3G	23 dBm

Accessories



5-in-1 Charging Dock
(not compatible with Toast Go 2)



Protective Case

